

A & B DIMENSIONS

Bar	A	B
p12(E)	24'-11"	1'-3"
p14(E)	22'-11"	1'-3"
v11(E)	21'-3"	1'-4"

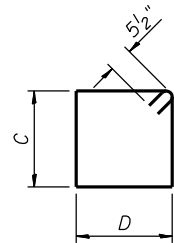

C & D DIMENSIONS

Bar	C	D
s11(E)	3'-8"	1'-10"
s12(E)	3'-6"	1'-10"
s13(E)	3'-0"	1'-10"
s14(E)	2'-6"	1'-10"
s15(E)	2'-0"	1'-10"
s16(E)	1'-6"	1'-10"
s17(E)	2'-8"	2'-8"

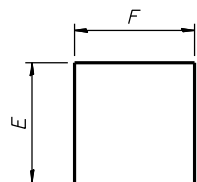

E & F DIMENSIONS

Bar	E	F
s10(E)	4'-9"	2'-8"
u11(E)	3'-0"	2'-8"
u12(E)	2'-3"	2'-8"
v12(E)	11'-1"	2'-8"

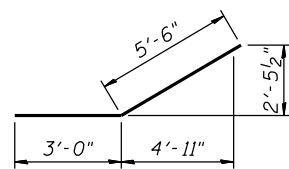

BAR p11(E)

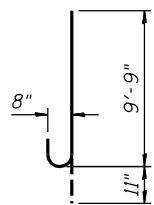

BAR n11(E)

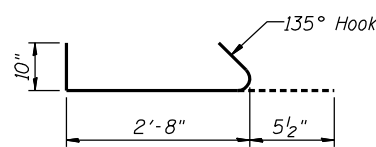

BAR s18(E)

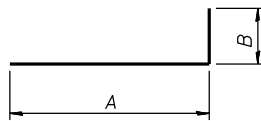

A & B DIMENSIONS

Bar	A	B
p22(E)	24'-2"	1'-3"
p24(E)	22'-11"	1'-3"
v21(E)	23'-3"	1'-4"

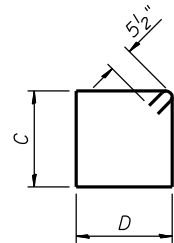

C & D DIMENSIONS

Bar	C	D
s21(E)	3'-8"	1'-10"
s22(E)	3'-6"	1'-10"
s23(E)	3'-0"	1'-10"
s24(E)	2'-6"	1'-10"
s25(E)	2'-0"	1'-10"
s26(E)	1'-6"	1'-10"
s27(E)	2'-8"	2'-8"

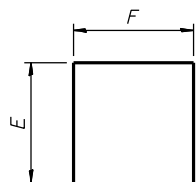

E & F DIMENSIONS

Bar	E	F
s20(E)	4'-9"	2'-8"
u21(E)	3'-0"	2'-8"
u22(E)	2'-3"	2'-8"
v22(E)	7'-11"	2'-8"

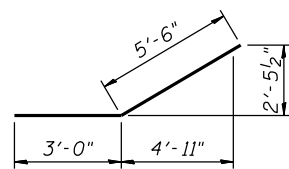

BAR p21(E)

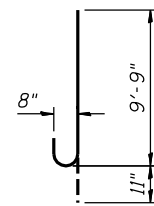

BAR n21(E)

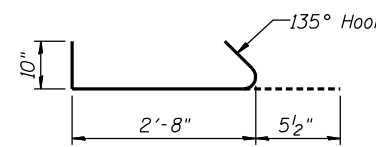

BAR s28(E)

BILL OF MATERIAL - PIER 2

Bar	No.	Size	Length	Shape
d21(E)	50	#6	4'-3"	—
h21(E)	2	#5	24'-2"	—
h22(E)	2	#5	22'-10"	—
h23(E)	2	#5	21'-0"	—
h24(E)	2	#5	22'-11"	—
h25(E)	2	#5	21'-7"	—
h26(E)	2	#5	19'-9"	—
h27(E)	19	#5	18'-2"	—
h28(E)	19	#5	16'-11"	—
n21(E)	40	#8	10'-8"	┘
p21(E)	8	#5	8'-6"	┘
p22(E)	7	#9	25'-5"	┘
p23(E)	7	#10	19'-2"	┘
p24(E)	7	#9	24'-2"	┘
p25(E)	7	#10	17'-11"	┘
s20(E)	37	#5	12'-2"	┘
s21(E)	78	#5	11'-11"	┘
s22(E)	4	#5	11'-7"	┘
s23(E)	4	#5	10'-7"	┘
s24(E)	4	#5	9'-7"	┘
s25(E)	4	#5	8'-7"	┘
s26(E)	4	#5	7'-7"	┘
s27(E)	40	#5	11'-7"	┘
s28(E)	80	#5	4'-0"	┘
t21(E)	74	#5	10'-8"	—
u21(E)	8	#5	8'-8"	┘
u22(E)	16	#5	7'-2"	┘
v21(E)	40	#8	24'-7"	┘
v22(E)	37	#5	18'-6"	┘
w21(E)	22	#5	18'-2"	—
w22(E)	22	#5	16'-11"	—
Structure Excavation		Cu Yd.	210	
Concrete Structures		Cu Yd.	103.0	
Reinforcement Bars, Epoxy Coated		Pound	12,420	
Concrete Sealer		Sq. Ft.	1,290	

BILL OF MATERIAL - PIER 3

Bar	No.	Size	Length	Shape
d31(E)	42	#6	4'-3"	—
h31(E)	2	#5	23'-6"	—
h32(E)	2	#5	22'-2"	—
h33(E)	2	#5	20'-4"	—
h34(E)	2	#5	22'-11"	—
h35(E)	2	#5	21'-7"	—
h36(E)	2	#5	19'-9"	—
h37(E)	11	#5	17'-6"	—
h38(E)	11	#5	16'-11"	—
n31(E)	40	#8	10'-8"	┘
p31(E)	8	#5	8'-6"	┘
p32(E)	7	#9	24'-9"	┘
p33(E)	7	#10	18'-6"	┘
p34(E)	7	#9	24'-2"	┘
p35(E)	7	#10	17'-11"	┘
s30(E)	36	#5	12'-2"	┘
s31(E)	76	#5	11'-11"	┘
s32(E)	4	#5	11'-7"	┘
s33(E)	4	#5	10'-7"	┘
s34(E)	4	#5	9'-7"	┘
s35(E)	4	#5	8'-7"	┘
s36(E)	4	#5	7'-7"	┘
s37(E)	48	#5	11'-7"	┘
s38(E)	96	#5	4'-0"	┘
t31(E)	72	#5	9'-8"	—
u31(E)	8	#5	8'-8"	┘
u32(E)	8	#5	7'-2"	┘
v31(E)	40	#8	28'-1"	┘
v32(E)	36	#5	10'-2"	┘
w31(E)	20	#5	17'-6"	—
w32(E)	20	#5	16'-11"	—
Structure Excavation		Cu Yd.	120	
Concrete Structures		Cu Yd.	85.0	
Reinforcement Bars, Epoxy Coated		Pound	11,950	
Concrete Sealer		Sq. Ft.	1,400	

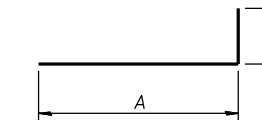

A & B DIMENSIONS

Bar	A	B
p32(E)	23'-6"	1'-3"
p34(E)	22'-11"	1'-3"
v31(E)	26'-9"	1'-4"

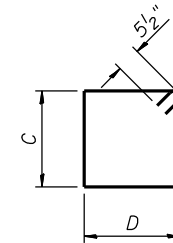

C & D DIMENSIONS

Bar	C	D
s31(E)	3'-8"	1'-10"
s32(E)	3'-6"	1'-10"
s33(E)	3'-0"	1'-10"
s34(E)	2'-6"	1'-10"
s35(E)	2'-0"	1'-10"
s36(E)	1'-6"	1'-10"
s37(E)	2'-8"	2'-8"

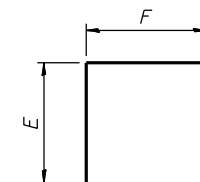

E & F DIMENSIONS

Bar	E	F
s30(E)	4'-9"	2'-8"
u31(E)	3'-0"	2'-8"
u32(E)	2'-3"	2'-8"
v32(E)	3'-9"	2'-8"

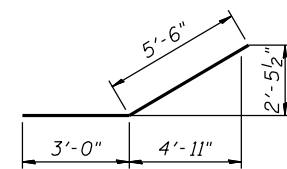

BAR p31(E)

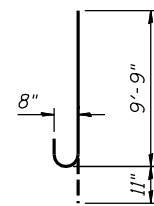

BAR n31(E)

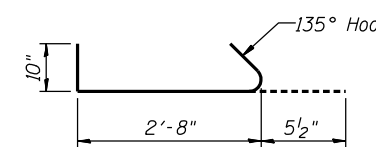

BAR s38(E)

NOTES:
1. Work this Sheet with Sheets S70 thru S72.

P:\p\2010\20103003\cadd\structural\dm\045-0039 - final\00.DWG\033-e073-pier-sh.2,3-dt.dgn
 6/14/2012 6:03:32 PM