

KENDALL COUNTY

SB-IL-TS-26
SIGN TO BE RELOCATED
FROM STA. 209+01, LT
TO STA. 208+40, LT

TO BASELINE RD →
SB-IL-TS-21
TO STAY IN PLACE

ALBRIGHT RD
SB-IL-TS-3
TO STAY IN PLACE

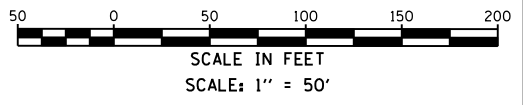
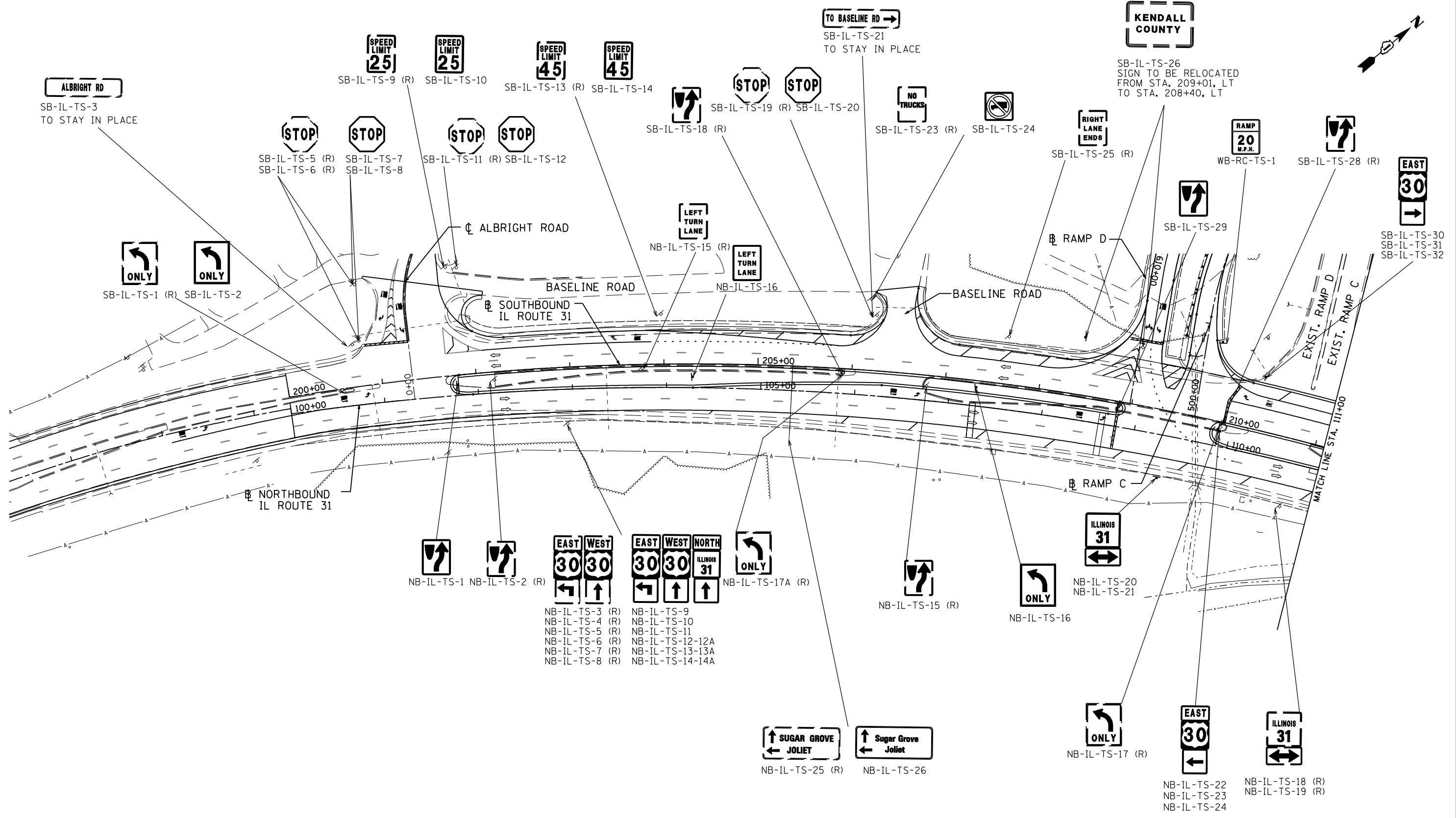

5/15/2012 12:44:41 AM

GRÄEF
8501 W. Higgins Road, Suite 280
Chicago, Illinois 60631; (773) 399-0112

USER NAME = 1654	DESIGNED - JWB	REVISED -
DRAWN - JWB	REVISIONS -	
PLOT SCALE = 100.0000' / IN.	CHECKED - RS	REVISED -
PLOT DATE = 5/16/2012	DATE - 05/11/2012	REVISED -

**STATE OF ILLINOIS
DEPARTMENT OF TRANSPORTATION**

**U.S. ROUTE 30 AT IL ROUTE 31
SIGNING PLAN - IL ROUTE 31**

F.A.P. RTE.	SECTION	COUNTY	TOTAL SHEETS	SHEET NO.
349	(10 & 11 VB) R-3	KANE AND KENDALL	507	373
CONTRACT NO. 60133			ILLINOIS FED. AID PROJECT	

STA. 100+00 TO STA. 111+00