

DATE	
BY	
SURVEYED	
PLOTTED	
TEMPLATE	
AREAS	
CHECKED	
FINAL SURVEY	
NOTE BOOK	
NO.	

DATE	
BY	
SURVEYED	
PLOTTED	
TEMPLATE	
AREAS	
CHECKED	
ORIGINAL SURVEY	
NOTE BOOK	
NO.	

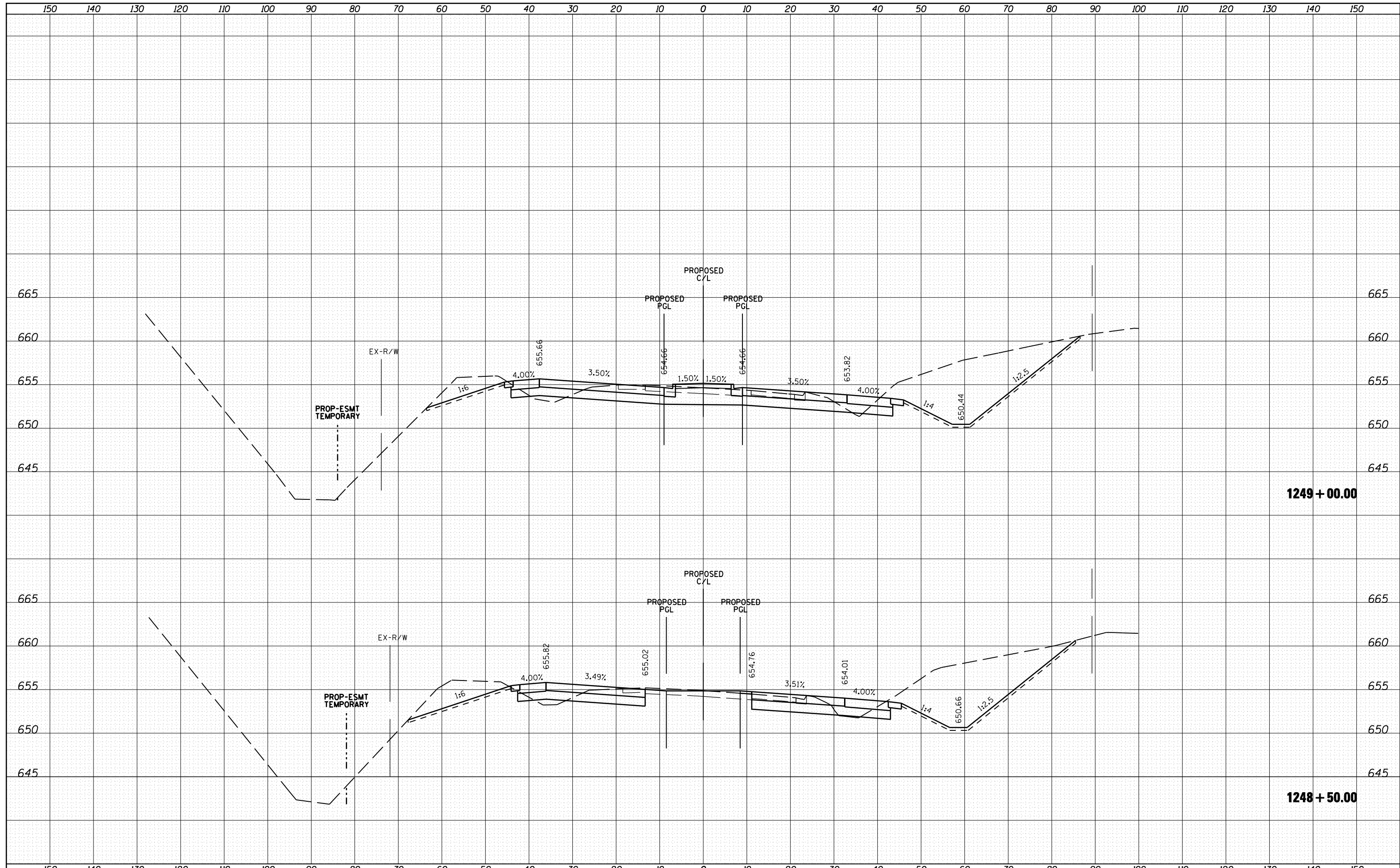

FILE NAME =	USER NAME = 1654	DESIGNED - NGS	REVISED -	<b>STATE OF ILLINOIS</b> <b>DEPARTMENT OF TRANSPORTATION</b>	<b>U.S. ROUTE 30 AT IL ROUTE 31</b> <b>CROSS SECTIONS - U.S. ROUTE 30</b>	F.A. RTE.	SECTION	COUNTY	TOTAL SHEETS	SHEET NO.
ht:\jobs\2010\20103003\cod\site\dgn\refs\US-30.D	60133-sht-US30-xsec.dgn	DRAWN - NGS	REVISED -			349	(10 & 11 VB) R-3	*	507	399
PLOT SCALE = 20.0000' / IN.	CHECKED - RS	REVISIED -				* KANE AND KENDALL		CONTRACT NO. 60133		
PLOT DATE = 5/16/2012	DATE - 05/11/2012	REVISIED -				ILLINOIS FED. AID PROJECT				

SCALE: SHEET NO. 14 OF 41 SHEETS STA. 1248+50.00 TO STA. 1249+00.00