

DATE	
BY	
SURVEYED	
PLOTTED	
TEMPLATE	
AREAS	
CHECKED	
FINAL SURVEY	
NOTE BOOK	
NO.	

DATE	
BY	
SURVEYED	
PLOTTED	
TEMPLATE	
AREAS	
CHECKED	
ORIGINAL SURVEY	
NOTE BOOK	
NO.	

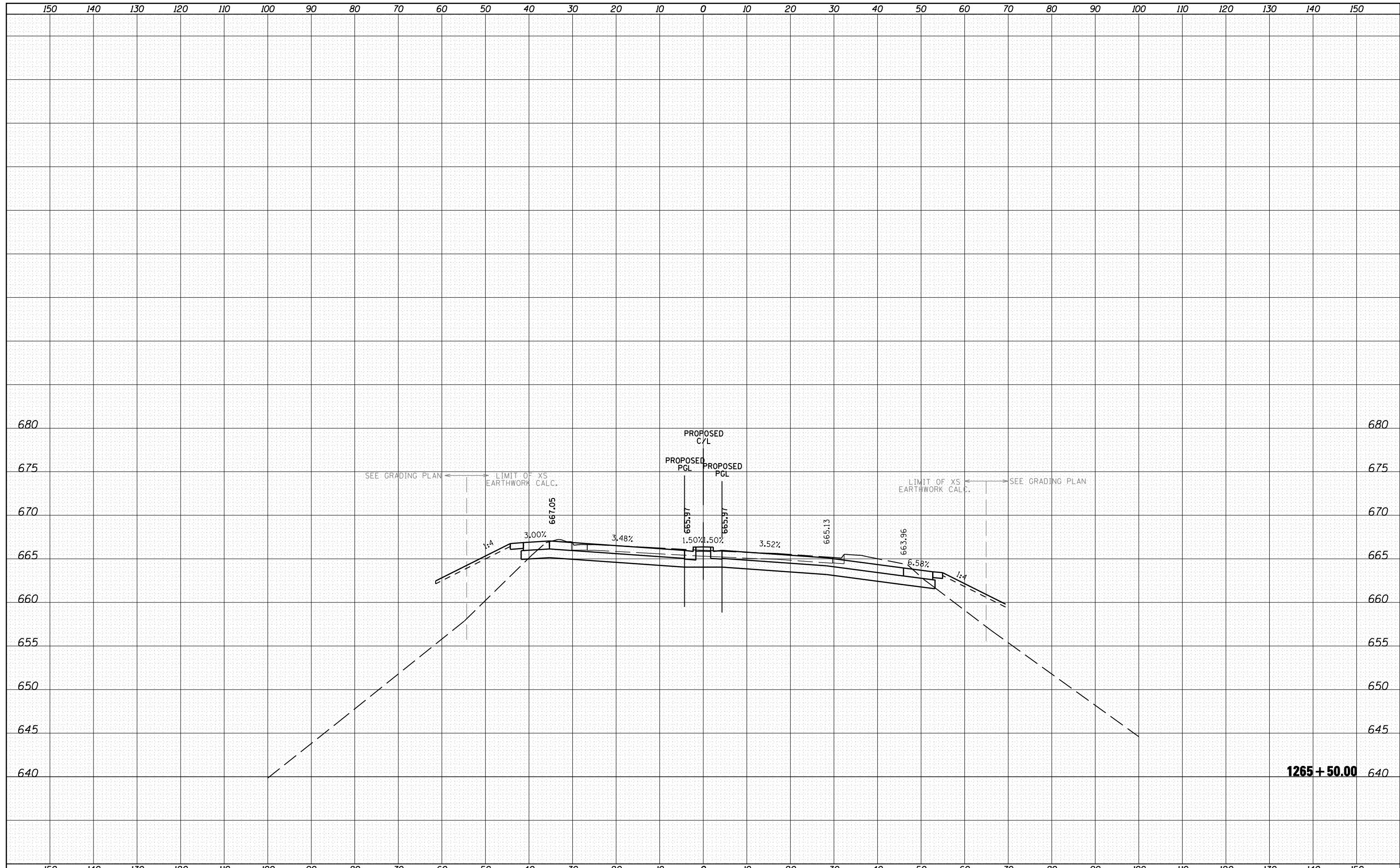

1265 + 50.00

FILE NAME =	USER NAME = 1654	DESIGNED - NGS	REVISIED -	STATE OF ILLINOIS DEPARTMENT OF TRANSPORTATION	U.S. ROUTE 30 AT IL ROUTE 31 CROSS SECTIONS - U.S. ROUTE 30		F.A. RTE.	SECTION	COUNTY	TOTAL SHEETS	SHEET NO.
ht:\jobs\2010\20103003\cod\site\dgn\refs\US-30\060133-sht-US30-xsec.dgn		DRAWN - NGS	REVISIED -		349	(10 & 11 VB) R-3	*	507	415		
PLOT SCALE = 20.0000' / IN.		CHECKED - RS	REVISIED -		* KANE AND KENDALL			CONTRACT NO. 60133			
PLOT DATE = 5/16/2012		DATE - 05/11/2012	REVISIED -		SCALE:	SHEET NO. 30 OF 41 SHEETS	STA. 1265+50.00 TO STA. 1265+50.00	ILLINOIS FED. AID PROJECT			