

DATE	
BY	
SURVEYED	
PLOTTED	
TEMPLATE	
AREAS	
CHECKED	
NO.	

DATE	
BY	
SURVEYED	
PLOTTED	
TEMPLATE	
AREAS	
CHECKED	
NO.	

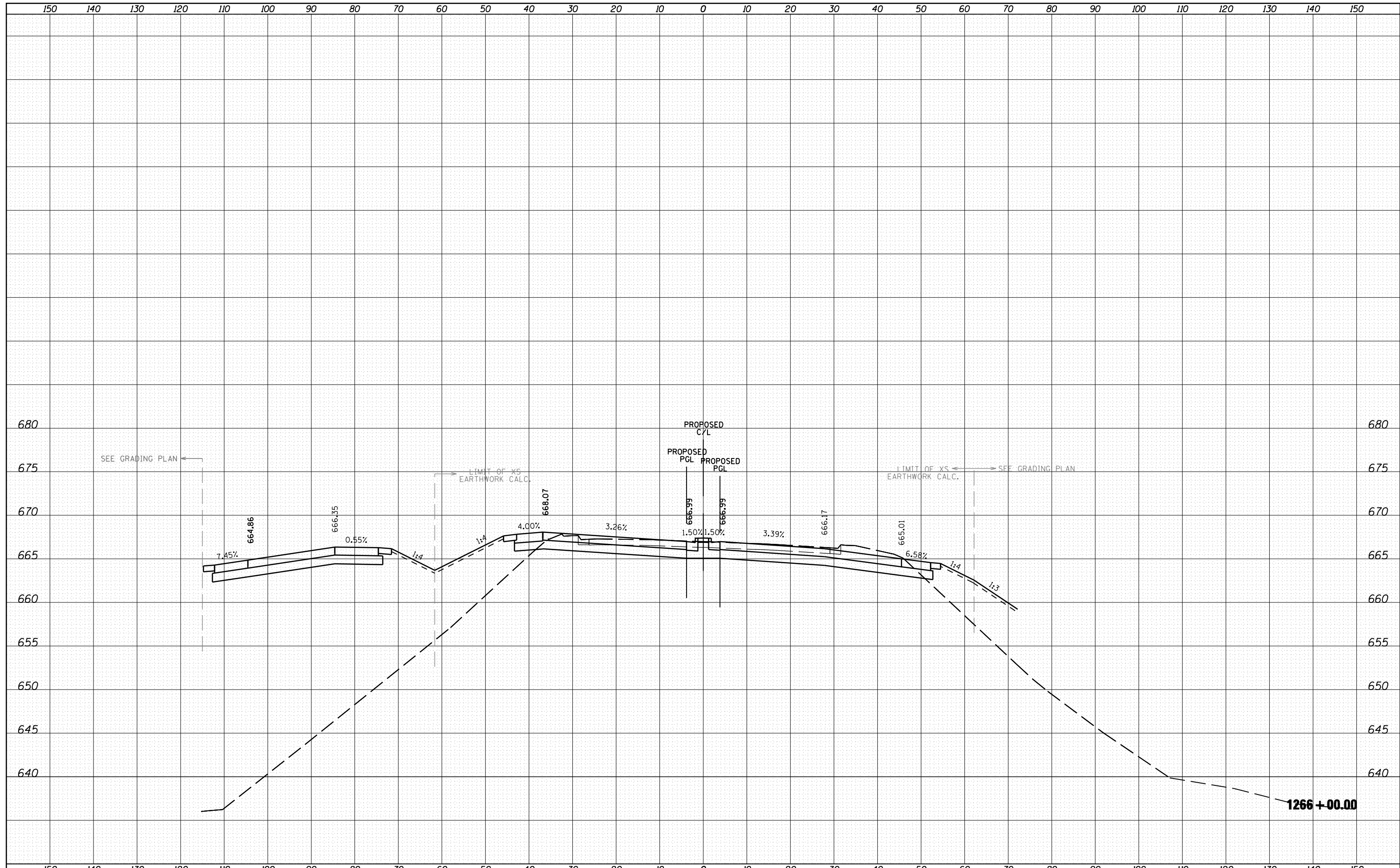

FILE NAME =	USER NAME = 1654	DESIGNED - NGS	REVISED -	<p align="center"><b>STATE OF ILLINOIS</b> <b>DEPARTMENT OF TRANSPORTATION</b></p> <p align="center"><b>U.S. ROUTE 30 AT IL ROUTE 31</b> <b>CROSS SECTIONS - U.S. ROUTE 30</b></p>	F.A. RTE. =	SECTION	COUNTY	TOTAL SHEETS	SHEET NO.
ht:\jobs\2010\20103003\cod\site\dgn\refs\US-30\160133-sht-US30-xsec.dgn	DRAWN - NGS	REVISOR -			349	(10 & 11 VB) R-3	*	507	416
PLOT SCALE = 20.0000' / IN.	CHECKED - RS	REVISOR -			* KANE AND KENDALL CONTRACT NO. 60133				
PLOT DATE = 5/16/2012	DATE - 05/11/2012	REVISOR -			ILLINOIS FED. AID PROJECT				