

BY	DATE
FINAL SURVEY	SURVEYED
NOTE BOOK	PLOTTED
NO.	TEMPLATE
	AREAS CHECKED

BY	DATE
ORIGINAL SURVEY	SURVEYED
NOTE BOOK	PLOTTED
NO.	TEMPLATE
	AREAS CHECKED

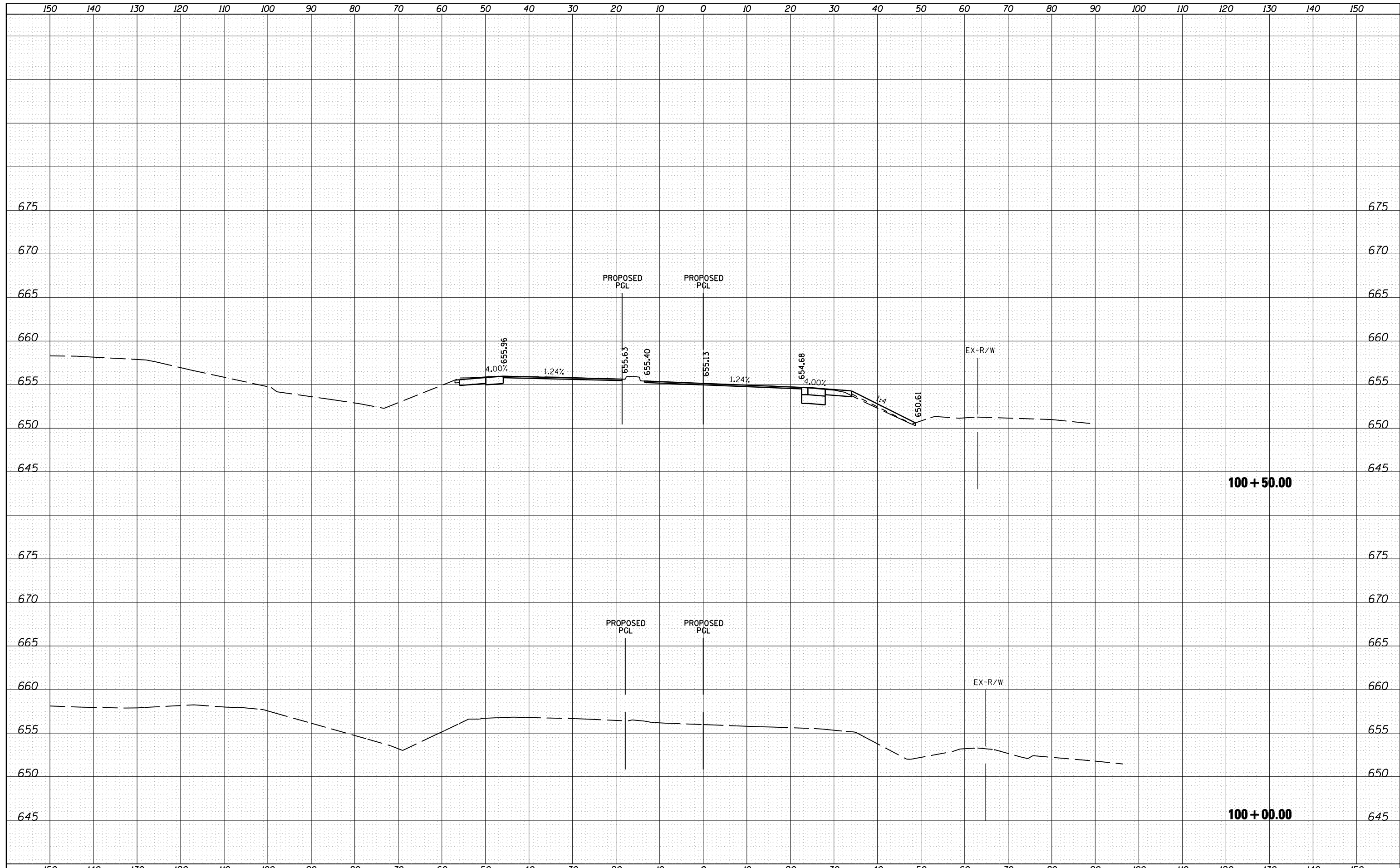

FILE NAME =	USER NAME = 1654	DESIGNED - NGS	REVISED -	STATE OF ILLINOIS DEPARTMENT OF TRANSPORTATION	U.S. ROUTE 30 AT IL ROUTE 31 CROSS SECTIONS - IL ROUTE 31			F.A. RTE.	SECTION	COUNTY	TOTAL SHEETS	SHEET NO.
ht:\jobs\2010\20103003\cod\site\dgn\refs\IL-31\10133-sh.t..IL31-xsec-NB.dgn		DRAWN - NGS	REVISED -		349	(10 & 11 VB) R-3	*	507	427			
PLOT SCALE = 20.0000' / IN.		CHECKED - RS	REVISED -		* KANE AND KENDALL CONTRACT NO. 60133							
PLOT DATE = 5/16/2012		DATE - 05/11/2012	REVISED -		SCALE:	SHEET NO. 1 OF 39 SHEETS	STA. 100+00.00 TO STA. 100+50.00	ILLINOIS FED. AID PROJECT				