

| | |
|----------------------------|--|
| DATE | |
| BY | |
| SURVEYED | |
| PLOTTED | |
| TEMPLATE | |
| AREAS CHECKED | |
| FINAL SURVEY NOTE BOOK NO. | |

| | |
|-------------------------------|--|
| DATE | |
| BY | |
| SURVEYED | |
| PLOTTED | |
| TEMPLATE | |
| AREAS CHECKED | |
| ORIGINAL SURVEY NOTE BOOK NO. | |

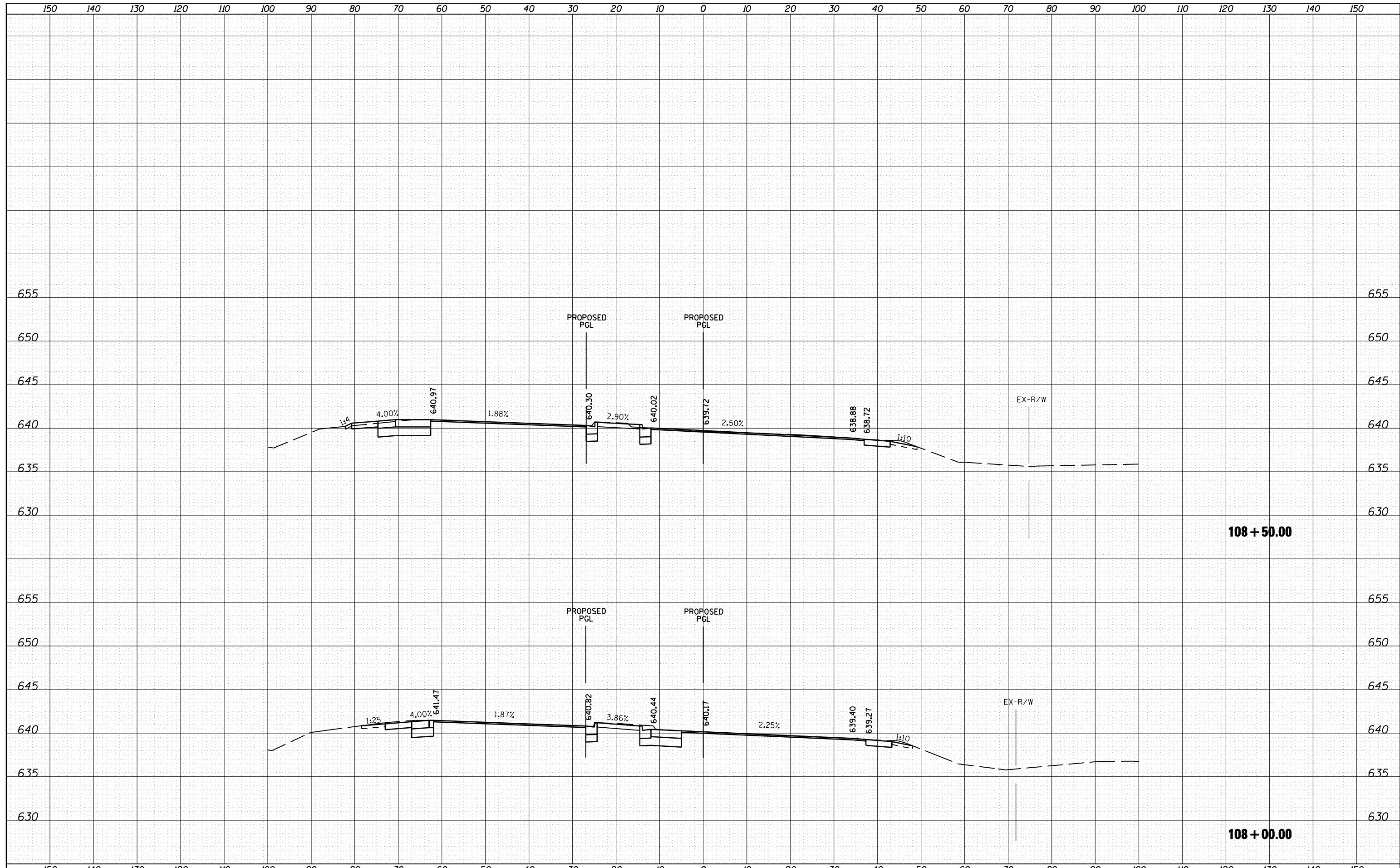

| | | | | | | | | | | |
|---|------------------|-------------------|-----------|---|--|---------------------------|------------------|--------------------|--------------|-----------|
| FILE NAME = | USER NAME = 1654 | DESIGNED - NGS | REVISED - | STATE OF ILLINOIS DEPARTMENT OF TRANSPORTATION | U.S. ROUTE 30 AT IL ROUTE 31 CROSS SECTIONS - IL ROUTE 31 | F.A. RTE. | SECTION | COUNTY | TOTAL SHEETS | SHEET NO. |
| ht:\jobs\2010\20103003\cod\site\dgn\refs\IL-31\10133-sh.tl;IL31-xsec-NB.dgn | | DRAWN - NGS | REVISED - | | | 349 | (10 & 11 VB) R-3 | * | 507 | 437 |
| PLOT SCALE = 20.0000' / IN. | | CHECKED - RS | REVISED - | | | * KANE AND KENDALL | | CONTRACT NO. 60133 | | |
| PLOT DATE = 5/16/2012 | | DATE - 05/11/2012 | REVISED - | | | ILLINOIS FED. AID PROJECT | | | | |

SCALE: SHEET NO. 11 OF 39 SHEETS STA. 108+00.00 TO STA. 108+50.00