

| | |
|----------|--|
| DATE | |
| BY | |
| SURVEYED | |
| PLOTTED | |
| TEMPLATE | |
| AREAS | |
| CHECKED | |
| NO. | |

| | |
|----------|--|
| DATE | |
| BY | |
| SURVEYED | |
| PLOTTED | |
| TEMPLATE | |
| AREAS | |
| CHECKED | |
| NO. | |

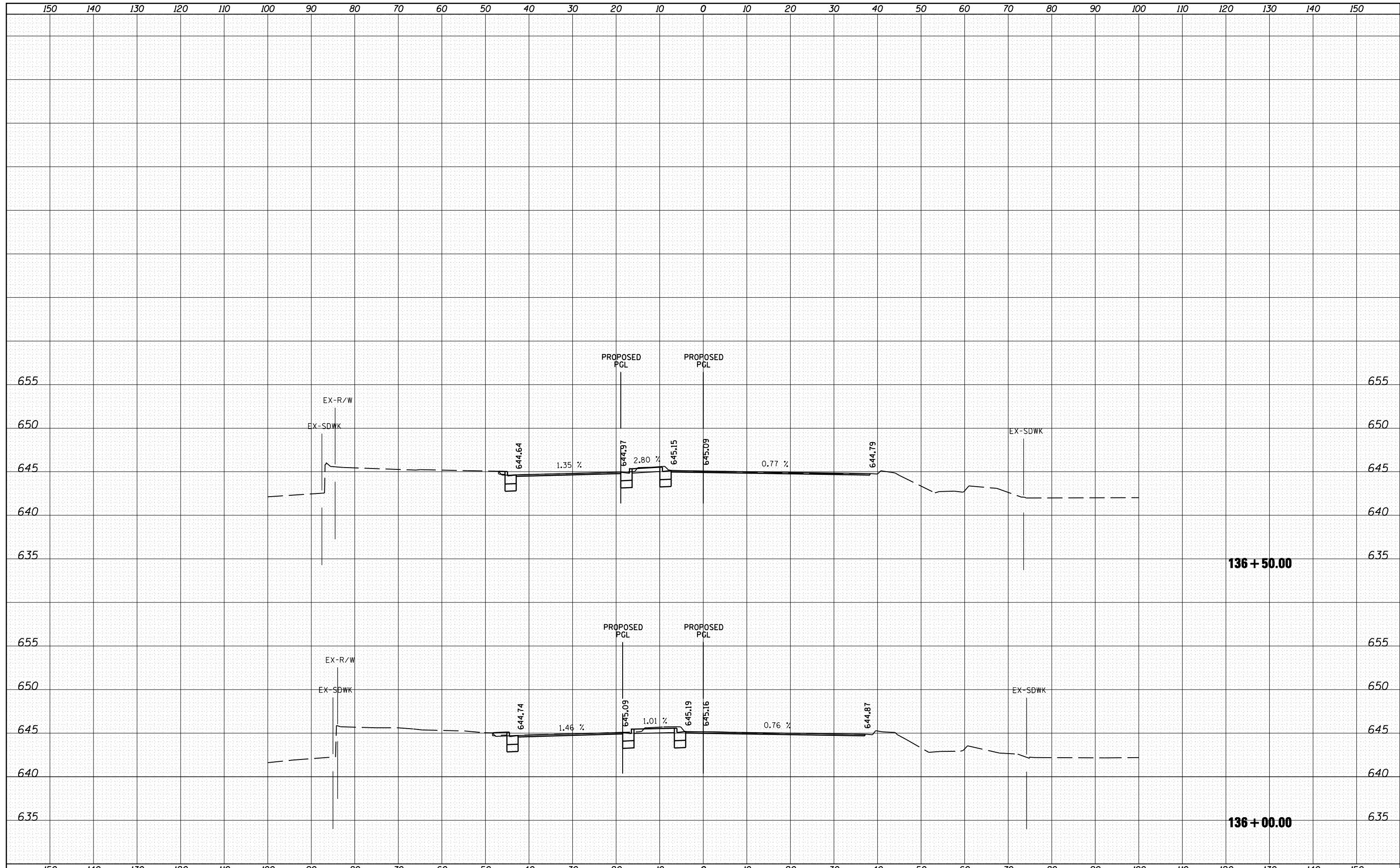

| | | | | | | | | | | |
|--|-------------------|---------------------------|---------------------------|---|--|--------------------|---------|--------|--------------|-----------|
| FILE NAME = | USER NAME = 1654 | DESIGNED - NGS | REVISED - | STATE OF ILLINOIS DEPARTMENT OF TRANSPORTATION | U.S. ROUTE 30 AT IL ROUTE 31 CROSS SECTIONS - IL ROUTE 31 | F.A. RTE. | SECTION | COUNTY | TOTAL SHEETS | SHEET NO. |
| ht:\jobs\2010\20103003\ced\site\dgn\refs\IL-31\160133-sh.t..il31-xsec-NB.dgn | DRAWN - NGS | REVISED - | 349 | | | (10 & 11 VB) R-3 | * | 507 | 464 | |
| PLOT SCALE = 20.0000' / IN. | CHECKED - RS | REVISED - | * KANE AND KENDALL | | | CONTRACT NO. 60133 | | | | |
| PLOT DATE = 5/16/2012 | DATE - 05/11/2012 | REVISED - | ILLINOIS FED. AID PROJECT | | | | | | | |
| SCALE: | | SHEET NO. 38 OF 39 SHEETS | | STA. 136+00.00 TO STA. 136+50.00 | | | | | | |