

DATE	
BY	
SURVEYED	
PLOTTED	
TEMPLATE	
AREAS	
CHECKED	
FINAL SURVEY	
NOTE BOOK	
NO.	

DATE	
BY	
SURVEYED	
PLOTTED	
TEMPLATE	
AREAS	
CHECKED	
ORIGINAL SURVEY	
NOTE BOOK	
NO.	

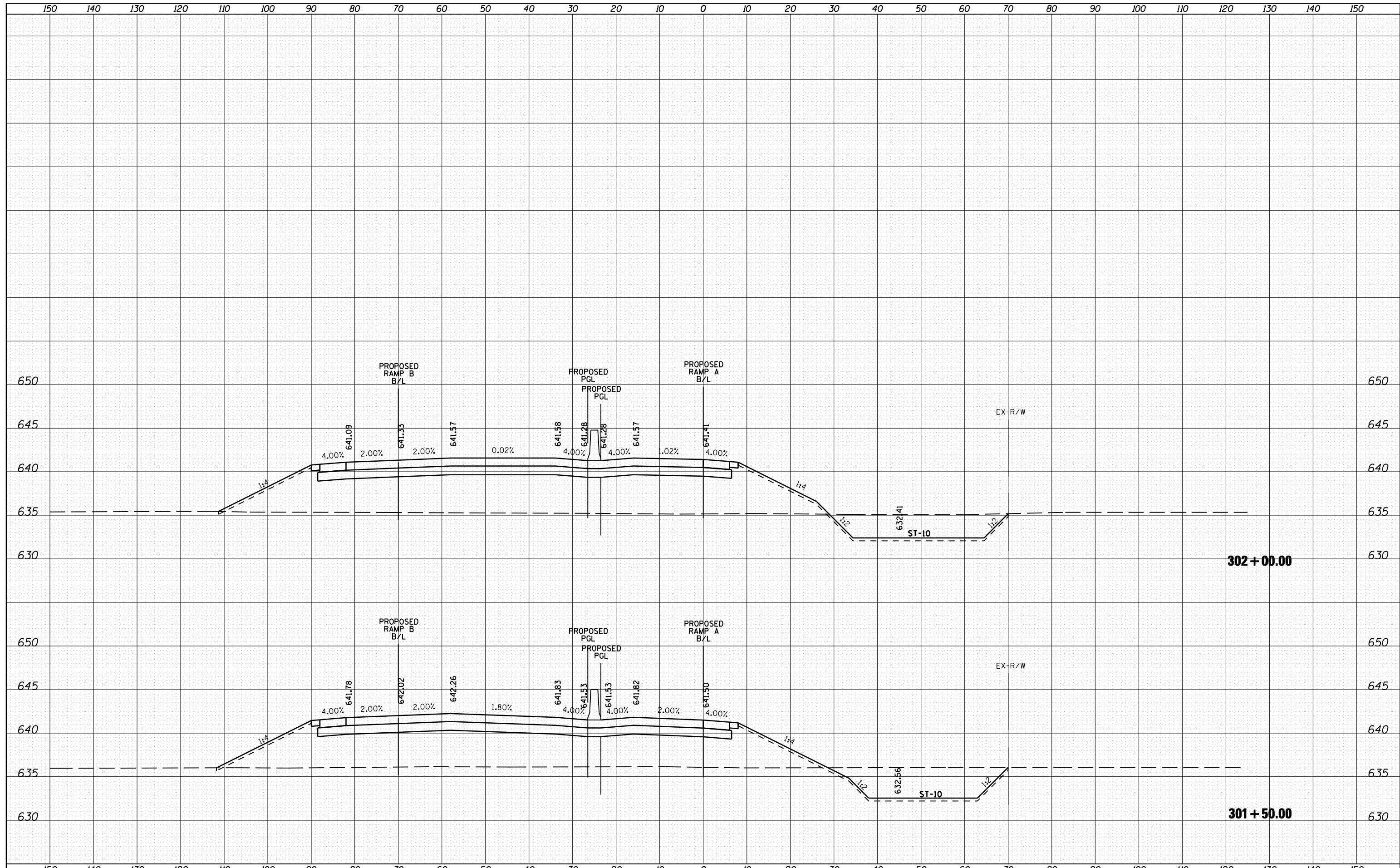

FILE NAME =	USER NAME = 1654	DESIGNED - NGS	REVISED -	<b>STATE OF ILLINOIS DEPARTMENT OF TRANSPORTATION</b>	<b>U.S. ROUTE 30 AT IL ROUTE 31 CROSS-SECTIONS - RAMP A</b>			F.A. RTE. = 349	SECTION = (10 & 11 VB) R-3	COUNTY = *	TOTAL SHEETS = 507	SHEET NO. = 466
ht:\jobs\2010\20103003\cod\site\dgn\refs\RampA-300\DI60133-sh1-RampA-300-xsec.dgn		DRAWN - NGS	REVISED -		SCALE:	SHEET NO. 1 OF 16 SHEETS	STA. 301+50.00	TO STA. 302+00.00	* KANE AND KENDALL		CONTRACT NO. 60133	
PLOT SCALE = 20.0000' / IN.		CHECKED - RS	REVISED -		ILLINOIS FED. AID PROJECT							
PLOT DATE = 5/16/2012		DATE - 05/11/2012	REVISED -									