

**INDEX OF SHEETS**

FOR INDEX OF SHEETS, SEE SHEET NO. 2

PROJECT LOCATED IN VILLAGE OF MIDLOTHIAN, THE CITY OF HARVEY, THE VILLAGE OF POSEN AND THE VILLAGE OF DIXMOOR

| TRAFFIC DATA:  | ADT (2030) | DESIGN SPEED | POSTED SPEED |
|----------------|------------|--------------|--------------|
| 147TH STREET   | 23,000     | 40 MPH       | 35 MPH       |
| KEDZIE AVENUE  | 22,000     | 40 MPH       | 35 MPH       |
| DIXIE HIGHWAY  | 11,000     | 40 MPH       | 35 MPH       |
| WESTERN AVENUE | 10,000     | 40 MPH       | 35 MPH       |

**PROJECT DESCRIPTION**

THE PROPOSED 147TH STREET IMPROVEMENT INCLUDES PAVEMENT RECONSTRUCTION AND WIDENING, TRAFFIC SIGNALS, ROADWAY LIGHTING, AND DRAINAGE. WORK WILL INCLUDE PORTIONS OF I-57 ENTRANCE AND EXIT RAMP AS WELL AS PORTIONS OF WESTERN AVENUE AND DIXIE HIGHWAY.

**DESIGN DESIGNATION**

1780(30) ARTERIAL

STATE OF ILLINOIS  
DEPARTMENT OF TRANSPORTATION  
DIVISION OF HIGHWAYS

**PROPOSED HIGHWAY PLANS**

FAP 397

IL-83 (147TH STREET): KEDZIE AVENUE TO WESTERN AVENUE (DIXIE HIGHWAY)

ROADWAY RECONSTRUCTION, LIGHTING AND TRAFFIC SIGNAL INSTALLATION

COOK COUNTY

PROJ. TIG - F-0397(004)

C-91-130-11

SECTION (0405-1 & 0506-2) R-1

PROJECT NO.

|                                   |          |              |              |           |
|-----------------------------------|----------|--------------|--------------|-----------|
| F.A.I. RTE.                       | SECTION  | COUNTY       | TOTAL SHEETS | SHEET NO. |
| 57                                |          | COOK         | 577          | 1         |
| FED. ROAD DIST. NO.               | ILLINOIS | CONTRACT NO. | 60M57        |           |
| D-91-130-11 (0405-1 & 0506-2) R-1 |          |              |              |           |

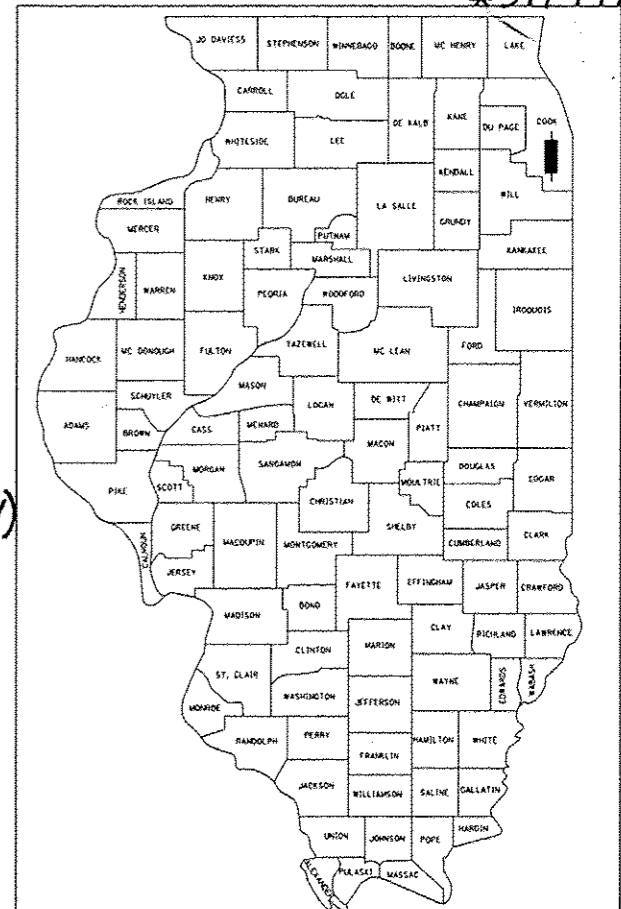

LOCATION OF SECTION INDICATED THUS: -

STATE OF ILLINOIS  
DEPARTMENT OF TRANSPORTATION  
DIVISION OF HIGHWAYS

SUBMITTED MAY 2, 2012

*Diane M. O'Keefe*  
DEPUTY DIRECTOR OF HIGHWAYS, REGION ENGINEER

August 17, 2012  
*John D. Savarelli P.E./a*  
acting ENGINEER OF DESIGN AND ENVIRONMENT

August 17, 2012  
*William R. Frey, Jr.*  
acting DIRECTOR OF HIGHWAYS, CHIEF ENGINEER

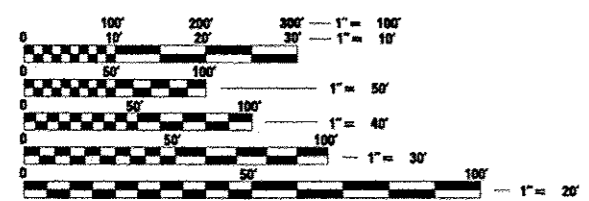

FULL SIZE PLANS HAVE BEEN PREPARED USING STANDARD ENGINEERING SCALES. REDUCED SIZED PLANS WILL NOT CONFORM TO STANDARD SCALES. IN MAKING MEASUREMENTS ON REDUCED PLANS, THE ABOVE SCALES MAY BE USED.

J.U.L.I.E.  
JOINT UTILITY LOCATION INFORMATION FOR EXCAVATION  
1-800-892-0123

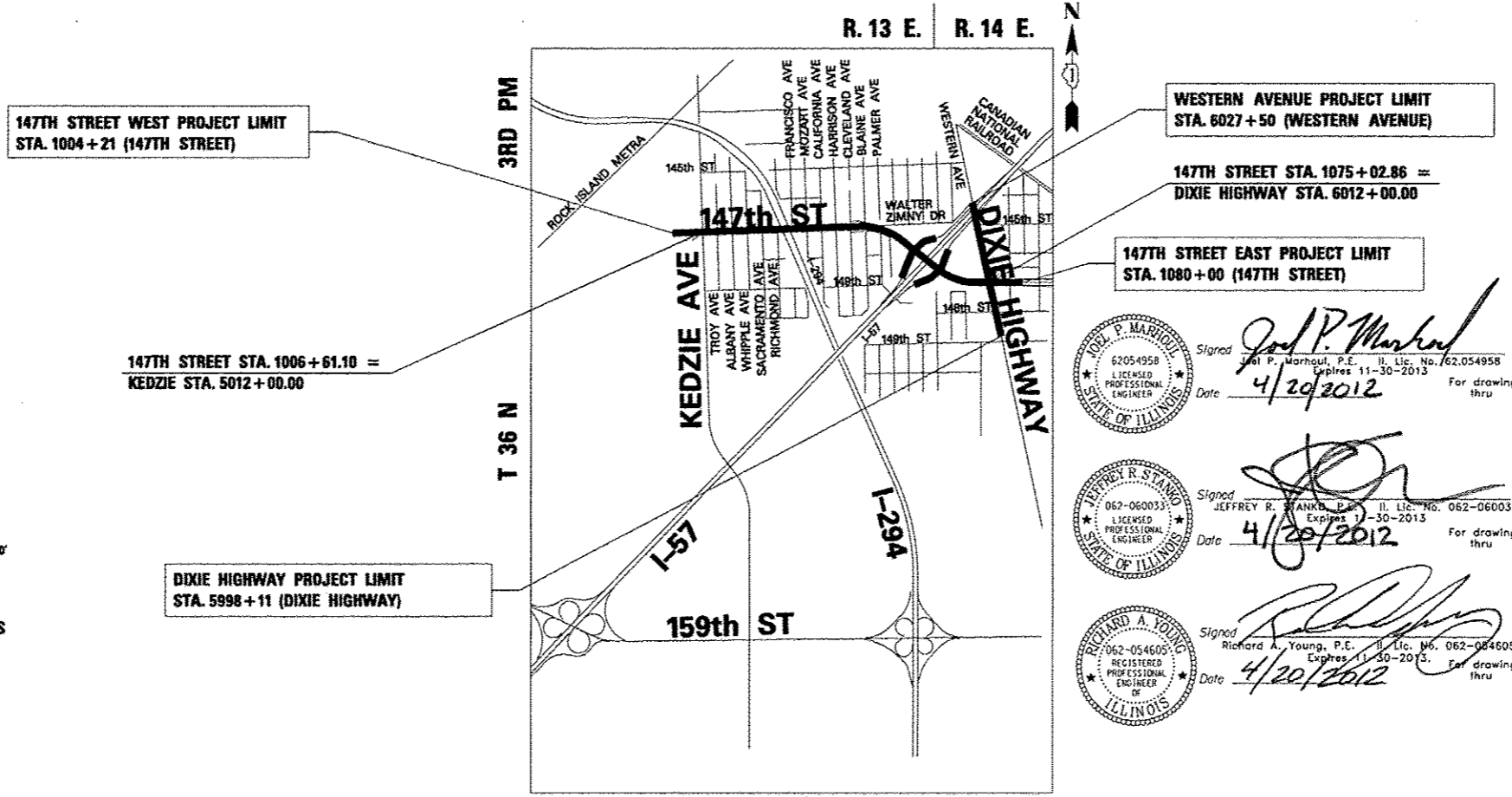

VILLAGE OF POSEN

LOCATION MAP

GROSS LENGTH OF PROJECT = 12,360 FT. = 2.34 MI.  
NET LENGTH OF PROJECT = 12,360 FT. = 2.34 MI.

*John P. Marhouf*  
Signed *John P. Marhouf, P.E.* IL Lic. No. 62054958 Expires 11-30-2013  
Date 4/20/2012 For drawings thru

*Jeffrey R. Stanko*  
Signed *JEFFREY R. STANKO, P.E.* IL Lic. No. 062-060033 Expires 11-30-2013  
Date 4/20/2012 For drawings thru

*Richard A. Young*  
Signed *Richard A. Young, P.E.* IL Lic. No. 062-084805 Expires 11-30-2013  
Date 4/20/2012 For drawings thru

**TYLIN INTERNATIONAL**  
200 SOUTH WACKER DRIVE, SUITE 1400  
CHICAGO, ILLINOIS 60606  
TEL: 312-777-2900 FAX: 312-705-0305

**PRINTED BY THE AUTHORITY OF THE STATE OF ILLINOIS**

PROJECT MANAGER: HELEN PAZON (847) 705-4523

CONTRACT NO. 60M57

Rev