

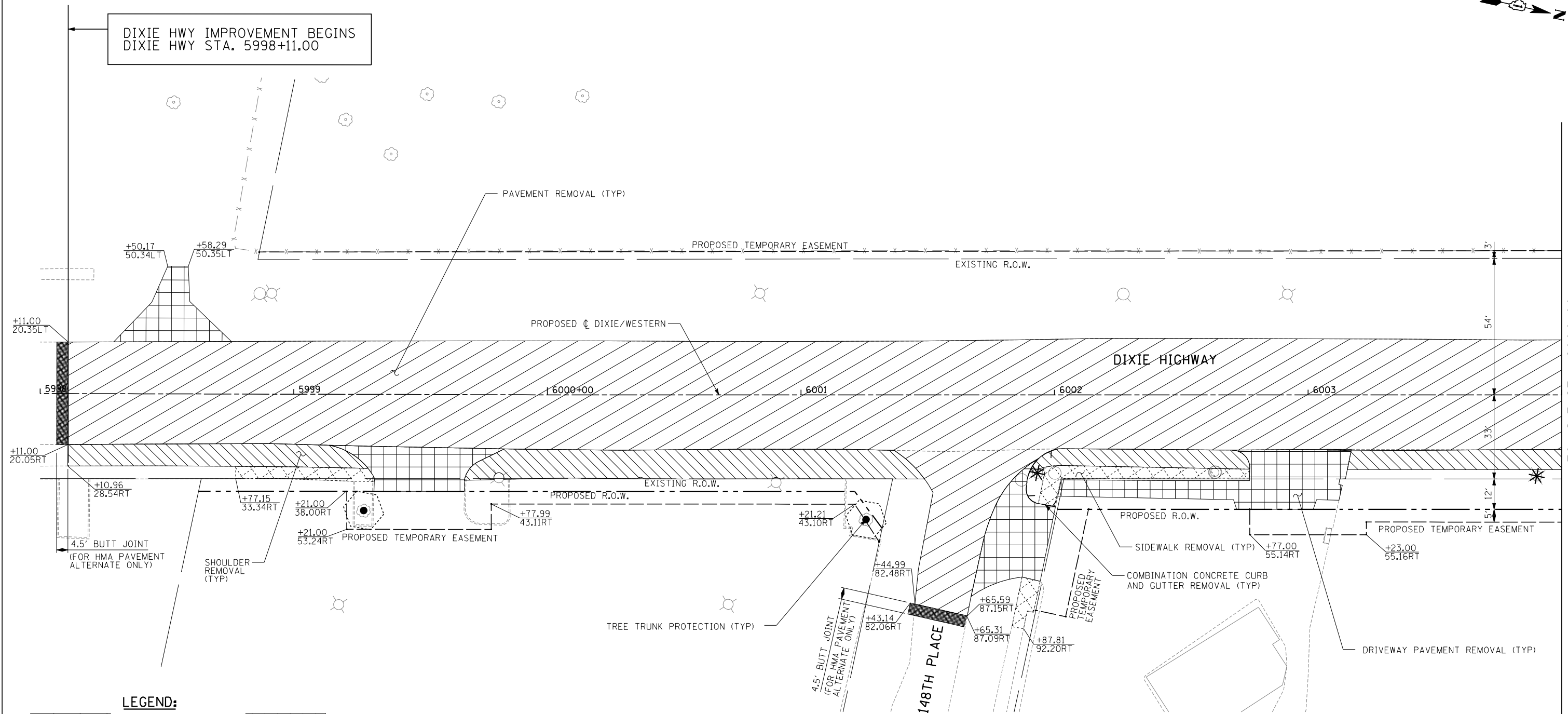

DIXIE HWY IMPROVEMENT BEGINS
DIXIE HWY STA. 5998+11.00



MATCHLINE STA. 6004+00

LEGEND:

- | | | | |
|--|-------------------------------------|--|---|
| | PAVEMENT REMOVAL | | DRIVEWAY PAVEMENT REMOVAL |
| | PAVEMENT PATCHING, CLASS D, TYPE IV | | HMA SURFACE REMOVAL |
| | MEDIAN REMOVAL | | TREE REMOVAL (UNITS) (NO UNIT SHOWN = <6) |
| | MEDIAN SURFACE REMOVAL | | TREE TRUNK PROTECTION |
| | SIDEWALK REMOVAL | | LIGHT POLE AND FOUNDATION REMOVAL (SEE ROADWAY LIGHTING & SURVEILLANCE PLANS) |
| | PAVED SHOULDER REMOVAL | | CHAIN LINK FENCE REMOVAL |
| | | | COMB CONC CURB & GUTTER REMOVAL |

NOTE: SEE EXISTING DRAINAGE AND REMOVAL PLANS FOR ADDITIONAL UTILITY STRUCTURE REMOVALS AND ADJUSTMENTS.

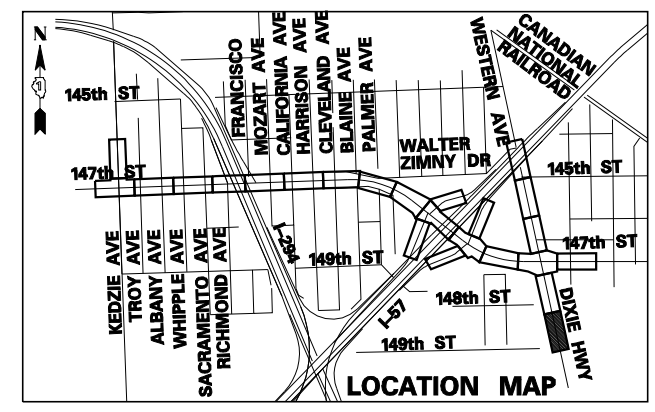
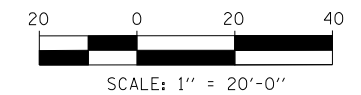

| | | | | | | | | | | | |
|--|------------|-----------|---|---|---------------------------|---|---------|-----------------------|--------------|-----------|----|
| TYLIN INTERNATIONAL USER NAME = PLOT SCALE = PLOT DATE = | DESIGNED - | REVISED - | STATE OF ILLINOIS DEPARTMENT OF TRANSPORTATION | 147TH STREET PROJECT REMOVAL PLANS - DIXIE HWY/WESTERN AVE | | F.A.I. RTE. | SECTION | COUNTY | TOTAL SHEETS | SHEET NO. | |
| | DRAWN - | REVISED - | | SCALE: 1"=20' | SHEET NO. 15 OF 20 SHEETS | STA. 5998+00 TO STA. 6004+00 | XX | (0405-1 & 0506-2) R-1 | COOK | 577 | 51 |
| | CHECKED - | REVISED - | | | | | | CONTRACT NO. 60M57 | | | |
| DATE - 5/23/2012 | REVISED - | | | | | FED. ROAD DIST. NO. ILLINOIS FED. AID PROJECT | | | | | |