

147TH ST IMPROVEMENT BEGINS
147TH STA. 1004+21.14

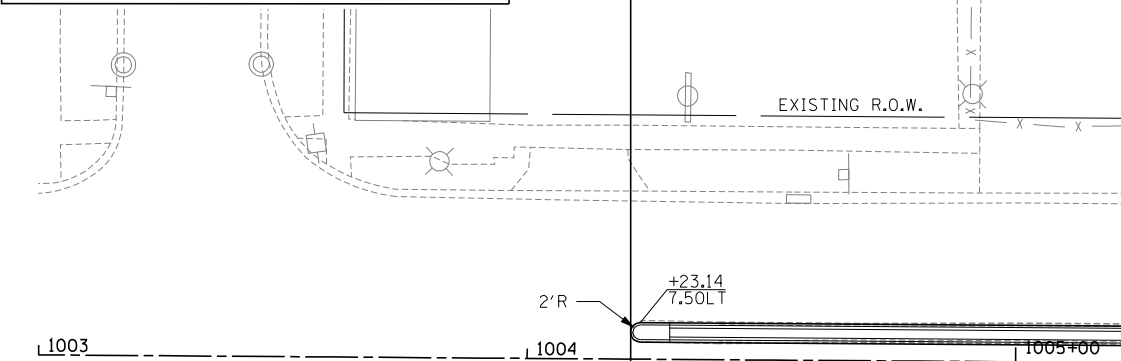

147TH STREET

KEDZIE AVE PAVEMENT

- 10" PORTLAND CEMENT CONCRETE (JOINTED)
- 12" AGGREGATE SUBGRADE

147TH STREET (IL-83) PAVEMENT ALTERNATES

HOT-MIX ASPHALT PAVEMENT ALTERNATE	PCC PAVEMENT ALTERNATE
- 2" POLYMERIZED HOT-MIX ASPHALT SURFACE COURSE, STONE MATRIX ASPHALT, N80	- 9 1/4" PORTLAND CEMENT CONCRETE (JOINTED)
- 2" POLYMERIZED HOT-MIX ASPHALT BINDER COURSE, STONE MATRIX ASPHALT, N80	- 4 1/2" STABILIZED SUBBASE - HOT-MIX ASPHALT
- 6 1/2" HOT-MIX ASPHALT BINDER COURSE, IL-19.0, N90 (PAID FOR AS HMA BASE COURSE, 6 1/2")	- 12" AGGREGATE SUBGRADE
- 12" AGGREGATE SUBGRADE	

- NOTES**
1. STATION, OFFSET, AND RADIUS CALLOUTS REFER TO EDGE OF PAVEMENT, UNLESS OTHERWISE NOTED.
 2. C.E./P.E. INDICATES DRIVEWAY ENTRANCE. SEE DRIVEWAY LAYOUT SHEET FOR DIMENSION DETAILS.
 3. SEE INTERSECTION DETAILS - 147TH ST AND KEDZIE AVE FOR MORE LAYOUT INFORMATION.

MATCHLINE STA. 5010+00.00

SEE SHEET 24
MATCHLINE STA. 5013+50.00

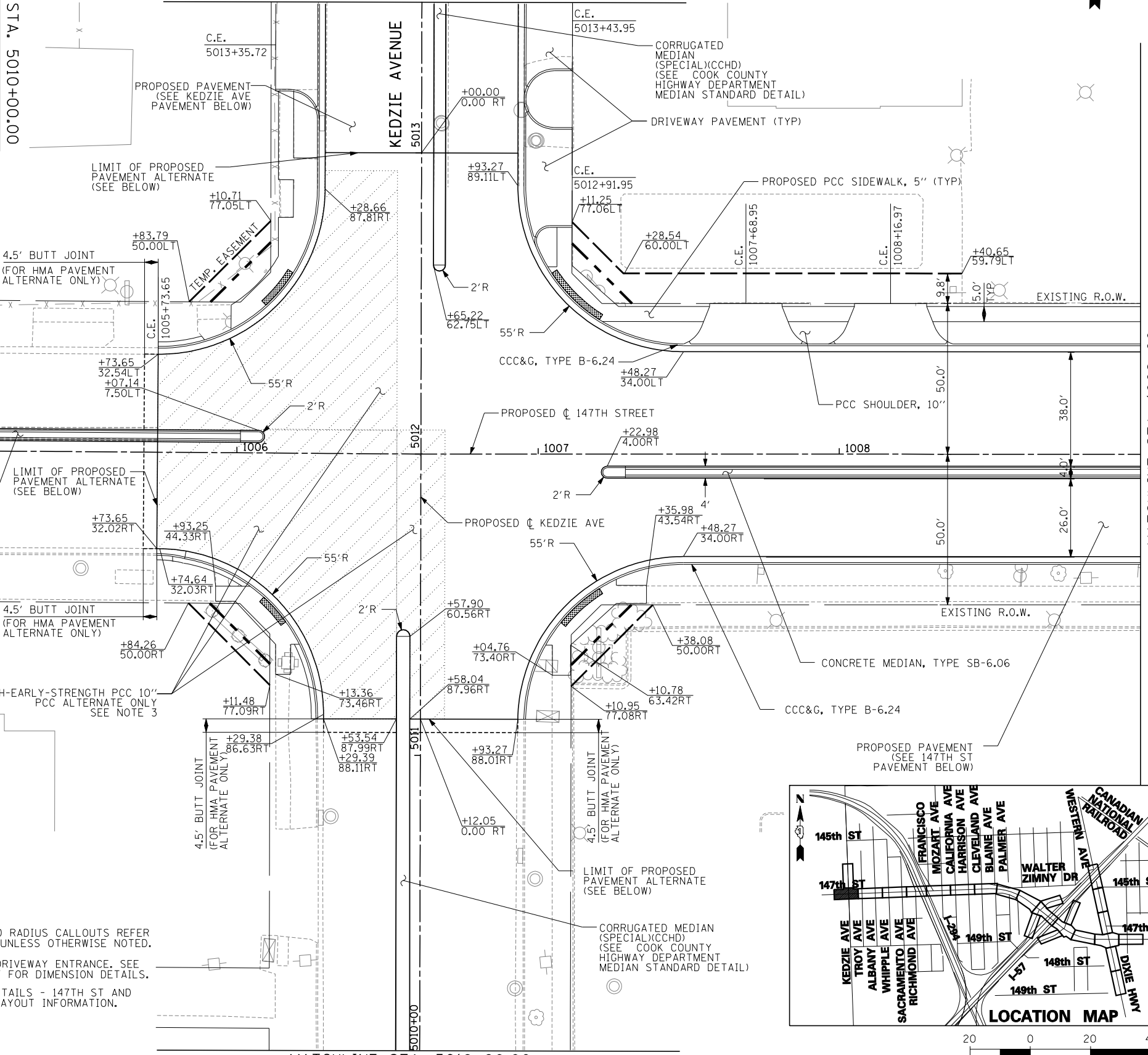

MATCHLINE STA. 5010+00.00
SEE ABOVE

MATCHLINE STA. 1009+00

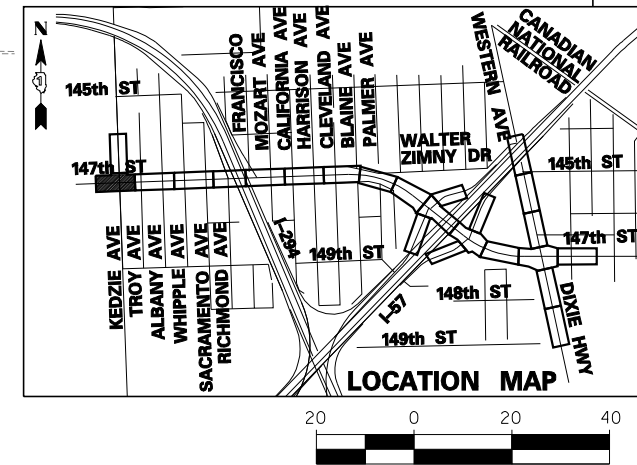

SCALE: 1" = 20'-0"

TYLIN INTERNATIONAL USER NAME = PLOT SCALE = PLOT DATE =	DESIGNED - DM	REVISED -	STATE OF ILLINOIS DEPARTMENT OF TRANSPORTATION	147TH STREET PROJECT PROPOSED PLANS - 147TH STREET		F.A.I. RTE.	SECTION	COUNTY	TOTAL SHEETS	SHEET NO.	
	DRAWN - DM	REVISED -		SCALE: 1"=20'	SHEET NO. 1 OF 25 SHEETS	STA. 1003+00 TO STA. 1009+00	XX	(0405-1 & 0506-2) R-1	COOK	577	57
	CHECKED - JPM	REVISED -					CONTRACT NO. 60M57				
DATE - 5/23/2012	REVISED -						FED. ROAD DIST. NO.	ILLINOIS	FED. AID PROJECT		