

STAGE 1: DIXIE/WESTERN: STA. 5889+11 TO STA. 6006+00
AD - AD

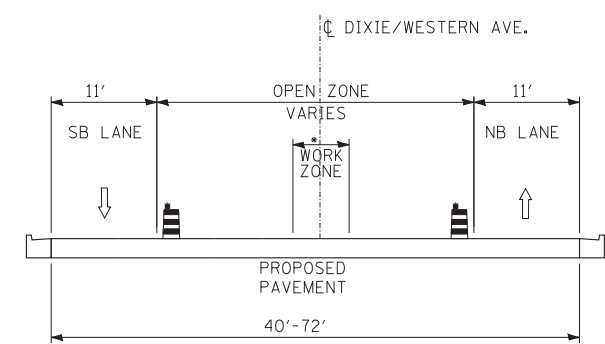

STAGE 3: DIXIE/WESTERN: STA. 5889+11 TO STA. 6005+66
OD - OD
•WORK ZONE VARIES IN WIDTH FROM 8.3' - 12' BETWEEN STA. 5998+11 TO STA. 5998+85

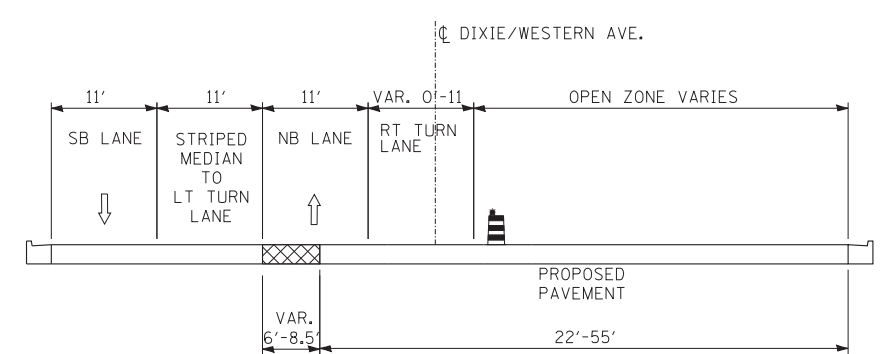

STAGES 2B & 2C: DIXIE/WESTERN: STA. 6005+66 TO STA. 6010+60
MD - MD

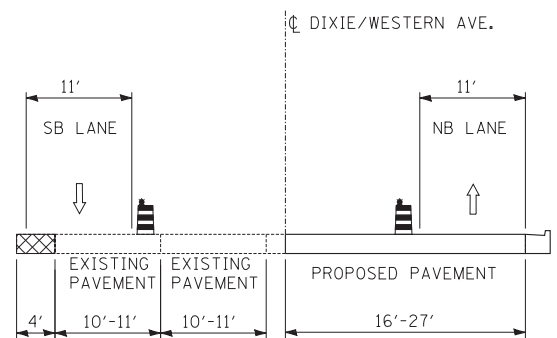

STAGE 1A: DIXIE/WESTERN: STA. 5889+11 TO STA. 6005+66
ED - ED

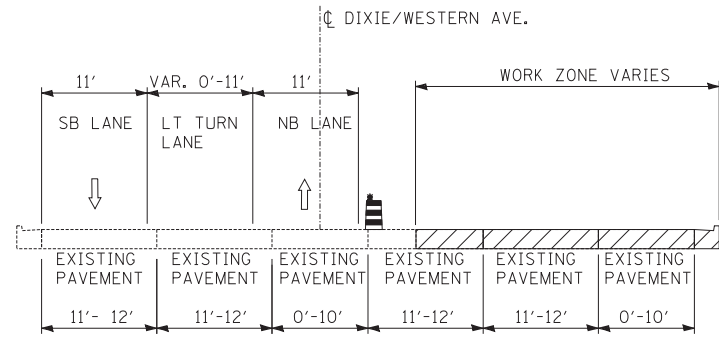

STAGE 1: DIXIE/WESTERN: STA. 6006+00 TO STA. 6011+27
BD - BD

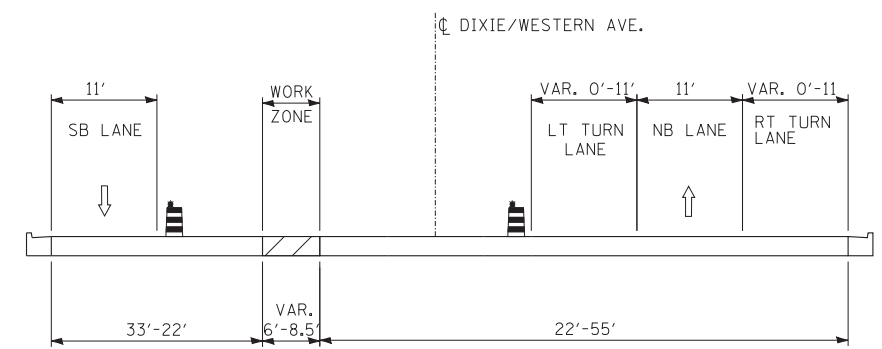

STAGE 3: DIXIE/WESTERN: STA. 6005+66 TO STA. 6011+35
PD - PD

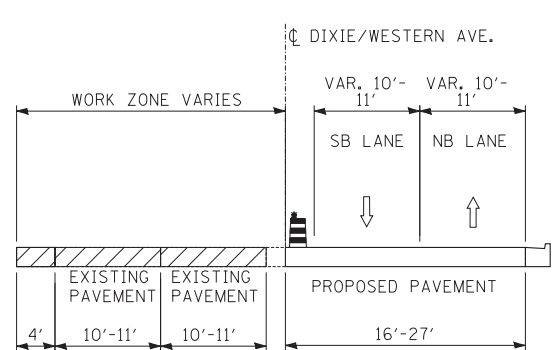

STAGES 1B, 2, & 2A: DIXIE/WESTERN: STA. 5889+11 TO STA. 6005+66
HD - HD

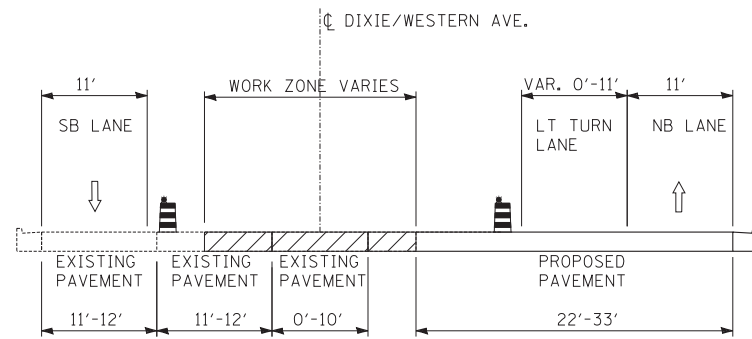

STAGE 1A: DIXIE/WESTERN: STA. 6005+66 TO STA. 6011+50
FD - FD

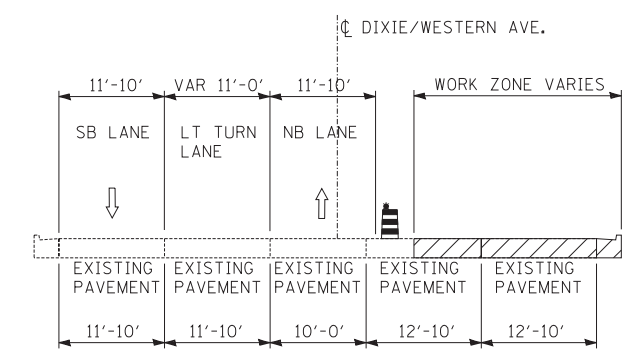

STAGE 1: DIXIE/WESTERN: STA. 6013+63 TO STA. 6027+50
CD - CD

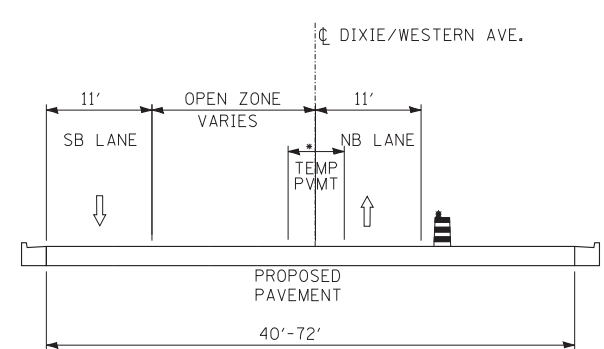

STAGES 2B & 2C: DIXIE/WESTERN: STA. 5889+11 TO STA. 6005+66
LD - LD
•TEMPORARY PAVEMENT 6' WIDE BETWEEN STA. 5998+11 TO STA. 5998+85

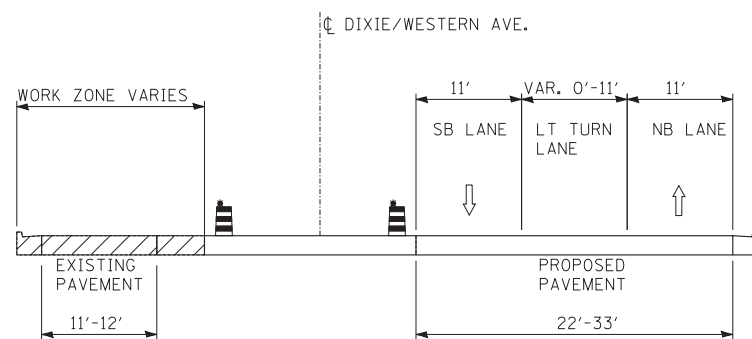

STAGES 1B, 2 & 2A: DIXIE/WESTERN: STA. 6005+66 TO STA. 6011+50
ID - ID

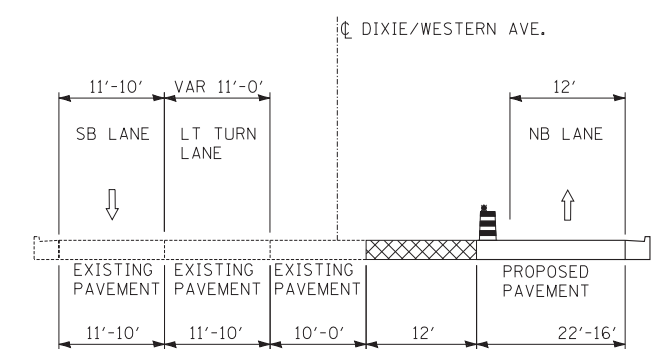

STAGE 1A: DIXIE/WESTERN: STA. 6013+63 TO STA. 6027+50
GD - GD

- LEGEND**
- TRAFFIC MOVEMENT
 - TEMPORARY CONCRETE BARRIER (WITH MONO-DIRECTIONAL PRISMATIC REFLECTORS ON TOP AND SIDE FACING TRAFFIC)
 - WORK ZONE
 - TEMPORARY PAVEMENT
 - DRUM WITH MONO-DIRECTIONAL STEADY BURNING LIGHT

TYL INTERNATIONAL

USER NAME =	DESIGNED - JDU	REVISED -
PLOT SCALE =	DRAWN - JDU	REVISED -
PLOT DATE =	CHECKED - SES	REVISED -
	DATE - 5/23/2012	REVISED -

**STATE OF ILLINOIS
DEPARTMENT OF TRANSPORTATION**

**147TH STREET PROJECT
MAINTENANCE OF TRAFFIC - TYPICAL SECTIONS**

SCALE: N.T.S. SHEET NO. 1 OF 8 SHEETS STA. TO STA.

F.A.I. R.E. XX	SECTION (0405-1 & 0506-2) R-1	COUNTY COOK	TOTAL SHEETS 577	SHEET NO. 93
FED. ROAD DIST. NO. ILLINOIS FED. AID PROJECT			CONTRACT NO. 60M57	