

p:\602540(57-294)\road\p10_147th\P10_MOT_TYP_SHT04.dgn 9:00:53 AM

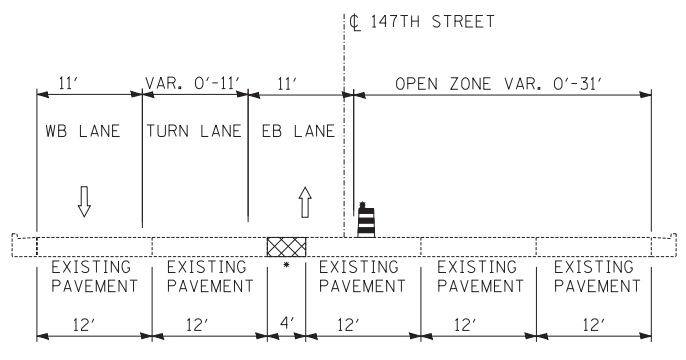

STAGES 1 & 1C: 147TH ST: STA. 1000+00 TO STA. 1006+00
A - A
• TEMPORARY PAVEMENT FROM STA. 1004+21 TO STA. 1006+11

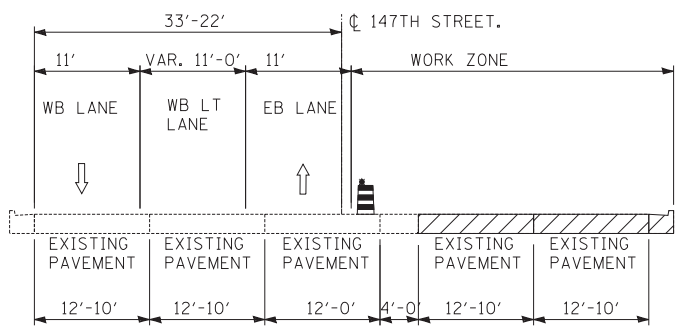

STAGES 1 & 1C: 147TH ST: STA. 1007+00 TO STA. 1013+00
B - B

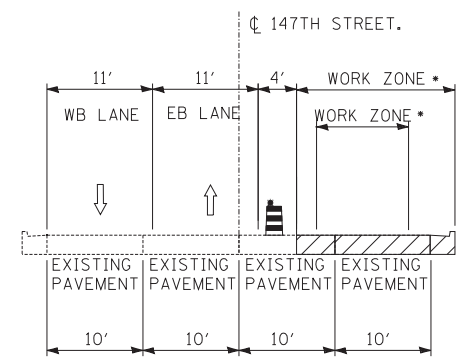

STAGES 1, 1A, 1B & 1C: 147TH ST: STA. 1013+40 TO STA. 1033+00
C - C
• WORK ZONE FROM STA. 1019+75 TO 1030+04 VARIES FROM 7' WIDE TO 9.66' FOR CONSTRUCTION OF THE PROPOSED STORM SEWER ONLY

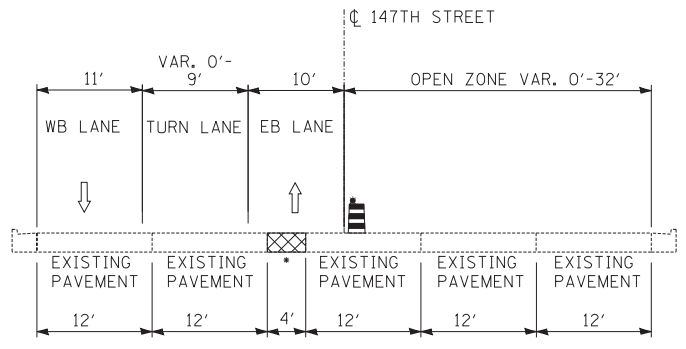

STAGES 1A, 1B: 147TH ST: STA. 1000+00 TO STA. 1006+00
J - J
• TEMPORARY PAVEMENT FROM STA. 1004+21 TO STA. 1006+11

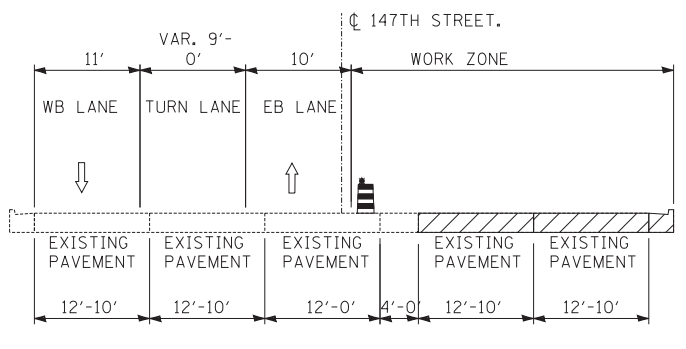

STAGES 1A, 1B: 147TH ST: STA. 1007+00 TO STA. 1013+00
K - K

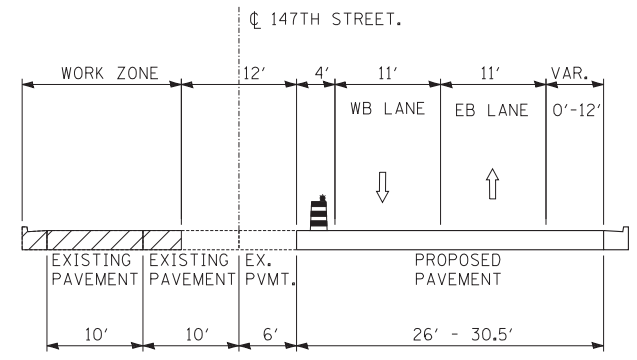

STAGES 2, 2A, 2B & 2C: 147TH ST: STA. 1013+40 TO STA. 1019+75
N - N

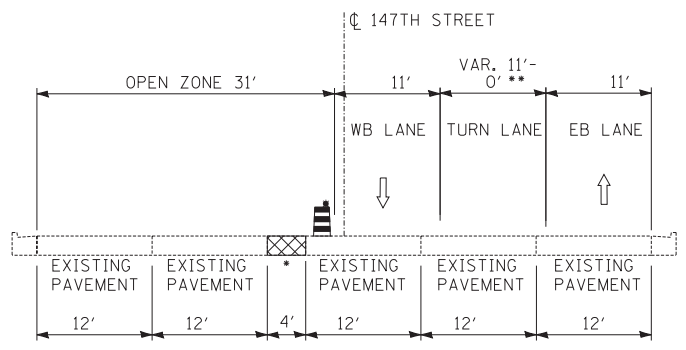

STAGES 2, 2A, 2B & 2C: 147TH ST: STA. 1000+00 TO STA. 1006+00
L - L
• TEMPORARY PAVEMENT FROM STA. 1004+21 TO STA. 1006+11
•• STAGE 2A: TURN LANE VARIES 0'-9' WIDE

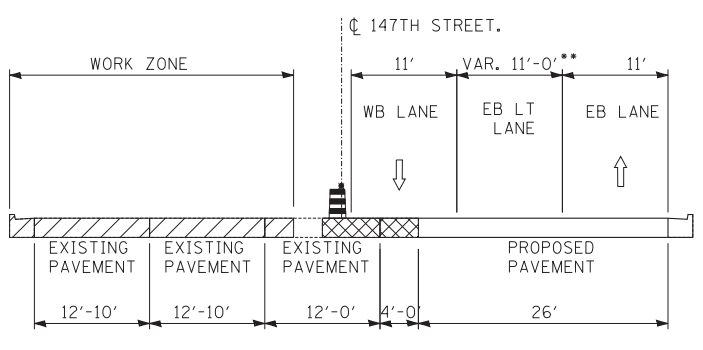

STAGES 2, 2A, 2B & 2C: 147TH ST: STA. 1007+00 TO STA. 1013+00
M - M
•• STAGE 2A: TURN LANE VARIES 9'-0' WIDE

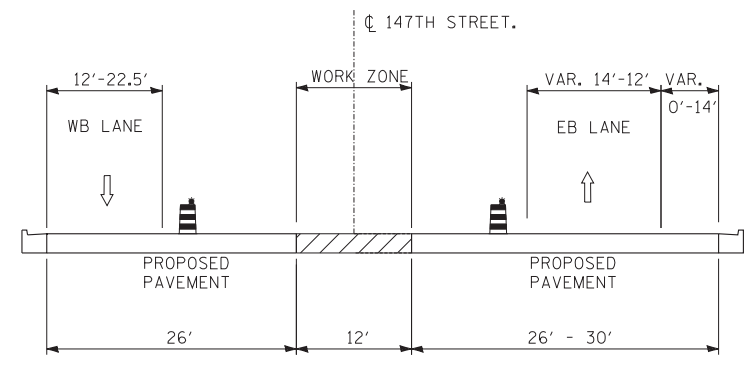

STAGE 3, 3A & 3B: STA. 1016+75 TO STA. 1019+75
CC - CC

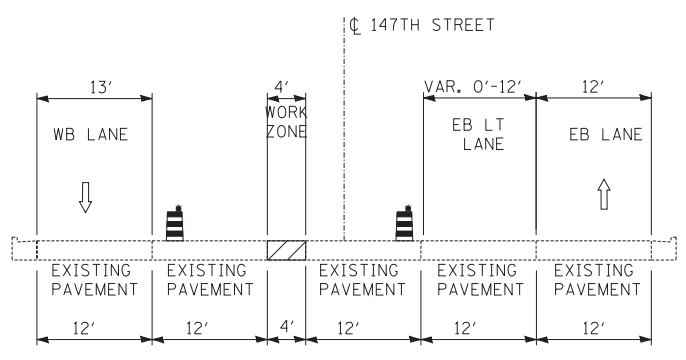

STAGES 3, 3A & 3B: 147TH ST: STA. 1000+00 TO STA. 1006+00
AA - AA

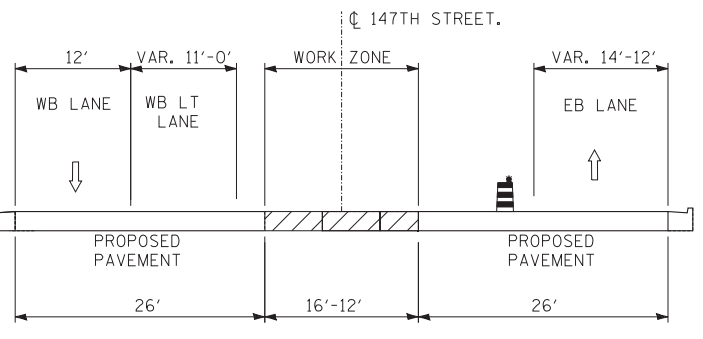

STAGES 3, 3A & 3B: STA. 1007+00 TO STA. 1016+43
BB - BB

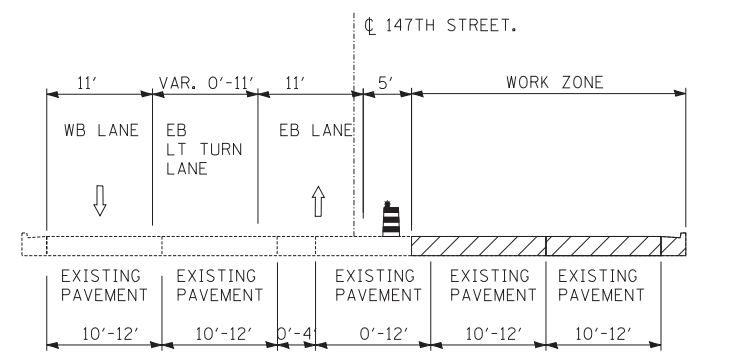

STAGES 1, 1A, 1B & 1C: 147TH ST: STA. 1033+60 TO STA. 1036+30
D - D

- LEGEND**
- TRAFFIC MOVEMENT
 - TEMPORARY CONCRETE BARRIER (WITH MONO-DIRECTIONAL PRISMATIC REFLECTORS ON TOP AND SIDE FACING TRAFFIC)
 - WORK ZONE
 - TEMPORARY PAVEMENT
 - DRUM WITH MONO-DIRECTIONAL STEADY BURNING LIGHT

TYLIN INTERNATIONAL

USER NAME =	DESIGNED - JDU	REVISED -
PLOT SCALE =	DRAWN - JDU	REVISED -
PLOT DATE =	CHECKED - SES	REVISED -
	DATE - 5/23/2012	REVISED -

**STATE OF ILLINOIS
DEPARTMENT OF TRANSPORTATION**

**147TH STREET PROJECT
MAINTENANCE OF TRAFFIC - TYPICAL SECTIONS**

SCALE: N.T.S.	SHEET NO. 4 OF 8 SHEETS	STA. TO STA.
---------------	-------------------------	--------------

F.A.I. RTE.	SECTION	COUNTY	TOTAL SHEETS	SHEET NO.
XX	(0405-1 & 0506-2) R-1	COOK	577	96
FED. ROAD DIST. NO.			ILLINOIS FED. AID PROJECT	
			CONTRACT NO. 60M57	