

STAGE 1 RAMP F: I-57 SB ENTRANCE RAMP FROM 147TH ST.

F1 - F1

NOTE: WORK ZONE FROM STA. 5200+15 TO STA. 5201+10

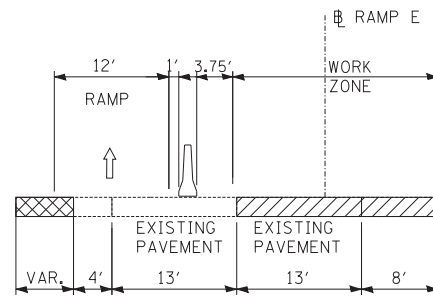

STAGE 1 RAMP E: I-57 SB EXIT RAMP TO 147TH ST.

E1 - E1

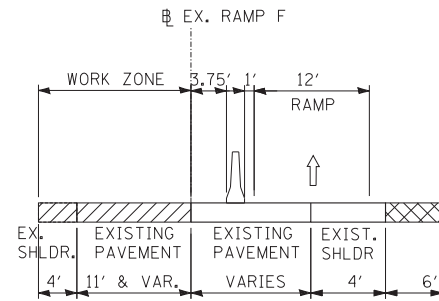

STAGE 1A RAMP F: I-57 SB ENTRANCE RAMP FROM 147TH ST.

F2 - F2

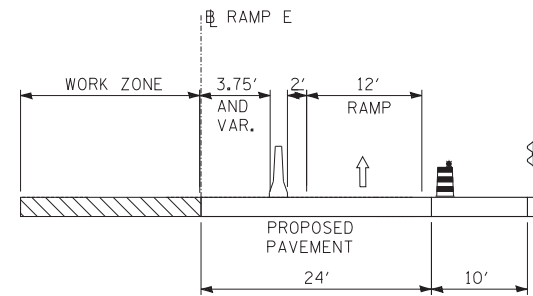

STAGE 2: RAMP E: I-57 SB EXIT RAMP TO 147TH ST.

E2 - E2

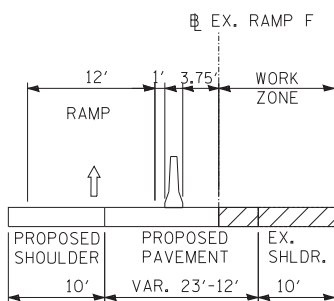

STAGE 2 RAMP F: I-57 SB ENTRANCE RAMP FROM 147TH ST.

F3 - F3

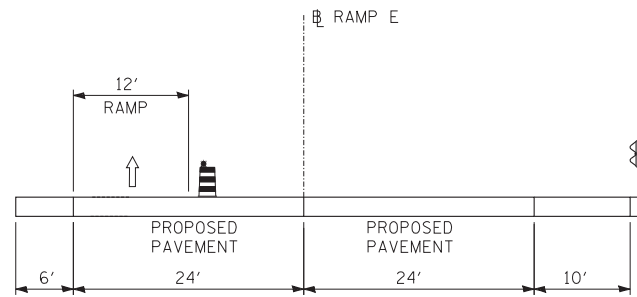

STAGE 2A: RAMP E: I-57 SB EXIT RAMP TO 147TH ST.

E3 - E3

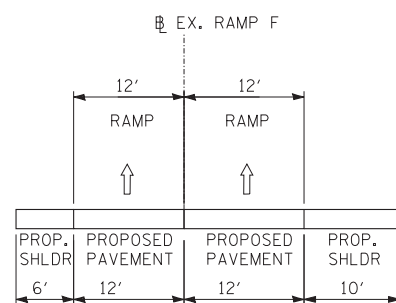

STAGE 3 RAMP F: I-57 SB ENTRANCE RAMP FROM 147TH ST.

F4 - F4

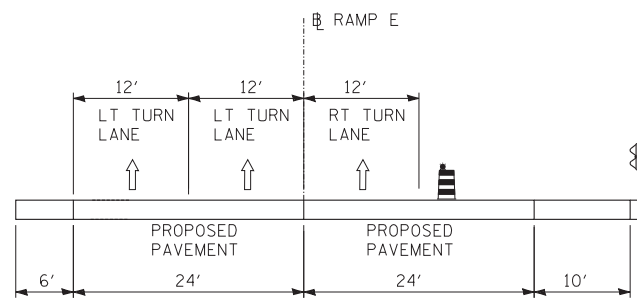

STAGE 3: RAMP E: I-57 SB EXIT RAMP TO 147TH ST.

E4 - E4

IDOT HOT-MIX ASPHALT MIXTURE REQUIREMENTS

ITEM	AIR VOIDS
TEMPORARY PAVEMENT (HMA OPTION)	
HOT-MIX ASPHALT SURFACE COURSE, MIX "D", N70 (IL-9.5mm) (2")	4%±50 Gyr
HOT-MIX ASPHALT BINDER COURSE, IL-19.0, N70 (8")	4%±50 Gyr

THE UNIT WEIGHT USED TO CALCULATE ALL HMA SURFACE MIXTURE QUANTITIES IS 112 LB/SQ YD/IN.

PC CONCRETE TEMPORARY PAVEMENT SHALL CONSIST OF CLASS PV CONCRETE MEETING THE REQUIREMENTS OF ART. 1020 OF THE STANDARD SPECIFICATIONS.

LEGEND

- TRAFFIC MOVEMENT
- TEMPORARY CONCRETE BARRIER (WITH MONO-DIRECTIONAL PRISMATIC REFLECTORS ON TOP AND SIDE FACING TRAFFIC)
- WORK ZONE
- TEMPORARY PAVEMENT
- DRUM WITH MONO-DIRECTIONAL STEADY BURNING LIGHT

TYLIN INTERNATIONAL

USER NAME =	DESIGNED - JDU	REVISED -
	DRAWN - JDU	REVISED -
PLOT SCALE =	CHECKED - SES	REVISED -
PLOT DATE =	DATE - 5/23/2012	REVISED -

STATE OF ILLINOIS
DEPARTMENT OF TRANSPORTATION

147TH STREET PROJECT
MAINTENANCE OF TRAFFIC - TYPICAL SECTIONS

SCALE: N.T.S. SHEET NO. 8 OF 8 SHEETS STA. TO STA.

F.A.I. RTE.	SECTION	COUNTY	TOTAL SHEETS	SHEET NO.
XX	(0405-1 & 0506-2) R-1	COOK	577	100
FED. ROAD DIST. NO.			ILLINOIS FED. AID PROJECT	
			CONTRACT NO. 60M57	