

MATCHLINE STA. 5015+00

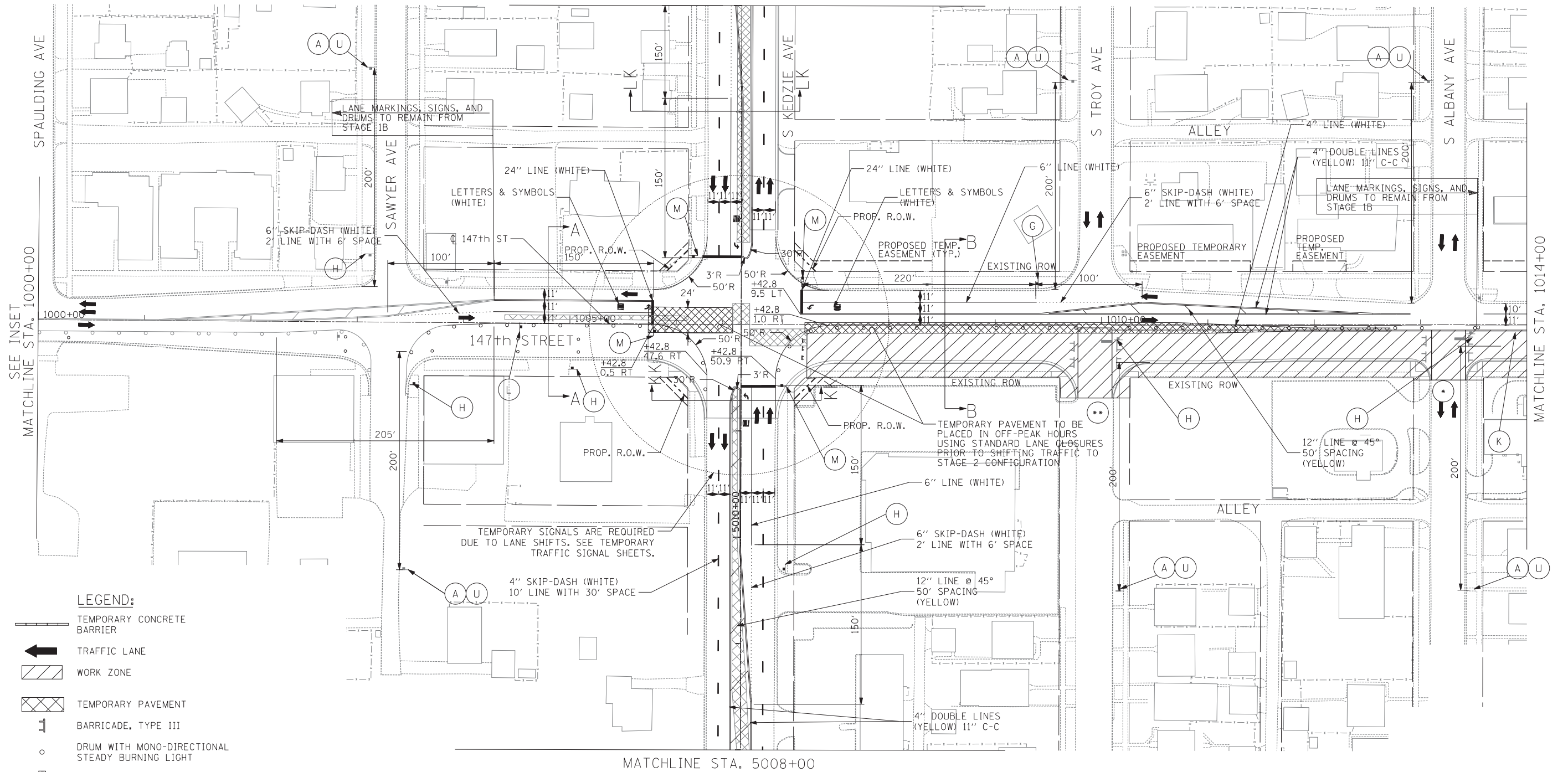

MATCHLINE STA. 5008+00

SEE INSET
MATCHLINE STA. 1000+00

MATCHLINE STA. 1014+00

LEGEND:

- TEMPORARY CONCRETE BARRIER
- TRAFFIC LANE
- WORK ZONE
- TEMPORARY PAVEMENT
- BARRICADE, TYPE III
- DRUM WITH MONO-DIRECTIONAL STEADY BURNING LIGHT
- ARROW BOARD

TEMPORARY SIGNALS ARE REQUIRED DUE TO LANE SHIFTS. SEE TEMPORARY TRAFFIC SIGNAL SHEETS.

TEMPORARY PAVEMENT TO BE PLACED IN OFF-PEAK HOURS USING STANDARD LANE CLOSURES PRIOR TO SHIFTING TRAFFIC TO STAGE 2 CONFIGURATION

NOTES

- CLOSURE TIME LIMITED TO 2 WEEKS. COORDINATE CLOSURE BETWEEN WHIPPLE AVE. AND ALBANY AVE. ONE STREET MUST REMAIN OPEN AT ALL TIMES.
- CLOSURE TIME LIMITED TO 2 WEEKS

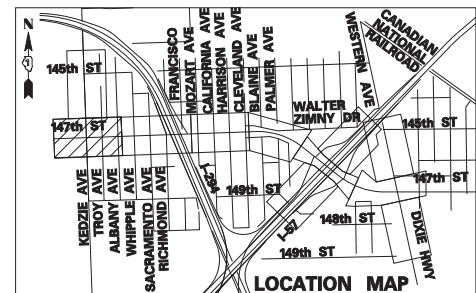
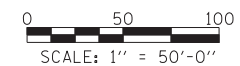

TYLIN INTERNATIONAL

USER NAME =	DESIGNED - DM	REVISED -
DRAWN - DM	REVISED -	
PLOT SCALE =	CHECKED - JPM	REVISED -
PLOT DATE =	DATE - 5/23/2012	REVISED -

**STATE OF ILLINOIS
DEPARTMENT OF TRANSPORTATION**

**147TH STREET PROJECT
MAINTENANCE OF TRAFFIC - 147TH ST. STAGE 1C**

SCALE: 1" = 50' SHEET NO. 1 OF 2 SHEETS STA. 1000+00 TO STA. 1014+00

F.A.I. RT.:	SECTION	COUNTY	TOTAL SHEETS	SHEET NO.
XX	(0405-1 & 0506-2) R-1	COOK	577	124
FED. ROAD DIST. NO.			CONTRACT NO. 60M57	
ILLINOIS FED. AID PROJECT				