

MULCH (METHOD 4) AND TEMP
EROSION CONTROL SEEDING (TYP.)
SEDIMENT CONTROL
SILT FENCE (TYP.)

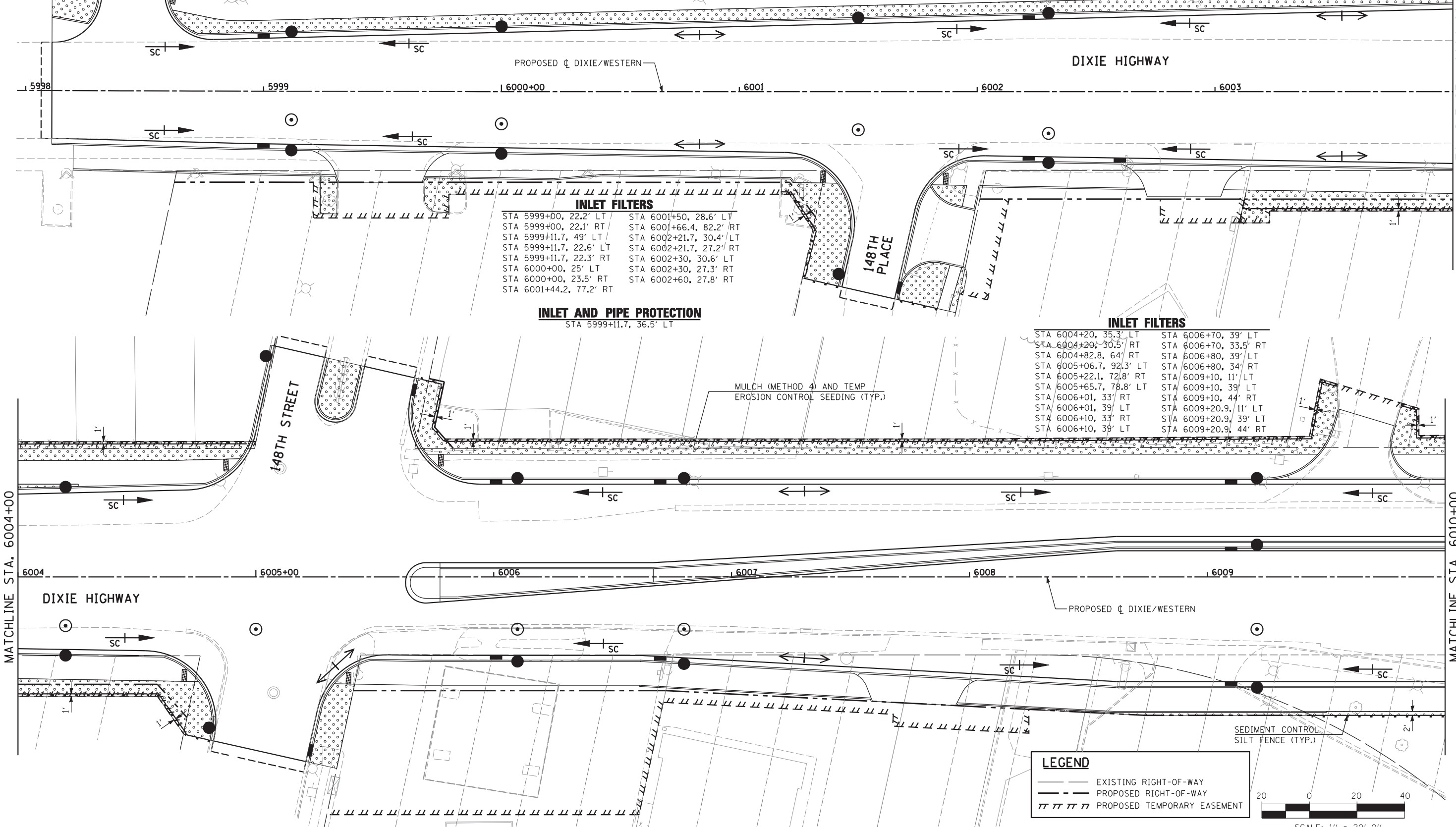

INLET FILTERS

STA 5999+00, 22.2' LT	STA 6001+50, 28.6' LT
STA 5999+00, 22.1' RT	STA 6001+66.4, 82.2' RT
STA 5999+11.7, 49' LT	STA 6002+21.7, 30.4' LT
STA 5999+11.7, 22.6' LT	STA 6002+21.7, 27.2' RT
STA 5999+11.7, 22.3' RT	STA 6002+30, 30.6' LT
STA 6000+00, 25' LT	STA 6002+30, 27.3' RT
STA 6000+00, 23.5' RT	STA 6002+60, 27.8' RT
STA 6001+44.2, 77.2' RT	

INLET AND PIPE PROTECTION
STA 5999+11.7, 36.5' LT

INLET FILTERS

STA 6004+20, 35.3' LT	STA 6006+70, 39' LT
STA 6004+20, 30.5' RT	STA 6006+70, 33.5' RT
STA 6004+82.8, 64' RT	STA 6006+80, 39' LT
STA 6005+06.7, 92.3' LT	STA 6006+80, 34' RT
STA 6005+22.1, 72.8' RT	STA 6009+10, 11' LT
STA 6005+65.7, 78.8' LT	STA 6009+10, 39' LT
STA 6006+01, 33' RT	STA 6009+10, 44' RT
STA 6006+01, 39' LT	STA 6009+20.9, 11' LT
STA 6006+10, 33' RT	STA 6009+20.9, 39' LT
STA 6006+10, 39' LT	STA 6009+20.9, 44' RT

LEGEND

- EXISTING RIGHT-OF-WAY
- - - PROPOSED RIGHT-OF-WAY
- ||||| PROPOSED TEMPORARY EASEMENT

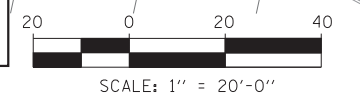

USER NAME =	DESIGNED - JRS	REVISED - JRS 12/01/2011
	DRAWN - MJF	REVISED - JRS 02/15/2012
PLOT SCALE =	CHECKED - APS	REVISED - JRS 05/04/2012
PLOT DATE	DATE - 7/22/2011	REVISED -

**STATE OF ILLINOIS
DEPARTMENT OF TRANSPORTATION**

**147TH STREET PROJECT
EROSION CONTROL PLAN - DIXIE HWY**

SCALE: 1"=20' SHEET NO. 14 OF 22 SHEETS STA. 5998+00 TO STA. 6010+00

F.A.I. RTE.	SECTION	COUNTY	TOTAL SHEETS	SHEET NO.
57	(0405-1 & 0506-2) R-1	COOK	577	186
FED. ROAD DIST. NO. ILLINOIS FED. AID PROJECT			CONTRACT NO. 60M57	