

DATE	
BY	
SURVEYED	
PLOTTED	
TEMPLATE	
AREAS	
CHECKED	
FINAL SURVEY	
NOTE BOOK	
NO.	

DATE	
BY	
SURVEYED	
PLOTTED	
TEMPLATE	
AREAS	
CHECKED	
ORIGINAL SURVEY	
NOTE BOOK	
NO.	

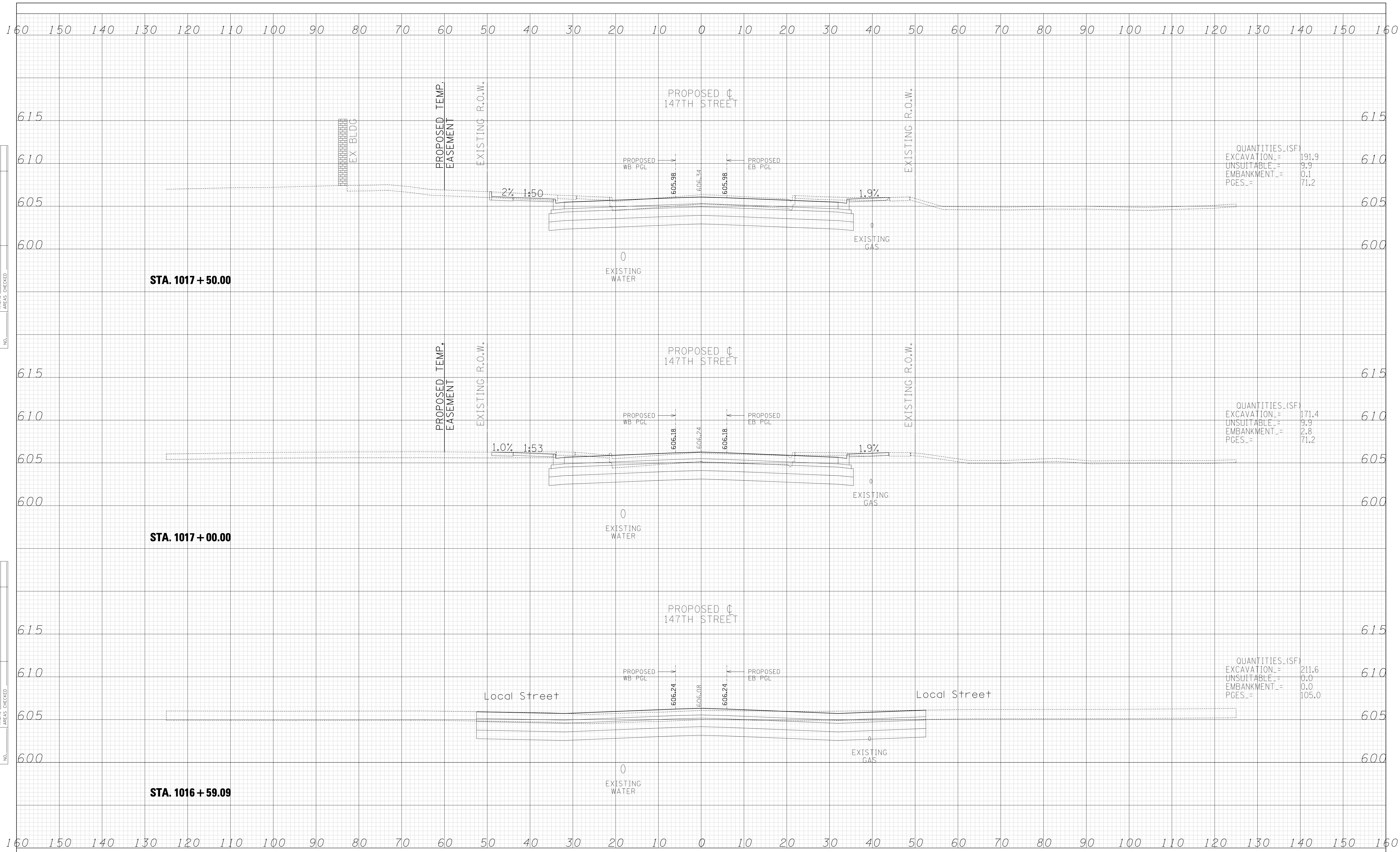

QUANTITIES (SF)

EXCAVATION	=	191.9
UNSUITABLE	=	9.9
EMBANKMENT	=	0.1
PGES	=	71.2

QUANTITIES (SF)

EXCAVATION	=	171.4
UNSUITABLE	=	9.9
EMBANKMENT	=	2.8
PGES	=	71.2

QUANTITIES (SF)

EXCAVATION	=	211.6
UNSUITABLE	=	0.0
EMBANKMENT	=	0.0
PGES	=	105.0

TYLIN INTERNATIONAL

USER NAME	=		DESIGNED	-	JPM	REVISED	-	
			DRAWN	-	JDF	REVISED	-	
PLOT SCALE	=		CHECKED	-	JPM	REVISED	-	
PLOT DATE	=		DATE	-	2/24/2012	REVISED	-	

**STATE OF ILLINOIS
DEPARTMENT OF TRANSPORTATION**

**I-294 AT I-57 INTERCHANGE PROJECT
PROPOSED 147TH STREET CROSS SECTIONS**

SCALE: 1" = 10' V, 1" = 100' H SHEET NO. OF SHEETS STA. 1016+59.09 TO STA. 1017+50.00

F.A. RTE.	SECTION	COUNTY	TOTAL SHEETS	SHEET NO.
57	1414.2B	COOK	577	510
FED. ROAD DIST. NO.			ILLINOIS FED. AID PROJECT	
			CONTRACT NO. 60M57	