

FINAL SURVEY NO.	SURVEYED PLOTTED TEMPLATE AREAS CHECKED	BY	DATE

ORIGINAL SURVEY NO.	SURVEYED PLOTTED TEMPLATE AREAS CHECKED	BY	DATE

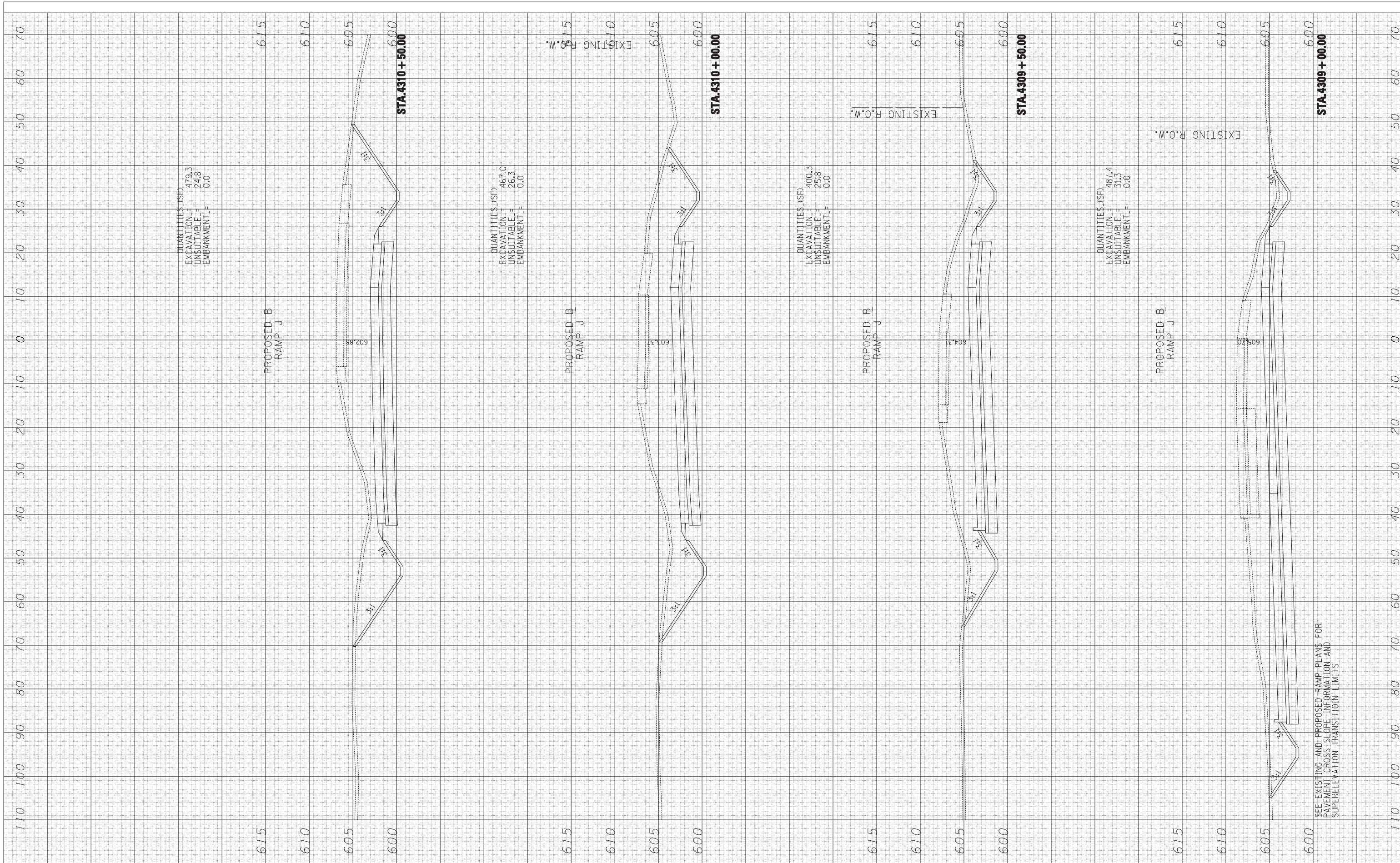

QUANTITIES (SF)  
 EXCAVATION = 479.3  
 UNSUITABLE = 24.8  
 EMBANKMENT = 0.0

QUANTITIES (SF)  
 EXCAVATION = 467.0  
 UNSUITABLE = 26.3  
 EMBANKMENT = 0.0

QUANTITIES (SF)  
 EXCAVATION = 400.3  
 UNSUITABLE = 25.8  
 EMBANKMENT = 0.0

QUANTITIES (SF)  
 EXCAVATION = 487.4  
 UNSUITABLE = 31.3  
 EMBANKMENT = 0.0

SEE EXISTING AND PROPOSED RAMP PLANS FOR PAVEMENT CROSS SLOPE INFORMATION AND SUPERELEVATION TRANSITION LIMITS

TYLIN INTERNATIONAL

USER NAME =	DESIGNED - JDF	REVISED -
PLOT SCALE =	DRAWN - JDF	REVISED -
PLOT DATE	CHECKED - JPM	REVISED -
	DATE - 6/19/2011	REVISED -

STATE OF ILLINOIS  
 DEPARTMENT OF TRANSPORTATION

147TH STREET PROJECT  
 PROPOSED RAMP J CROSS SECTIONS

SCALE: 1" = 10' V<sup>H</sup> SHEET NO. OF SHEETS STA. 4309+00.00 TO STA. 4310+50.00

F.A. RTE.	SECTION	COUNTY	TOTAL SHEETS	SHEET NO.
XX	(0405-1 & 0506-2) R-1	COOK	577	574
FED. ROAD DIST. NO.			CONTRACT NO. 60M57	
ILLINOIS FED. AID PROJECT				