

(IN FEET)
1 inch = 50 ft.

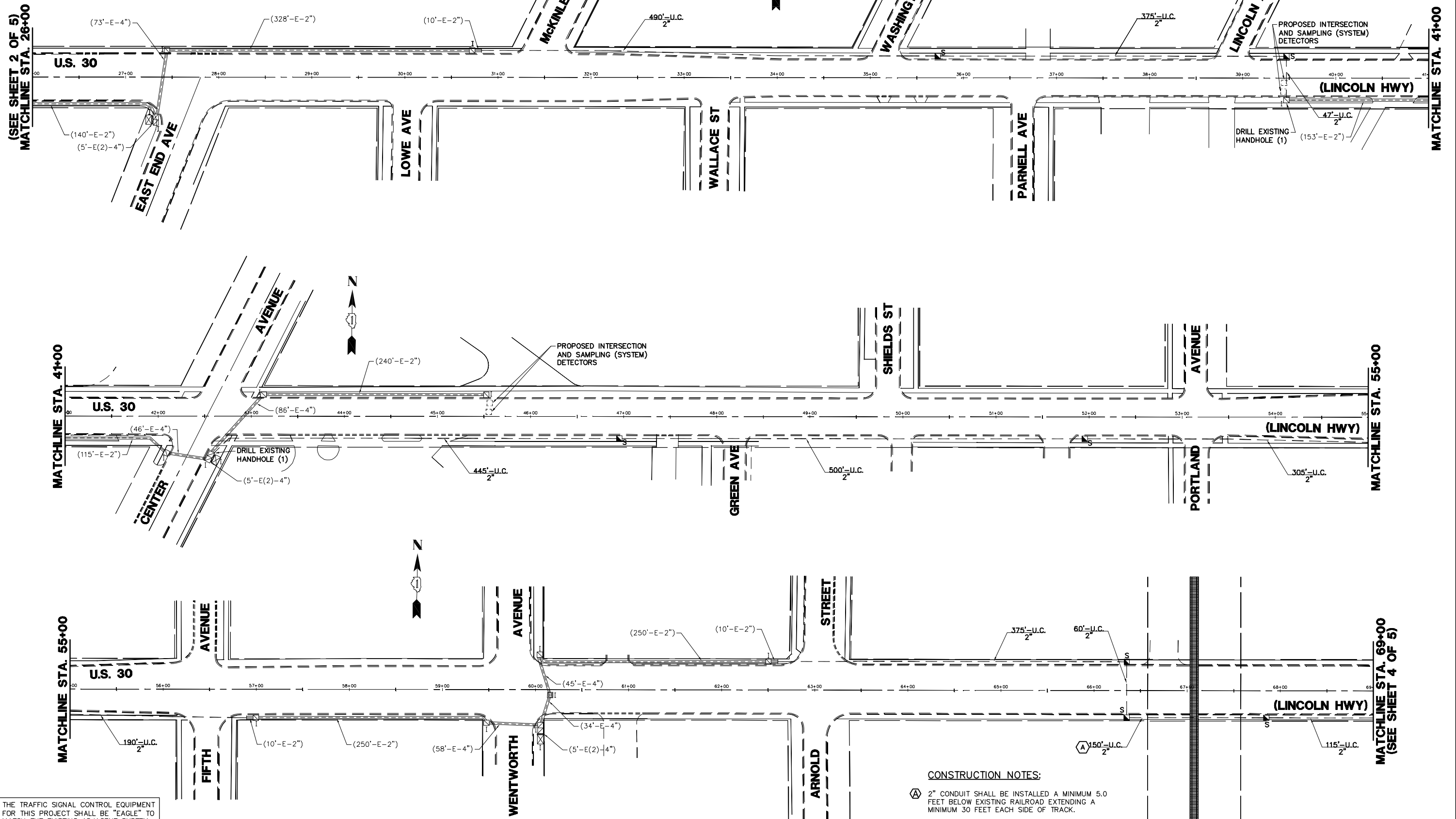

THE TRAFFIC SIGNAL CONTROL EQUIPMENT FOR THIS PROJECT SHALL BE "EAGLE" TO MATCH THE EXISTING ADJACENT SYSTEM.

CONSTRUCTION NOTES:
 (A) 2" CONDUIT SHALL BE INSTALLED A MINIMUM 5.0 FEET BELOW EXISTING RAILROAD EXTENDING A MINIMUM 30 FEET EACH SIDE OF TRACK.

FILE NAME = 4085.883-TR1.dwg	USER NAME = ZACH WALLSTEN	DESIGNED - JRD	REVISED -	STATE OF ILLINOIS DEPARTMENT OF TRANSPORTATION	INTERCONNECT PLAN (SHEET 3 OF 5)			FAP. RTE.	SECTION	COUNTY	TOTAL SHEETS	SHEET NO.
	PLOT SCALE = 1" = .0833'	DRAWN - ZCW	REVISED -					353	2012-038TS	COOK	43	38
PLOT DATE = 6/28/2012	CHECKED - KLB	DATE - 6/28/2012	REVISED -	SCALE: 1" = 50'			SHEET NO.	OF SHEETS	STA.	TO STA.	CONTRACT # 60186	
											ILLINOIS FED. AID PROJECT	