

09-21-12 LETTING ITEM 064

ROUTE	SECTION	COUNTY	TOTAL SHEETS	SHEET NUMBER
VARIOUS	2012-042-I	COOK	* 20	1

* 20 - 9 = 11

CONTRACT NO.: 60V31

D-91-009-12

FOR INDEX OF SHEETS SEE SHEET 2

STATE OF ILLINOIS
DEPARTMENT OF TRANSPORTATION
DIVISION OF HIGHWAYS
DISTRICT ONE

PROPOSED HIGHWAY PLANS

VARIOUS ROUTES
VARIOUS LOCATIONS (NEAR MIDWAY AIRPORT)
SECTION 2012-042-I
CURB AND GUTTER REPAIR
COOK COUNTY
C-91-538-12

IMPROVEMENTS ARE
LOCATED WITHIN THE CITY
OF CHICAGO

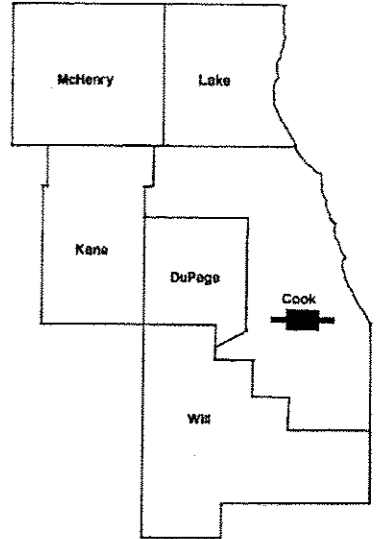

LOCATION OF IMPROVEMENT INDICATED THUS:

IMPROVEMENT
LOCATION

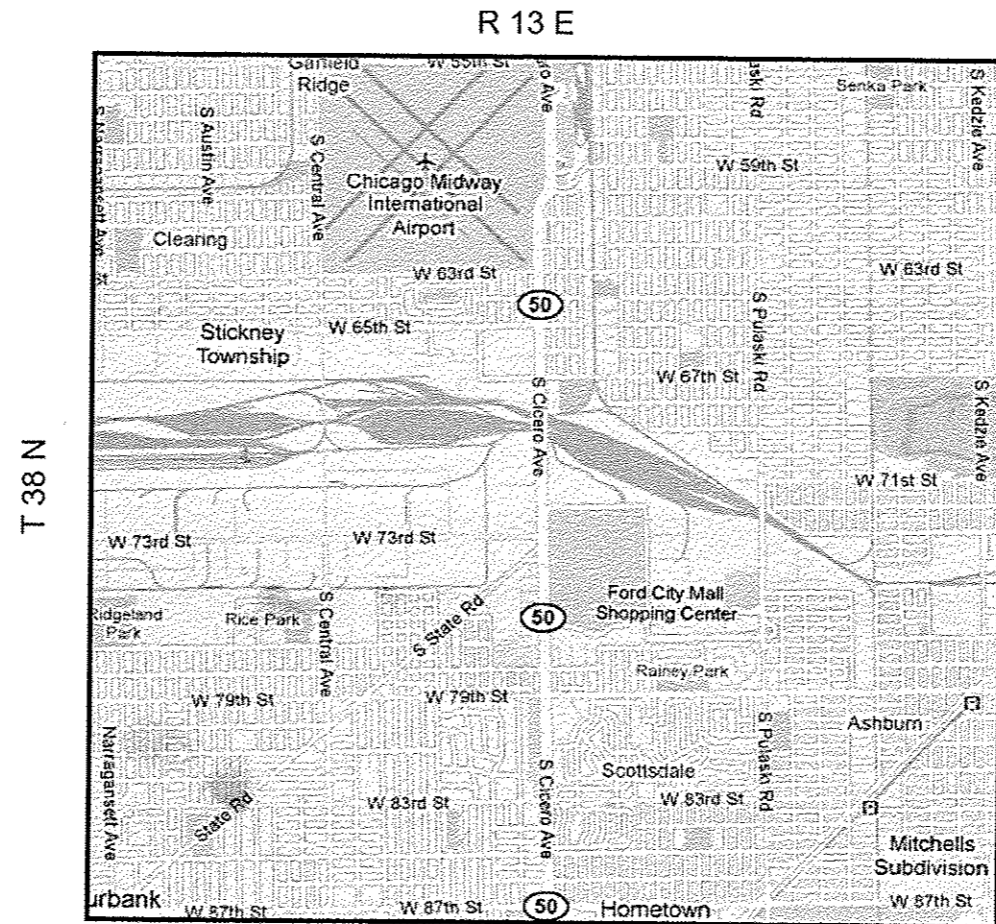

STATE OF ILLINOIS
DEPARTMENT OF TRANSPORTATION
DIVISION OF HIGHWAYS

SUBMITTED: JUNE 15, 2012

John P. ...
DEPUTY DIRECTOR OF HIGHWAYS, REGION ENGINEER

June 29 2012
John D. Baranzelli, P.E.
acting ENGINEER OF DESIGN AND ENVIRONMENT

June 29 2012
William R. Frayler
acting DIRECTOR OF HIGHWAYS, CHIEF ENGINEER

**PRINTED BY THE AUTHORITY
OF THE STATE OF ILLINOIS**

C.U.A.N.: CHICAGO UTILITY ALERT
NETWORK
(312) 744-7000

Plan Preparation Engineer: Issam Rayyan
Project Manager: Robert Boro (847)-705-4237
CONTRACT NO.60V31

LAKE TOWNSHIP

Rev. 7-23-12

ROUTE	SECTION	COUNTY	TOTAL SHEETS	SHEET NUMBER
VARIOUS	2012-042-1	COOK	20	2

CONTRACT NO.: 60V31

INDEX OF SHEETS

1. TITLE SHEET
2. INDEX OF SHEETS, STATE STANDARDS, GENERAL NOTES AND MIXTURE REQUIREMENTS
3. SUMMARY OF QUANTITIES
4. ^{6.}~~15.~~ SCHEDULE OF QUANTITIES
Delete Sheets 7.-15.
16. DETAIL CONCRETE DRIVEWAY
17. CURB AND GUTTER REMOVAL AND REPLACEMENT
18. CITY OF CHICAGO DETAILS FOR P.C. CONCRETE DRIVEWAY, ALLEY RETURN AND SIDEWALK
19. TRAFFIC CONTROL AND PROTECTION FOR SIDEROADS, INTERSECTIONS AND DRIVEWAYS (TC-10)
20. ARTERIAL ROAD INFORMATION SIGN (TC-22)

STATE STANDARDS

- 424001-06 PERPENDICULAR CURB RAMPS FOR SIDEWALKS
- 424021 DEPRESSED CORNER FOR SIDEWALKS
- 424026 ENTRANCE/ALLEY PEDESTRIAN CROSSING
- 701301-04 LANE CLOSURE, 2L, 2W, SHORT TIME OPERATIONS
- 701501-06 URBAN LANE CLOSURE, 2L, 2W, UNDIVIDED
- 701606-08 URBAN LANE CLOSURE WITH MOUNTABLE MEDIAN
- 701701-08 URBAN LANE CLOSURE MULTILANE INTERSECTION
- 701801-05 SIDEWALK, CORNER OR CROSSWALK CLOSURE
- 701901-02 TRAFFIC CONTROL DEVICES

MIXTURE REQUIREMENTS

MIXTURE TYPE	AIR VOIDS @ Ndes
HOT-MIX ASPHALT SURFACE COURSE MIX "D", N70 (IL 9.5 mm), (1.5-3.0 in)	4% @ 70 GYR.

- THE UNIT WEIGHT USED TO CALCULATE ALL HMA SURFACE MIXTURES IS 112 LBS/SQ YD/IN.
- THE AC TYPE FOR POLYMERIZED HMA MIXES SHALL BE SBS/SBR PG 76-22' AND FOR NON-POLYMERIZED HMA THE AC TYPE SHALL BE "PG 64-22" UNLESS MODIFIED BY DISTRICT ONE SPECIAL PROVISIONS. FOR "PERCENT OF RAP" SEE SPECIAL PROVISIONS.

GENERAL NOTES

BEFORE STARTING ANY EXCAVATION, THE CONTRACTOR SHALL CALL "C.U.A.N." (CHICAGO UTILITY ALERT NETWORK) AT (312)744-7000 FOR FIELD LOCATIONS OF BURIED ELECTRIC, TELEPHONE AND GAS UTILITIES. (48 HOUR NOTIFICATION IS REQUIRED).

THE CONTRACTOR WILL NOT BE ALLOWED TO SET UP A YARD OR FIELD OFFICE ON STATE PROPERTY WITHOUT WRITTEN PERMISSION FROM THE DEPARTMENT.

WHEN CONSTRUCTING SIDEWALK RAMPS FOR THE HANDICAPPED (STATE STANDARD 424001), USE TYPE B RAMPS UNLESS OTHERWISE SPECIFIED.

THESE PLANS HAVE BEEN PREPARED FROM NOTES RECEIVED FROM BUREAU OF MAINTENANCE.

THE COST OF HOT-MIX ASPHALT REMOVAL IN THE EXISTING GUTTER FLAG WILL BE INCLUDED IN THE UNIT PRICE BID FOR COMBINATION CURB AND GUTTER REMOVAL AND REPLACEMENT.

ALL DAMAGE TO EXISTING PAVEMENT MARKINGS SHALL BE REPLACED AT THE CONTRACTOR'S EXPENSE.

THE ENGINEER SHALL OBTAIN APPROVAL FROM THE DISTRICT ONE BUREAU CHIEF OF MAINTENANCE FOR ANY PROPOSED REVISIONS IN THE SCHEDULED CURB AND GUTTER REPAIR LOCATIONS.

DO NOT SCALE PLANS FOR CONSTRUCTION DIMENSIONS.

IT SHALL BE THE CONTRACTOR'S RESPONSIBILITY TO VERIFY ALL DIMENSIONS AND CONDITIONS EXISTING IN THE FIELD PRIOR TO CONSTRUCTION AND ORDERING OF MATERIALS.

PAINT CURB YELLOW AT FIRE HYDRANTS ACCORDING TO THE APPLICABLE REQUIREMENTS OF SECTION 780 OF THE STANDARD SPECIFICATIONS FOR PAINTED PAVEMENT MARKINGS, EXCEPT THE COST SHALL NOT BE PAID FOR SEPERATELY BUT SHALL BE INCLUDED IN "COMB. CONC. C&G, REMOVAL AND REPLACEMENT."

ADJACENT PARALLEL SIDEWALK, REMOVE AND REPLACE ENTIRE WIDTH OF SIDEWALK JOINT TO JOINT

THE CONTRACTOR SHALL CONTACT THE DISTRICT ONE TRAFFIC CONTROL SUPERVISOR AT (847)705-4470 A MINIMUM OF 72 HOURS IN ADVANCE OF BEGINNING WORK.

ILLINOIS DEPARTMENT OF TRANSPORTATION
**INDEX OF SHEETS
STATE STANDARDS
GENERAL NOTES**

100%
STATE
URBAN

100%
STATE
URBAN

SUMMARY OF QUANTITIES			CONSTRUCTION TYPE CODE 0021			
CODE NO	ITEM	UNIT	TOTAL QUANTITIES	0021		
21101615	TOPSOIL FURNISH AND PLACE, 4"	SO YD	112	112		
25200110	SODDING, SALT TOLERANT	SO YD	112	112		
40603340	HOT-MIX ASPHALT SURFACE COURSE, MIX "D", N70	TON	32	32		
42001300	PROTECTIVE COAT	SO YD	2882	2882		
42300400	PORTLAND CEMENT CONCRETE DRIVEWAY PAVEMENT, 8 INCH	SO YD	1664	1664		
42400200	PORTLAND CEMENT CONCRETE SIDEWALK 5 INCH	SO FT	5755	5755		
42400410	PORTLAND CEMENT CONCRETE SIDEWALK 8 INCH	SO FT	3000	3000		
42400800	DETECTABLE WARNINGS	SO FT	430	430		
44000200	DRIVEWAY PAVEMENT REMOVAL	SO YD	1664	1664		
44000600	SIDEWALK REMOVAL	SO FT	8755	8755		
67100100	MOBILIZATION	L SUM	1	1		
70102620	TRAFFIC CONTROL AND PROTECTION, STANDARD 701501	L SUM	1	1		
70102625	TRAFFIC CONTROL AND PROTECTION, STANDARD 701606	L SUM	1	1		
70102635	TRAFFIC CONTROL AND PROTECTION, STANDARD 701701	L SUM	1	1		
70102640	TRAFFIC CONTROL AND PROTECTION, STANDARD 701801	L SUM	1	1		

SUMMARY OF QUANTITIES			CONSTRUCTION TYPE CODE 0021			
CODE NO	ITEM	UNIT	TOTAL QUANTITIES	0021		
X4401198	HOT-MIX ASPHALT SURFACE REMOVAL, VARIABLE DEPTH	SO YD	185	185		
Z0004562	COMBINATION CONCRETE CURB AND GUTTER REMOVAL AND REPLACEMENT	FOOT	1101	1101		
Z0030850	TEMPORARY INFORMATION SIGNING	SO FT	309	309		

Rev. 7-23-12

FILE NAME	USER NAME	DESIGNED	REVISED
PLT SCALE	CHECKED	DRAWN	REVISED
PLT DATE	DATE	CHECKED	REVISED

STATE OF ILLINOIS
DEPARTMENT OF TRANSPORTATION

SCALE:	SHEET NO.	OF	SHEETS	STA.	TO STA.
--------	-----------	----	--------	------	---------

F.A. RTE.	SECTION	COUNTY	TOTAL SHEETS	SHEET NO.
VARIOUS	2012-042-1	COOK	20	3
FED. ROAD DIST. NO. 1 [ILLINOIS] FED. AID PROJECT			CONTRACT NO. 60V31	

ROUTE	SECTION	COUNTY	TOTAL SHEETS	SHEET NUMBER
VARIOUS	2012-042-1	COOK	20	4

CONTRACT: 60V31

LOCATION	COMB. CONC. C & G R&R (LF)	HMA SURF R&R VARIABLE DEPTH (SQYD)	SALT TOLERANT SODDING (SQYD)	SIDEWALK 5" R&R (SQFT) 18" CARRIAGE/ COURTESY	SIDEWALK 5" R&R (SQFT) 5' PARALLEL	SIDEWALK 8" R&R (SQFT) 5' PARALLEL	DRIVEWAY 8" R&R (SQFT)	DETECTABLE WARNINGS (ADA RAMPS) (SQFT)	REMARKS
5931 West 59th Street	100.0	16.7	15.0	15.0	0.0	0.0	0.0	0.0	Replace 100 Feet of Broken Curb Along Mason Avenue Side of House
3810 West 60th Place	8.0	1.4	0.0	18.0	150.0	0.0	0.0	10.0	Install Depressed Curb For Handcapped Accessible Access, and Replace 6 Sidewalk Squares and 4 Courtesy Walk Squares
5838 West 63rd Place	0.0	0.0	0.0	0.0	200.0	0.0	840.0	0.0	Replace Alley In Concrete From 5822 to 5846 West 63rd Place, 2 Locations
4501 West 66th Place	0.0	0.0	0.0	9.0	600.0	0.0	0.0	0.0	Replace Entire Sidewalk On Front and Side of Home
3650 West 67th Place	0.0	0.0	0.0	0.0	225.0	0.0	0.0	0.0	9 Sidewalk Squares
3859 West 67th Place/3858 West 68th Street	10.0	1.7	0.0	4.5	100.0	150.0	700.0	20.0	Repair Alley Return/Apron In its Entirety With Concrete and ADA Ramps Behind These Two Listed Addresses That Share This Alley Return/Apron
3858 to 3854 West 68th Street	11.0	1.9	1.5	3.0	0.0	0.0	0.0	0.0	Replace 11 Feet of Broken Curb and Missing Gutter In Front of These Two Addresses
3901 West 68th Place/3900 West 69th Street	10.0	1.7	0.0	0.0	100.0	150.0	700.0	20.0	Repair Alley Return/Apron In its Entirety With Concrete and ADA Ramps Behind These Two Listed Addresses That Share This Alley Return/Apron
3816 West 68th Street	0.0	0.0	0.0	0.0	100.0	0.0	0.0	0.0	Replace 4 Sidewalk Squares
3834 West 68th Street	0.0	0.0	0.0	13.5	0.0	0.0	0.0	0.0	Replace 3 Sunken Carriage Walk Squares
3901 West 68th Street/3900 West 68th Place	10.0	1.7	0.0	0.0	100.0	150.0	700.0	20.0	Repair Alley Return/Apron In its Entirety With Concrete and ADA Ramps Behind These Two Listed Addresses That Share This Alley Return/Apron
3630 West 70th Street	30.0	5.0	3.4	15.0	0.0	0.0	0.0	0.0	Replace 30 Feet of Curb and Gutter In Front of Entire Length of Home
3634 West 70th Street	30.0	5.0	3.4	15.0	0.0	0.0	0.0	0.0	Replace 30 Feet of Curb and Gutter In Front of Entire Length of Home
3803 West Marquette Road/3800 West 67th Place	10.0	1.7	0.0	0.0	100.0	150.0	700.0	20.0	Repair Alley Return/Apron In its Entirety With Concrete and ADA Ramps Behind These Two Listed Addresses That Share This Alley Return/Apron
3859 West Marquette Road/3858 West 67th Place	10.0	1.7	0.0	0.0	100.0	150.0	700.0	20.0	Repair Alley Return/Apron In its Entirety With Concrete and ADA Ramps Behind These Two Listed Addresses That Share This Alley Return/Apron
3901 West Marquette Road/3900 West 67th Place	10.0	1.7	0.0	0.0	100.0	150.0	700.0	20.0	Repair Alley Return/Apron In its Entirety With Concrete and ADA Ramps Behind These Two Listed Addresses That Share This Alley Return/Apron
3757 West Marquette Road/6715 South Hamlin Avenue	10.0	1.7	0.0	0.0	100.0	150.0	700.0	20.0	Repair Alley Return/Apron In its Entirety With Concrete and ADA Ramps Behind These Two Listed Addresses That Share This Alley Return/Apron
4025 West Marquette Road/6715 South Komensky Avenue	10.0	1.7	0.0	0.0	100.0	150.0	700.0	20.0	Repair Alley Return/Apron In its Entirety With Concrete and ADA Ramps Behind These Two Listed Addresses That Share This Alley Return/Apron
6048 South Austin Avenue	0.0	0.0	0.0	0.0	25.0	0.0	0.0	0.0	Replace 1 Sidewalk Square
6052 South Austin Avenue	10.0	1.7	1.7	0.0	0.0	0.0	0.0	0.0	Repair Curb and Gutter In Front of This Address
6419 South Austin Avenue	30.0	5.0	1.7	30.0	0.0	0.0	0.0	0.0	Replace Courtesy Walk, and 30 Feet of Curb and Gutter in front of home. It is currently too high and too deep, and is causing a standing water issue.
6423 South Austin Avenue	0.0	0.0	0.0	0.0	50.0	0.0	0.0	0.0	Repair Caving-In Cement/Concrete In Front of This Address
7200 South Avers	7.0	1.2	1.2	0.0	0.0	0.0	0.0	0.0	Replace 7 Feet of Missing Gutter on Either Side of Adjacent Sewer Catch Basin on 72nd Street Side
SUB-TOTAL	306.0	51.5	27.9	123.0	2150.0	1200.0	6440.0	170.0	

ILLINOIS DEPARTMENT OF TRANSPORTATION
SCHEDULE OF QUANTITIES

△ Revised Sheet 07/20/12 RP

ROUTE	SECTION	COUNTY	TOTAL SHEETS	SHEET NUMBER
VARIOUS	2012-042-1	COOK	20	5

CONTRACT: 60V31

LOCATION	COMB. CONC. C & G R&R (LF)	HMA SURF R&R VARIABLE DEPTH (SQYD)	SALT TOLERANT SODDING (SQYD)	SIDEWALK 5" R&R (SQFT) 18" CARRIAGE/ COURTESY	SIDEWALK 5" R&R (SQFT) 5' PARALLEL	SIDEWALK 8" R&R (SQFT) 5' PARALLEL	DRIVEWAY 8" R&R (SQFT)	DETECTABLE WARNINGS (ADA RAMPS) (SQFT)	REMARKS
6412 South Karlov Avenue	0.0	0.0	0.0	36.0	150.0	0.0	0.0	0.0	Replace 6 Sidewalk Square, Courtesy Walk, and Carriage Walk
6558 South Keating Avenue	100.0	16.7	13.4	30.0	0.0	0.0	0.0	0.0	Replace 100 Feet of Broken, Cracked, and Low Curb and Gutter on the 66th Street of This Address - North Side of Street
6600 South Keating Avenue	100.0	16.7	13.4	30.0	0.0	0.0	0.0	0.0	Replace 100 Feet of Missing Curb and Gutter on the 66th Street of This Address - South Side of Street
6023 South Kenneth Avenue	12.0	2.0	0.4	15.0	150.0	0.0	0.0	0.0	replace 12 feet of curb and gutter
6559 South Kilbourn Avenue	20.0	3.4	0.0	0.0	50.0	0.0	30.0	0.0	Replace Side Driveway Apron & Adjacent Curb Around Perimeter of Driveway Apron Facing 66th Street
6058 South Kilpatrick Avenue	20.0	3.4	0.0	22.5	0.0	0.0	0.0	0.0	Replace Side Concrete Driveway Apron Facing 61st Street Side, Including Driveway Apron Curb and Gutter. There is currently a standing water issue here.
7759 South Kilpatrick Avenue	20.0	3.4	0.0	0.0	0.0	0.0	30.0	0.0	Replace Missing Curb and Gutter on 78th Street Side of Home Directly In Front of Driveway Apron
6058 South Kilpatrick Avenue/6059 South Keating Avenue	10.0	1.7	0.0	22.5	100.0	150.0	700.0	20.0	Repair Alley Return/Apron In its Entirety With Concrete and ADA Ramps Behind These Two Listed Addresses That Share This Alley Return/Apron
6459 South Knox Avenue	100.0	16.7	15.4	12.0	0.0	0.0	0.0	0.0	Replace 100 Feet of Curb and Gutter on the 65th Street of This Address, Between Knox Avenue and Train Tracks - North Side of Street
6500 South Knox Avenue	100.0	16.7	15.4	12.0	0.0	0.0	0.0	0.0	Replace 100 Feet of Curb and Gutter on the 65th Street of This Address - South Side of Street - Standing Water Issue Here.
6501 South Knox Avenue	100.0	16.7	15.4	12.0	0.0	0.0	0.0	0.0	Replace 100 Feet of Curb and Gutter on the 65th Street of This Address, Between Knox Avenue and Train Tracks - South Side of Street
6149 South Kostner Avenue	0.0	0.0	0.0	0.0	100.0	0.0	0.0	0.0	Replace 3 or 4 Sidewalk Squares
6340 South Kostner Avenue	0.0	0.0	0.0	0.0	150.0	0.0	0.0	0.0	Replace 6 Sidewalk Squares
6348 South La Crosse Avenue	0.0	0.0	0.0	0.0	25.0	0.0	0.0	10.0	Replace ADA Ramp on the SouthWest Corner of 6300 South La Crosse Avenue -
6349 South La Crosse Avenue	0.0	0.0	0.0	0.0	50.0	0.0	0.0	0.0	Replace 2 Sidewalk Squares
6351 South La Crosse Avenue	0.0	0.0	0.0	0.0	50.0	0.0	0.0	0.0	Replace Sidewalk Squares Impacted By The Sewer
6459 South Lamont Avenue	0.0	0.0	0.0	0.0	75.0	0.0	0.0	0.0	Replace 3 Raised Sidewalk Squares on 65th Street Side of House
6459 South Laporte Avenue/6458 South Lamont Avenue	10.0	1.7	0.0	0.0	100.0	150.0	700.0	20.0	Repair Alley Return/Apron In its Entirety With Concrete and ADA Ramps Behind These Two Listed Addresses That Share This Alley Return/Apron, Facing 65th Street
6751 South Lawndale Avenue	0.0	0.0	0.0	0.0	150.0	0.0	0.0	0.0	Replace 6 Cracked, Broken Sidewalk Squares
6000 South Major Avenue	20.0	3.4	0.0	0.0	0.0	0.0	30.0	0.0	Replace Side Concrete Driveway Apron Facing 60th Street Side
6025 South Mason Avenue	0.0	0.0	0.0	22.5	150.0	0.0	0.0	0.0	Replace 6 Sidewalk Squares, 2 Courtesy Walk Squares, and 3 Carriage Walk Squares
6001 South Massasoit Avenue	20.0	3.4	0.0	0.0	0.0	0.0	30.0	0.0	Replace Side Concrete Driveway Apron Facing 60th Street Side
6001 South Massasoit Avenue/6000 South Major Avenue	10.0	1.7	0.0	0.0	100.0	150.0	700.0	20.0	Repair Alley Return/Apron In its Entirety With Concrete and ADA Ramps Behind These Two Listed Addresses That Share This Alley Return/Apron
SUB-TOTAL	642.0	107.6	73.4	214.5	1400.0	450.0	2220.0	70.0	

ILLINOIS DEPARTMENT OF TRANSPORTATION
SCHEDULE OF QUANTITIES

ROUTE	SECTION	COUNTY	TOTAL SHEETS	SHEET NUMBER
VARIOUS	2012-042-1	COOK	20	6

CONTRACT: 60V31

LOCATION	COMB. CONC. C & G R&R (LF)	HMA SURF R&R VARIABLE DEPTH (SQYD)	SALT TOLERANT SODDING (SQYD)	SIDEWALK 5" R&R (SQFT) 18" CARRIAGE/ COURTESY	SIDEWALK 5" R&R (SQFT) 5' PARALLEL	SIDEWALK 8" R&R (SQFT) 5' PARALLEL	DRIVEWAY 8" R&R (SQFT)	DETECTABLE WARNINGS (ADA RAMPS) (SQFT)	REMARKS
5914 South Mayfield Avenue	5.0	0.9	0.0	22.5	50.0	75.0	350.0	10.0	Repair Alley Return/Apron In its Entirety With Concrete and ADA Ramps At This Address
5915 South Mayfield Avenue	5.0	0.9	0.0	0.0	50.0	75.0	350.0	10.0	Repair Alley Return/Apron In its Entirety With Concrete and ADA Ramps At This Address
6110 South Mayfield Avenue	3.0	0.5	0.4	9.0	0.0	0.0	0.0	0.0	Replace 3 Feet of Curb, 3 Feet of Carriage Walk, and 1 Courtesy Walk Square
5830 South New England Avenue	0.0	0.0	0.0	22.5	200.0	0.0	0.0	0.0	Replace 8 Sidewalk Squares and Entire Courtesy Walk
6725 South Pulask Road/3944 West 67th Place	10.0	1.7	0.0	0.0	100.0	150.0	700.0	20.0	Repair Alley Return/Apron In its Entirety With Concrete and ADA Ramps Behind These Two Listed Addresses That Share This Alley Return/Apron
6825 South Pulask Road/3944 West 68th Place	10.0	1.7	0.0	0.0	100.0	150.0	700.0	20.0	Repair Alley Return/Apron In its Entirety With Concrete and ADA Ramps Behind These Two Listed Addresses That Share This Alley Return/Apron
6735 South Pulask Road/3945 West 67th Place	10.0	1.7	0.0	0.0	100.0	150.0	700.0	20.0	Repair Alley Return/Apron In its Entirety With Concrete and ADA Ramps Behind These Two Listed Addresses That Share This Alley Return/Apron
6835 South Pulask Road/3945 West 68th Place	10.0	1.7	0.0	0.0	100.0	150.0	700.0	20.0	Repair Alley Return/Apron In its Entirety With Concrete and ADA Ramps Behind These Two Listed Addresses That Share This Alley Return/Apron
6735 South Pulask Road/3944 West 68th Street	10.0	1.7	0.0	0.0	100.0	150.0	700.0	20.0	Repair Alley Return/Apron In its Entirety With Concrete and ADA Ramps Behind These Two Listed Addresses That Share This Alley Return/Apron
6805 South Pulask Road/3945 West 68th Street	10.0	1.7	0.0	0.0	100.0	150.0	700.0	20.0	Repair Alley Return/Apron In its Entirety With Concrete and ADA Ramps Behind These Two Listed Addresses That Share This Alley Return/Apron
6750 South Pulask Road/6759 South Komensky Avenue	10.0	1.7	0.0	0.0	100.0	150.0	700.0	20.0	Repair Alley Return/Apron In its Entirety With Concrete and ADA Ramps Behind These Two Listed Addresses That Share This Alley Return/Apron
7237 South Springfield Avenue	0.0	0.0	0.0	0.0	0.0	0.0	16.0	0.0	Repair 4 Foot by 4 Foot Concrete Alley Hole Directly In Front of Asphalt Speed Humps on 73rd Street/Alley Side of Home
6732 South Springfield Avenue/3900 West 68th Street	10.0	1.7	0.0	0.0	100.0	150.0	700.0	20.0	Repair Alley Return/Apron In its Entirety With Concrete and ADA Ramps Behind These Two Listed Addresses That Share This Alley Return/Apron
5724 South Tripp	60.0	10.0	9.5	4.5	0.0	0.0	0.0	0.0	Replace Broken Sidewalk Squares
5623 South Tripp Avenue	0.0	0.0	0.0	0.0	25.0	0.0	0.0	0.0	Replace 1 Sidewalk Square
5701 South Tripp Avenue	0.0	0.0	0.0	0.0	75.0	0.0	0.0	0.0	Replace 3 Sidewalk Squares
5741 South Tripp Avenue	0.0	0.0	0.0	0.0	150.0	0.0	0.0	0.0	Replace 6 Sidewalk Squares
5742 South Tripp Avenue	0.0	0.0	0.0	9.0	150.0	0.0	0.0	0.0	Replace 6 Sidewalk Squares and 2 Courtesy Walk Squares
6341 South Tripp Avenue	0.0	0.0	0.0	0.0	100.0	0.0	0.0	0.0	Replace Broken Sidewalk Squares
6437 South Tripp Avenue	0.0	0.0	0.0	0.0	150.0	0.0	0.0	0.0	Replace 6 or 7 Sidewalk Squares
6443 South Tripp Avenue	0.0	0.0	0.0	0.0	50.0	0.0	0.0	10.0	Replace 2 Sidewalk Squares
SUB-TOTAL	153.0	25.9	9.9	67.5	1800.0	1350.0	6316.0	190.0	

TOTAL	1101.0	185.0	111.2	405.0	5350.0	3000.0	14976.0	430.0
--------------	---------------	--------------	--------------	--------------	---------------	---------------	----------------	--------------

ILLINOIS DEPARTMENT OF TRANSPORTATION
SCHEDULE OF QUANTITIES

△ Revised Sheet 07/20/12 RP

ROUTE	SECTION	COUNTY	TOTAL SHEETS	SHEET NUMBER
VARIOUS	2012-042-I	COOK	20	16

CONTRACT NO.: 60V31

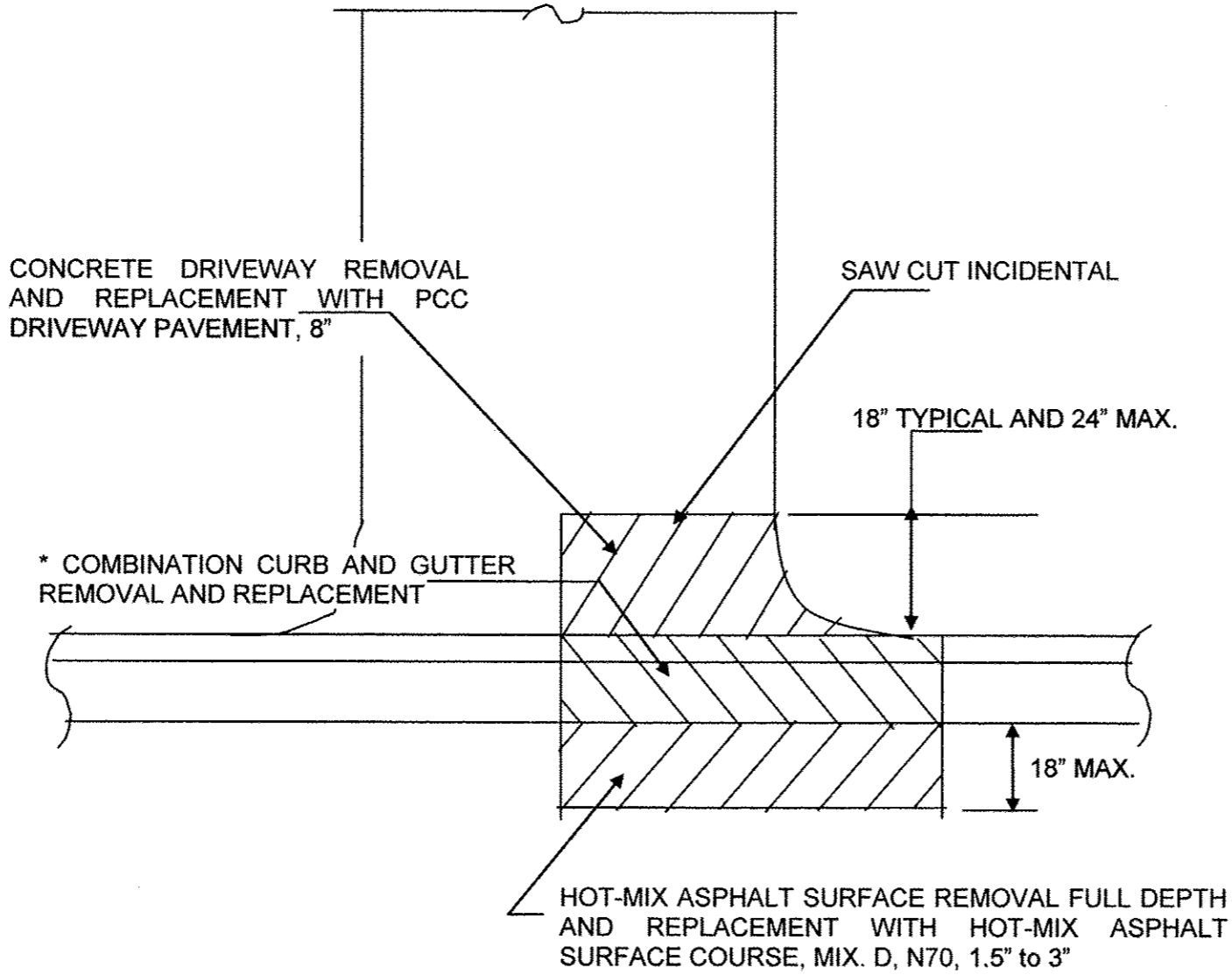

PLAN VIEW

* PROPOSED DEPRESSED CURB AND EXACT LENGTH SHALL BE DETERMINED IN THE FIELD BY THE ENGINEER (TYPICAL)

ILLINOIS DEPARTMENT OF TRANSPORTATION

DETAIL: CONCRETE DRIVEWAY

VARIABLE - TO MEET EXISTING DIMENSIONS AND FIELD CONDITIONS (SEE NOTE ②)

PROP. CONC. CURB OR CURB AND GUTTER REPLACEMENT IN ACCORDANCE WITH STATE STANDARD 606001. (SEE NOTE ②)

SAW CUT FULL DEPTH - INCLUDED IN THE COST OF SIDEWALK, DRIVEWAY OR MEDIAN SURFACE REMOVAL PAY ITEM.

SEE STATE STANDARD 606001
EXISTING OR PROPOSED HMA SURFACE (IF APPLICABLE)
1/4" (5) **

18" (450) MAX.

EXISTING SIDEWALK, DRIVEWAY, MEDIAN SURFACE, SOD OR GROUND.

PROPOSED SIDEWALK, DRIVEWAY PAVEMENT, MEDIAN SURFACE OR SODDING SALT TOLERANT WITH TOP SOIL, 4" (100) SOD RESTORATION (SEE NOTE ①).

EXISTING CONCRETE PAVEMENT, CONCRETE BASE COURSE OR FLEXIBLE PAVEMENT

3" (75) MIN.

SUITABLE BACKFILL MATERIAL (INCLUDED IN THE COST OF CURB OR CURB AND GUTTER REMOVAL AND REPLACEMENT)

PROPOSED 3/4" (20) PREFORMED EXPANSION JOINT AT CONCRETE SIDEWALKS, DRIVEWAYS, AND MEDIANS. (INCLUDED IN THE COST OF CURB OR CURB AND GUTTER REMOVAL AND REPLACEMENT.)

* 3" (75) MINIMUM FROM TOP AND BOTTOM OF THE CONCRETE PAVEMENT OR BASE COURSE.

** IF THE FINAL SURFACE OF THE PAVEMENT IS CONCRETE, THE GUTTER IS TO BE FLUSH WITH THE PAVEMENT.

UNSUITABLE SUB-BASE MATERIAL TO BE REMOVED, IF DIRECTED BY THE ENGINEER, SHALL BE REPLACED WITH EITHER SUB-BASE GRANULAR MATERIAL, TYPE B OR ADDITIONAL THICKNESS OF CONCRETE.

REMOVAL AND REPLACEMENT 4" (100) OR LESS IS INCLUDED IN THE COST OF CURB OR CURB AND GUTTER REMOVAL AND REPLACEMENT.

REMOVAL AND REPLACEMENT IN EXCESS OF 4" (100) WILL BE PAID FOR IN ACCORDANCE WITH ARTICLE 109.04 OF THE STANDARD SPECIFICATIONS.

NOTE: ① SIDEWALK, DRIVEWAY PAVEMENT OR MEDIAN SURFACE SHALL BE SIMILAR TO THE MATERIAL BEING REMOVED AND WILL BE PAID FOR SEPARATELY.

SODDING, SALT TOLERANT AND TOP SOIL, FURNISH AND PLACE 4" WILL BE PAID FOR SEPARATELY.

② FERTILIZER FOR THE PLACEMENT OF THE SOD IS NOT REQUIRED

③ CURB OR CURB AND GUTTER REPLACEMENT SHALL MATCH THE SHAPE OF THE EXISTING CURB OR CURB AND GUTTER UNLESS OTHERWISE SPECIFIED.

④ FOR CURB OR CURB AND GUTTER REMOVAL AND REPLACEMENT ADJACENT TO FLEXIBLE PAVEMENT DELETE EPOXY COATED TIE BARS.

⑤ LONGITUDINAL BARS, IF ENCOUNTERED IN THE EXISTING CURB OR CURB AND GUTTER, ARE NOT TO BE REPLACED. CUTTING AND REMOVING LONGITUDINAL BARS SHALL BE INCLUDED IN THE COST OF CURB OR CURB AND GUTTER REMOVAL AND REPLACEMENT.

⑥ THE COST OF HMA SURFACE REMOVAL IN THE EXISTING GUTTER FLAG SHALL BE INCLUDED IN THE COST OF THE CURB AND GUTTER REMOVAL AND REPLACEMENT.

PROPOSED #6 (20) EPOXY COATED TIE BARS 24" (600) LONG AT 24" (600) CENTERS WILL NOT BE PAID FOR SEPARATELY. DELETE EPOXY COATED TIE BARS IF EXISTING TIE BARS ARE USUABLE AS DETERMINED BY THE ENGINEER. (SEE NOTE ③).

⑦ THE REMOVAL AND REPLACEMENT OF THE EXISTING CURB OR CURB AND GUTTER SHALL BE DONE IN ACCORDANCE WITH THE APPLICABLE PORTIONS OF SECTION 440 AND 606 OF THE STANDARD SPECIFICATIONS.

⑧ THE LOCATIONS OF REMOVAL AND REPLACEMENT OF EXISTING CURB OR CURB AND GUTTER SHALL BE DETERMINED BY THE RESIDENT ENGINEER AT THE TIME OF CONSTRUCTION.

BASIS OF PAYMENT:

THIS WORK WILL BE PAID FOR AT THE CONTRACT UNIT PRICE PER FOOT (METER) FOR "CURB REMOVAL AND REPLACEMENT" OR "COMBINATION CONCRETE CURB AND GUTTER REMOVAL AND REPLACEMENT".

CURB OR CURB AND GUTTER REMOVAL AND REPLACEMENT

ALL DIMENSIONS ARE IN INCHES (MILLIMETERS) UNLESS OTHERWISE SHOWN.

FILE NAME =	USER NAME = currgaw	DESIGNED - A. HOUSEH	REVISED - R. SHAH 10-03-96	STATE OF ILLINOIS DEPARTMENT OF TRANSPORTATION	CURB OR CURB AND GUTTER REMOVAL AND REPLACEMENT		F.A. -	SECTION	COUNTY	TOTAL SHEETS	SHEET NO.
oi\p\work\p\dot\currgaw\0172364\16909-Design.dgn		DRAWN -	REVISED - A. ABBAS 03-21-97		VARIOUS	2012-042-1	COOK	20	17		
PLOT SCALE = 5/8" = 1' / in.		CHECKED -	REVISED - M. GOMEZ 01-22-01		SCALE: NONE		SHEET NO. 1 OF 1 SHEETS		STA. TO STA.	FED. ROAD DIST. NO. 1 ILLINOIS FED. AID PROJECT	
PLOT DATE = 6/15/2012		DATE - 03-11-94	REVISED - R. BORO 12-15-09		REMOVAL AND REPLACEMENT		BD800-06 (BD-24)		CONTRACT NO. 60V31		

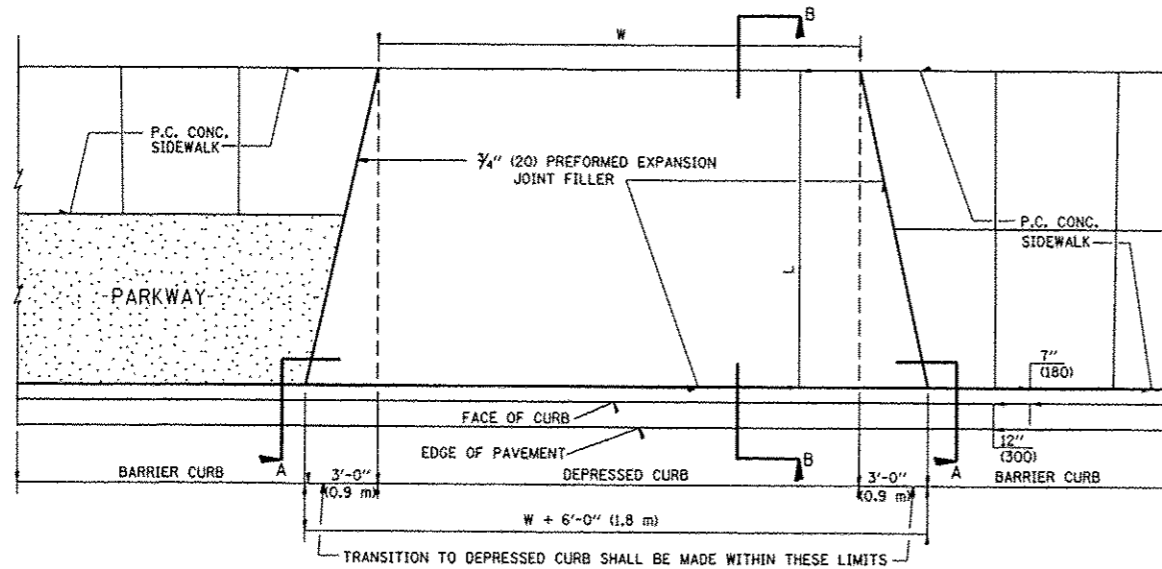

PLAN VIEW

NOTES:

1. EXPANSION JOINTS SHALL BE CONSTRUCTED AS SHOWN ON THE DETAILS FOR P.C.C. SIDEWALK.
2. THE CURB BETWEEN ADJACENT DRIVEWAYS SHALL BE FULL HEIGHT FOR A DISTANCE OF AT LEAST FOUR FEET (1.2 METERS).
3. P.C. CONCRETE DRIVEWAYS SHALL BE CONSTRUCTED AT LOCATIONS SHOWN ON THE PLANS OR AS DIRECTED BY THE ENGINEER.
4. 3/4" (20) PREFORMED EXPANSION JOINTS WILL NOT BE PAID FOR SEPARATELY BUT SHALL BE CONSIDERED INCIDENTAL TO P.C.C. DRIVEWAY PAVEMENT 8" (200).
5. COMBINATION CONC. CURB AND GUTTER SHALL BE MEASURED STRAIGHT ACROSS THE DRIVEWAY. NO ADDITIONAL COMPENSATION WILL BE ALLOWED FOR THE TRANSITION CURB AND GUTTER.

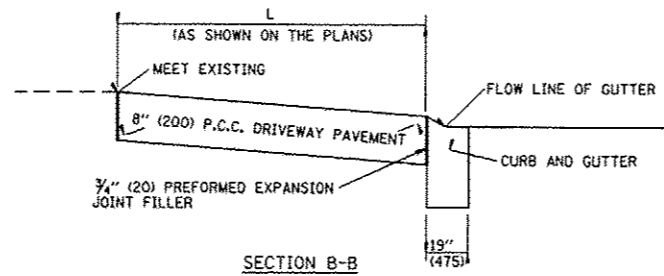

SECTION B-B

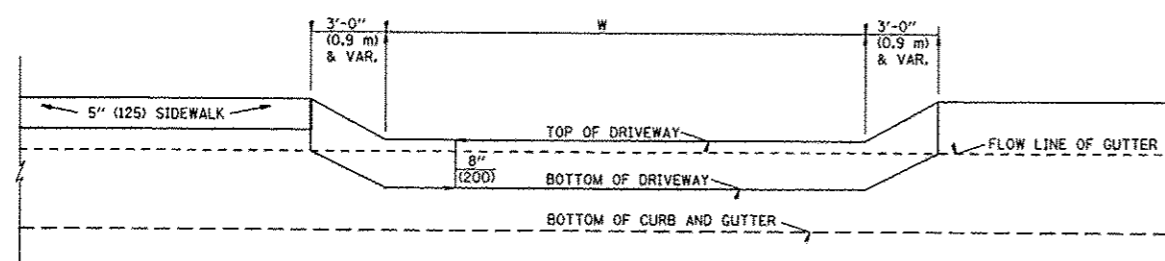

SECTION A-A

P.C.C. DRIVEWAY PAVEMENT DETAIL

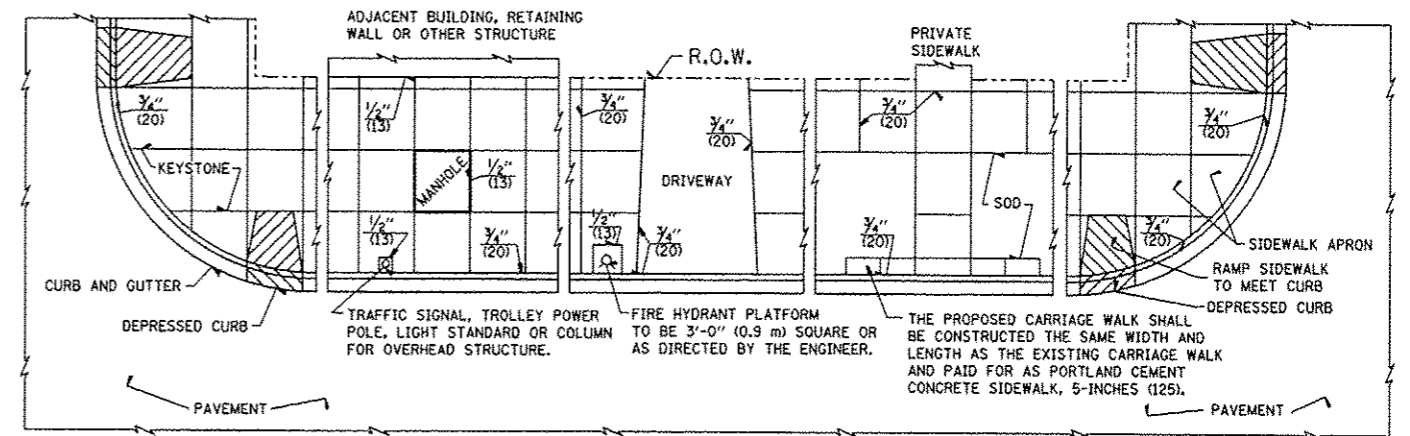

NOTES:

1. ONE-HALF INCH THICK EXPANSION JOINTS SHALL BE PLACED BETWEEN THE SIDEWALK AND ALL STRUCTURES SUCH AS LIGHT STANDARDS, TRAFFIC LIGHT STANDARDS, MANHOLES, WHICH EXTEND THROUGH THE SIDEWALK.
2. 3/4" (20) THICK EXPANSION JOINTS SHALL BE PLACED AT INTERVALS OF NOT MORE THAN 100 FEET (30 METERS) IN THE SIDEWALK. WHERE THE SIDEWALK IS CONSTRUCTED ADJACENT TO PAVEMENT OR CURB HAVING EXPANSION JOINTS, THE EXPANSION JOINTS IN THE SIDEWALK SHALL BE PLACED OPPOSITE THE EXISTING EXPANSION JOINTS AS NEARLY AS PRACTICABLE. EXPANSION JOINTS SHALL ALSO BE PLACED WHERE THE SIDEWALK ABUTS EXISTING SIDEWALKS, BETWEEN DRIVEWAY PAVEMENT AND SIDEWALK, AND BETWEEN SIDEWALK AND CURBS WHERE THE SIDEWALK ABUTS A CURB.

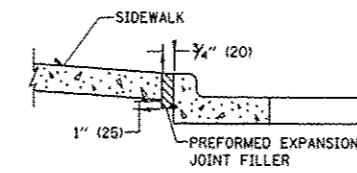

SLOPE FOR SIDEWALK
1" (25) IN 3'-0" (0.9 m) IN CHICAGO

PORTLAND CEMENT CONCRETE SIDEWALK DETAILS

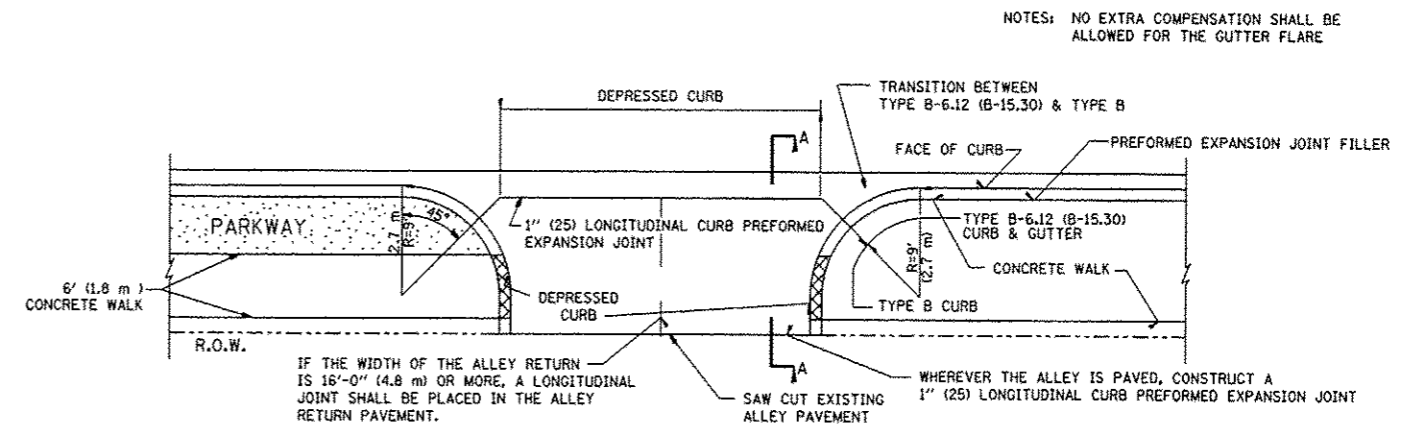

IF THE WIDTH OF THE ALLEY RETURN IS 16'-0" (4.8 m) OR MORE, A LONGITUDINAL JOINT SHALL BE PLACED IN THE ALLEY RETURN PAVEMENT.

WHEREVER THE ALLEY IS PAVED, CONSTRUCT A 1" (25) LONGITUDINAL CURB PREFORMED EXPANSION JOINT

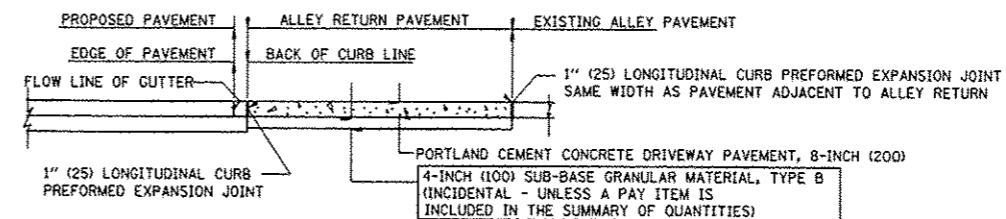

SECTION A-A

ALLEY RETURN DETAIL

ALL DIMENSIONS ARE IN INCHES (MILLIMETERS) UNLESS OTHERWISE SHOWN

FILE NAME =	USER NAME = curryaw	DESIGNED - M. DE YONG	REVISED -
o:\p\work\p\dot\curryaw\d0172364\VP169029-Design.dgn		DRAWN -	REVISED -
PLOT SCALE = 5000.0000 ' / in.		CHECKED -	REVISED -
PLOT DATE = 6/15/2012		DATE - 06-13-90	REVISED -

STATE OF ILLINOIS
DEPARTMENT OF TRANSPORTATION

CITY OF CHICAGO
DETAILS FOR P.C. CONCRETE DRIVEWAY, ALLEY RETURN AND SIDEWALK

SCALE: NONE SHEET NO. 1 OF 1 SHEETS STA. TO STA.

F.A. RTE.	SECTION	COUNTY	TOTAL SHEETS	SHEET NO.
VARIOUS	2012-042-1	COOK	20	18
BD400-03 (BD-17)		CONTRACT NO. 60V31		
FED. ROAD DIST. NO. 1 ILLINOIS FED. AID PROJECT				

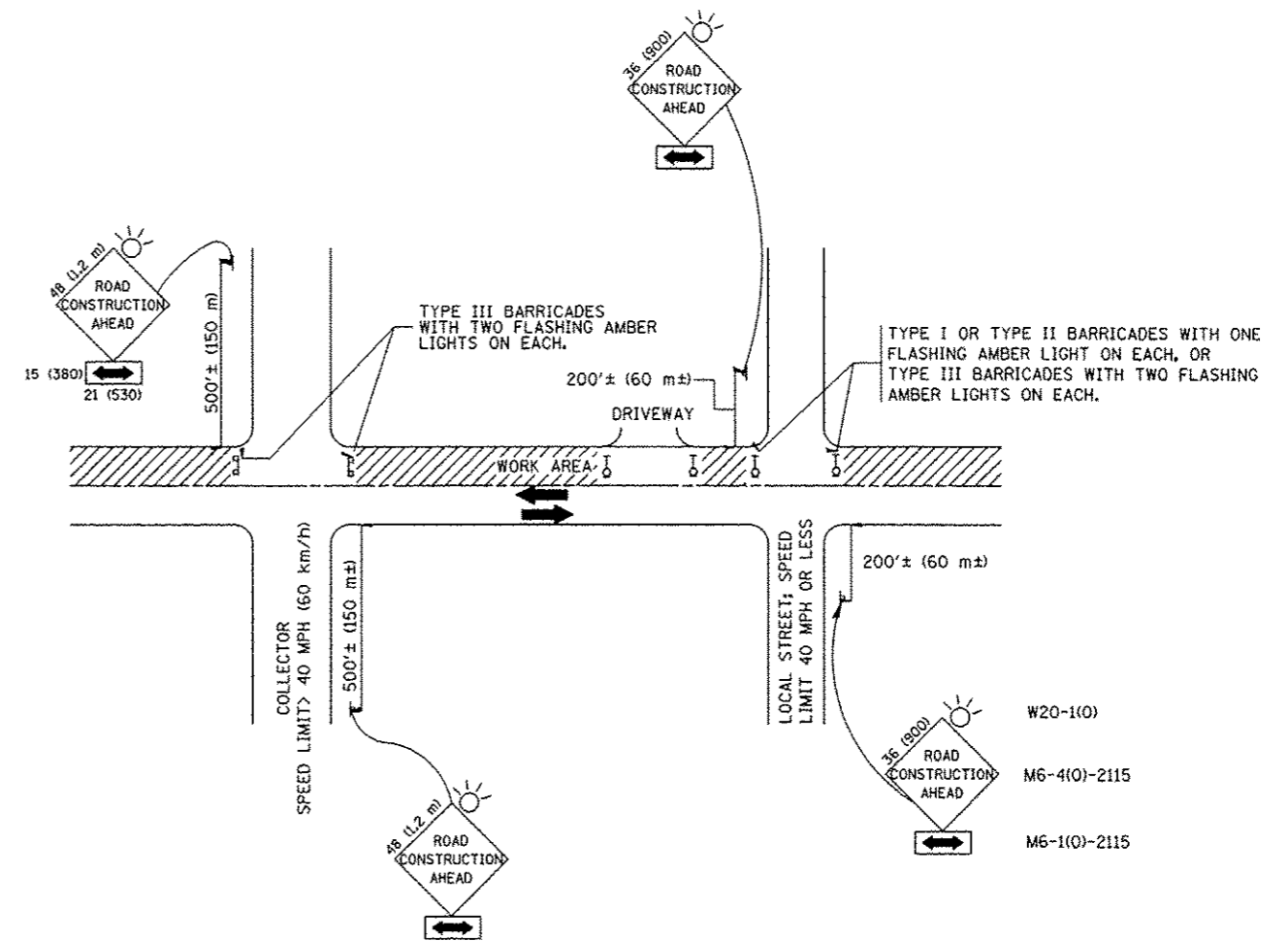

W20-1(0)
M6-4(0)-2115
M6-1(0)-2115

TRAFFIC CONTROL AND PROTECTION FOR SIDE ROADS, INTERSECTIONS, AND DRIVEWAYS

NOTES:

- A. FOR NO LANE RESTRICTION ON THE SIDE ROAD OR DRIVEWAYS
 - 1. SIDE ROAD WITH A SPEED LIMIT OF 40 MPH (60 km/h) OR LESS AS SHOWN ON THE DRAWING AND AS DIRECTED BY THE ENGINEER:
 - a) ONE ROAD CONSTRUCTION AHEAD SIGN 36 x 36 (900x900) WITH A FLASHER AND FLAG MOUNTED ON IT APPROXIMATELY 200' (60 m) IN ADVANCE OF THE MAIN ROUTE.
 - b) THE CLOSED PORTION OF THE MAIN ROUTE SHALL BE PROTECTED BY BLOCKING WITH TYPE I, TYPE II OR TYPE III BARRICADES, 1/3 OF THE CROSS SECTION OF THE CLOSED PORTION.
 - 2. SIDE ROAD WITH A SPEED LIMIT GREATER THAN 40 MPH (60 km/h) AS SHOWN ON THE DRAWING AND AS DIRECTED BY THE ENGINEER:
 - a) ONE ROAD CONSTRUCTION AHEAD SIGN 48 x 48 (1.2 m x 1.2 m) WITH A FLASHER MOUNTED ON IT APPROXIMATELY 500' (150 m) IN ADVANCE OF THE MAIN ROUTE.
 - b) THE CLOSED PORTION OF THE MAIN ROUTE SHALL BE PROTECTED BY BLOCKING WITH TYPE III BARRICADES, 1/2 OF THE CROSS SECTION OF THE CLOSED PORTION.
 - 3. WHEN THE SIDE ROAD LIES BETWEEN THE BEGINNING OF THE MAINLINE SIGNING AND THE WORK ZONE, A SINGLE HEADED ARROW (M6-1) SHALL BE USED IN LIEU OF THE DOUBLE HEADED ARROW (M6-4).
- B. FOR A LANE CLOSURE ON A SIDE ROAD OR DRIVEWAY:
 - USE APPLICABLE PORTIONS OF THE TYPICAL APPLICATION OF TRAFFIC CONTROL DEVICES (STD. 701501, STD. 701606 OR THE APPROPRIATE STANDARD). THE SPACING OF SIGNS AND BARRICADES SHALL BE ADJUSTED FOR FIELD CONDITIONS AS DIRECTED BY THE ENGINEER. THE DIRECTIONAL ARROW SHALL BE COVERED OR REMOVED WHEN NO LONGER CONSISTENT WITH THE SIDE ROAD LANE CLOSURE.
 - C. ADVANCE WARNING SIGNS ARE TO BE OMITTED ON DRIVEWAY UNLESS OTHERWISE NOTED.
 - D. THE TRAFFIC CONTROL AND PROTECTION FOR SIDE ROADS, INTERSECTIONS, AND DRIVEWAYS SHALL BE INCIDENTAL TO THE COST OF SPECIFIED TRAFFIC CONTROL STANDARDS OR ITEMS.

All dimensions are in millimeters (inches) unless otherwise shown.

FILE NAME =	USER NAME = curryaw	DESIGNED - LHA	REVISED - J. OBERLE 10-18-95	STATE OF ILLINOIS DEPARTMENT OF TRANSPORTATION	TRAFFIC CONTROL AND PROTECTION FOR SIDE ROADS, INTERSECTIONS, AND DRIVEWAYS			F.A. RTE.	SECTION	COUNTY	TOTAL SHEETS	SHEET NO.	
o:\pwork\pvidot\curryaw\d2172364\169089-Design.dgn		DRAWN -	REVISED - A. HOUSEH 03-06-96		SCALE: NONE	SHEET NO. 1 OF 1 SHEETS	STA.	TO STA.	VARIOUS	2012-042-1	COOK	20	19
PLOT SCALE = 5000.0000' / in.		CHECKED -	REVISED - A. HOUSEH 10-15-96						TC-10		CONTRACT NO. 60V31		
PLOT DATE = 6/15/2012		DATE - 06-89	REVISED - T. RAMMACHER 01-06-00						FED. ROAD DIST. NO. 1 (ILLINOIS) FED. AID PROJECT				

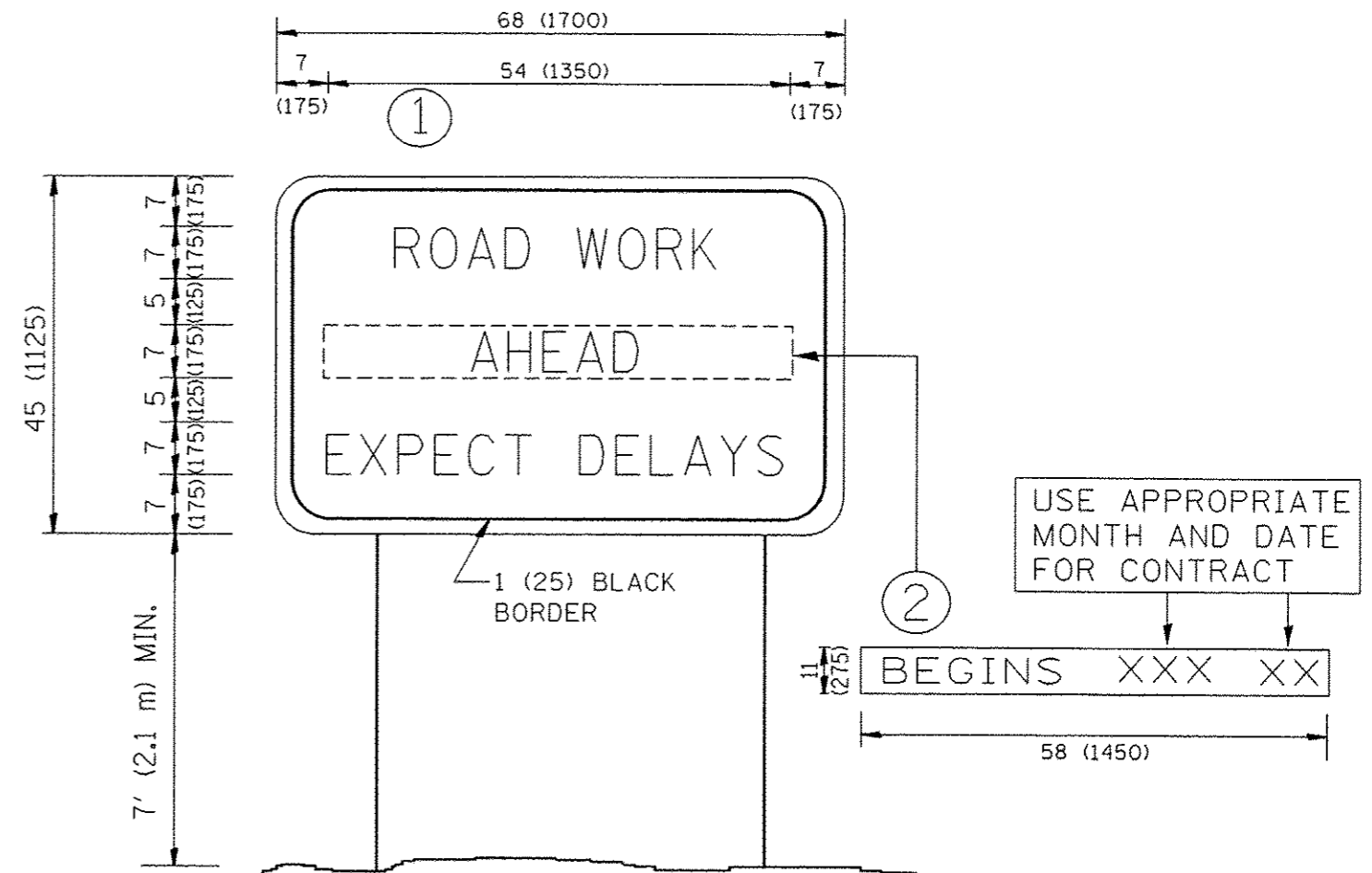

NOTES:

1. USE BLACK LETTERING ON ORANGE BACKGROUND.
2. ERECT SIGNS IN ADVANCE OF THE LOCATION FOR THE "ROAD CONSTRUCTION AHEAD" SIGN AT LOCATIONS AS DIRECTED BY THE ENGINEER.
3. ERECT SIGN ① WITH INSTALLED PANEL ② ONE WEEK PRIOR TO THE START OF CONSTRUCTION.
4. REMOVE PANEL ② SOON AFTER THE START OF CONSTRUCTION.
5. SEE SPECIAL PROVISION FOR "TEMPORARY INFORMATION SIGNING" FOR ADDITIONAL INFORMATION.
6. ONE SIGN ASSEMBLY EQUALS 25.70 SQ. FT. (2.3 SQ. M.)
7. SHALL BE PAID FOR AS TEMPORARY INFORMATION SIGNING.

ALL DIMENSIONS ARE IN INCHES (MILLIMETERS) UNLESS OTHERWISE SHOWN.

FILE NAME =	USER NAME = curryov	DESIGNED -	REVISED - R. MIRS 09-15-97
c:\pwork\pwork\curryov\d0172364\PI6909-Design.dgn		DRAWN -	REVISED - R. MIRS 12-11-97
		CHECKED -	REVISED - T. RAMMACHER 02-02-99
		DATE -	REVISED - C. JUCIUS 01-31-07

**STATE OF ILLINOIS
DEPARTMENT OF TRANSPORTATION**

**ARTERIAL ROAD
INFORMATION SIGN**

SCALE: NONE	SHEET NO. 1 OF 1 SHEETS	STA. TO STA.	F.A. RTE. VARIOUS	SECTION 2012-042-1	COUNTY COOK	TOTAL SHEETS 20	SHEET NO. 20
			TC-22		CONTRACT NO. 60V31		
FED. ROAD DIST. NO. 1 ILLINOIS FED. AID PROJECT							