

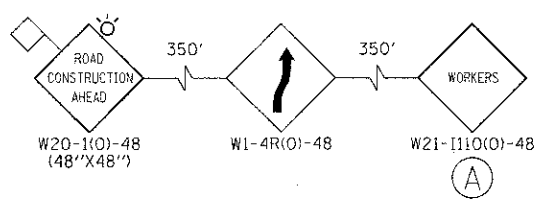

ADVANCED SIGNING DETAIL



LEGEND:

- TEMPORARY PAVEMENT
- WORK ZONE
- DIRECTION OF TRAFFIC
- TYPE II BARRICADES OR DRUMS WITH STEADY BURNING LIGHTS @ 50 FT CENTERS ALONG ROADWAY TANGENTS, 25 FT CENTERS ALONG TAPERS, AND 12 FT CENTERS ALONG RADII
- VERTICAL PANEL WITH STEADY BURNING LIGHT @ 50 FT CENTERS
- TYPE III BARRICADES WITH FLASHING LIGHTS

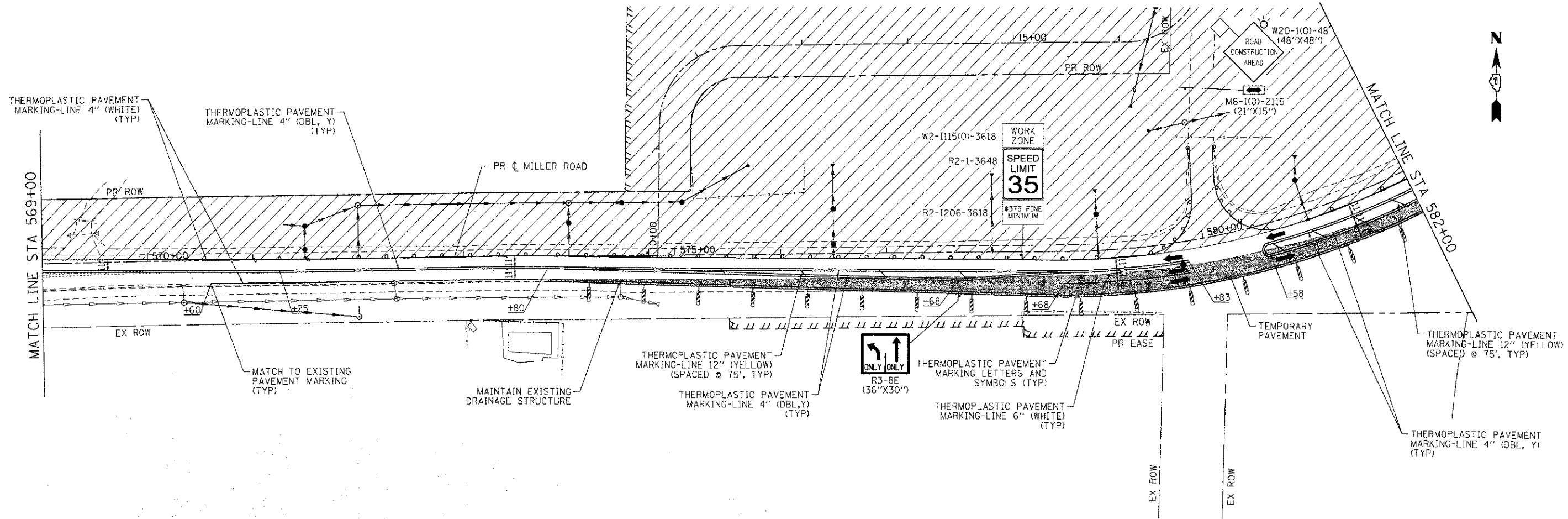
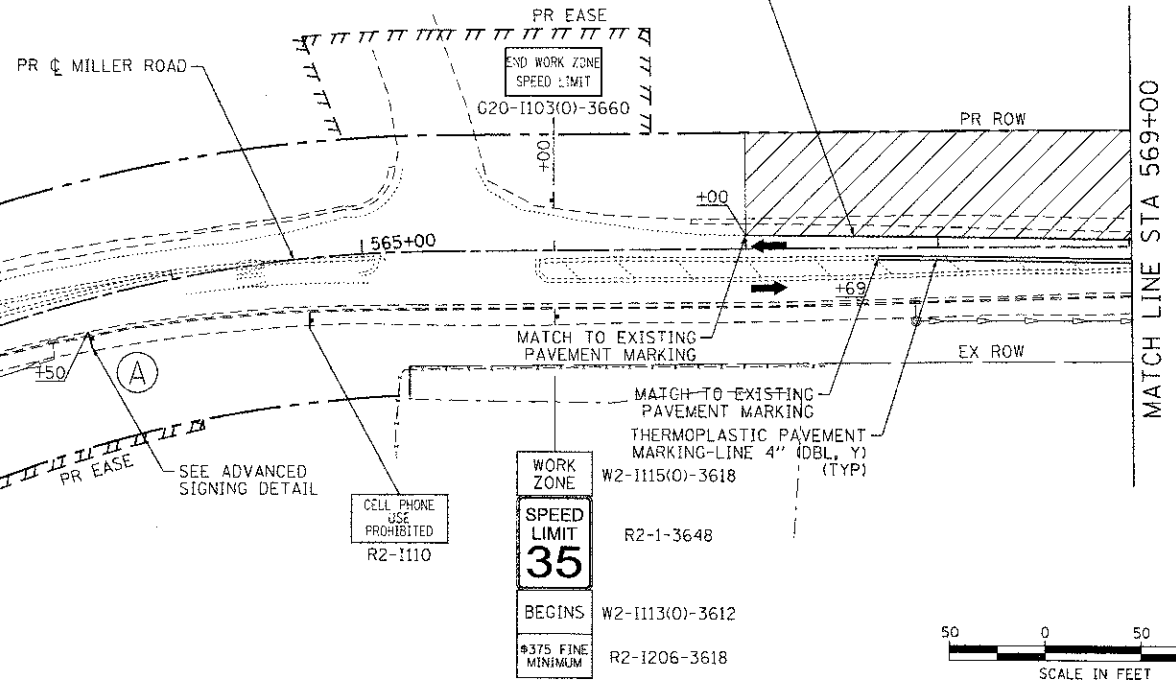

COMPANY NAME: HRGreen
 PROJECT CONTACT: jettano
 CLIENT: MCHENRY COUNTY
 DATE PLOTTED: 7/23/2012 10:55:58 AM
 FILE NAME: 090071-motl-04.dgn
 PLOT SCALE: 1" = 50'
 PLOT DATE: 7/23/2012



USER NAME = jettano	DESIGNED - JPA	REVISED -
FILE NAME = 090071-motl-04.dgn	DRAWN - SVJ	REVISED -
PLOT SCALE = 1" = 50'	CHECKED - JLP	REVISED -
PLOT DATE = 7/23/2012	DATE - 7/23/12	REVISED -

**MCHENRY COUNTY
DIVISION OF TRANSPORTATION**

**SUGGESTED MAINTENANCE OF TRAFFIC - STAGE 1
CHARLES J. MILLER ROAD ROADWAY IMPROVEMENTS**

SCALE: 1" = 50' SHEET NO. 1 OF 14 SHEETS STA. TO STA.

F.A.U. RTE. 3860	SECTION 09-00372-00-PW	COUNTY MCHENRY	TOTAL SHEETS 252	SHEET NO. 35
FED. ROAD DIST. NO. ILLINOIS FED. AID PROJECT			CONTRACT NO. 63633	