

- LEGEND:**
- TEMPORARY PAVEMENT
 - WORK ZONE
 - DIRECTION OF TRAFFIC
 - TYPE II BARRICADES OR DRUMS WITH STEADY BURNING LIGHTS @ 50 FT CENTERS ALONG ROADWAY TANGENTS, 25 FT CENTERS ALONG TAPERS, AND 12 FT CENTERS ALONG RADIUS
 - VERTICAL PANEL WITH STEADY BURNING LIGHT @ 50 FT CENTERS
 - TYPE III BARRICADES WITH FLASHING LIGHTS

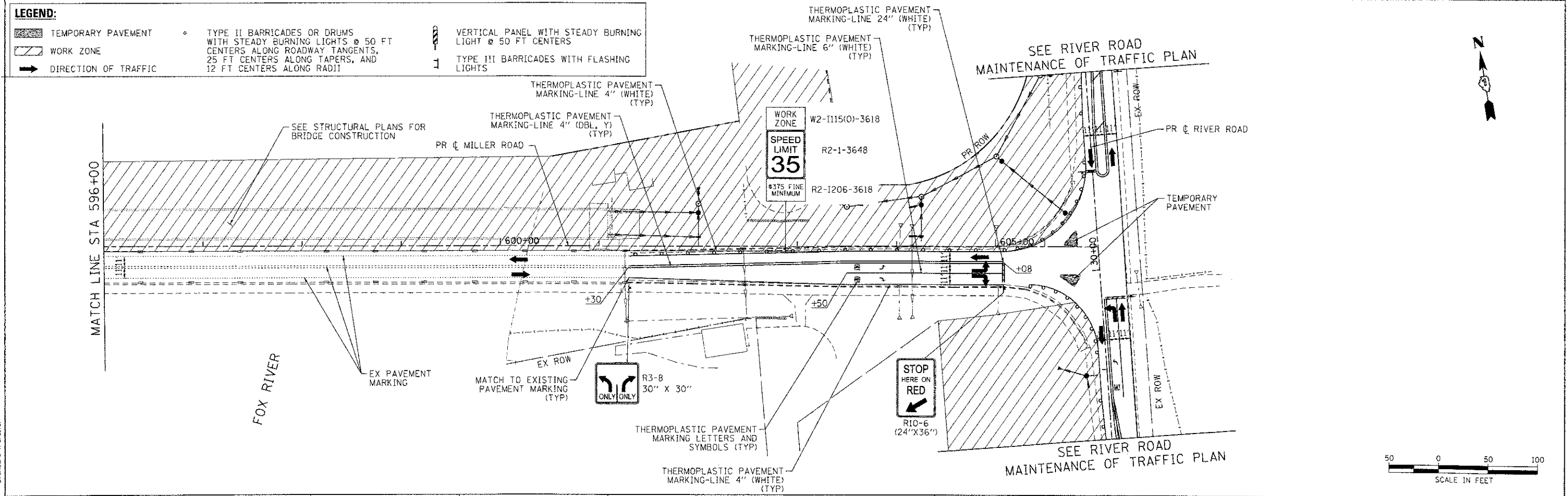

7/23/2012 11:56:07 AM
 090071-mch1-05.dgn
 pof,ldt
 strondarc-trans.tbl



USER NAME = jottena	DESIGNED = JPA	REVISED =
FILE NAME = 090071-mch1-05.dgn	DRAWN = SVJ	REVISED =
PLOT SCALE = 1" = 50'	CHECKED = JLP	REVISED =
PLOT DATE = 7/23/2012	DATE = 7/23/12	REVISED =

**MCHENRY COUNTY
 DIVISION OF TRANSPORTATION**

**SUGGESTED MAINTENANCE OF TRAFFIC - STAGE 1
 CHARLES J. MILLER ROAD ROADWAY IMPROVEMENTS**

F.A.U. RTE. 3860	SECTION 09-00372-00-PW	COUNTY MCHENRY	TOTAL SHEETS 252	SHEET NO. 36
FED. ROAD DIST. NO. ILLINOIS/FED. AID PROJECT			CONTRACT NO. 63633	

SCALE: 1" = 50' SHEET NO. 2 OF 14 SHEETS STA. TO STA.

