

ADVANCED SIGNING DETAIL

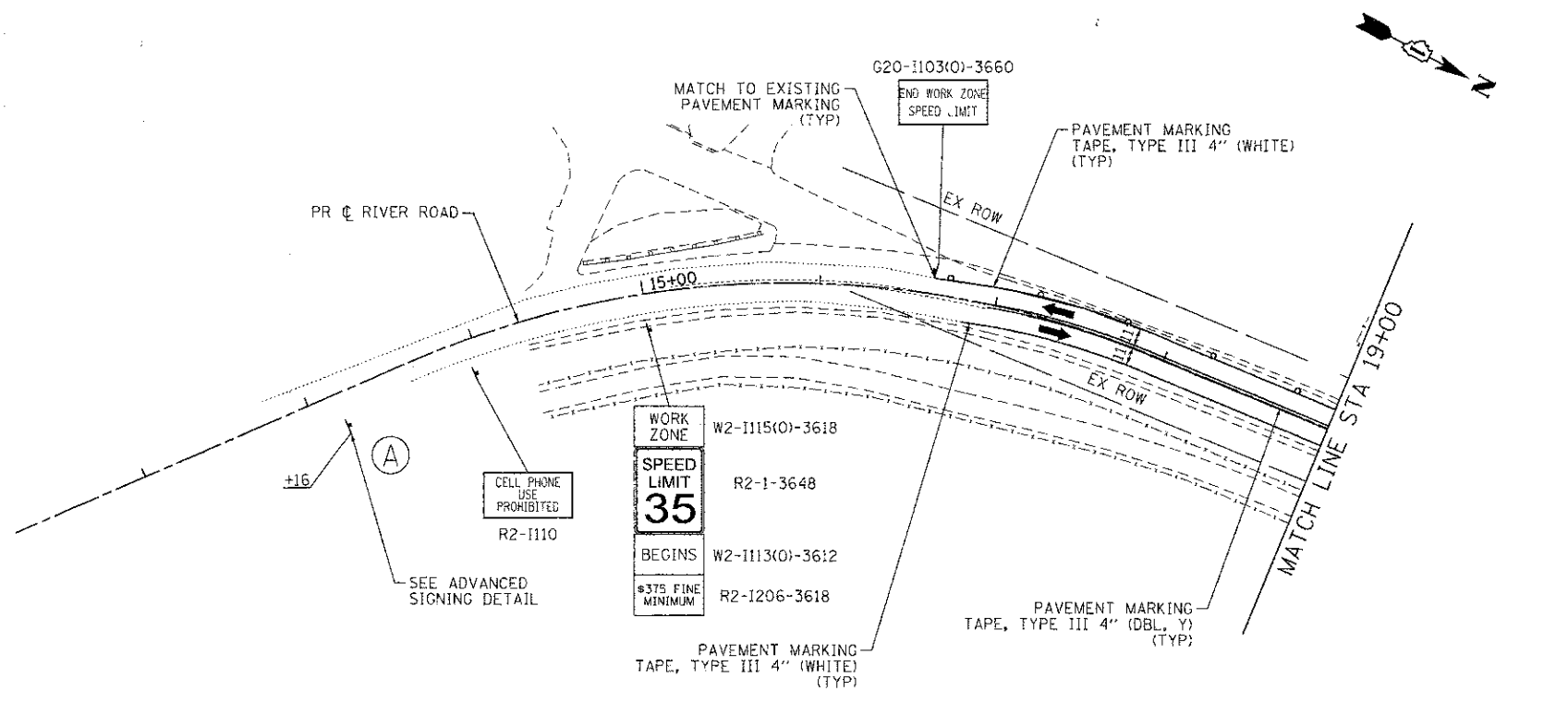

LEGEND:

TEMPORARY PAVEMENT	TYPE II BARRICADES OR DRUMS WITH STEADY BURNING LIGHTS @ 50 FT CENTERS ALONG ROADWAY TANGENTS, 25 FT CENTERS ALONG TAPERS, AND 12 FT CENTERS ALONG RADII	VERTICAL PANEL WITH STEADY BURNING LIGHT @ 50 FT CENTERS
WORK ZONE	TYPE III BARRICADES WITH FLASHING LIGHTS	
DIRECTION OF TRAFFIC		

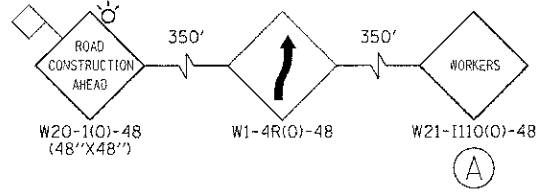
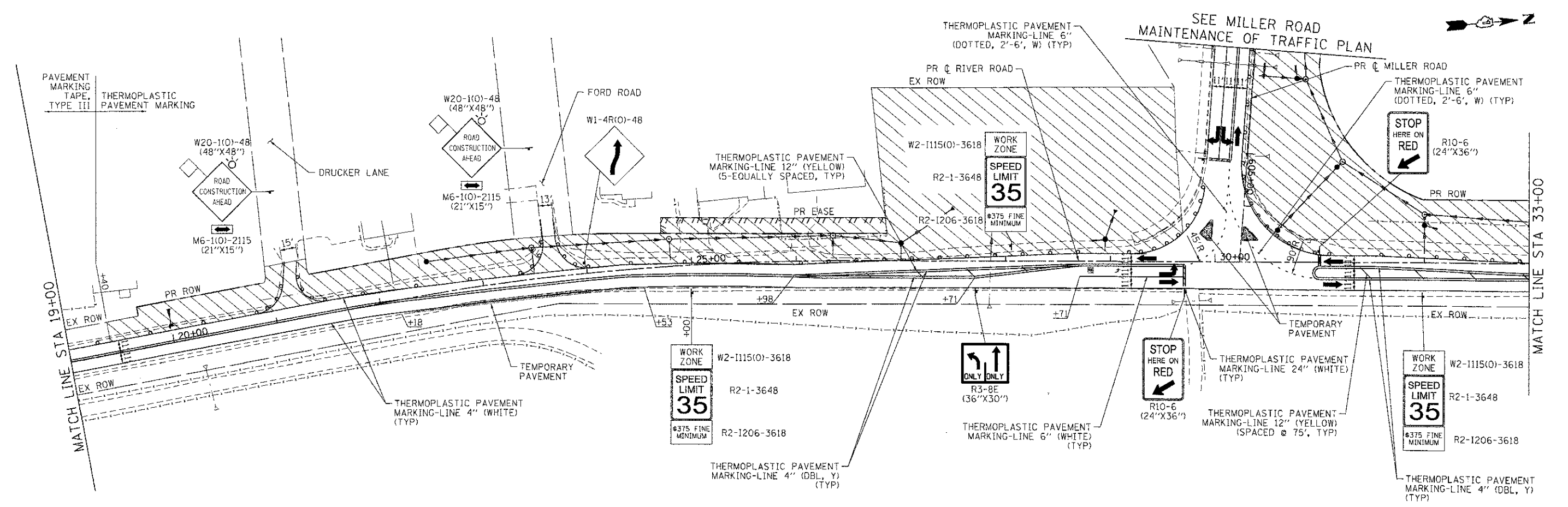
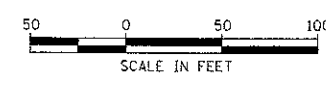

COMPANY NAME: HRGreen
 PROJECT CONTACT: HRGreen
 CLIENT: MCHENRY COUNTY
 DATE PLOTTED: 7/23/2012 10:17:41 AM
 FILE NAME: 090071-mo1-09.dgn
 PLOT DRIVER: pct
 PEN TABLE: standard-trans.tbl



USER NAME = jactena	DESIGNED - JPA	REVISED -
FILE NAME = 090071-mo1-09.dgn	DRAWN - SVJ	REVISED -
PLOT SCALE = 1" = 50'	CHECKED - JLP	REVISED -
PLOT DATE = 7/23/2012	DATE - 7/23/12	REVISED -

**MCHENRY COUNTY
DIVISION OF TRANSPORTATION**

**SUGGESTED MAINTENANCE OF TRAFFIC - STAGE 1
CHARLES J. MILLER ROAD ROADWAY IMPROVEMENTS**

SCALE: 1" = 50' SHEET NO. 3 OF 14 SHEETS STA. TO STA.

F.A.U. RTE. 3860	SECTION 09-00372-00-PW	COUNTY MCHENRY	TOTAL SHEETS 252	SHEET NO. 37
FED. ROAD DIST. NO.		ILLINOIS FED. AID PROJECT		
CONTRACT NO. 63633				