

LEGEND:

	TEMPORARY PAVEMENT		TYPE II BARRICADES OR DRUMS WITH STEADY BURNING LIGHTS @ 50 FT CENTERS ALONG ROADWAY TANGENTS, 25 FT CENTERS ALONG TAPERS, AND 12 FT CENTERS ALONG RADII		VERTICAL PANEL WITH STEADY BURNING LIGHT @ 50 FT CENTERS
	WORK ZONE		TYPE III BARRICADES WITH FLASHING LIGHTS		
	DIRECTION OF TRAFFIC				

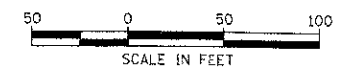

COMPANY NAME: HRGreen
 PROJECT CONTACT: J. Jattana
 CLIENT: MCHENRY COUNTY
 DATE PLOTTED: 7/23/2012 10:54:42 AM
 FILE NAME: 090071-mct10-10.dgn
 PLOT DRIVER: pefpnt
 VIEW TABLE: g:\roads\cl-trans.tbl

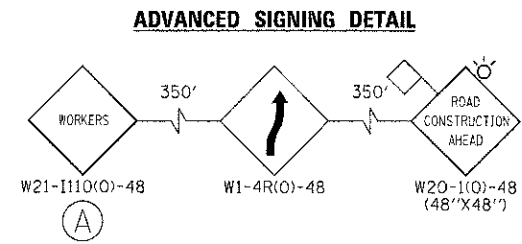
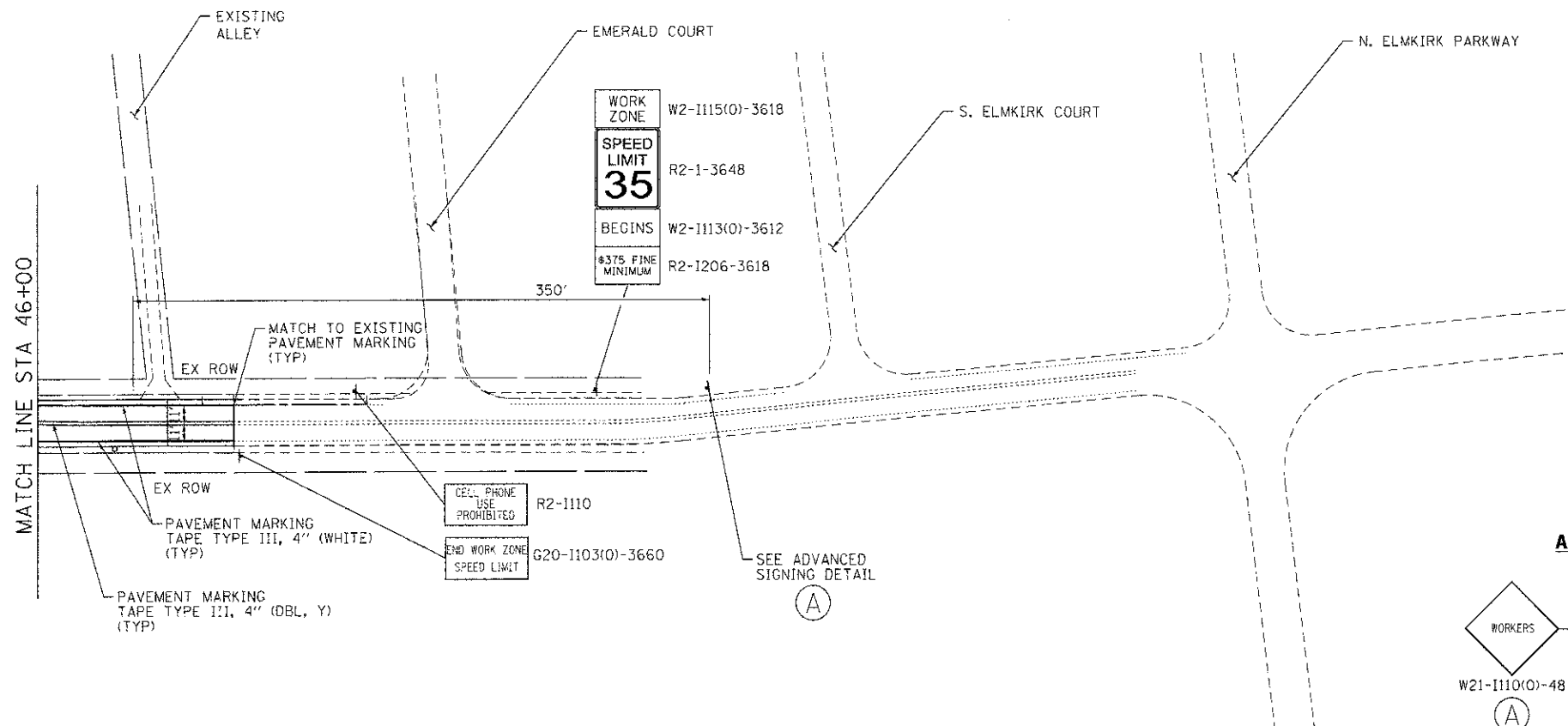

USER NAME = jattana	DESIGNED - JPA	REVISED -
FILE NAME = 090071-mct10-10.dgn	DRAWN - SVJ	REVISED -
PLOT SCALE = 1" = 50'	CHECKED - JLP	REVISED -
PLOT DATE = 7/23/2012	DATE - 7/23/12	REVISED -

**MCHENRY COUNTY
DIVISION OF TRANSPORTATION**

**SUGGESTED MAINTENANCE OF TRAFFIC - STAGE 1A
CHARLES J. MILLER ROAD ROADWAY IMPROVEMENTS**

SCALE: 1" = 50' SHEET NO. 6 OF 14 SHEETS STA. TO STA.

F.A.U. RTE.	SECTION	COUNTY	TOTAL SHEETS	SHEET NO.
3860	09-00372-00-PW	MCHENRY	252	40
CONTRACT NO. 63633			FED. ROAD DIST. NO. ILLINOIS FED. AID PROJECT	