

PLAN	SURVEYED	BY	DATE
NOTE BOOK	PLOTTED		
NO.	CHECKED		
	DATE		
	FILE NAME		
	PLOT DRIVER		
	PEN TABLE		

PROF. I.E.	SURVEYED	BY	DATE
NOTE BOOK	PLOTTED		
NO.	CHECKED		
	DATE		
	FILE NAME		
	PLOT DRIVER		
	PEN TABLE		

COMPANY NAME: HRGreen
 PROJECT CONTACT: J. JONES
 CLIENT: MCHENRY COUNTY
 DATE PLOTTED: 7/23/2012 11:48:56 AM
 FILE NAME: 090071.pwp-1-09a.dgn
 PLOT DRIVER: pdf.plt
 PEN TABLE: standard-trans.tbl

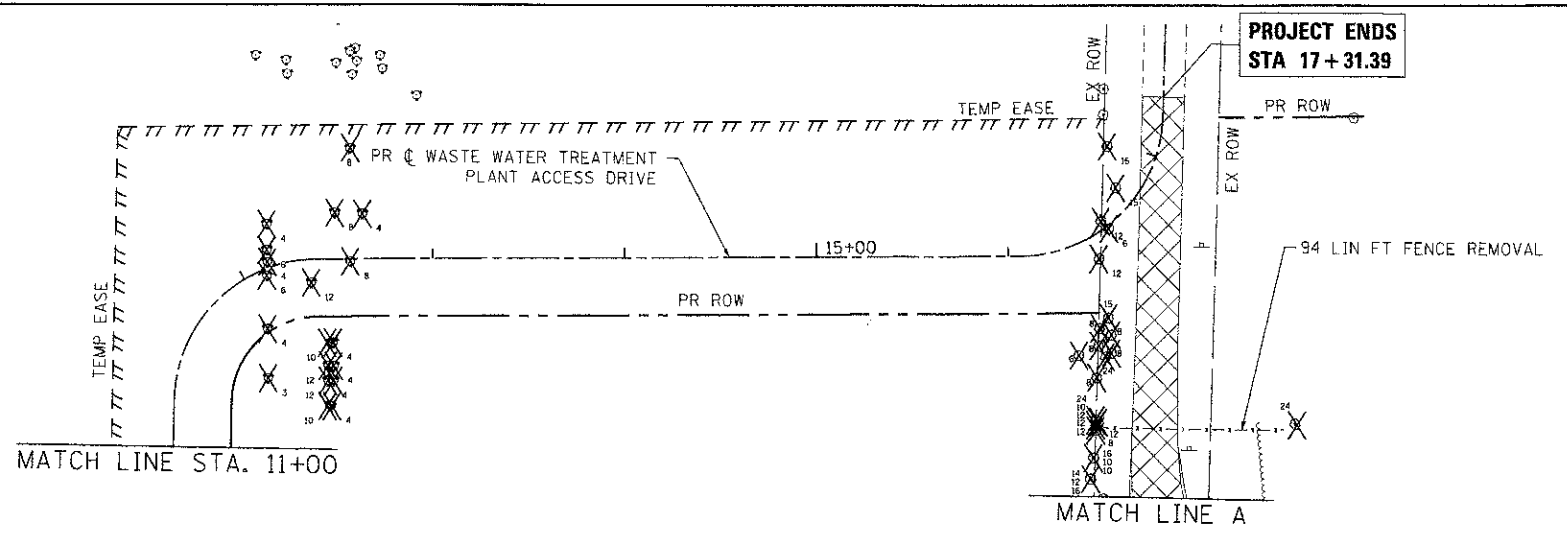

LEGEND:

[Symbol]	PAVEMENT REMOVAL
[Symbol]	PAVED SHOULDER REMOVAL
[Symbol]	AGGREGATE SHOULDER REMOVAL (PAID FOR AS REMOVAL AND DISPOSAL OF UNSUITABLE MATERIAL)
[Symbol]	COMBINATION CURB & GUTTER REMOVAL
[Symbol]	TREE REMOVAL
[Symbol]	DRIVEWAY PAVEMENT REMOVAL
[Symbol]	SIDEWALK REMOVAL
[Symbol]	HOT-MIX ASPHALT SURFACE REMOVAL - 2"
[Symbol]	HOT-MIX ASPHALT SURFACE REMOVAL - BUTT JOINT

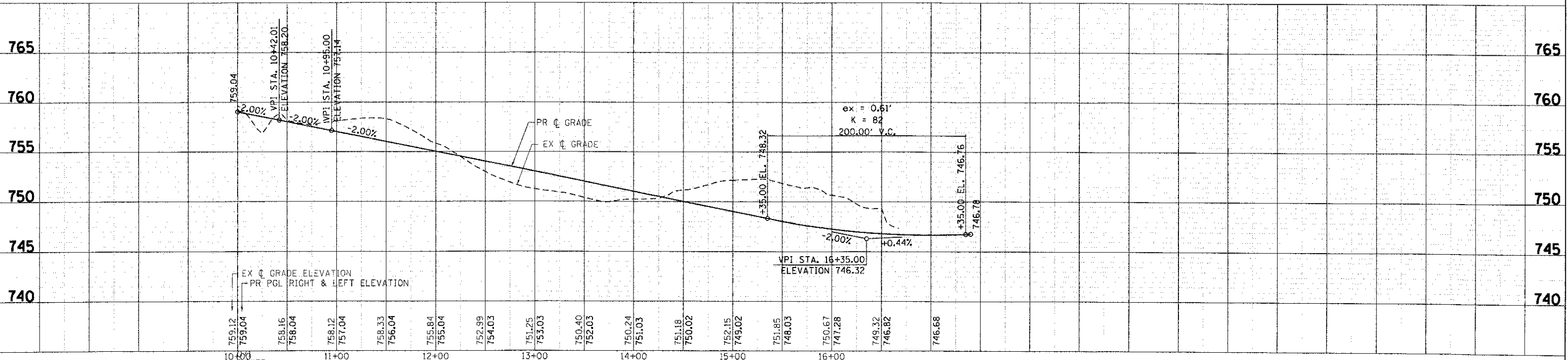
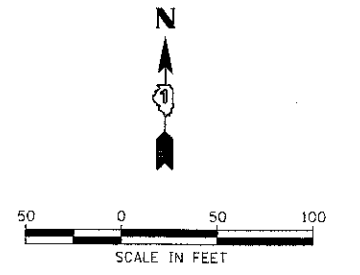
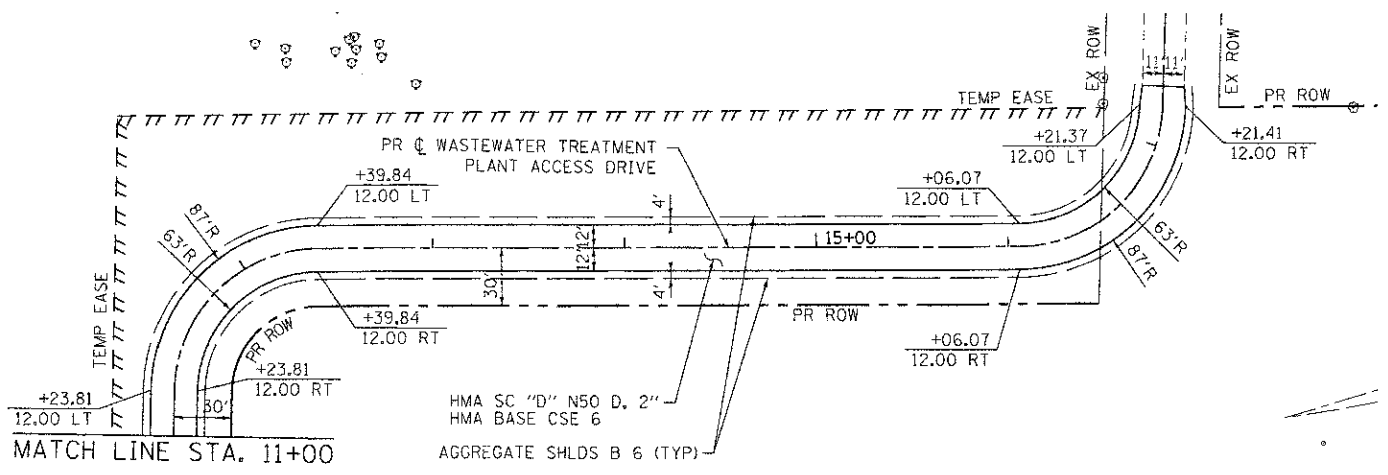

	USER NAME = j.jones	DESIGNED - JPA	REVISED -	MCHENRY COUNTY DIVISION OF TRANSPORTATION	ROADWAY PLAN AND PROFILE - WASTE WATER TREATMENT PLANT ACCESS DRIVE - CHARLES J. MILLER ROAD ROADWAY IMPROVEMENTS	F.A.U. RTE. 3860	SECTION 09-00372-00-PW	COUNTY MCHENRY	TOTAL SHEETS 252	SHEET NO. 55
	PLOT SCALE = 1" = 50'	CHECKED - JLP	REVISED -			CONTRACT NO.				
	PLOT DATE = 7/23/2012	DATE = 7/23/12	REVISED -			SCALE: 1" = 50'	SHEET NO. 7 OF 7 SHEETS	STA. 572+00 TO STA. 581+00	ILLINOIS FED. AID PROJECT 63633	