

RESTORATION OF WORK AREA

RESTORATION OF THE TRAFFIC SIGNAL WORK AREA SHALL BE INCIDENTAL TO THE RELATED PAY ITEM SUCH AS FOUNDATION, CONDUIT, HANDHOLE, TRENCH AND BACKFILL, ETC., AND NO EXTRA COMPENSATION SHALL BE ALLOWED. ALL ROADWAY SURFACES SUCH AS SHOULDERS, MEDIANS, SIDEWALKS, PAVEMENT, ETC. SHALL BE REPLACED IN KIND. ALL DAMAGE TO MOWED LAWNS SHALL BE REPLACED WITH AN APPROVED SOD AND ALL DAMAGE TO UNMOWED LAWNS SHALL BE SEEDED IN ACCORDANCE WITH STANDARD SPECIFICATIONS 252 AND 250 RESPECTIVELY.

THE VIDEO DETECTION EQUIPMENT FOR THIS PROJECT SHALL BE AUTOSCOPE AS REQUIRED BY THE MCHENRY COUNTY DIVISION OF TRANSPORTATION.

THE TRAFFIC SIGNAL CONTROL EQUIPMENT SHALL BE "ECONOLITE" AS REQUIRED BY THE MCHENRY COUNTY DIVISION OF TRANSPORTATION.

NOTE:

THE EMERGENCY VEHICLE PREEMPTION EQUIPMENT FOR THIS PROJECT SHALL BE OPTICON OR AN APPROVED EQUAL AS REQUIRED BY THE MCHENRY TOWNSHIP FIRE DEPARTMENT.

NOTE:

STOP BARS ARE NOT TO BE PLACED PRIOR TO PROPOSED TRAFFIC SIGNALS BEING OPERATIONAL. THEY MUST BE IN PLACE, HOWEVER, AT THE TIME OF TURN-ON.

NOTE:

NEW LED CONFIRMATION BEACONS IN ACCORDANCE WITH THE SPECIFICATIONS FOR EVP SHALL BE INCLUDED IN THE COST OF THE UNINTERRUPTABLE POWER SUPPLY, SPECIAL.

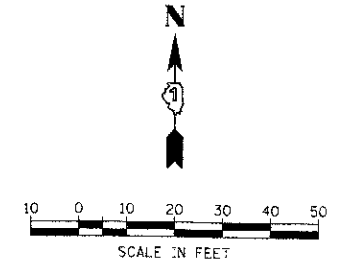
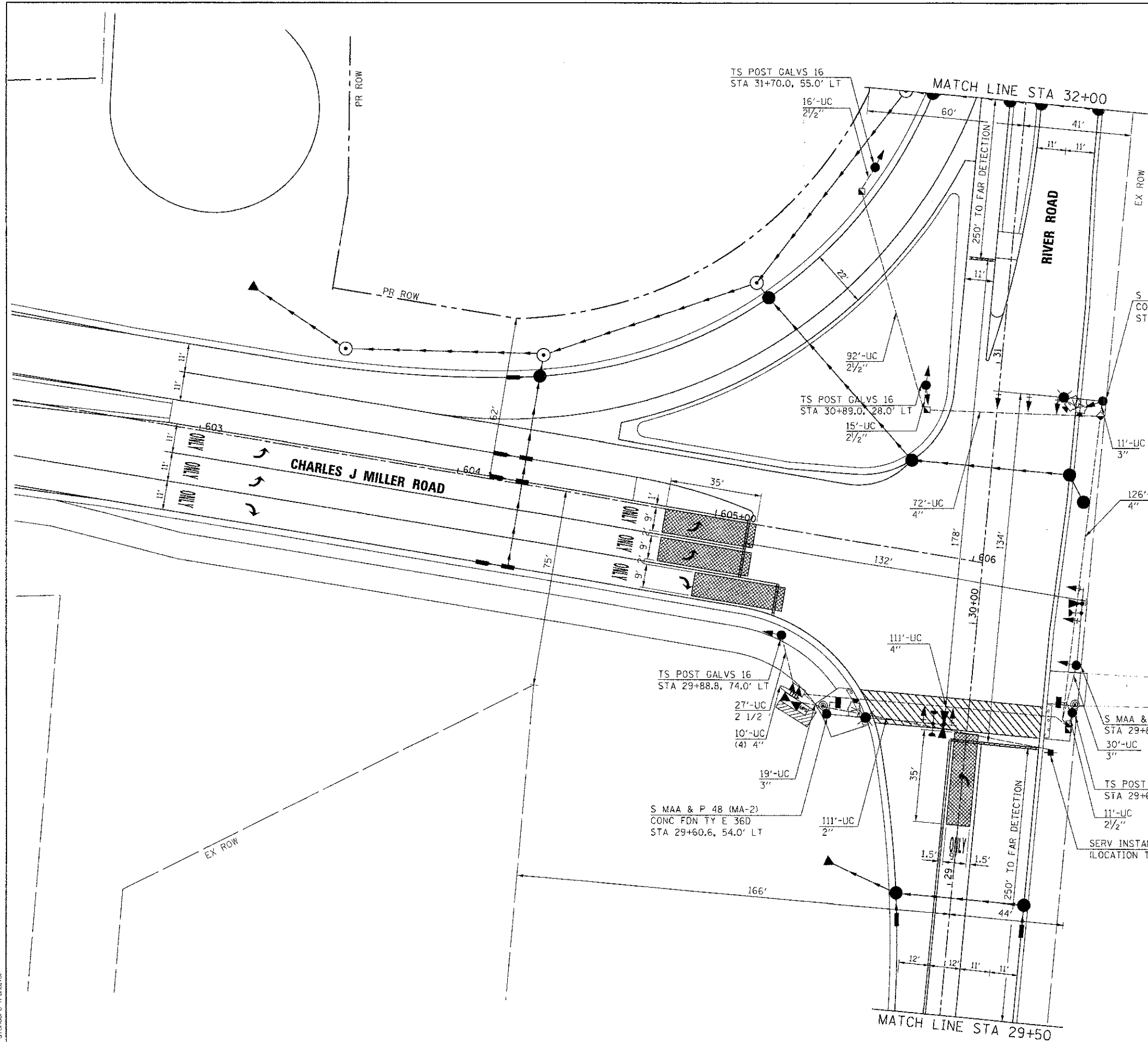

COMPANY NAME: HRGreen
 PROJECT CONTACT: jattana
 CLIENT: MCHENRY COUNTY DIVISION OF TRANSPORTATION
 DATE PLOTTED: 7/23/2012 11:57:02 AM
 FILE NAME: 090071-010-03b1-river.dgn
 PLOT DRIVER: pdt.plt
 PEN TABLE: standard-trans.tbl

HRGreen.com
 Illinois Professional Design Firm
 #184-001322

USER NAME = jattana	DESIGNED -	REVISED -
FILE NAME = 090071-010-03b1-river.dgn	DRAWN -	REVISED -
PLOT SCALE = 1" = 20'	CHECKED -	REVISED -
PLOT DATE = 7/23/2012	DATE = 7/23/12	REVISED -

**MCHENRY COUNTY
 DIVISION OF TRANSPORTATION**

**TRAFFIC SIGNAL INSTALLATION PLAN
 CHARLES J. MILLER ROAD AND RIVER ROAD**

SCALE: 1" = 20' SHEET NO. 1 OF 4 SHEETS STA. TO STA.

F.A.U. RTE.	SECTION	COUNTY	TOTAL SHEETS	SHEET NO.
3860	09-00372-00-PW	MCHENRY	252	105
CONTRACT NO. 63633				
FED. ROAD DIST. NO. ILLINOIS FED. AID PROJECT				