

SUMMARY OF QUANTITIES - ROADWAY LIGHTING IMPROVEMENT

PAY ITEM	DESCRIPTION	UNIT	QUANTITY
80400100	ELECTRIC SERVICE INSTALLATION	EACH	1
80400200	ELECTRIC UTILITY SERVICE CONNECTION	L SUM	1
81028200	UNDERGROUND CONDUIT, GALVANIZED STEEL, 2" DIA.	FOOT	50
81028240	UNDERGROUND CONDUIT, GALVANIZED STEEL, 4" DIA.	FOOT	155
81200230	CONDUIT EMBEDDED IN STRUCTURE, 2" DIA., PVC	FOOT	620
81300830	JUNCTION BOX, STAINLESS STEEL, ATTACHED TO STRUCTURE, 18" X 18" X 8"	EACH	4
81603050	UNIT DUCT, 600V, 3-1C NO.6, 1/C NO.8 GROUND, (XLP-TYPE USE), 1" DIA. POLYETHYLENE	FOOT	2,225
81702120	ELECTRIC CABLE IN CONDUIT, 600V (XLP-TYPE USE) 1/C NO. 8	FOOT	638
81702130	ELECTRIC CABLE IN CONDUIT, 600V (XLP-TYPE USE) 1/C NO. 6	FOOT	1,914
81702160	ELECTRIC CABLE IN CONDUIT, 600V (XLP-TYPE USE) 1/C NO. 1/0	FOOT	150
82102310	LUMINAIRE, SODIUM VAPOR, HORIZONTAL MOUNT, 310 WATT	EACH	18
82500350	LIGHTING CONTROLLER, BASE MOUNTED, 240VOLT, 100AMP	EACH	1
83008200	LIGHT POLE, ALUMINUM, 40 FT. M.H., 6 FT. MAST ARM	EACH	6
83008500	LIGHT POLE, ALUMINUM, 40 FT. M.H., 12 FT. MAST ARM	EACH	10
83600355	LIGHT POLE FOUNDATION, METAL, 15" BOLT CIRCLE, 8" X 6'	EACH	7
83800205	BREAKAWAY DEVICE, TRANSFORMER BASE, 15 INCH BOLT CIRCLE	EACH	6
84200500	REMOVAL OF LIGHTING UNIT, SALVAGE	EACH	9
84200804	REMOVAL OF POLE FOUNDATION	EACH	6
87300925	ELECTRIC CABLE IN CONDUIT, TRACER, NO. 14 1C	FOOT	638

• REQUIRES SPECIAL PROVISIONS

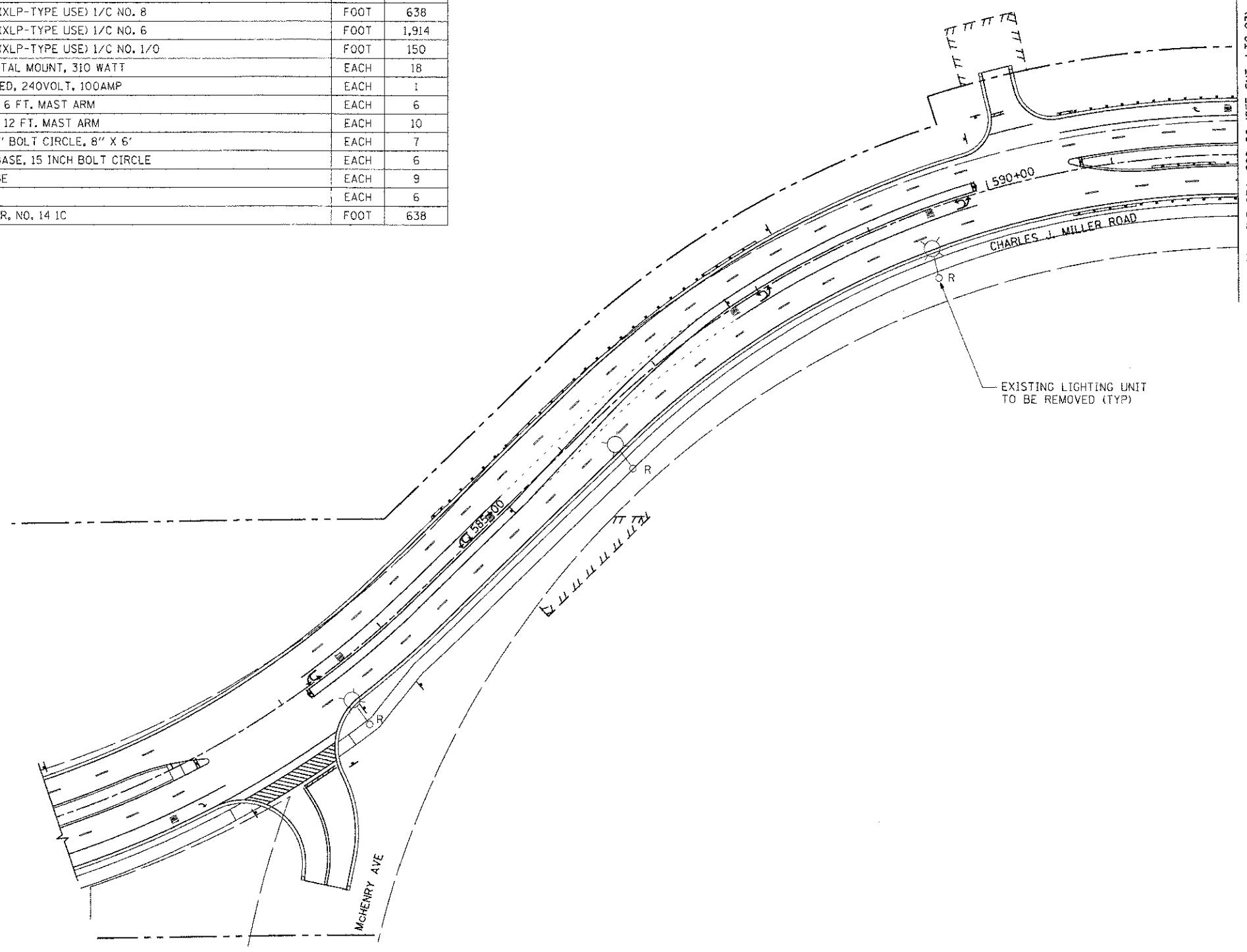

MATCH LINE STA. 592+00 (SEE SHT. LTG-03)

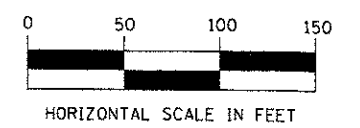

COMPANY NAME: AMES Engineering, Inc.
 PROJECT CONTACT: J. J. J. J.
 DATE PLOTTED: 7/23/2012 11:50:35 AM
 FILE NAME: 09007-LT-02.dgn
 PLOT DRIVER: pdt.plt
 PLOT TABLE: standard-trans.tbl

AMES Engineering, Inc.
 CONSULTING ENGINEERS
 1341 Warren Avenue
 Downers Grove, IL 60515
 (630) 737-1887 (630) 470-8881 (F)
 www.amesengineeringinc.com

USER NAME = jstango	DESIGNED - BL	REVISED -
FILE NAME = 09007-LT-02.dgn	DRAWN - RV/MSA	REVISED -
PLOT SCALE = 1"=50'	CHECKED - SA	REVISED -
PLOT DATE = 7/23/2012	DATE - 7/23/12	REVISED -

MCHENRY COUNTY
DIVISION OF TRANSPORTATION

SUMMARY OF QUANTITIES AND LIGHTING PLAN - STA. 581+00 TO STA. 592+00 - CHARLES J. MILLER ROAD ROADWAY IMPROVEMENTS

F.A.U. R.T.E. 3860	SECTION 09-00372-00-PW	COUNTY MCHENRY	TOTAL SHEETS 252	SHEET NO. 116
FED. ROAD DIST. NO. ILLINOIS FED. AID PROJECT			CONTRACT NO. 63633	

LTG-02