

FINAL SURVEY	BY	DATE
SURVEYED		
PLOTTED		
TEMPLATE		
NOTE BOOK		
AREAS CHECKED		
NO.		

ORIGINAL SURVEY	BY	DATE
SURVEYED		
PLOTTED		
TEMPLATE		
NOTE BOOK		
AREAS CHECKED		
NO.		

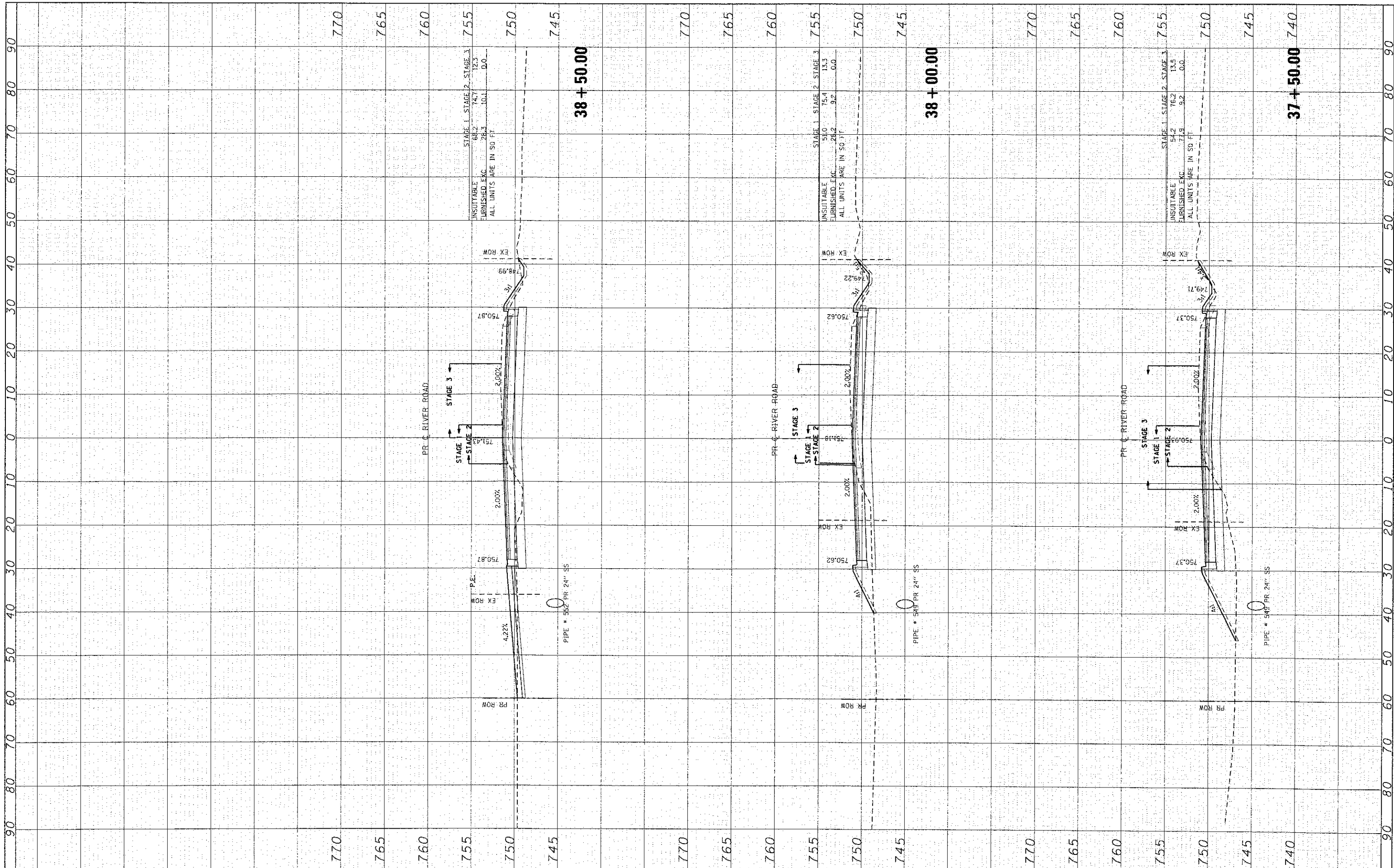

	USER NAME = jottano	DESIGNED - CMH	REVISED -	STATE OF ILLINOIS DEPARTMENT OF TRANSPORTATION	PROPOSED CROSS SECTIONS RIVER ROAD				<table border="1"> <tr><th>F.A. RTE.</th><th>SECTION</th><th>COUNTY</th><th>TOTAL SHEETS</th><th>SHEET NO.</th></tr> <tr><td>3860</td><td>09-00372-00-PW</td><td>MCHENRY</td><td>252</td><td>246</td></tr> <tr><td colspan="4"></td><td>CONTRACT NO.</td></tr> <tr><td colspan="4"></td><td>ILLINOIS FED. AID PROJECT</td></tr> <tr><td colspan="4"></td><td>63633</td></tr> </table>	F.A. RTE.	SECTION	COUNTY	TOTAL SHEETS	SHEET NO.	3860	09-00372-00-PW	MCHENRY	252	246					CONTRACT NO.					ILLINOIS FED. AID PROJECT					63633
	F.A. RTE.	SECTION	COUNTY		TOTAL SHEETS	SHEET NO.																												
	3860	09-00372-00-PW	MCHENRY		252	246																												
				CONTRACT NO.																														
				ILLINOIS FED. AID PROJECT																														
				63633																														
PLOT SCALE = 1" = 10'	CHECKED - JLP	REVISIED -	REVISIED -	SCALE: 1" = 10'	SHEET NO. 56 OF 62 SHEETS	STA. 37+50.00	TO STA. 38+50.00																											
PLOT DATE = 7/23/2012	DATE - 5/29/12	REVISIED -	REVISIED -																															