

STATE OF ILLINOIS
DEPARTMENT OF TRANSPORTATION
DIVISION OF HIGHWAYS
PLANS FOR PROPOSED
FEDERAL AID HIGHWAY
FAP 336 (RANDALL ROAD) (CH 34)
AT FAP 527 (BIG TIMBER ROAD) (CH 21)
INTERSECTION AND SAFETY
IMPROVEMENTS
SECTION: 08-00369-00-SP
PROJECT NO: HSIP-9003 (055)
JOB NO: C-91-509-08
KANE COUNTY

FAP RTE	SECTION	COUNTY	TOTAL SHEETS	SHEET NO.
527	08-00369-00-SP	KANE	67	1
CONTRACT #			63669	
ILLINOIS FED. AID PROJECT				

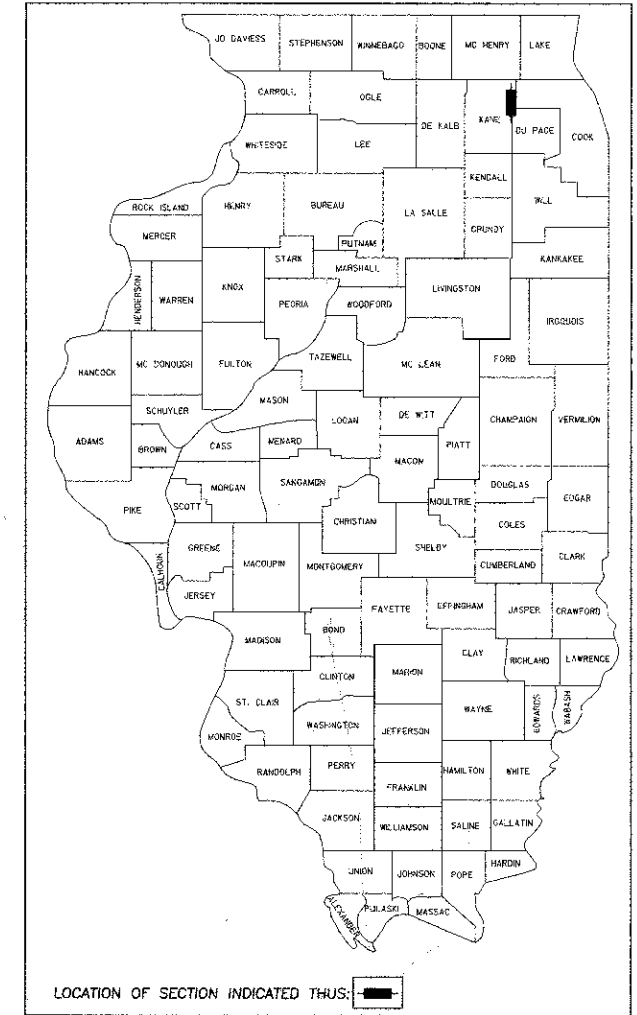

THIS PROJECT IS LOCATED IN THE CITY OF ELGIN

DESIGN DESIGNATION:

FUNCTIONAL CLASSIFICATIONS
 BIG TIMBER ROAD = OTHER PRINCIPAL ARTERIAL
 RANDALL ROAD = OTHER PRINCIPAL ARTERIAL

POSTED SPEED LIMIT
 BIG TIMBER ROAD = 45 M.P.H.
 RANDALL ROAD = 45 M.P.H.

DESIGN SPEED LIMIT
 BIG TIMBER ROAD = 45 M.P.H.
 RANDALL ROAD = 45 M.P.H.

DESIGN ADT
 BIG TIMBER ROAD = 16,100
 RANDALL ROAD = 52,800

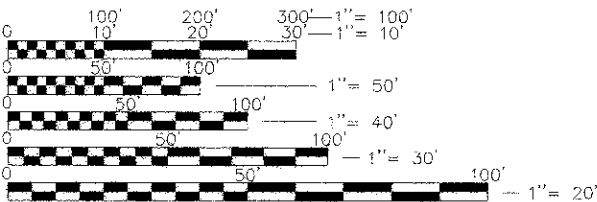

FULL SIZE PLANS HAVE BEEN PREPARED USING STANDARD ENGINEERING SCALES. REDUCED SIZED PLANS WILL NOT CONFORM TO STANDARD SCALES. IN MAKING MEASUREMENTS ON REDUCED PLANS, THE ABOVE SCALES MAY BE USED.



CONTRACT NO: 63669

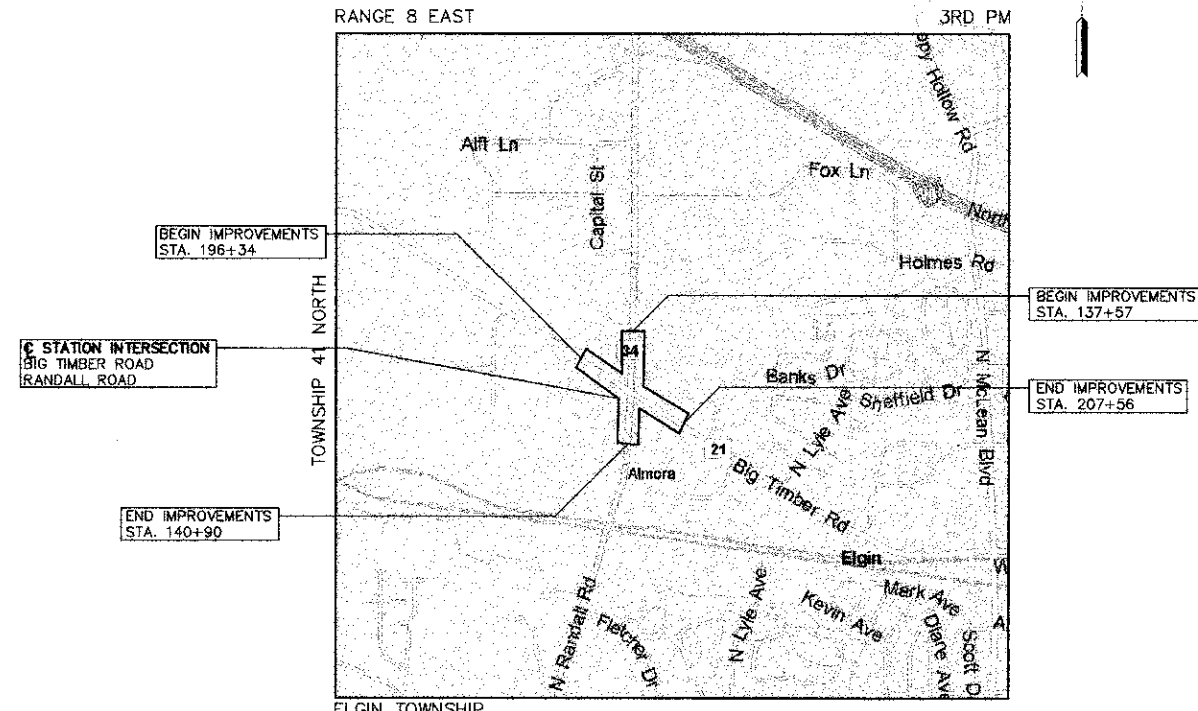

LOCATION MAP
(NOT TO SCALE)

GROSS AND NET LENGTH OF PROJECT

BIG TIMBER ROAD	= 1122 FEET (0.195 MILES)
RANDALL ROAD	= 333 FEET (0.048 MILES)
TOTAL	= 1,455 FEET (0.243 MILES)

STATE OF ILLINOIS
DEPARTMENT OF TRANSPORTATION
DIVISION OF HIGHWAYS

APPROVED: MARCH 21 20 12
 KANE COUNTY DIVISION OF TRANSPORTATION, COUNTY ENGINEER

PASSED: APRIL 2 20 12
 DISTRICT ONE ENGINEER OF LOCAL ROADS AND STREETS

RELEASING FOR BID
 BASED ON LIMITED REVIEW: APRIL 2 20 12
 DEPUTY DIRECTOR OF HIGHWAYS, REGION ONE ENGINEER

PROFESSIONAL ENGINEER'S SIGNATURE & SEAL
 Kevin L. Belgrave 3/21/12
 KEVIN L. BELGRAVE, P.E. DATE
 EXPIRES: 11/30/13 SEAL

PROFESSIONAL ELECTRICAL ENGINEER'S SIGNATURE & SEAL
 Arthur J. Penn 3/21/12
 ARTHUR J. PENN, P.E. DATE
 EXPIRES: 11/30/13 SEAL

PRINTED BY THE AUTHORITY OF THE STATE OF ILLINOIS

GEWALT HAMILTON ASSOCIATES, INC.
 850 Forest Edge Drive • Vernon Hills, IL 60061
 Phone: 847-478-9700 Fax: 847-478-9701

PROGRAM AND OFFICE ENGINEER: CHARLES F. RIDDLE, P.E. (847) 705-4408 SCHAUMBURG, IL