

PROPOSED CONDITIONS LEGEND

HMA PAVEMENT (SEE TYPICAL SECTION)	
HMA SHOULDER, 8"	
AGGREGATE SHOULDER, 8"	
HMA DRIVEWAY PAVEMENT	
WETLAND	
B6.24 CURB AND GUTTER	

NOTE 1: WHEN PAVEMENT WIDENING IS 6' WIDE OR LESS, RCP BASE COURSE WIDENING 9\"/>

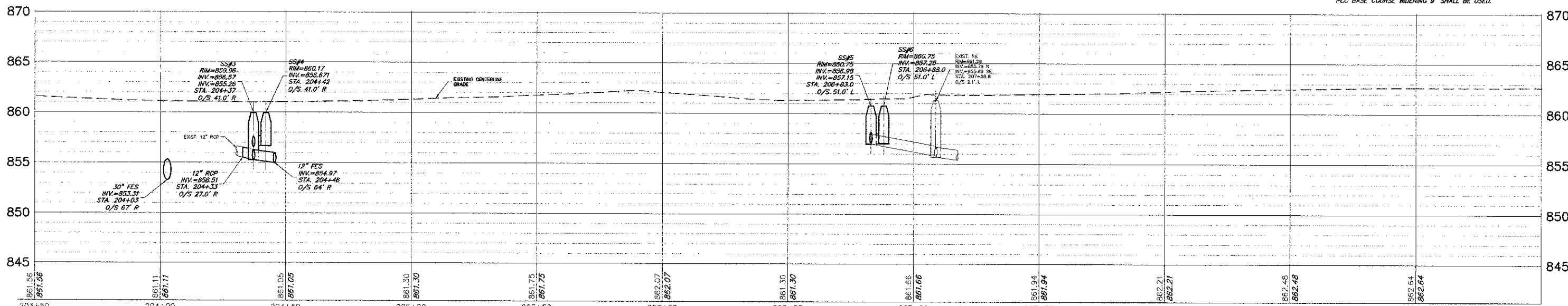

FILE NAME = 4459.000-PR3.dwg	USER NAME = BETHANY SUMMSKI	DESIGNED - KLB	REVISED -	STATE OF ILLINOIS DEPARTMENT OF TRANSPORTATION	PLAN AND PROFILE BIG TIMBER ROAD STA. 203+50 TO STA. 209+50			F.A.P. RITE 527	SECTION 08-00369-00-SP	COUNTY KANE	TOTAL SHEETS 67	SHEET NO. 12
PLOT SCALE = 1" = .0833'	DATE = 3/21/2012	DRAWN - PJS	REVISED -		SCALE 1" = 20'	SHEET NO. OF SHEETS	STA. TO STA.	ILLINOIS FED. AID PROJECT CONTRACT # 63669				
PLOT DATE = 3/21/2012	DATE = 3/21/2012	CHECKED - KLB	REVISED -									
		DATE = 3/21/2012	REVISED -									