

CONSTRUCTION NOTES:

- 1 THE CONTRACTOR SHALL REINSTALL THE EXISTING LIGHT DETECTORS, CONFIRMATION BEACONS, AND LIGHT DETECTOR AMPLIFIER TO THEIR RESPECTIVE NEW MAST ARMS AND NEW CONTROLLER CABINET.
- 2 THE CONTRACTOR SHALL REINSTALL THE EXISTING CONTROLLER, THE EXISTING ETHERNET COMMUNICATIONS EQUIPMENT (COMPLETE) INCLUDING THE MANAGED TYPE 1 SWITCH, AND MALFUNCTION MANAGEMENT UNIT IN THE NEW TS2 CABINET ON THE EXISTING TYPE D CONTROLLER FOUNDATION.
- 3 THE CONTRACTOR SHALL INSTALL THE EXISTING COILED FIBER OPTIC AND TRACER CABLES IN THE NEW OR EXISTING CONDUIT TO THE NEW CONTROLLER CABINET.
- 4 THE EXISTING MALFUNCTION MANAGEMENT UNIT RELOCATED TO THE TEMPORARY TRAFFIC SIGNAL INSTALLATION SHALL BE RELOCATED TO THE PERMANENT TRAFFIC SIGNAL INSTALLATION AND INSTALLED IN THE NEW CONTROLLER CABINET. ALL RELOCATED EQUIPMENT SHALL BE FULLY INTEGRATED INTO THE RANDALL ROAD ETHERNET SYSTEM. ALL WORK REQUIRED TO RELOCATE AND REINSTALL THIS TRAFFIC SIGNAL EQUIPMENT TO THE SATISFACTION OF THE KDOT ENGINEER AND THE KDOT TRAFFIC MANAGER SHALL BE INCLUDED IN THE CONTRACT UNIT PRICE EACH FOR "RELOCATE EXISTING TRAFFIC SIGNAL EQUIPMENT".
- 5 THE NEW UNINTERRUPTIBLE POWER SUPPLY (SPECIAL KDOT) SHALL BE RELOCATED TO THE PERMANENT TRAFFIC SIGNAL INSTALLATION AND INSTALLED ON THE EXISTING TYPE "D" FOUNDATION. THE NEW UPS SHALL BE FULLY INTEGRATED INTO THE RANDALL ROAD ETHERNET SYSTEM. ALL WORK REQUIRED TO INSTALL THIS TRAFFIC SIGNAL EQUIPMENT TO THE SATISFACTION OF THE KDOT ENGINEER AND KDOT TRAFFIC MANAGER SHALL BE INCLUDED IN THE CONTRACT UNIT PRICE EACH FOR "UNINTERRUPTIBLE POWER SUPPLY (SPECIAL KDOT)".
- 6 THE EXISTING ETHERNET IP CARD RELOCATED TO THE TEMPORARY TRAFFIC SIGNAL INSTALLATION SHALL BE RELOCATED TO THE PERMANENT TRAFFIC SIGNAL INSTALLATION AND INSTALLED INTO THE RELOCATED UPS. THE RELOCATED ETHERNET IP CARD SHALL BE FULLY INTEGRATED INTO THE RANDALL ROAD ETHERNET SYSTEM. ALL WORK REQUIRED TO RELOCATE AND REINSTALL THIS TRAFFIC SIGNAL EQUIPMENT TO THE SATISFACTION OF THE KDOT ENGINEER AND KDOT TRAFFIC MANAGER SHALL BE INCLUDED IN THE CONTRACT UNIT PRICE EACH FOR "RELOCATE EXISTING TRAFFIC SIGNAL EQUIPMENT".
- 7 THE EXISTING PAN, TILT, ZOOM CAMERA AND THE ETHERNET MANAGED SWITCH, TYPE 1 SHALL BE RELOCATED FROM THE TEMPORARY TRAFFIC SIGNAL INSTALLATION TO THE PERMANENT TRAFFIC SIGNAL INSTALLATION. ALL WORK REQUIRED TO RELOCATE AND REINSTALL THIS TRAFFIC SIGNAL EQUIPMENT TO THE SATISFACTION OF THE KDOT ENGINEER AND KDOT TRAFFIC MANAGER SHALL BE INCLUDED IN THE PAY ITEMS "VIDEO TRAFFIC MONITORING SYSTEM WITH PTZ CAMERA" AND "ETHERNET SWITCH, TYPE 1".

NOTE:
THE EXISTING CONTROLLER IS AN EAGLE MODEL M-52 WITH VERSION 3.33 E SOFTWARE IN A TYPE IV CABINET.

IMPORTANT NOTE:
REFER TO THE PERMANENT LIGHTING MODERNIZATION PLAN FOR ADDITIONAL NUMBER AND SIZE OF CONDUITS TO BE INSTALLED IN ALL COMBINATION MAST ARM ASSEMBLY AND POLE FOUNDATIONS.

SIGN DETAILS



R4-7
24"x30" (TYPICAL)
SIGN PANEL TYPE 1
(5 REQUIRED)



R1-7
(VERTICAL TRI-FOLD)
30"x30"
SIGN DETAIL
(4 REQUIRED)
DELIVERED AND INSTALLED BY
KDOT SIGN CREWS

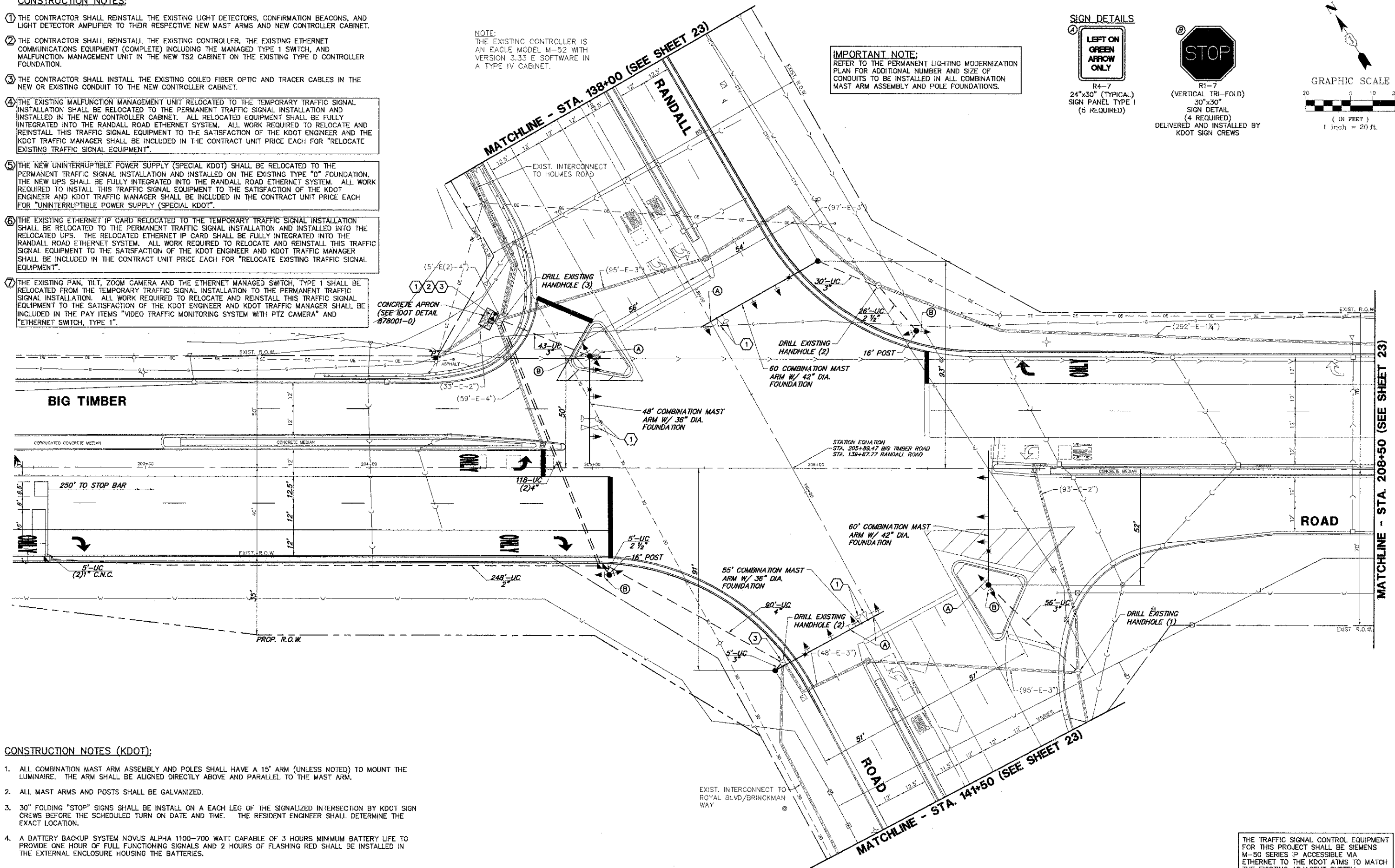
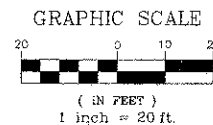

CONSTRUCTION NOTES (KDOT):

1. ALL COMBINATION MAST ARM ASSEMBLY AND POLES SHALL HAVE A 15' ARM (UNLESS NOTED) TO MOUNT THE LUMINAIRE. THE ARM SHALL BE ALIGNED DIRECTLY ABOVE AND PARALLEL TO THE MAST ARM.
2. ALL MAST ARMS AND POSTS SHALL BE GALVANIZED.
3. 30" FOLDING "STOP" SIGNS SHALL BE INSTALL ON A EACH LEG OF THE SIGNALIZED INTERSECTION BY KDOT SIGN CREWS BEFORE THE SCHEDULED TURN ON DATE AND TIME. THE RESIDENT ENGINEER SHALL DETERMINE THE EXACT LOCATION.
4. A BATTERY BACKUP SYSTEM NOVUS ALPHA 1100-700 WATT CAPABLE OF 3 HOURS MINIMUM BATTERY LIFE TO PROVIDE ONE HOUR OF FULL FUNCTIONING SIGNALS AND 2 HOURS OF FLASHING RED SHALL BE INSTALLED IN THE EXTERNAL ENCLOSURE HOUSING THE BATTERIES.

THE TRAFFIC SIGNAL CONTROL EQUIPMENT FOR THIS PROJECT SHALL BE SIEMENS M-50 SERIES IP ACCESSIBLE VIA ETHERNET TO THE KDOT ATMS TO MATCH THE EXISTING ADJACENT SYSTEM.

FILE NAME = 4459.000- TR1.dwg	USER NAME = ZACH WALLSTEN	DESIGNED = JRD	REVISED =	STATE OF ILLINOIS DEPARTMENT OF TRANSPORTATION	TRAFFIC SIGNAL MODERNIZATION PLAN BIG TIMBER ROAD (CH 21) AT RANDALL ROAD (CH 34)	F.A.P. RTE. = 527	SECTION = 08-00369-00-SP	COUNTY = KANE	TOTAL SHEETS = 67	SHEET NO. = 22
PLOT SCALE = 1" = .0833'	CHECKED = KLB	REVISED =	CONTRACT # = 63669							
PLOT DATE = 3/21/2012	DATE = 3/21/2012	REVISED =	ILLINOIS FED. AID PROJECT							
SCALE: 1"=20'		SHEET NO. OF SHEETS STA. TO STA.								