

RESTORATION OF WORK AREA, RESTORATION OF THE TRAFFIC SIGNAL WORK AREA SHALL BE INCIDENTAL TO THE RELATED PAY ITEM SUCH AS FOUNDATION, CONDUIT, HANDHOLE, TRENCH AND BACKFILL, ETC., AND NO EXTRA COMPENSATION SHALL BE ALLOWED. ALL ROADWAY SURFACES SUCH AS SHOULDERS, MEDIANS, SIDEWALKS, PAVEMENT, ETC. SHALL BE REPLACED IN KIND. ALL DAMAGE TO MOWED LAWNS SHALL BE REPLACED WITH AN APPROVED SOG, AND ALL DAMAGE TO UNMOWED FIELDS SHALL BE SEEDING IN ACCORDANCE WITH STANDARD SPECIFICATIONS 252 AND 250 RESPECTIVELY.

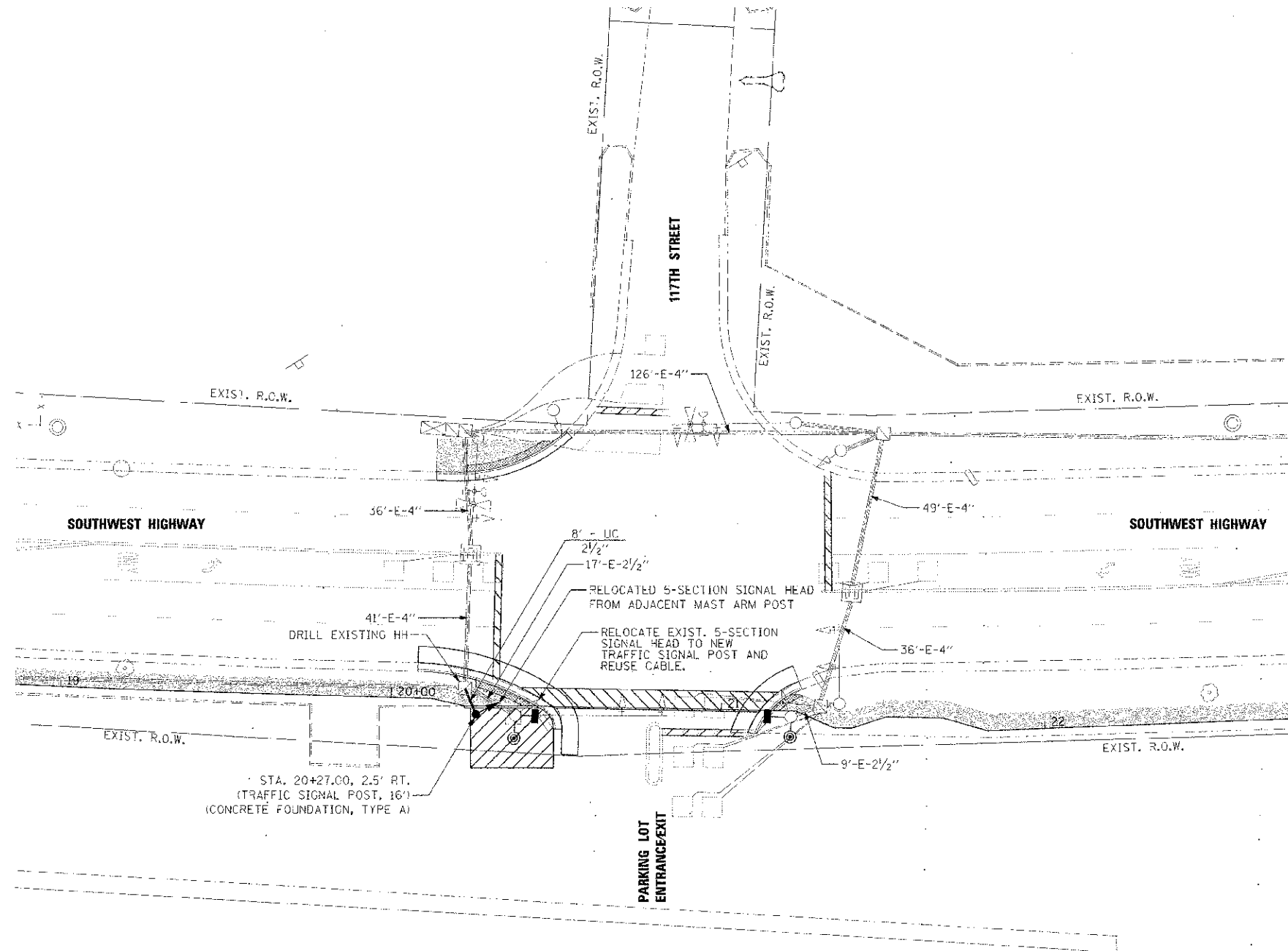

NOTES:

1. ALL PEDESTRIAN SIGNAL HEADS TO BE L.E.D. (LIGHT EMITTING DIODE).
2. ANY DAMAGE TO THE PROPOSED SIDEWALKS SHALL BE REPLACED IN KIND BY THE CONTRACTOR AT NO ADDITIONAL COST.
3. FOR DETAILS SEE DISTRICT ONE STANDARD TRAFFIC SIGNAL DESIGN DETAILS.

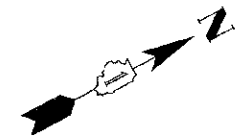
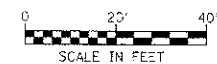

P.L.T. NAME - 011515



100 S. WACKER DR.
SUITE 500
CHICAGO IL 60606
TEL (312) 433-4000
FAX (312) 433-4196

| | |
|----------|---------------|
| DESIGNED | KLM |
| DRAWN | KLM |
| CHECKED | DDL |
| DATE | JUNE 29, 2012 |

| | |
|----------|--|
| REVISION | |
| REVISION | |
| REVISION | |
| REVISION | |

STATE OF ILLINOIS
DEPARTMENT OF TRANSPORTATION

TRAFFIC SIGNAL PLAN
SOUTHWEST HIGHWAY AND 117TH STREET

SCALE: 1" = 20' DRAWING NO. OF ST4. TO STA.

| | | | | |
|---------------------------|----------------|--------|--------------|--------------------|
| F.A.U. RT. NO. | SECTION | COUNTY | TOTAL SHEETS | SHEET NO. |
| 3378 | 11-00049-00-SW | COOK | 29 | 9 |
| | | | | CONTRACT NO. 63732 |
| ILLINOIS FED. AID PROJECT | | | | |