

**PROPOSED TYPICAL SECTION 22**  
**MORTON AVE**

BRIDGE OMISSION STA 34+86.75 TO STA 37+99.73 (MORTON AVE OVER I-74)

**PAVEMENT DESIGN MORTON AVE**

STRUCTURAL DESIGN TRAFFIC:	Year	2024
PV =	19,132	SU = 853 SU = 811
ROAD CLASSIFICATION	CLASS I	
PERCENT OF STRUCTURAL DESIGN TRAFFIC IN DESIGN LANE:	P = 32% S = 45% M = 45%	
TRAFFIC FACTOR:	Actual TF = 6.21	AC Type = N/A
	Minimum TF = 10.05	
PG GRADE:	Binder = N/A	Surface = N/A
SUBGRADE SUPPORT RATING:	SSR = POOR (Sta. 26+94.00 to 49+30.67)	

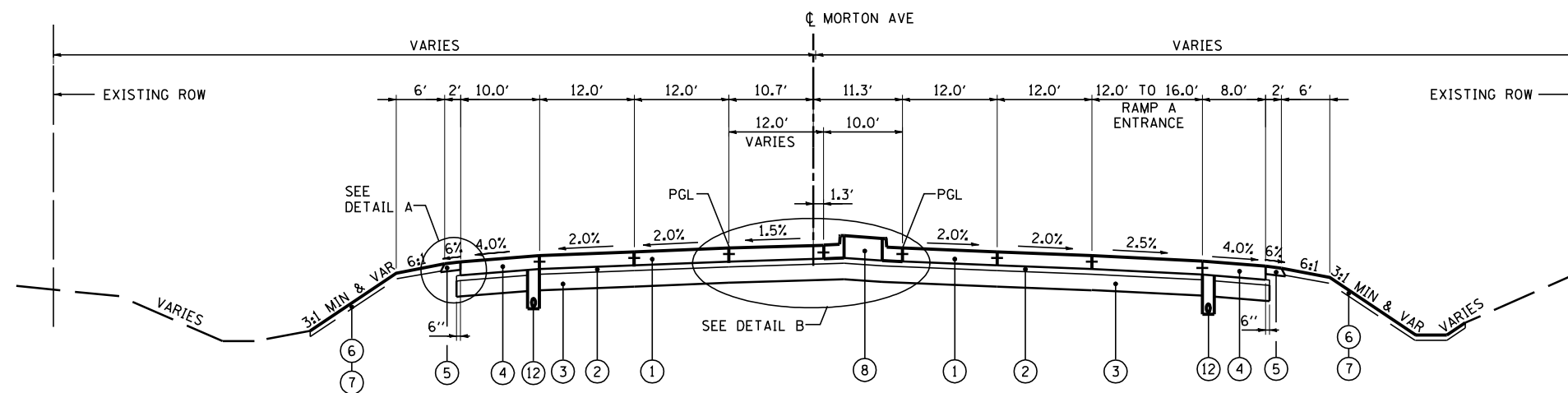

**PROPOSED TYPICAL SECTION 23**  
**MORTON AVE**

STA 37+99.73 TO STA 44+09.68

**PROPOSED LEGEND:**

- ① PORTLAND CEMENT CONCRETE PAVEMENT 10" (JOINTED)
- ② SUBBASE GRANULAR MATERIAL, TYPE A, 4" (SEE NOTE 2)
- ③ SUBBASE GRANULAR MATERIAL, TYPE A, 12" (SEE NOTE 3)
- ④ PORTLAND CEMENT CONCRETE SHOULDERS 10"
- ⑤ AGGREGATE SHOULDERS, TYPE B 6"
- ⑥ TOPSOIL FURNISH AND PLACE, 4"
- ⑦ SEEDING, CLASS 2A
- ⑧ CONCRETE MEDIAN, TYPE SB-6.24
- ⑨ COMBINATION CONCRETE CURB AND GUTTER, TYPE B-6.24
- ⑩ CONCRETE MEDIAN SURFACE, 4"
- ⑪ CORRUGATED MEDIAN
- ⑫ PIPE UNDERDRAINS 6"
- ⑬ STEEL PLATE BEAM GUARDRAIL, TYPE A, 6 FOOT POSTS
- ⑭ GUARDRAIL AGGREGATE EROSION CONTROL

**NOTE**

1. SEE CROSS SECTIONS FOR DETAIL GRADING
2. 4" OF AGGREGATE SUBBASE GRANULAR MATERIAL, TYPE A TO FILL HOLES AND IRREGULARITIES IN EXISTING SUBBASE CAUSED BY PAVEMENT REMOVAL
3. EXISTING 12" SUBBASE TO REMAIN. PROPOSED 12" OF SUBBASE GRANULAR MATERIAL, TYPE A AT LOCATIONS WHERE PROPOSED PAVEMENT WILL BE PLACED ON EXISTING EMBANKMENT THAT CURRENTLY DOES NOT HAVE AGGREGATE SUBBASE

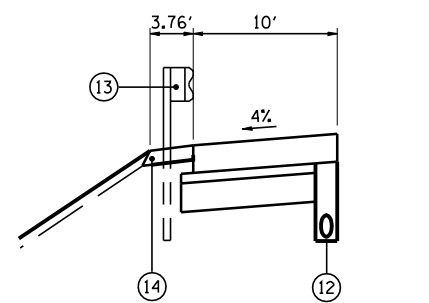

**DETAIL A**

STA 37+69.47 TO STA 41+43.00

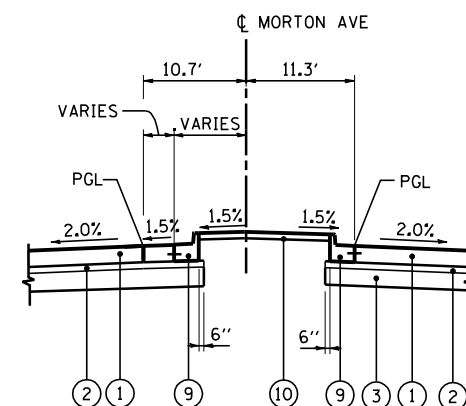

**DETAIL B**

STA 38+64.50 TO STA 40+64.40

FILE NAME =	DESIGNED - I S	REVISED -
...D468620-shd.Pr.Typ.Morton.02.dgn	DRAWN - TMB	REVISED -
USER NAME = jreambillo	CHECKED - JNR	REVISED -
PLOT DATE = 7/26/2012	DATE - JULY 20, 2012	REVISED -



**STATE OF ILLINOIS**  
**DEPARTMENT OF TRANSPORTATION**

<b>PROPOSED TYPICAL SECTIONS</b>	
<b>MORTON AVE</b>	
SCALE: NTS	SHEET NO. 2 OF 3 SHEETS
STA.	TO STA.

F.A.I. RTE.	SECTION	COUNTY	TOTAL SHEETS	SHEET NO.
90-114R(14HB-4,14,14HB)BR		TAZEWELL	2433	61
			CONTRACT NO. 68620	
ILLINOIS FED. AID PROJECT				