

PLAN	SURVEYED	DATE
	PLOTTED	BY
	ALIGNED	
	CHECKED	
	FILED	
	NO.	

PROFILE	SURVEYED	DATE
	PLOTTED	BY
	GRADES	
	CHECKED	
	STRUCTURE	
	NOTATIONS	
	CHFD	
	NO.	

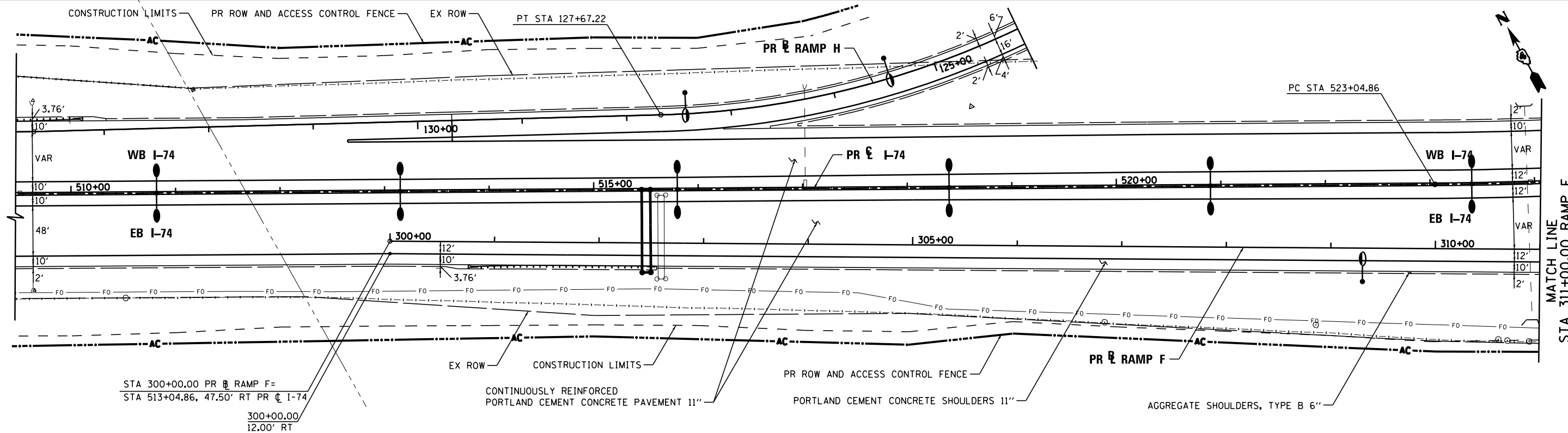

STA 300+00.00 PR B RAMP F =
 STA 513+04.86, 47.50' RT PR C I-74
 300+00.00
 12.00' RT

NOTE:
 SEE I-74 AND RAMP H
 PLAN / PROFILE

NOTE:
 SEE I-74 AND RAMP H
 PAVEMENT JOINTING / ELEVATIONS PLANS

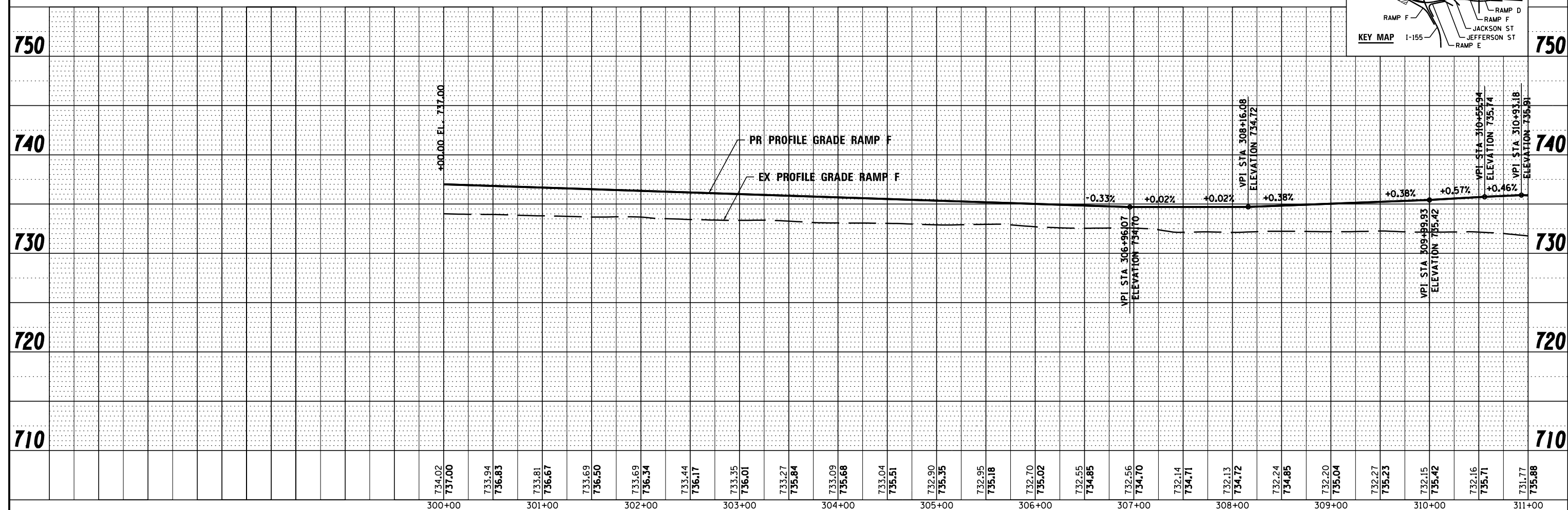
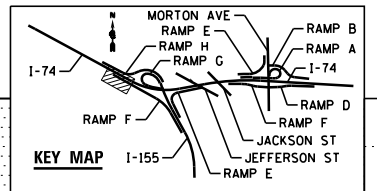

FILE NAME =	DESIGNED - AJP	REVISED -		STATE OF ILLINOIS DEPARTMENT OF TRANSPORTATION		PLAN AND PROFILE I-155 RAMP F		F.A.I. RT.	SECTION	COUNTY	TOTAL SHEETS	SHEET NO.
...D468620-sh-t-1-155-RampF-plnpr f20.dgn	DRAWN - TMB	REVISED -		SCALE: 1"=50'		SHEET NO. 4 OF 13 SHEETS	STA. POB	TO STA. 311+00.00	90-[14R(14HB-4,14,14HVB)BR]	TAZEWELL	2433	226
USER NAME = tblank	CHECKED - JNR	REVISED -		CONTRACT NO. 68620		ILLINOIS FED. AID PROJECT						
PLOT DATE = 7/17/2012	DATE - JULY 20, 2012	REVISED -										