

**LEGEND**

- DRUMS WITH STEADY BURNING WARNING LIGHTS
- DIRECTION INDICATOR
- BARRICADE WITH STEADY BURN MONODIRECTIONAL LIGHT
- VERTICAL DELINEATOR PANELS
- BARRICADE, TYPE III
- FLASHING ARROW BOARD
- DIRECTION OF TRAFFIC FLOW
- IMPACT ATTENUATOR, TEMPORARY (NON-REDIRECTIVE)
- IMPACT ATTENUATOR, TEMPORARY (NARROW, REDIRECTIVE)
- TCP• SIGN INCLUDED IN TRAFFIC CONTROL & PROTECTION (SEE SIGN SCHEDULE)

- TEMPORARY PAVEMENT CONSTRUCTION
- ON-GOING EARTHWORK FOR PROPOSED PAVEMENT
- PROPOSED PAVEMENT CONSTRUCTION
- TEMP PVMT REMOVAL (SEE REMOVAL PLAN FOR EX PVMT REMOVAL)
- REM TEMP AGGREGATE SHOULDERS
- AGGREGATE SHOULDERS, TYPE B 6"
- TEMPORARY CONCRETE BARRIER
- TEMPORARY CONCRETE BARRIER WITH 36" GLARE SCREEN
- XX-X SIGN REFERENCE NUMBER (SEE SIGN SCHEDULE)

**PAVEMENT MARKING LEGEND**

- ① EXISTING PAVEMENT MARKING
  - ② TEMPORARY PAVEMENT MARKING FROM PREVIOUS STAGE
  - ③ PROPOSED PAVEMENT MARKING IN PLACE (SEE PROPOSED PAVEMENT MARKING PLAN)
  - T PAVEMENT MARKING TAPE, TYPE III
  - P POLYUREA PAVEMENT MARKING TYPE II
- |   |                                     |
|---|-------------------------------------|
| 4SW 4" SOLID WHITE                          | 8SW 8" SOLID WHITE                  |
| 4SY 4" SOLID YELLOW                         | 12SW 12" SOLID WHITE @ 20' SPACING  |
| 4SYY 4" SOLID DOUBLE YELLOW (11" C-C)       | 12SY 12" SOLID YELLOW @ 20' SPACING |
| 4KW 4" SKIP-DASH WHITE (30' SKIP, 10' DASH) | 24SW 24" SOLID WHITE STOP BAR       |
| 4DW 4" DOTTED WHITE (9' SKIP, 3' DASH)      | LSW LETTERS & SYMBOLS, WHITE        |

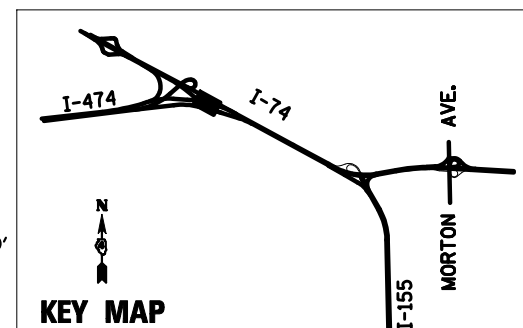
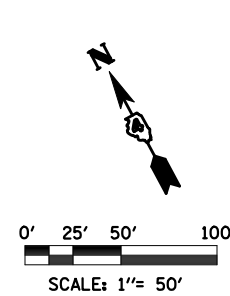
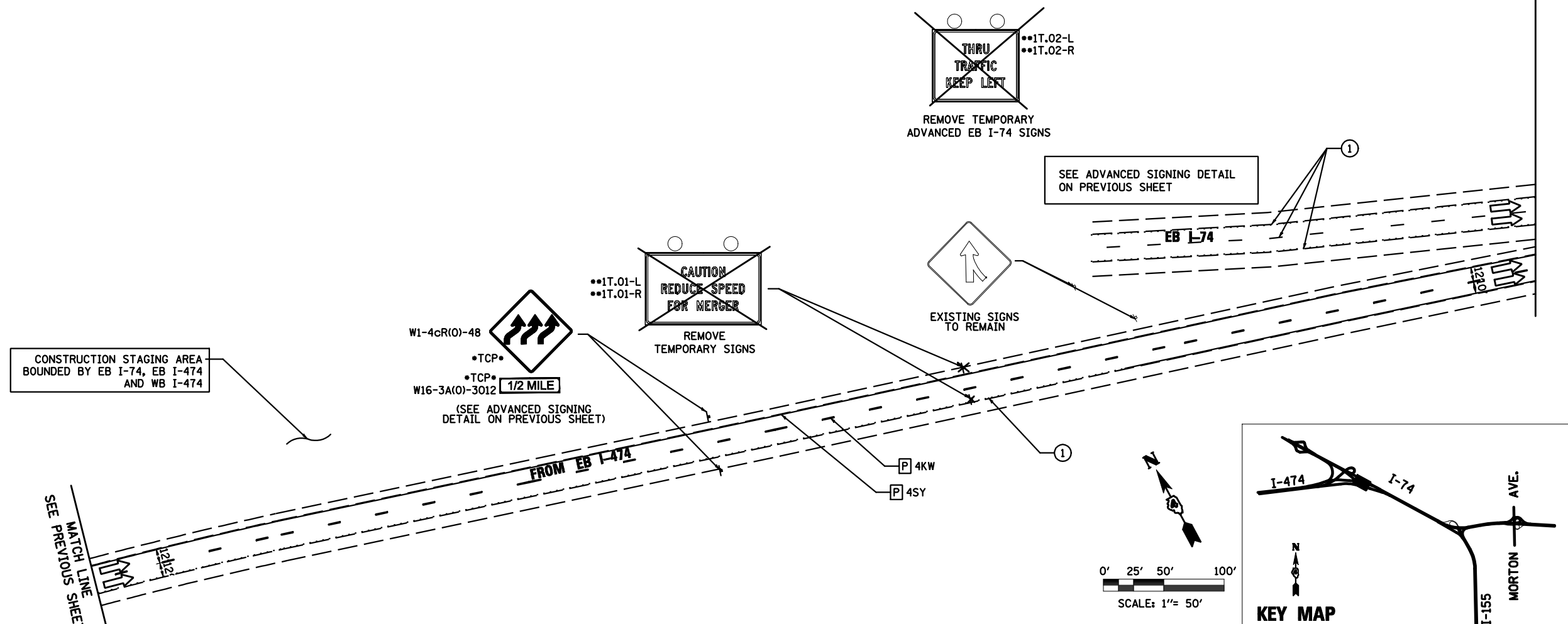
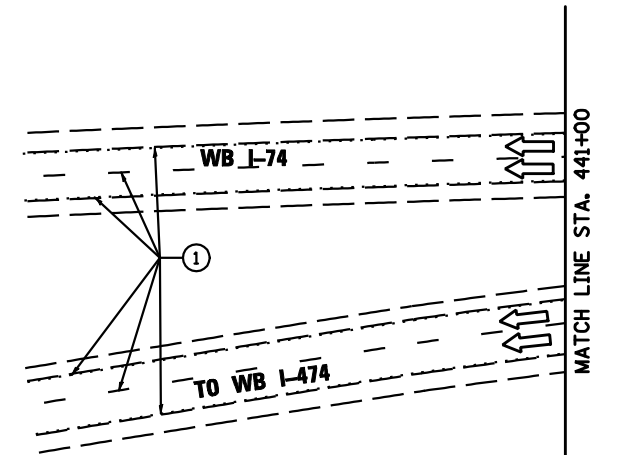

FILE NAME =	DESIGNED - HTL	REVISED -
D468620-shr-staging01 174-02B.dgn	DRAWN - JPS	REVISED -
USER NAME = TERRA	CHECKED - DA/LVA	REVISED -
PLOT DATE = 7/16/2012	DATE - 7/20/2012	REVISED -



STATE OF ILLINOIS  
DEPARTMENT OF TRANSPORTATION

MAINTENANCE OF TRAFFIC  
STAGE 2B

SCALE: SHEET NO. 7 OF 17 SHEETS STA. - TO STA. -

F.A.I. RTE.	SECTION	COUNTY	TOTAL SHEETS	SHEET NO.
•	90-[14R(14HB-4,14,14HB)/BR]	TAZEWELL	2433	596
CONTRACT NO. 68620				