

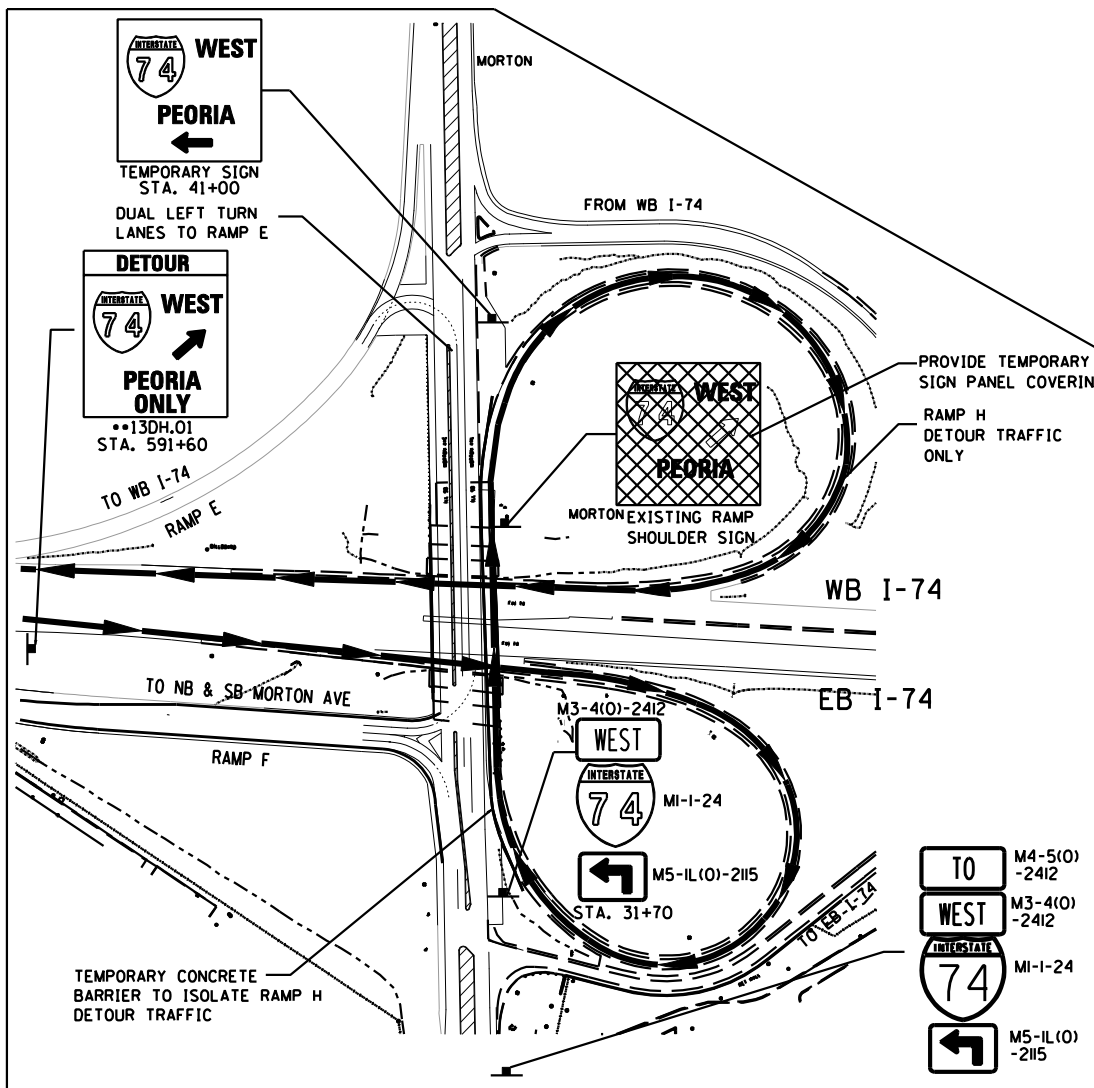

GRAPHIC SCALE
1"=1000'

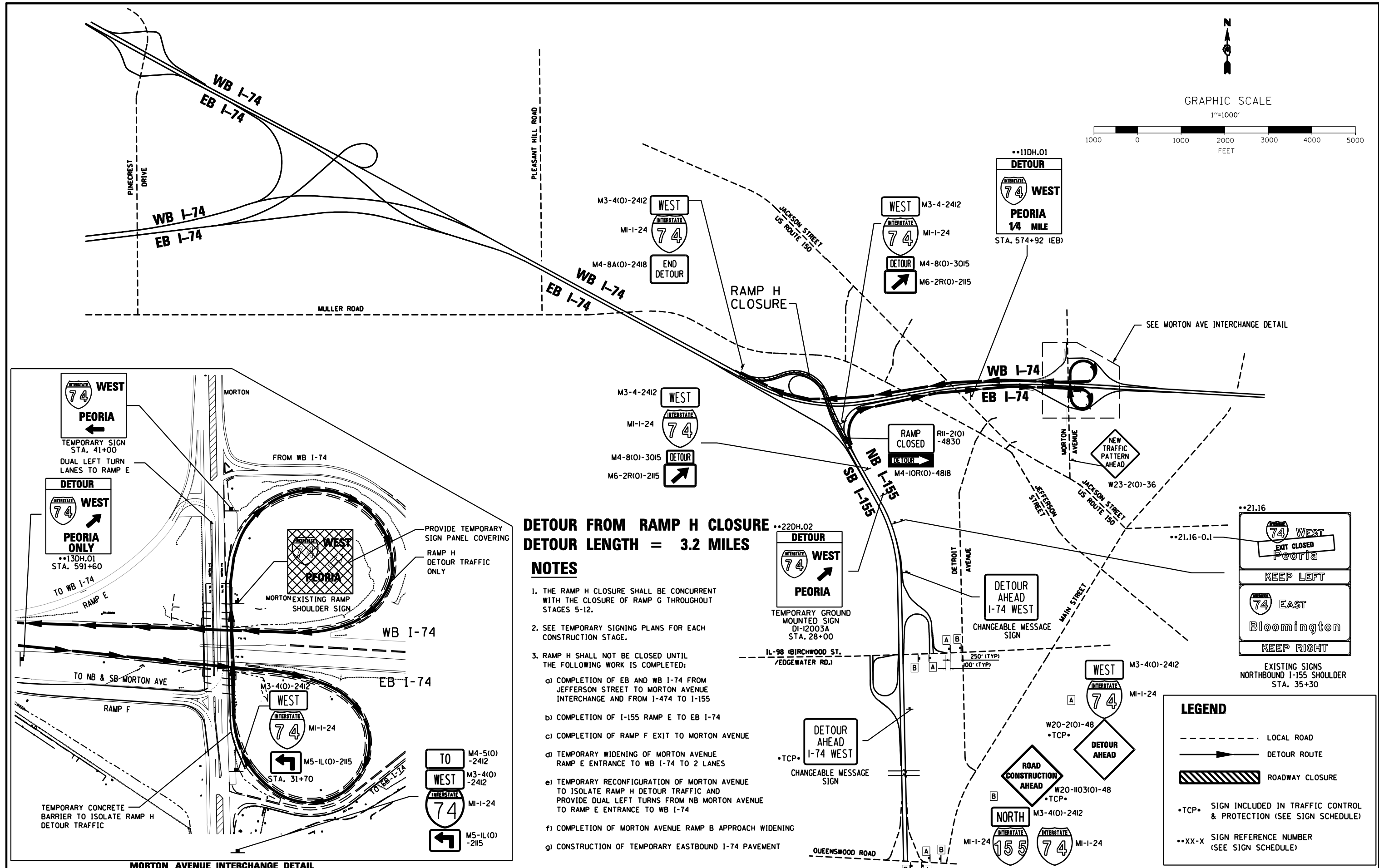

DETOUR FROM RAMP H CLOSURE DETOUR LENGTH = 3.2 MILES

NOTES

1. THE RAMP H CLOSURE SHALL BE CONCURRENT WITH THE CLOSURE OF RAMP G THROUGHOUT STAGES 5-12.
2. SEE TEMPORARY SIGNING PLANS FOR EACH CONSTRUCTION STAGE.
3. RAMP H SHALL NOT BE CLOSED UNTIL THE FOLLOWING WORK IS COMPLETED:
 - a) COMPLETION OF EB AND WB I-74 FROM JEFFERSON STREET TO MORTON AVENUE INTERCHANGE AND FROM I-474 TO I-155
 - b) COMPLETION OF I-155 RAMP E TO EB I-74
 - c) COMPLETION OF RAMP F EXIT TO MORTON AVENUE
 - d) TEMPORARY WIDENING OF MORTON AVENUE RAMP E ENTRANCE TO WB I-74 TO 2 LANES
 - e) TEMPORARY RECONFIGURATION OF MORTON AVENUE TO ISOLATE RAMP H DETOUR TRAFFIC AND PROVIDE DUAL LEFT TURNS FROM NB MORTON AVENUE TO RAMP E ENTRANCE TO WB I-74
 - f) COMPLETION OF MORTON AVENUE RAMP B APPROACH WIDENING
 - g) CONSTRUCTION OF TEMPORARY EASTBOUND I-74 PAVEMENT

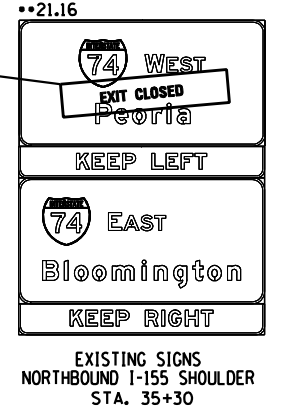

LEGEND	
	LOCAL ROAD
	DETOUR ROUTE
	ROADWAY CLOSURE
•TCP•	SIGN INCLUDED IN TRAFFIC CONTROL & PROTECTION (SEE SIGN SCHEDULE)
•XX-X	SIGN REFERENCE NUMBER (SEE SIGN SCHEDULE)

FILE NAME =	DESIGNED - DA	REVISED -
D468620-Detour RampH-dt.dgn	DRAWN - KV	REVISED -
USER NAME = TERRA	CHECKED - HTL/LVA	REVISED -
PLOT DATE = 7/16/2012	DATE - 7/20/2012	REVISED -



STATE OF ILLINOIS
DEPARTMENT OF TRANSPORTATION

MAINTENANCE OF TRAFFIC
RAMP H DETOUR PLAN

SCALE: SHEET NO. 27 OF 27 SHEETS STA. TO STA.

F.A.I. RTE.	SECTION	COUNTY	TOTAL SHEETS	SHEET NO.
•	90-[14R(14HB-4,14,14HB)/BR]	TAZEWELL	2433	839
CONTRACT NO. 68620				
ILLINOIS FED. AID PROJECT				