

PAVEMENT MARKING LEGEND

- | | | |
|---|---|-------------------------------------|
| ① EXISTING PAVEMENT MARKING | 4SW 4" SOLID WHITE | 8SW 8" SOLID WHITE |
| ② PAVEMENT MARKING FROM PREVIOUS STAGE | 4SY 4" SOLID YELLOW | 12SW 12" SOLID WHITE @ 20' SPACING |
| ③ PROPOSED PAVEMENT MARKING IN PLACE (SEE PROPOSED PAVEMENT MARKING PLAN) | 4SYY 4" SOLID DOUBLE YELLOW (11" C-C) | 12SY 12" SOLID YELLOW @ 20' SPACING |
| T PAVEMENT MARKING TAPE, TYPE III | 4KW 4" SKIP-DASH WHITE (30' SKIP, 10' DASH) | 24SW 24" SOLID WHITE STOP BAR |
| P POLYUREA PAVEMENT MARKING TYPE II | 4DW 4" DOTTED WHITE (9' SKIP, 3' DASH) | LSW LETTERS AND SYMBOLS, WHITE |

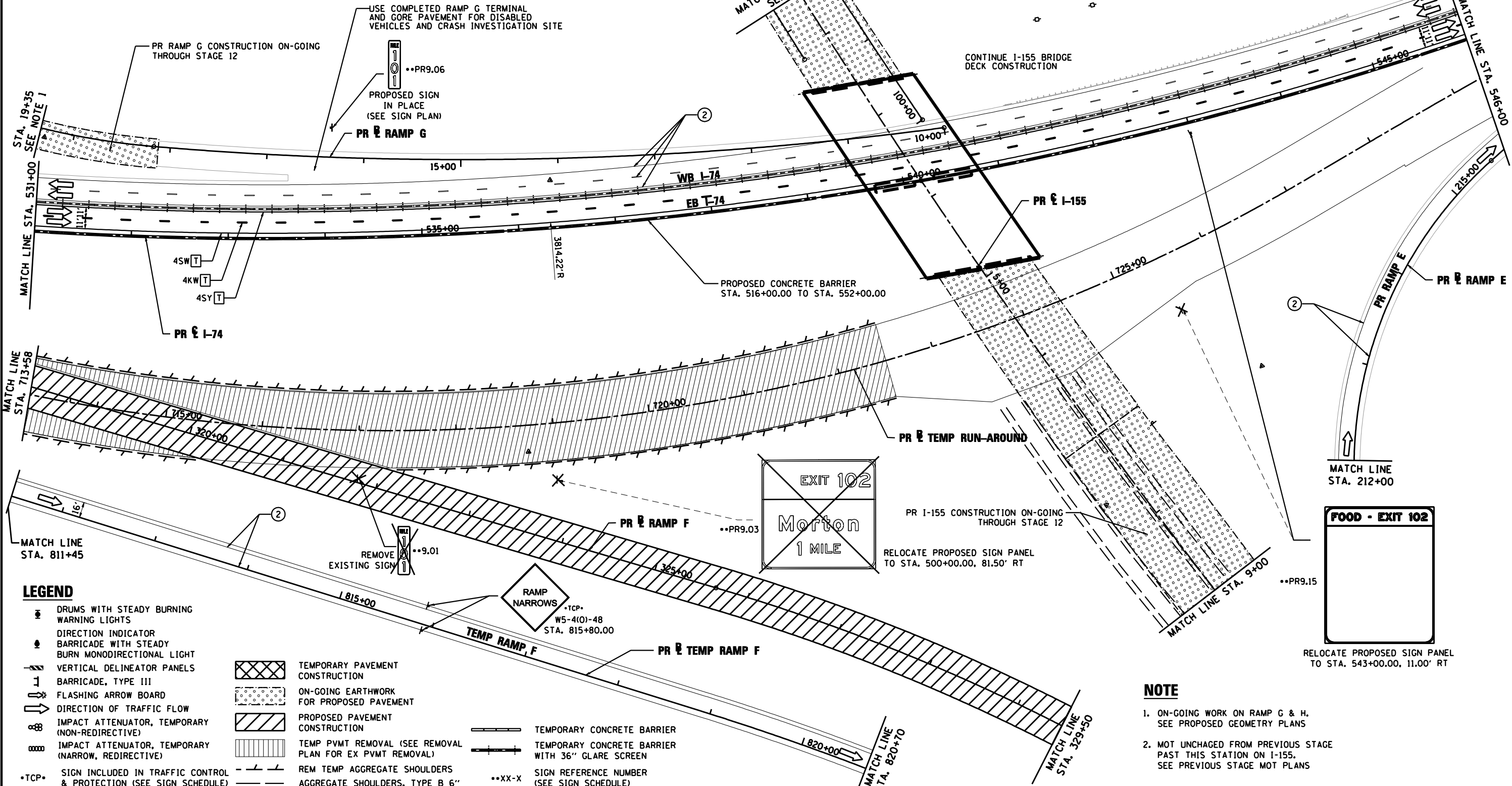
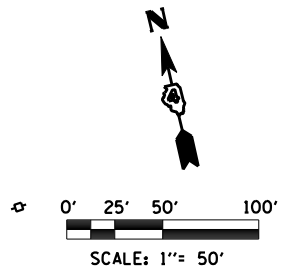

LEGEND

- | | |
|---|--|
| DRUMS WITH STEADY BURNING WARNING LIGHTS | TEMPORARY PAVEMENT CONSTRUCTION |
| DIRECTION INDICATOR BARRICADE WITH STEADY BURN MONODIRECTIONAL LIGHT | ON-GOING EARTHWORK FOR PROPOSED PAVEMENT |
| VERTICAL DELINEATOR PANELS | PROPOSED PAVEMENT CONSTRUCTION |
| BARRICADE, TYPE III | TEMP PVMT REMOVAL (SEE REMOVAL PLAN FOR EX PVMT REMOVAL) |
| FLASHING ARROW BOARD | REM TEMP AGGREGATE SHOULDERS |
| DIRECTION OF TRAFFIC FLOW | AGGREGATE SHOULDERS, TYPE B 6" |
| IMPACT ATTENUATOR, TEMPORARY (NON-REDIRECTIVE) | TEMPORARY CONCRETE BARRIER |
| IMPACT ATTENUATOR, TEMPORARY (NARROW, REDIRECTIVE) | TEMPORARY CONCRETE BARRIER WITH 36" GLARE SCREEN |
| •TCP• SIGN INCLUDED IN TRAFFIC CONTROL & PROTECTION (SEE SIGN SCHEDULE) | SIGN REFERENCE NUMBER (SEE SIGN SCHEDULE) |
| | ••XX-X |

NOTE

- ON-GOING WORK ON RAMP G & H. SEE PROPOSED GEOMETRY PLANS
- MOT UNCHANGED FROM PREVIOUS STAGE PAST THIS STATION ON I-155. SEE PREVIOUS STAGE MOT PLANS

FILE NAME =	DESIGNED - HTL	REVISED -
D468620-shr-staging09 174-11.dgn	DRAWN - JPS	REVISED -
USER NAME = TERRA	CHECKED - DA/LVA	REVISED -
PLOT DATE = 7/17/2012	DATE - 7/20/2012	REVISED -



STATE OF ILLINOIS
DEPARTMENT OF TRANSPORTATION

MAINTENANCE OF TRAFFIC
STAGE 11

SCALE: SHEET NO. 8 OF 13 SHEETS STA. 531+00 TO STA. 546+00

F.A.I. RTE.	SECTION	COUNTY	TOTAL SHEETS	SHEET NO.
90-[14R(14HB-4,14,14HVB)BR]		TAZEWELL	2433	1027
CONTRACT NO. 68620			ILLINOIS FED. AID PROJECT	