

**PRIMARY OBJECTIVE**

COMPLETE REMAINING I-74 EB PAVEMENT NEAR MORTON AVENUE  
 COMPLETE MORTON RAMP D  
 COMPLETE REMAINING PORTIONS OF MORTON AVENUE PAVEMENT

**EMERGENCY TRAFFIC MANAGEMENT**

EB I-74 : USE AVAILABLE MEDIAN PAVEMENT SEPARATING LANES OR SHOULDERS EAST OF CONSTRUCTION ZONE  
 MORTON : USE CRASH INVESTIGATION SITE 2

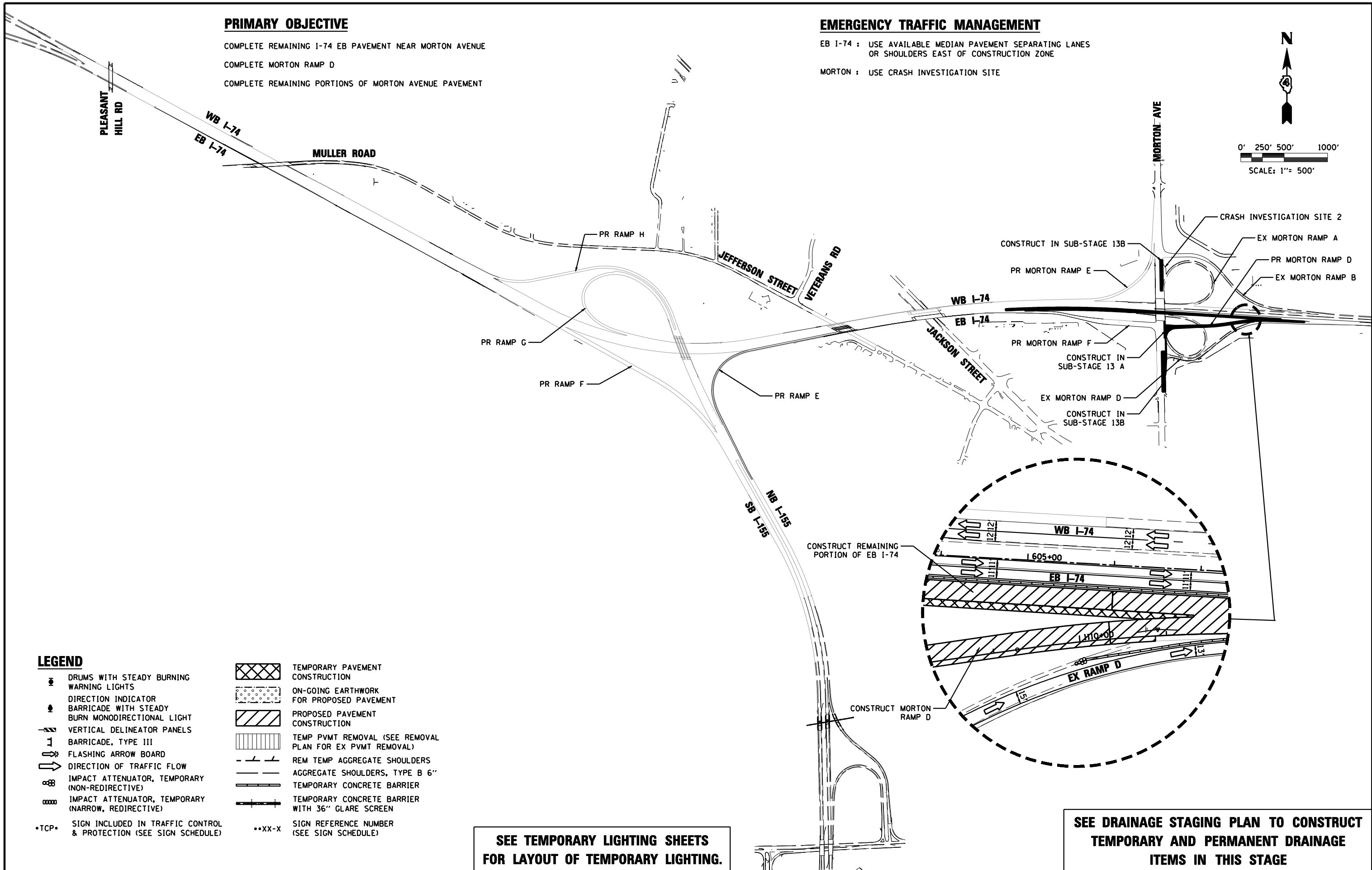
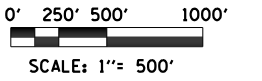

**LEGEND**

- DRUMS WITH STEADY BURNING WARNING LIGHTS
- DIRECTION INDICATOR
- BARRICADE WITH STEADY BURN MONODIRECTIONAL LIGHT
- VERTICAL DELINEATOR PANELS
- BARRICADE, TYPE III
- FLASHING ARROW BOARD
- DIRECTION OF TRAFFIC FLOW
- IMPACT ATTENUATOR, TEMPORARY (NON-REDIRECTIVE)
- IMPACT ATTENUATOR, TEMPORARY (NARROW, REDIRECTIVE)
- SIGN INCLUDED IN TRAFFIC CONTROL & PROTECTION (SEE SIGN SCHEDULE)
- TEMPORARY PAVEMENT CONSTRUCTION
- ON-GOING EARTHWORK FOR PROPOSED PAVEMENT
- PROPOSED PAVEMENT CONSTRUCTION
- TEMP PVMT REMOVAL (SEE REMOVAL PLAN FOR EX PVMT REMOVAL)
- REM TEMP AGGREGATE SHOULDERS
- AGGREGATE SHOULDERS, TYPE B 6"
- TEMPORARY CONCRETE BARRIER
- TEMPORARY CONCRETE BARRIER WITH 36" GLARE SCREEN
- SIGN REFERENCE NUMBER (SEE SIGN SCHEDULE)

**SEE TEMPORARY LIGHTING SHEETS FOR LAYOUT OF TEMPORARY LIGHTING.**

**SEE DRAINAGE STAGING PLAN TO CONSTRUCT TEMPORARY AND PERMANENT DRAINAGE ITEMS IN THIS STAGE**

FILE NAME =	DESIGNED - HTL	REVISED -
D468620-sh1-plen-13.dgn	DRAWN - JP	REVISED -
USER NAME = TERRA	CHECKED - DA/LVA	REVISED -
PLOT DATE = 7/16/2012	DATE - 7/20/2012	REVISED -



**STATE OF ILLINOIS  
 DEPARTMENT OF TRANSPORTATION**

<b>MAINTENANCE OF TRAFFIC          STAGE 13 SCHEMATIC DRAWINGS</b>	
SCALE:	TO STA.
SHEET NO. 1 OF 24 SHEETS	STA.

F.A.I. RTE.	SECTION	COUNTY	TOTAL SHEETS	SHEET NO.
• 90-[14R(14HB-4,14,14HB)BR]		TAZEWELL	2433	1179
CONTRACT NO. 68620				
ILLINOIS FED. AID PROJECT				