

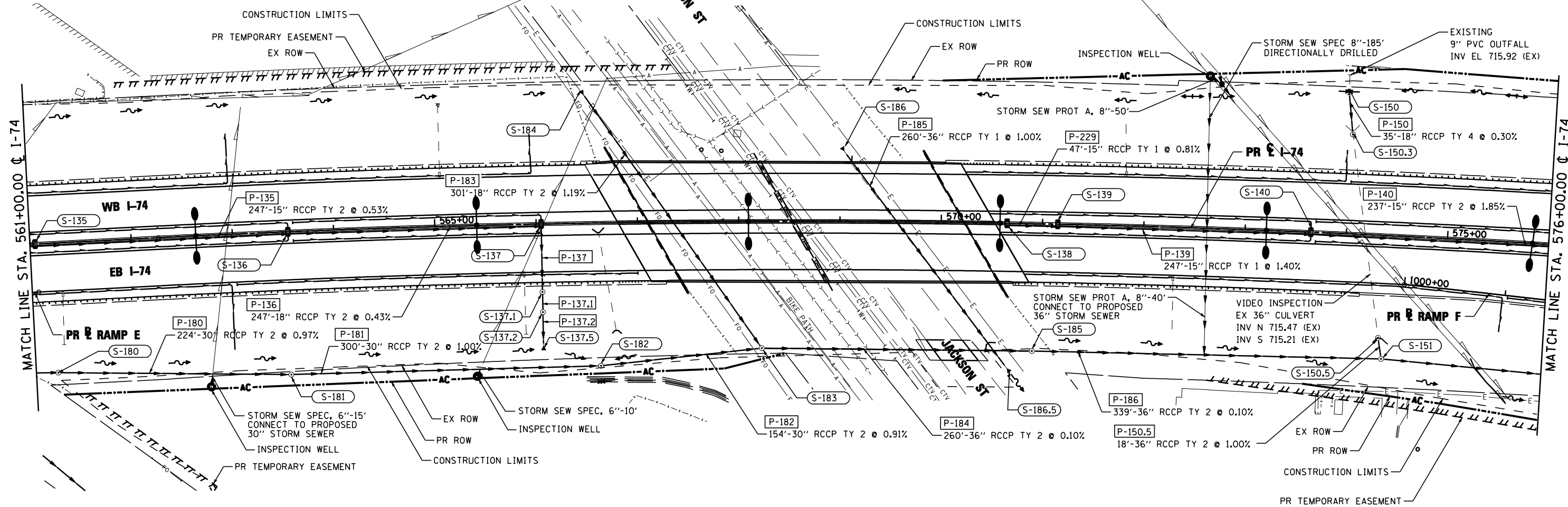

<b>S-135</b> DR STR T4 W/2 T20F&G STA 561+05.00 INV EL W 745.76 INV EL E 745.76 S RIM EL 750.09 N RIM EL 750.08	<b>S-136</b> DR STR T4 W/2 T20F&G STA 563+55.00 INV EL W 744.46 INV EL E 744.46 S RIM EL 749.04 N RIM EL 749.04	<b>S-137</b> DR STR T4 W/2 T20F&G STA 566+05.00 INV EL W 743.41 INV EL S 740.00 S RIM EL 747.99 N RIM EL 747.99	<b>S-137.5</b> DR STR FES 18" STA 566+05.00, 116.8' RT INV EL N 716.63	<b>S-138</b> DR STR T4 W/2 T20F&G STA 570+66.00 INV EL E 741.88 S RIM EL 745.91 N RIM EL 745.90	<b>S-139</b> DR STR T4 W/2 T20F&G STA 571+15.00 INV EL W 741.50 INV EL E 741.41 S RIM EL 745.50 N RIM EL 745.48	<b>S-140</b> DR STR T4 W/2 T20F&G STA 573+65.00 INV EL W 737.95 INV EL E 737.95 S RIM EL 742.18 N RIM EL 742.12	<b>S-150</b> DR STR FES 18" STA 573+97.14, 136.26' LT INV EL S 715.59	<b>S-150.3</b> DR STR MH TA 6' DIA W/ TYIF&L STA 574+02.12, 98.2' LT INV EL N 715.47 INV EL S 715.47 (EX) RIM EL 731.53
---	---	---	---	--	---	---	--	--



<b>S-180</b> DR STR MH TA 5' DIA W/TYIF&L STA 561+21.51, 128.00' RT INV EL W 716.75 INV EL E 716.75 RIM EL 724.77	<b>S-181</b> DR STR MH TA 5' DIA W/TYIF&L STA 563+52.63, 141.00' RT INV EL W 714.59 INV EL E 714.59 RIM EL 722.02	<b>S-182</b> DR STR MH TA 5' DIA W/SPECIAL FRAME & GRATE STA 566+61.97, 141.00' RT INV EL W 711.59 INV EL E 711.59 RIM EL 716.19	<b>S-183</b> DR STR MH TA 6' DIA W/TYIF&L STA 568+22.56, 125.08' RT INV EL N 712.63 INV EL W 710.13 INV EL E 710.13 RIM EL 719.39	<b>S-184</b> DR STR FES 18" STA 566+50.00, 125.27' LT INV EL S 716.00	<b>S-185</b> DR STR MH TA 6' DIA W/TYIF&L STA 570+91.77, 125.70' RT INV EL W 709.87 INV EL E 709.87 RIM EL 719.44	<b>S-186</b> DR STR FES 36" STA 569+06.21, 66.20' LT INV EL S 715.30	<b>S-151</b> DR STR MH TA 6' DIA W/TYIF&L STA 574+40.00, 121.94' RT INV EL N 712.00 INV EL W 709.53 INV EL E 709.53 RIM EL 715.96
--	--	---	---	--	--	---	---

<b>P-137</b> 61'-18" RCCP TY 2 @ 2.57% JACKED PIPE	<b>S-137.1</b> DR STR MH TA 4' DIA W/TYIF&L STA 566+05.00, 67.00' RT INV EL N 738.42 INV EL S 728.85 RIM EL 744.42
<b>P-137.1</b> 16'-18" RCCP TY 3 @ 2.69%	<b>S-137.2</b> DR STR MH TA 5' DIA W/TYIF&L STA 566+05.00, 87.00' RT INV EL N 728.42 INV EL S 717.42 RIM EL 734.43
<b>P-137.2</b> 27'-18" RCCP TY 4 @ 2.93%	

**LEGEND:**

—A—	EXISTING AERIAL LINE	—	PROPOSED STORM SEWER
—CTV—	EXISTING UNDERGROUND CABLE TV	—	PROPOSED PIPE UNDERDRAIN
—E—	EXISTING UNDERGROUND ELECTRIC	(S-101B)	PROPOSED STORM SEWER STRUCTURE CALLOUTS
—FO—	EXISTING UNDERGROUND FIBER OPTIC	(P-101)	PROPOSED STORM SEWER PIPE CALLOUTS
—IG—	EXISTING UNDERGROUND GAS LINE	—	SAG
—S—	EXISTING UNDERGROUND SANITARY SEWER	—	SUMMIT
—T—	EXISTING UNDERGROUND TELEPHONE	—	DITCH
—W—	EXISTING UNDERGROUND WATER	—	SWALE
		○	MANHOLE

