

SEE I-55 RAMP G DRAINAGE PLANS FOR ADDITIONAL INFORMATION

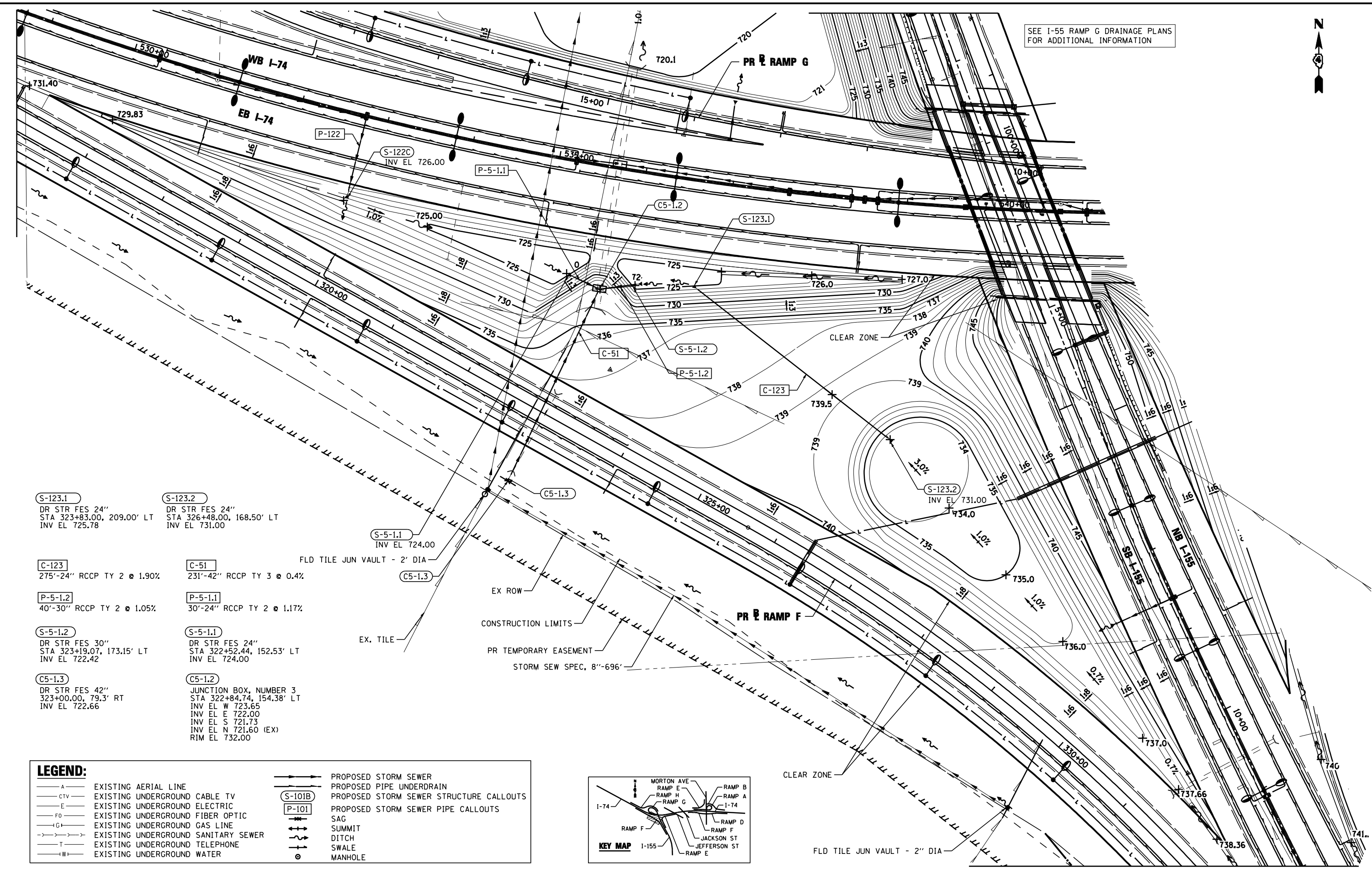

- S-123.1**
DR STR FES 24"
STA 323+83.00, 209.00' LT
INV EL 725.78
- S-123.2**
DR STR FES 24"
STA 326+48.00, 168.50' LT
INV EL 731.00
- C-123**
275'-24" RCCP TY 2 @ 1.90%
- C-51**
231'-42" RCCP TY 3 @ 0.4%
- P-5-1.2**
40'-30" RCCP TY 2 @ 1.05%
- P-5-1.1**
30'-24" RCCP TY 2 @ 1.17%
- S-5-1.2**
DR STR FES 30"
STA 323+19.07, 173.15' LT
INV EL 722.42
- S-5-1.1**
DR STR FES 24"
STA 322+52.44, 152.53' LT
INV EL 724.00
- C5-1.3**
DR STR FES 42"
323+00.00, 79.3' RT
INV EL 722.66
- C5-1.2**
JUNCTION BOX, NUMBER 3
STA 322+84.74, 154.38' LT
INV EL W 723.65
INV EL E 722.00
INV EL S 721.73
INV EL N 721.60 (EX)
RIM EL 732.00

LEGEND:

- A- EXISTING AERIAL LINE
- CTV- EXISTING UNDERGROUND CABLE TV
- E- EXISTING UNDERGROUND ELECTRIC
- FO- EXISTING UNDERGROUND FIBER OPTIC
- G- EXISTING UNDERGROUND GAS LINE
- S- EXISTING UNDERGROUND SANITARY SEWER
- T- EXISTING UNDERGROUND TELEPHONE
- W- EXISTING UNDERGROUND WATER
- PROPOSED STORM SEWER
- PROPOSED PIPE UNDERDRAIN
- (S-101B) PROPOSED STORM SEWER STRUCTURE CALLOUTS
- (P-101) PROPOSED STORM SEWER PIPE CALLOUTS
- SAG
- ↑ SUMMIT
- ↓ DITCH
- ↑ SWALE
- MANHOLE

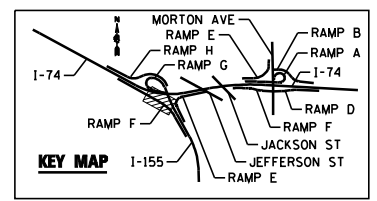

FILE NAME =	DESIGNED - I S	REVISED -
...D468620-sh-rampF_1-155-Basing.dgn	DRAWN - I S	REVISED -
USER NAME = toddblank	CHECKED - JNR	REVISED -
PLOT DATE = 7/17/2012	DATE - JULY 20, 2012	REVISED -



STATE OF ILLINOIS
DEPARTMENT OF TRANSPORTATION

GRADING PLANS
I-155 RAMP F

SCALE: 1"=50' SHEET NO. 2 OF 7 SHEETS STA. TO STA.

F.A.I. RTE.	SECTION	COUNTY	TOTAL SHEETS	SHEET NO.
90-114R(14HB-4,14,14HB)BR	TAZEWELL	ILLINOIS	2433	1451
CONTRACT NO. 68620			ILLINOIS FED. AID PROJECT	