

STATE OF ILLINOIS
DEPARTMENT OF TRANSPORTATION
DIVISION OF HIGHWAYS

**PROPOSED
HIGHWAY PLANS**

FAP 726 IL 37/OLD US 51
SECTION D9 CM BIT RES AND PATCH 2013-3

**RESURFACE /PAVEMENT REPLACEMENT
PULASKI COUNTY**

C-99-060-12

| | | | | |
|-------------|----------------------------|----------|--------------------|-----------|
| F.A.P. RTE. | SECTION | COUNTY | TOTAL SHEETS | SHEET NO. |
| VAR | D9 CM BIT RES PATCH 2013-3 | PULASKI | 10 | 1 |
| | | ILLINOIS | CONTRACT NO. 78329 | |

FOR INDEX OF SHEETS, SEE SHEET NO. 2

| LOCATION | ADT(2012) | SU | MU |
|-----------|-----------|----|----|
| OLD US 51 | 2,200 | 70 | 50 |
| IL 37 | 2,100 | 50 | 70 |

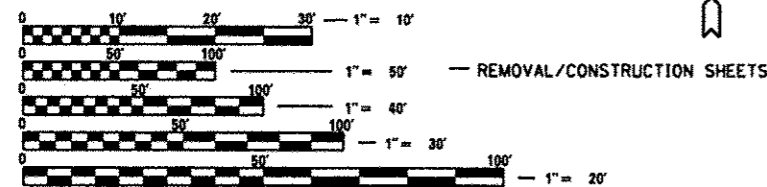
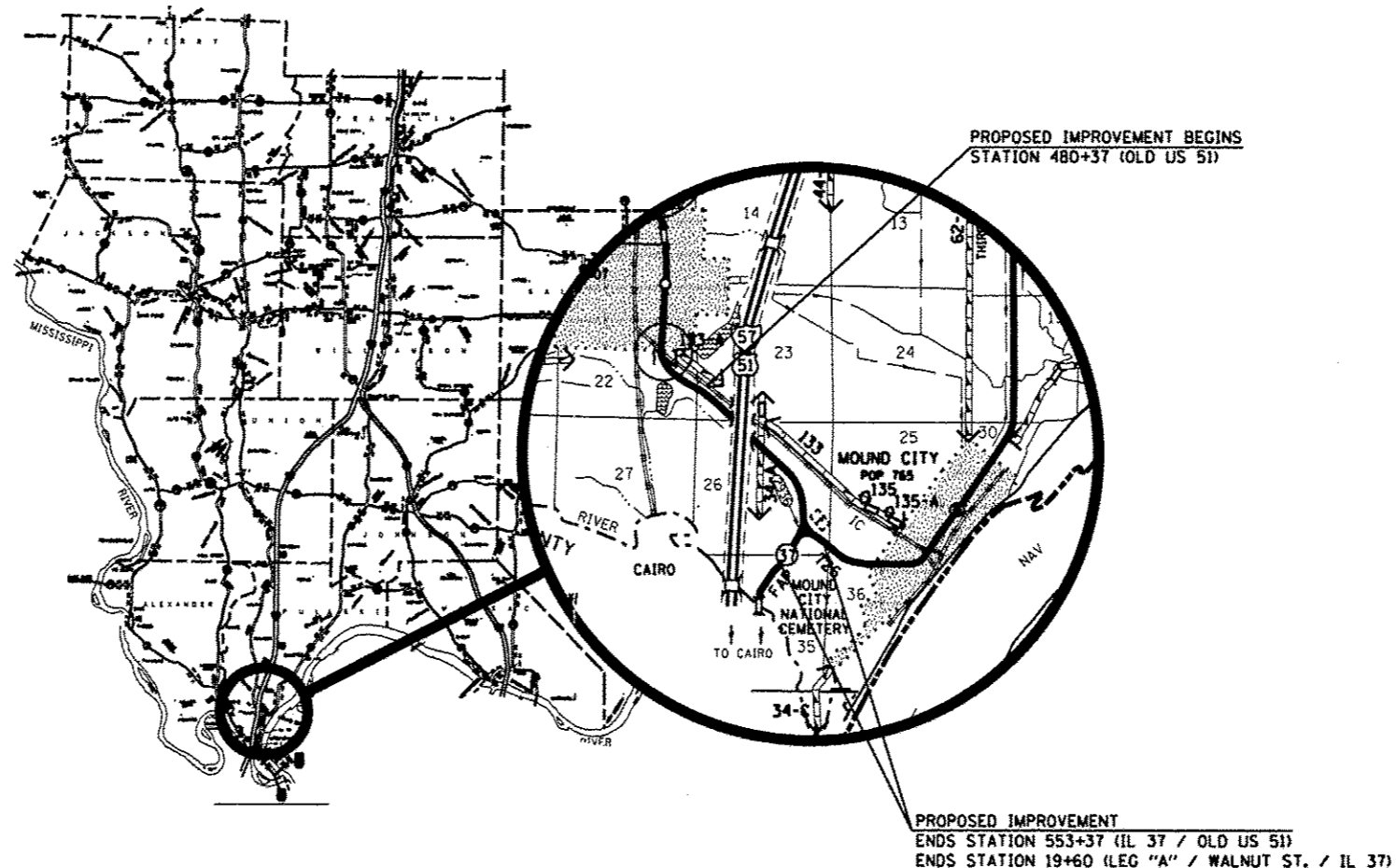
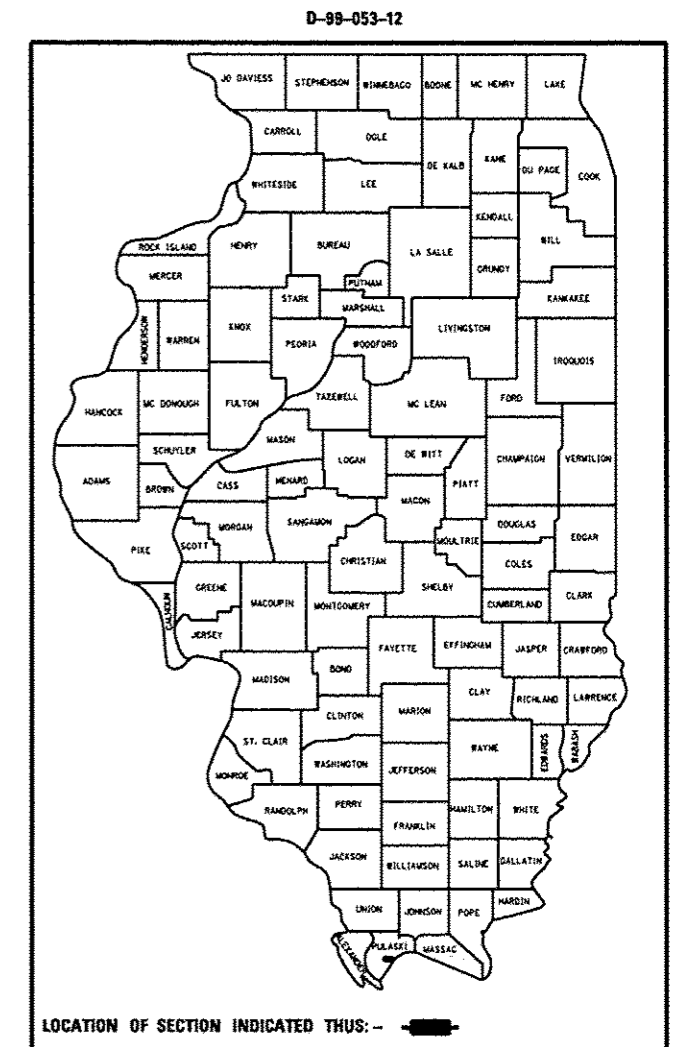

FULL SIZE PLANS HAVE BEEN PREPARED USING STANDARD ENGINEERING SCALES. REDUCED SIZED PLANS WILL NOT CONFORM TO STANDARD SCALES. IN MAKING MEASUREMENTS ON REDUCED PLANS, THE ABOVE SCALES MAY BE USED.

J.U.L.I.E.
JOINT UTILITY LOCATION INFORMATION FOR EXCAVATION
1-800-892-0123
OR 811

PROJECT ENGINEER SEAN GREENLEE
PROJECT MANAGER SUSAN POE

GROSS LENGTH = 8,448 FT. = 1.6 MILE
NET LENGTH = 2,481 FT. = 0.47 MILE

CONTRACT NO. 78329

STATE OF ILLINOIS
DEPARTMENT OF TRANSPORTATION
DIVISION OF HIGHWAYS

SUBMITTED July 16, 2012
Chris Aman
DEPUTY DIRECTOR OF HIGHWAYS, REGION ENGINEER

August 17, 2012
John D. Baramelli P.E.
ENGINEER OF DESIGN AND ENVIRONMENT

August 17, 2012
William R. Frey
acting DIRECTOR OF HIGHWAYS, CHIEF ENGINEER

**PRINTED BY THE AUTHORITY
OF THE STATE OF ILLINOIS**

INDEX OF SHEETS

| SHT NO | DESCRIPTION |
|--------|---|
| 1 | COVER SHEET |
| 2 | INDEX OF SHEETS, STANDARDS, MIXTURES REQUIREMENTS |
| 3 | SUMMARY OF QUANTITIES |
| 4 | TYPICAL SECTIONS |
| 5 | SCHEDULES OF QUANTITIES |
| 6-9 | PROPOSED REMOVAL AND CONSTRUCTION |
| 10 | DETAILS: ROUGH GROOVED SURFACE; UNEVEN LANES; DROP-OFF PROTECTION POLICY |

GENERAL NOTES

1. THE THICKNESS OF HOT MIX ASPHALT SHOWN ON THE PLANS IS THE NOMINAL THICKNESS. DEVIATIONS FROM THE NOMINAL THICKNESS WILL BE PERMITTED WHEN SUCH DEVIATIONS OCCUR DUE TO IRREGULARITIES IN THE EXISTING SURFACE OR BASE ON WHICH THE HOT MIX ASPHALT IS PLACED.
2. FACTORS USED FOR ESTIMATING PLAN QUANTITIES ARE AS FOLLOWS AND SHALL NOT BE USED FOR THE BASIS OF FINAL QUANTITIES:

| | |
|--------------------------------|-------------------|
| ALL HOT MIX ASPHALT | 2.016 TONS/CU YD |
| ALL AGGREGATE | 2.05 TONS/CU YD |
| BITUMINOUS MATERIALS: | |
| ON PAVEMENT | 0.09 GAL/SO YD |
| INTERMEDIATE LIFTS (FOG COATS) | 0.04 GAL/SO YD |
| ON AGGREGATE SURFACE | 0.32 GAL/SO YD |
| AGGREGATE (PRIME COAT) | 0.0015 TONS/SO YD |
| RIPRAP | 1.50 TONS/CU YD |
3. THE QUANTITY OF SHORT TERM PAVEMENT MARKING SHOWN IN THE PLANS IS BASED ON ONE APPLICATION EACH FOR THE PRIME COAT, SURFACE COURSE, AND BINDER COURSE.
4. ATTAINMENT OF PROPER CROWN OR SUPERELEVATION SHALL BE FULLY ACCOMPLISHED WITH THE HOT MIX ASPHALT SURFACE REMOVAL OR HOT MIX ASPHALT BINDER COURSE OR LEVELING BINDER, WHEN SPECIFIED.
5. AT ALL LOCATIONS WHERE THE PROPOSED HOT MIX ASPHALT OR CONCRETE PAVEMENT JOINS AN EXISTING HOT MIX ASPHALT OR CONCRETE PAVEMENT, A FULL DEPTH SAWED JOINT SHALL BE CONSTRUCTED. THE COST OF THIS JOINT WILL BE INCLUDED IN THE COST OF THE TYPE OF PAVEMENT BEING CONSTRUCTED.
6. AFTER A LIFT OF BITUMINOUS CONCRETE HAS BEEN PLACED ON A LANE, THAT LANE SHALL REMAIN CLOSED TO TRAFFIC UNTIL THE NEW MAT HAS COOLED TO 150°
7. PRIOR TO PLACEMENT OF THE FINAL PAVEMENT MARKINGS THE RESIDENT ENGINEER SHOULD CONTACT THE BUREAU OF OPERATIONS AND ARRANGE FOR INSPECTION AND APPROVAL OF THE PAVEMENT MARKING LAYOUT.
8. THE CONTRACTOR SHALL STAMP STATIONING IN THE PROPOSED HOT MIX ASPHALT SURFACE AT 300 FT. INTERVALS ON ALTERNATING SIDES OF THE PAVEMENT AND AS DIRECTED BY THE ENGINEER. THE STATION SYMBOL STAMPS USED SHALL BE FURNISHED BY THE CONTRACTOR, THEY SHALL BE (5 1/2 IN.) TALL, OF A DESIGN APPROVED BY THE ENGINEER, AND SHALL REMAIN THE PROPERTY OF THE CONTRACTOR.
9. ALL DISTURBED EARTH SHALL BE SEEDED AT THE ENGINEERS DISCRETION, SUCH WORK WILL BE PAID FOR PER ARTICLE 109.04.

MIXTURES REQUIREMENTS

| | |
|-----------------------------|--|
| Location(s): | Hot-Mix Asphalt Surface Course |
| Mixture Use(s): | Hot-Mix Asphalt Surface Course, Mix C, N90 |
| AC/PG: | PG64-22 |
| RAP % (Max): | 10 |
| Design Air Voids: | 4.0 %, 90 Gyration Design |
| Mixture (Gradation Mixture) | IL-9.5 mm or IL12.5 mm |
| Friction Aggregate: | C Surface |

| | |
|-----------------------------|--|
| Location(s): | Hot-Mix Asphalt Binder and Hot-Mix Asphalt Base Course |
| Mixture Use(s): | Hot-Mix Asphalt Binder Course, N90, IL-19.0 |
| AC/PG: | PG64-22 |
| RAP % (Max): | 10 |
| Design Air Voids: | 4.0 %, 90 Gyration Design |
| Mixture (Gradation Mixture) | IL-19.0 |
| Friction Aggregate: | None |

STANDARDS

| | |
|-----------|---|
| 000001-06 | STANDARD SYMBOLS, ABBREVIATIONS, AND PATTERNS |
| 001001-02 | AREAS OF REINFORCEMENT BARS |
| 001006 | DECIMAL OF AN INCH AND OF A FOOT |
| 482011-03 | HMA SHLD. STRIPS/SHLDS. WITH RESURFACING OR WIDENING, AND RESURFACING PROJECTS |
| 701001-02 | OFF-RD OPERATIONS, 2L 2W, MORE THAN 15' AWAY |
| 701006-03 | OFF-RD OPERATIONS, 2L 2W, 15' (4.5m) to 24" (600 mm) FROM PAVEMENT EDGE |
| 701201-04 | LANE CLOSURE, 2L, 2W, DAY ONLY, FOR SPEEDS ≥ 45 MPH |
| 701301-04 | LANE CLOSURE, 2L, 2W, SHORT TIME OPERATIONS |
| 701306-03 | LANE CLOSURE, 2L, 2W, SLOW MOVING OPERATIONS DAY ONLY, FOR SPEEDS ≥ 45 MPH |
| 701311-03 | LANE CLOSURE, 2L, 2W, MOVING OPERATIONS - DAY ONLY |
| 701901-02 | TRAFFIC CONTROL DEVICES |
| 780001-03 | TYPICAL PAVEMENT MARKINGS |
| 781001-03 | TYPICAL APPLICATORS RAISED REFLECTIVE PAVEMENT MARKERS |
| BLR 21-9 | TYPICAL APPLICATION OF TRAFFIC CONTROL DEVICES FOR CONSTRUCTION ON RURAL LOCAL HIGHWAYS |

| | |
|--------------|---|
| Prepared By: | <i>Joe Z. Graw</i> DISTRICT STUDIES & PLANS ENGINEER |
| Examined By: | <i>J. Travis Emery</i> DISTRICT LAND ACQUISITION ENGINEER |
| Examined By: | <i>Carrie Nelson</i> DISTRICT PROGRAM DEVELOPMENT ENGINEER |
| Examined By: | <i>Bill Kelly</i> DISTRICT OPERATIONS ENGINEER |
| Examined By: | <i>Douglas J. McNeil</i> DISTRICT CONSTRUCTION ENGINEER |
| Examined By: | <i>Bruce W. Peoples</i> DISTRICT MATERIALS ENGINEER |
| Examined By: | <i>CRS</i> DISTRICT PROJECT IMPLEMENTATION ENGINEER |
| Approved By: | <i>Omer Amman</i> DEPUTY DIRECTOR OF HIGHWAYS, REGION 5 ENGINEER |
| DATE | July 16 2012 |

| | | | | | | | | | | | |
|------------------------------------|-------------------------|------------|-----------|---|--|--|----------------------------|---------|--------------|-----------|--|
| FILE NAME * | USER NAME * greenlaam | DESIGNED - | REVISED - | STATE OF ILLINOIS DEPARTMENT OF TRANSPORTATION | INDEX OF SHEETS, STANDARDS, MIXTURE REQUIREMENTS | F.A.P. RTE. | SECTION | COUNTY | TOTAL SHEETS | SHEET NO. | |
| c:\pwork\pwork\greenlaam\d0312786\ | ta-cvr-soq-index.dgn | DRAWN - | REVISED - | | | VAR | 09 CM BIT RES PATCH 2013-3 | PULASKI | 10 | 2 | |
| | PLOT SCALE * 1/8"=1'-0" | CHECKED - | REVISED - | | | SCALE: SHEET OF SHEETS STA. TO STA. | | | | | |
| | PLOT DATE * 7/12/2012 | DATE - | REVISED - | | | ILLINOIS FED. AID PROJECT CONTRACT NO. 78329 | | | | | |

TYPICAL SECTIONS

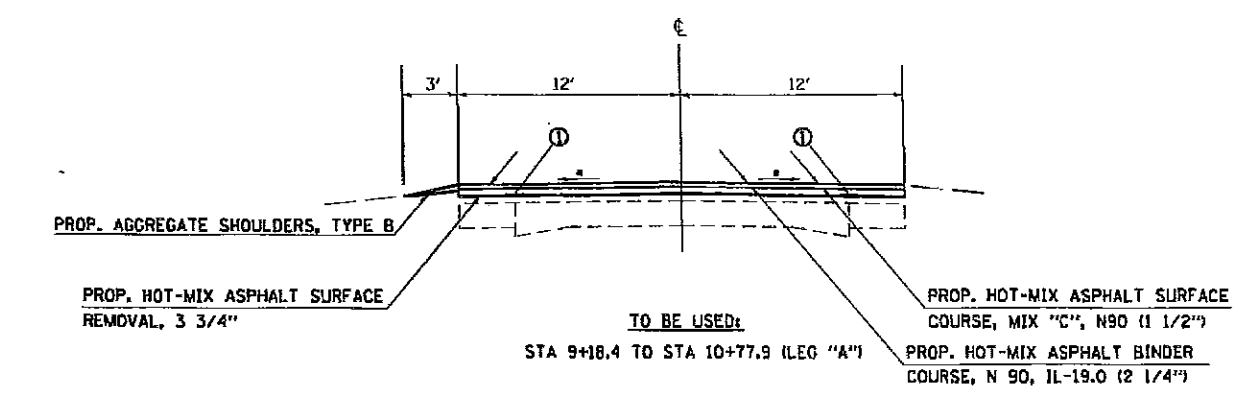
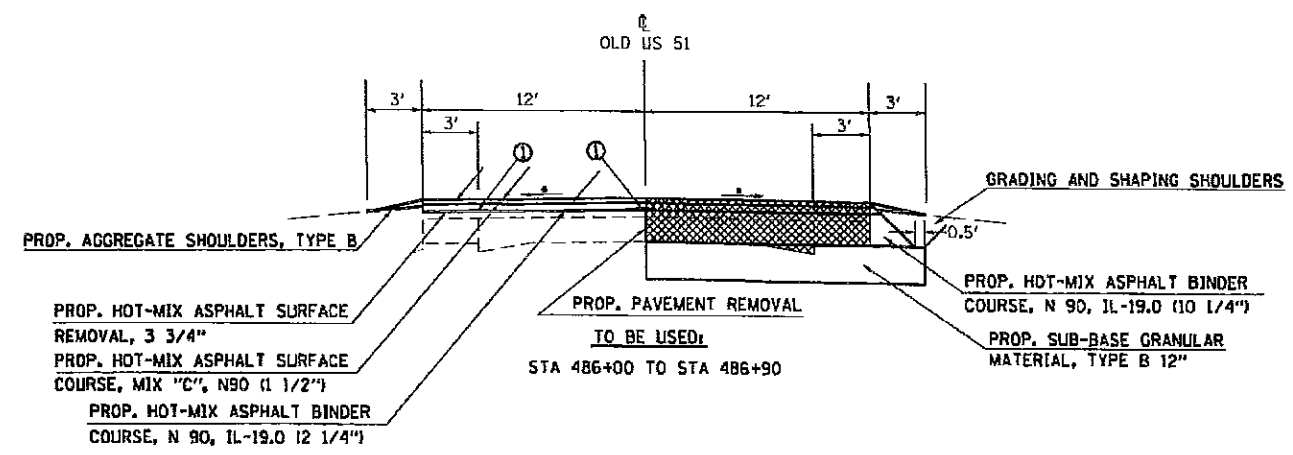
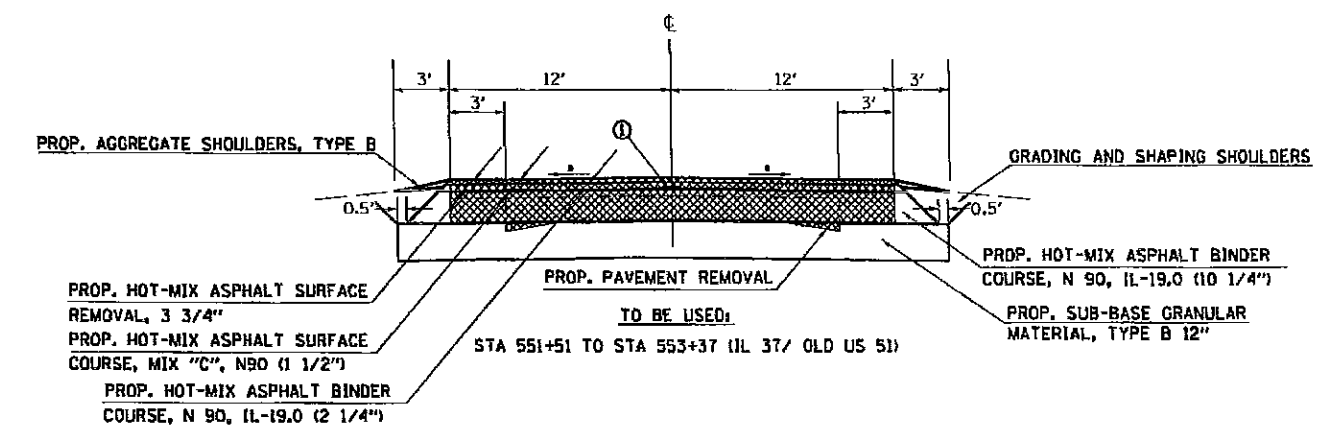
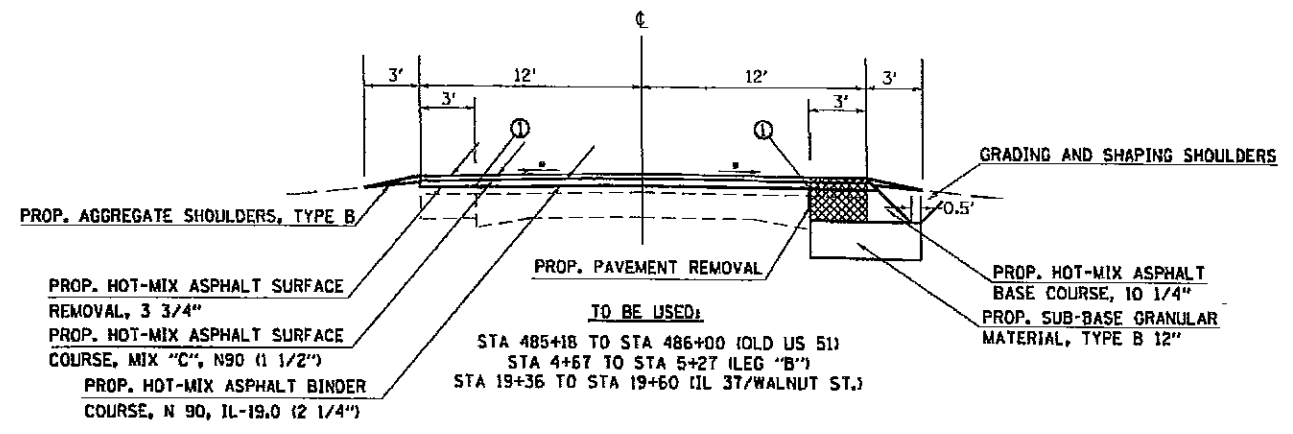
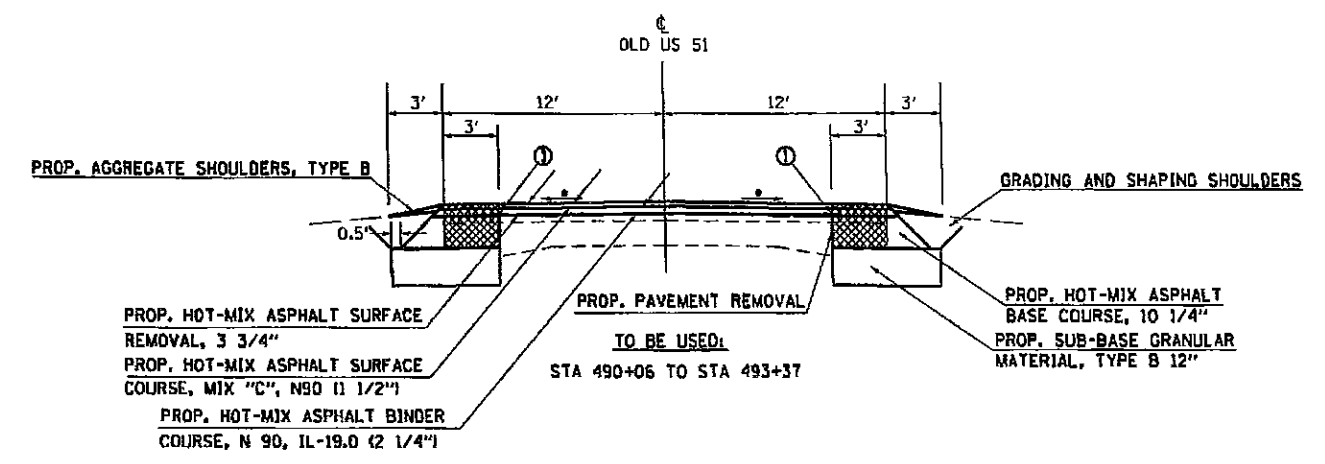
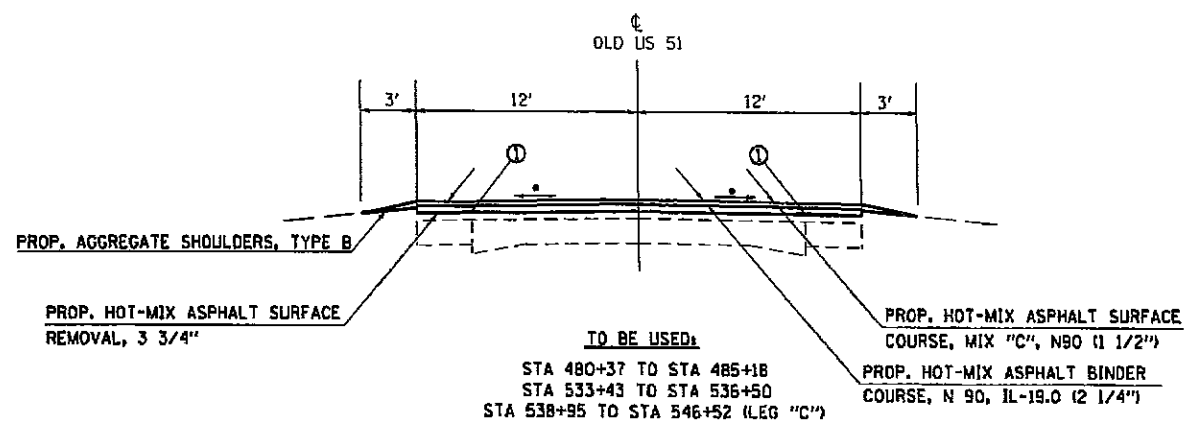

NOTES:

① - STRIP REFLECTIVE CRACK CONTROL TREATMENT

• - MATCH EXISTING LANE CROSS SLOPE

| | | | | | | | | | |
|------------------------------------|-----------------------------|------------|-----------|---|-------------------------|---------------|-----------------------------|---------|---------------------------|
| FILE NAME = | USER NAME = g-reinleas | DESIGNED - | REVISED - | STATE OF ILLINOIS DEPARTMENT OF TRANSPORTATION | TYPICAL SECTIONS | P.A.P. / RTE. | SECTION | COUNTY | TOTAL SHEETS |
| 0:\p\so\k\p\dot\greenleas\0312786\ | ib-tpy_sch_line.dgn | DRAWN - | REVISED - | | | VAR | DB BIT RES AND PATCH 2013-3 | PULASKI | NO. |
| | PLOT SCALE = 10.0000' / in. | CHECKED - | REVISED - | | | | | | 4 |
| #MODEL NAME | PLOT DATE = 7/17/2012 | DATE - | REVISED - | | SCALE: | | | | CONTRACT NO. 78329 |
| | | | | | SHEET | OF | SHEETS | STA. | TO STA. |
| | | | | | | | | | ILLINOIS FED. AID PROJECT |

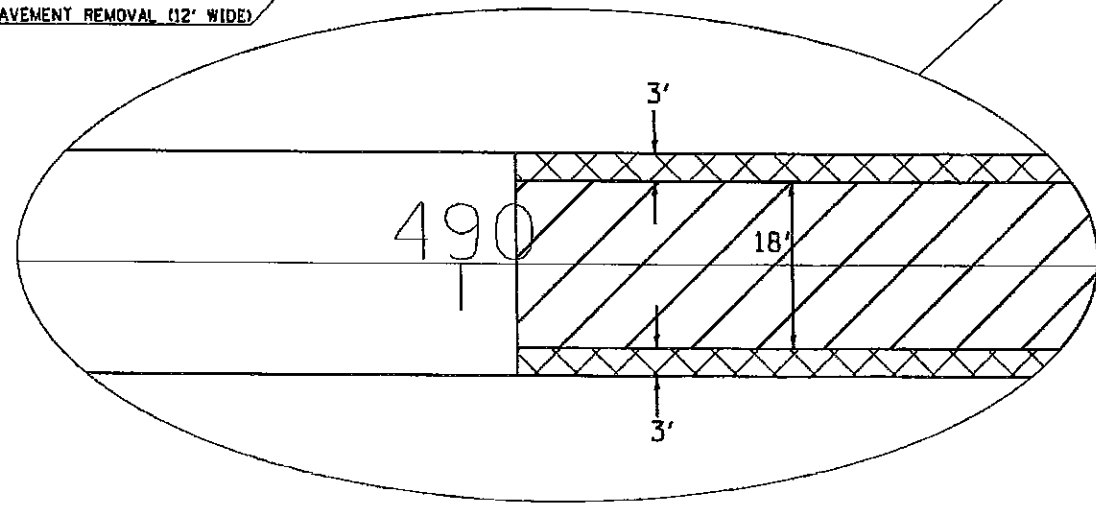
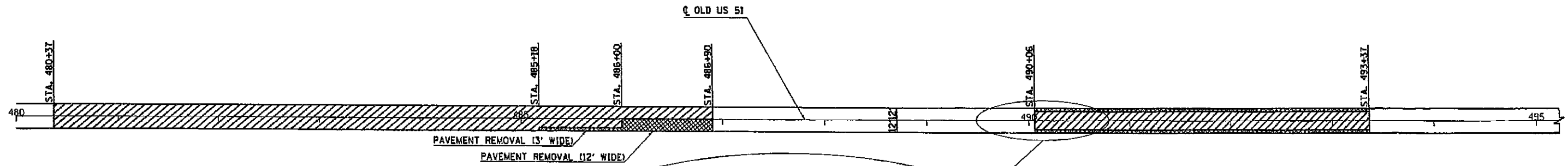

LEGEND

- PAVEMENT REMOVAL
- HOT-MIX ASPHALT SURFACE REMOVAL, 3 3/4"

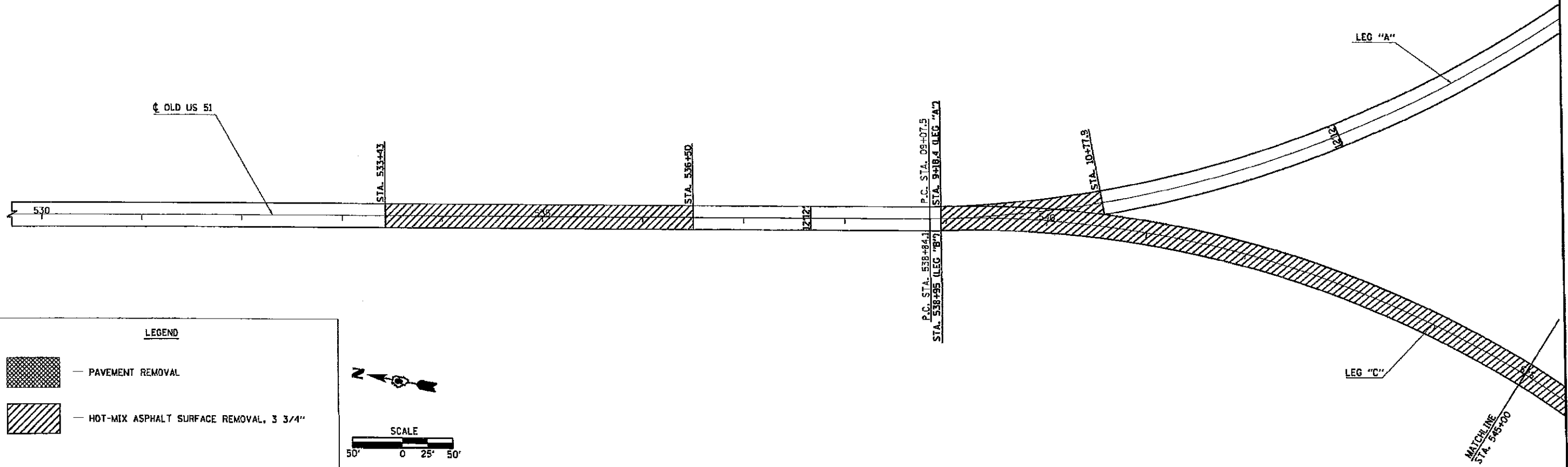
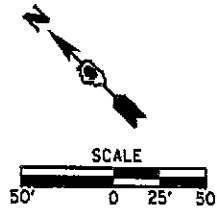

LEGEND

- PAVEMENT REMOVAL
- HOT-MIX ASPHALT SURFACE REMOVAL, 3 3/4"

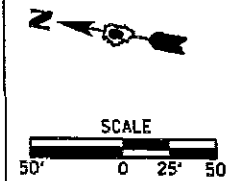

| | | | |
|---|-------------------------|------------|-----------|
| FILE NAME = | USER NAME = greenlee | DESIGNED - | REVISED - |
| \\ape_work\p\p\dot\greenlee\10332786\1\td\stageconstruction.dgn | | DRAWN - | REVISED - |
| #MODELNAME# | PLOT SCALE = 1/8"=1'-0" | CHECKED - | REVISED - |
| | PLOT DATE = 7/12/2012 | DATE - | REVISED - |

**STATE OF ILLINOIS
DEPARTMENT OF TRANSPORTATION**

REMOVAL SHEET

SCALE: SHEET OF SHEETS STA. YD STA.

| | | | | |
|--------------------|-------------------------------|---------|---------------------------|-----------|
| F.A.P. RTE. | SECTION | COUNTY | TOTAL SHEETS | SHEET NO. |
| VAR | DR 09 BY N&S AND PATCH 2013-3 | PULASKI | 10 | 6 |
| CONTRACT NO. 78329 | | | ILLINOIS FED. AID PROJECT | |

LEGEND



— PAVEMENT REMOVAL



— HOT-MIX ASPHALT SURFACE REMOVAL, 3 3/4"

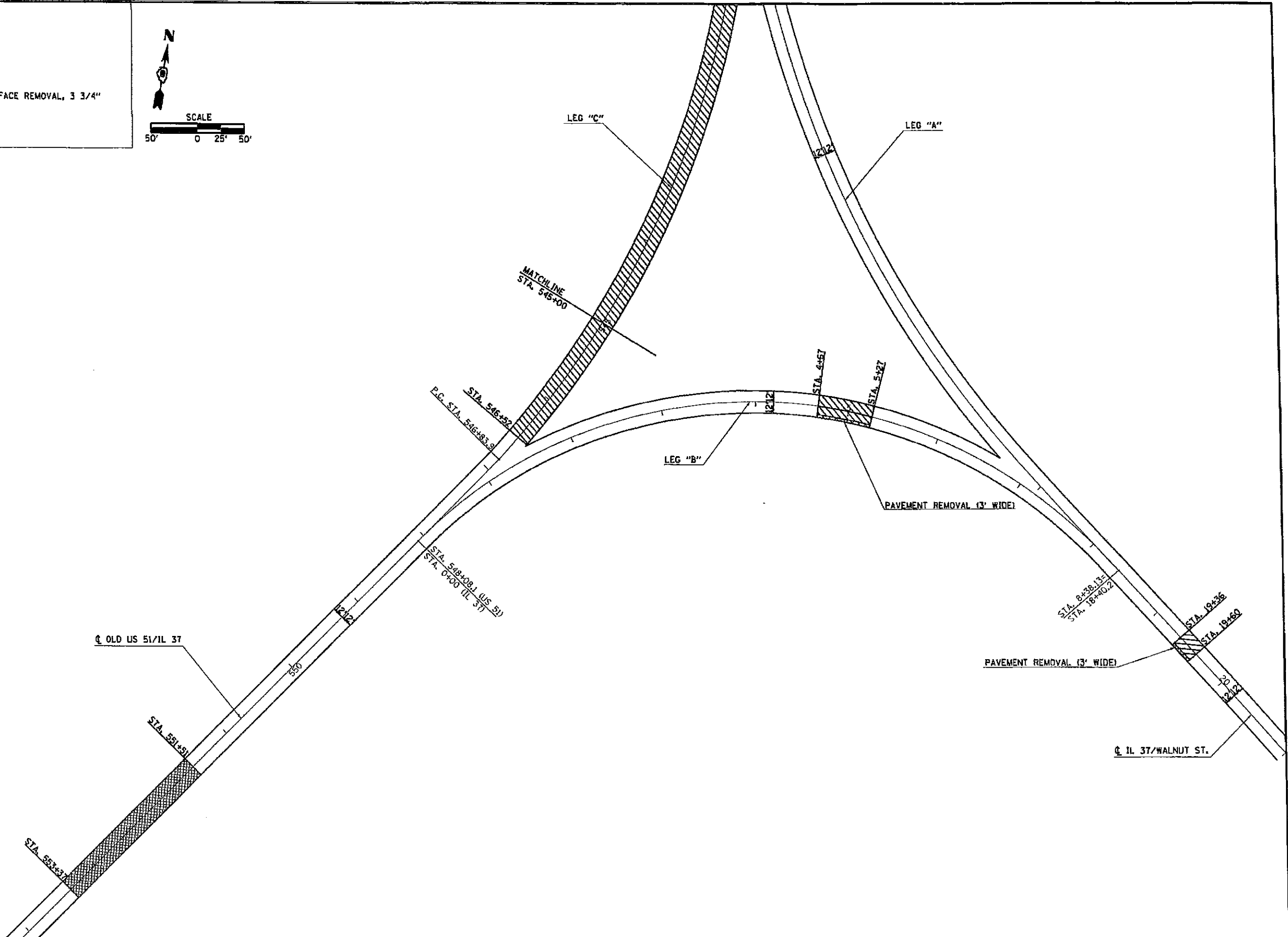
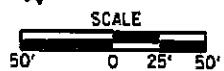

| | | | | | | | | | | | | | | | |
|---------------------------------------|--------------------------|------------|-----------|---|----------------------|--|--|---------------------------|--------------------------------|---------|-----------------|--------------|---------|--------------------|--|
| FILE NAME = | USER NAME = gnanlssn | DESIGNED - | REVISED - | STATE OF ILLINOIS DEPARTMENT OF TRANSPORTATION | REMOVAL SHEET | | | F.A.P. RTE. | SECTION | COUNTY | TOTAL SHEETS | SHEET NO. | | | |
| en\p...work\puzido\gnanlssn\10312785\ | td-stagconstruaction.dgn | DRAWN - | REVISED - | | | | | VAR | 05 CH BIT RES AND PATCH 2013-3 | PULASKI | ID | 7 | | | |
| PLT SCALE = 1/8"=1'-0" | PLT DATE = 7/12/2012 | CHECKED - | REVISED - | | | | | SCALE: | SHEET | OF | SHEETS | STA. | TO STA. | CONTRACT NO. 78329 | |
| #MODELNAME# | | DATE - | REVISED - | | | | | ILLINOIS FED. AID PROJECT | | | | | | | |

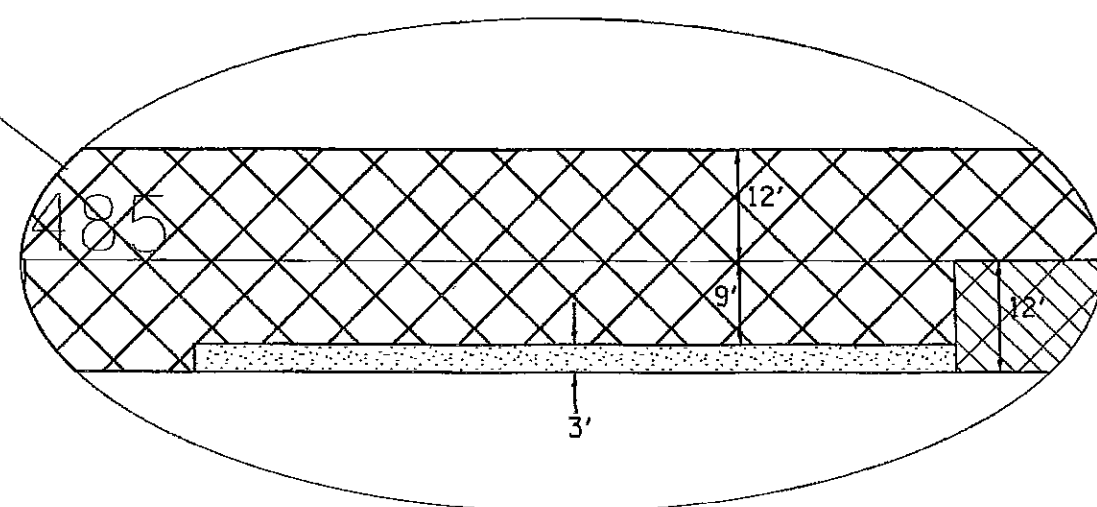
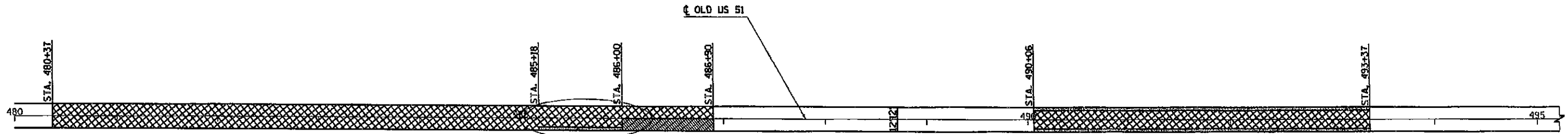

LEGEND

- HOT-MIX ASPHALT SURFACE COURSE, MIX "C" N90 (1 1/2")
HOT-MIX ASPHALT BINDER COURSE, N90, IL-19.0 (2 1/4")
- HOT-MIX ASPHALT SURFACE COURSE, MIX "C" N90 (1 1/2")
HOT-MIX ASPHALT BINDER COURSE, N90, IL-19.0 (2 1/4")
HOT-MIX ASPHALT BINDER COURSE, N90, IL-19.0 (10 1/4")
SUB-BASE GRANULAR MATERIAL, TYPE B 12"
- HOT-MIX ASPHALT SURFACE COURSE, MIX "C" N90 (1 1/2")
HOT-MIX ASPHALT BINDER COURSE, N90, IL-19.0 (2 1/4")
HOT-MIX ASPHALT BASE COURSE, 10 1/4"
SUB-BASE GRANULAR MATERIAL, TYPE B 12"

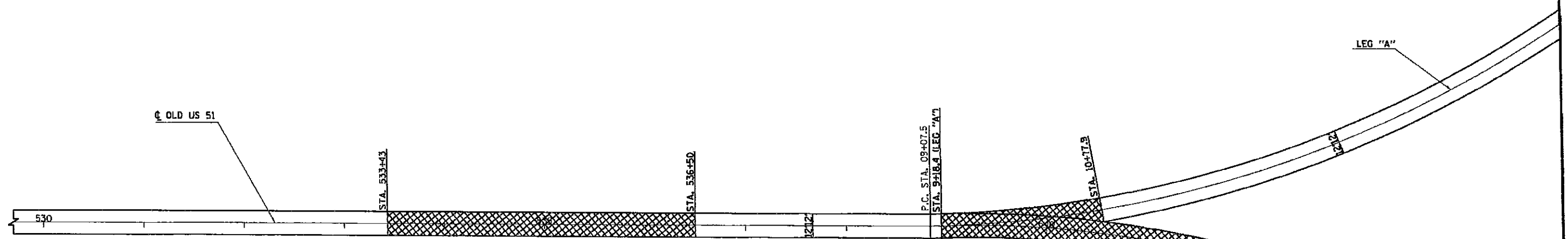
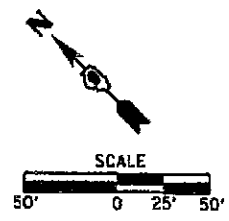

LEGEND

- HOT-MIX ASPHALT SURFACE COURSE, MIX "C" N90 (1 1/2")
HOT-MIX ASPHALT BINDER COURSE, N90, IL-19.0 (2 1/4")
- HOT-MIX ASPHALT SURFACE COURSE, MIX "C" N90 (1 1/2")
HOT-MIX ASPHALT BINDER COURSE, N90, IL-19.0 (2 1/4")
HOT-MIX ASPHALT BINDER COURSE, N90, IL-19.0 (10 1/4")
SUB-BASE GRANULAR MATERIAL, TYPE B 12"
- HOT-MIX ASPHALT SURFACE COURSE, MIX "C" N90 (1 1/2")
HOT-MIX ASPHALT BINDER COURSE, N90, IL-19.0 (2 1/4")
HOT-MIX ASPHALT BASE COURSE, 10 1/4"
SUB-BASE GRANULAR MATERIAL, TYPE B 12"

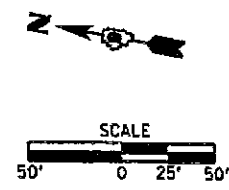

| | | | |
|---------------------------------------|-------------------------|------------|-----------|
| FILE NAME * | USER NAME * | DESIGNED - | REVISED - |
| 0:\pwork\p101dot\green\1000\09312786\ | td-stegans\trunkon.dgn | DRAWN - | REVISED - |
| #MODELNAME# | PLDT SCALE * 1/8"=1'-0" | CHECKED - | REVISED - |
| | PLDT DATE * 7/11/2012 | DATE - | REVISED - |



**STATE OF ILLINOIS
DEPARTMENT OF TRANSPORTATION**

CONSTRUCTION SHEET

| | | | | | |
|--------|-------|----|--------|------|---------|
| SCALE: | SHEET | OF | SHEETS | STA. | TO STA. |
|--------|-------|----|--------|------|---------|

| | | | | |
|---------------------------|--------------------------------|----------|--------------|-----------|
| F.A.P. RYE. | SECTION | COUNTY | TOTAL SHEETS | SHEET NO. |
| VAR | 09 CM 811 RES AND PATCH 2013-3 | FULLASKI | 10 | B |
| CONTRACT NO. 78329 | | | | |
| ILLINOIS/FED. AID PROJECT | | | | |

LEGEND

-  — HOT-MIX ASPHALT SURFACE COURSE, MIX "C" N90 (1 1/2")
HOT-MIX ASPHALT BINDER COURSE, N90, IL-19.0 (2 1/4")
-  — HOT-MIX ASPHALT SURFACE COURSE, MIX "C" N90 (1 1/2")
HOT-MIX ASPHALT BINDER COURSE, N90, IL-19.0 (2 1/4")
HOT-MIX ASPHALT BINDER COURSE, N90, IL-19.0 (10 1/4")
SUB-BASE GRANULAR MATERIAL, TYPE B 12"
-  — HOT-MIX ASPHALT SURFACE COURSE, MIX "C" N90 (1 1/2")
HOT-MIX ASPHALT BINDER COURSE, N90, IL-19.0 (2 1/4")
HOT-MIX ASPHALT BINDER COURSE, 10 1/4"
SUB-BASE GRANULAR MATERIAL, TYPE B 12"

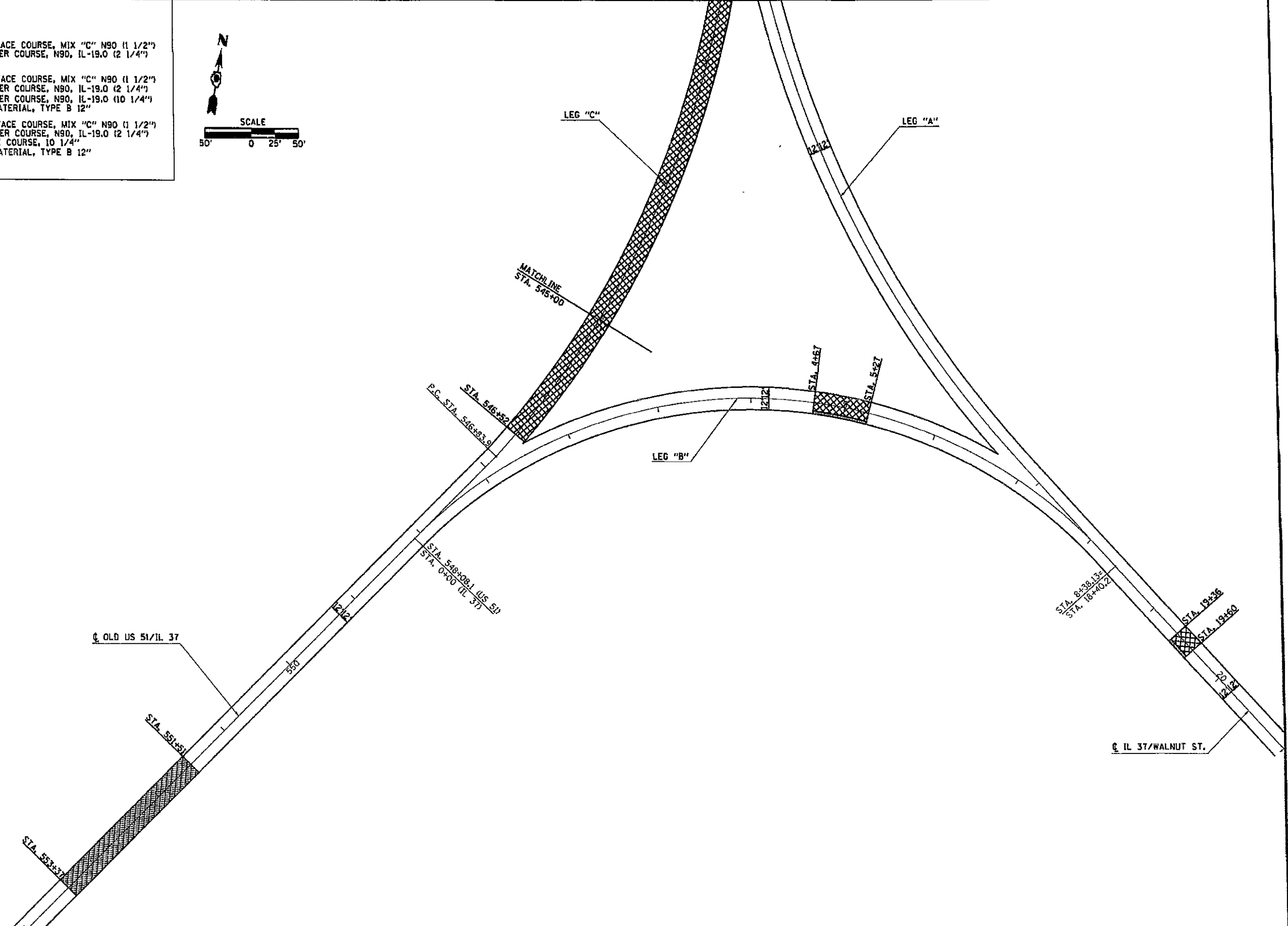
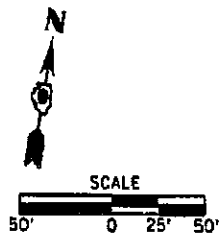

| | | | | | | | | | | | |
|---------------------------------------|------------------------------|------------|-----------|---|---------------------------|-------------------------------------|--------------------------------|--------------------|--------------|-----------|--|
| FILE NAME * | USER NAME = granleasn | DESIGNED - | REVISED - | STATE OF ILLINOIS DEPARTMENT OF TRANSPORTATION | CONSTRUCTION SHEET | F.A.P. RTE. | SECTION | COUNTY | TOTAL SHEETS | SHEET NO. | |
| es:\ps_work\psdot\granleasn\d8312786\ | id-stageconstruction.dgn | DRAWN - | REVISED - | | | VAR | DR CH RIF RES AND PATCH 2013-3 | PULASKI | 10 | 9 | |
| | PLOT SCALE = 1/8" = 1' / in. | CHECKED - | REVISED - | | | SCALE: SHEET OF SHEETS STA. TO STA. | | CONTRACT NO. 78329 | | | |
| MODEL NAME# | PLOT DATE = 7/17/2012 | DATE - | REVISED - | | | ILLINOIS FED. AID PROJECT | | | | | |

ILLINOIS STANDARD

W8-1106

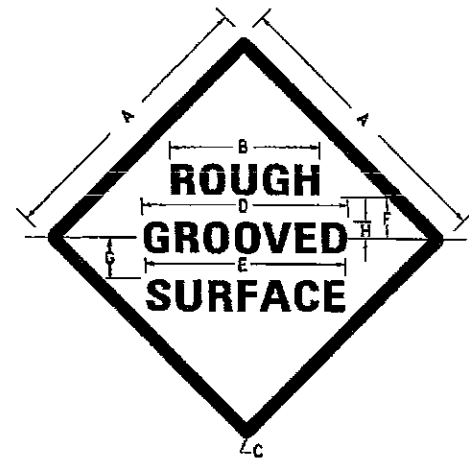

COLORS:

LEGEND AND BORDER- BLACK NON-REFLECTORIZED
BACKGROUND- ORANGE REFLECTORIZED

| SIGN SIZE | DIMENSIONS | | | | | | | |
|-----------|------------|------|-----|------|------|-----|------|-----|
| | A | B | C | D | E | F | G | H |
| 48X48 | 48.0 | 24.1 | 3.0 | 34.0 | 33.0 | 6.0 | 13.0 | 3.5 |

| SIGN SIZE | SERIES LINES | | | MAR-GIN | BOR-DER | BLANK STD. |
|-----------|--------------|----|----|---------|---------|------------|
| | 1 | 2 | 3 | | | |
| 48X48 | 7C | 7C | 7C | 0.8 | 1.2 | B4-48D |

ALL DIMENSIONS IN INCHES

NOTES:

PRIOR TO ALLOWING TRAFFIC ON ANY PORTION OF THE ROADWAY THAT HAS BEEN COLDMILLED, THE CONTRACTOR SHALL HAVE ERECTED "ROUGH GROOVED SURFACE" SIGNS THAT CONFORM TO THE ABOVE DETAILS. A MINIMUM OF ONE SIGN AT EACH END OF THE IMPROVEMENT WILL BE REQUIRED. THE CONTRACTOR SHALL MAINTAIN THE "ROUGH GROOVED SURFACE" SIGNS UNTIL THE COLDMILLED SURFACE IS COVERED WITH LEVELING BINDER OR SURFACE COURSE.

IF AT ANY TIME THE SIGNS ARE IN PLACE BUT NOT APPLICABLE, THEY SHALL BE TURNED FROM THE VIEW OF MOTORISTS OR COVERED AS DIRECTED BY THE ENGINEER.

THE COST OF FURNISHING, ERECTING, MAINTAINING, AND REMOVING THE REQUIRED SIGNS SHALL BE INCLUDED IN THE CONTRACT.

STD. 9-39

| REVISIONS | |
|-----------|---------|
| REORAWN | 2-15-89 |
| REVISED | 4-6-93 |
| REVISED | 3-27-08 |
| REVISED | |

UNEVEN LANES SIGN

W8-11 (48" x 48")

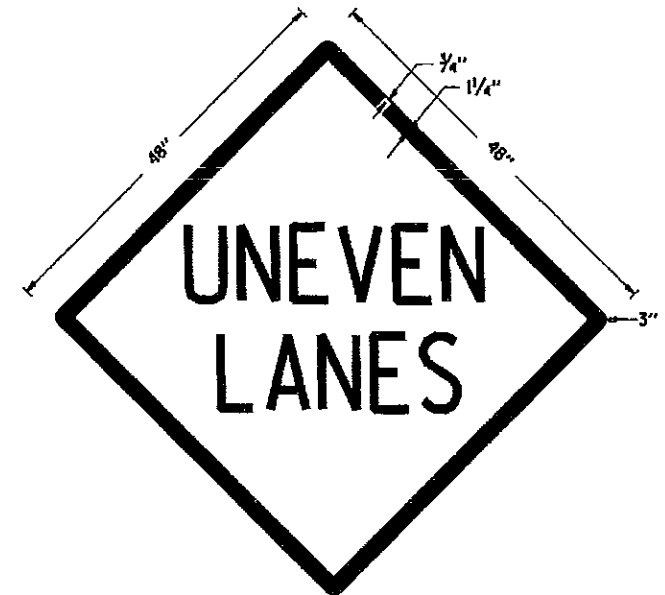

COLORS:

LEGEND AND BORDER - BLACK NON-REFLECTORIZED
BACKGROUND - ORANGE REFLECTORIZED

NOTE: PRIOR TO ALLOWING TRAFFIC ON ANY PORTION OF THE ROADWAY THAT HAS BEEN COLDMILLED OR BEFORE RESURFACING OPERATIONS BEGIN, THE CONTRACTOR SHALL HAVE ERECTED "UNEVEN PAVEMENT" SIGNS THAT CONFORM TO THE ABOVE DETAILS. A MINIMUM OF ONE SIGN AT EACH END OF THE IMPROVEMENT WILL BE REQUIRED. THE CONTRACTOR SHALL MAINTAIN THE "UNEVEN PAVEMENT" SIGNS UNTIL THE RESURFACING OPERATIONS ARE COMPLETED.

IF AT ANY TIME THE SIGNS ARE IN PLACE BUT NOT APPLICABLE, THEY SHALL BE TURNED FROM THE VIEW OF MOTORISTS OR COVERED AS DIRECTED BY THE ENGINEER.

THE COST OF FURNISHING, ERECTING, MAINTAINING, AND REMOVING THE REQUIRED SIGNS SHALL BE INCLUDED IN THE CONTRACT.

STD. 9-41

| REVISIONS | |
|-----------|---------|
| DRAWN | 2-15-89 |
| REVISED | 4-06-83 |
| RESIGNED | 7-23-04 |
| RESIZED | 5-08-08 |

| DROP-OFF LOCATION | NORMAL POSTED SPEED | DROP-OFF HEIGHT (X) AND TYPE | TREATMENT REQUIRED |
|---|---------------------|--|--|
| ≤ 3 FT ⁽¹⁾⁽²⁾ | ALL | ≤ 1 IN | NONE |
| | | 1 IN < X ≤ 3 IN | LOW SHOULDER SIGNS (2 MILE SPACING) |
| | < 45 MPH | 3 IN < X ≤ 18 IN | PLACE CHANNELIZING DEVICES AT 50-FT SPACING |
| | ≥ 45 MPH | 3 IN < X ≤ 12 IN | PLACE CHANNELIZING DEVICES AT 100-FT SPACING |
| | < 45 MPH | 18 IN < X ≤ 24 IN FOR < 0.5 MILE OR < 48 HOURS ⁽⁴⁾ | PLACE CHANNELIZING DEVICES AT 50-FT SPACING |
| | ≥ 45 MPH | 12 IN < X ≤ 18 IN FOR < 0.5 MILE OR < 48 HOURS | PLACE CHANNELIZING DEVICES AT 100-FT SPACING |
| | ≥ 45 MPH | 12 IN < X ≤ 24 IN FOR > 0.5 MILE OR > 48 HOURS | CLOSURE USING TEMPORARY TRAFFIC BARRIER |
| | < 45 MPH | 18 IN < X ≤ 24 IN ⁽⁴⁾ | CLOSURE USING TEMPORARY TRAFFIC BARRIER |
| 3 FT < X ≤ 8 FT ⁽³⁾ | ALL | ≤ 1 IN | NONE |
| | | 1 IN < X ≤ 3 IN | LOW SHOULDER SIGNS (2 MILE SPACING) |
| | < 45 MPH | 3 IN < X ≤ 24 IN ⁽⁴⁾ | PLACE CHANNELIZING DEVICES AT 50-FT SPACING |
| | ≥ 45 MPH | 3 IN < X ≤ 24 IN | PLACE CHANNELIZING DEVICES AT 100-FT SPACING |
| > 8 FOOT TO THE WORK ZONE CLEAR ZONE ⁽⁵⁾ | ALL | 24 IN ⁽⁶⁾ | CLOSURE USING TEMPORARY TRAFFIC BARRIER |
| | < 45 MPH | 12 IN < X ≤ 24 IN ⁽⁴⁾ | PLACE CHANNELIZING DEVICES AT 50-FT SPACING |
| | ≥ 45 MPH | 12 IN < X ≤ 24 IN | PLACE CHANNELIZING DEVICES AT 100-FT SPACING |
| | ALL | > 24 IN ⁽⁶⁾ | CLOSURE USING TEMPORARY TRAFFIC BARRIER |

NOTES:

- (1) PLACE CHANNELIZING DEVICES AND/OR TEMPORARY BARRIER AT THE SAME LEVEL AS THE TRAVELING LANE OR SHOULDER PROFILE
- (2) CHANNELIZING DEVICES MAY BE PLACED AT THE DROP-OFF ELEVATION TO PRESERVE LANE WIDTH. RAISE THE REFLECTIVE AREA AND WARNING LIGHT (IF REQUIRED) TO THE ELEVATION ABOVE THE TRAVELING LANE OR SHOULDER PROFILE AS PER HIGHWAY STANDARD 701901.
- (3) PLACE CHANNELIZING DEVICES OR TEMPORARY BARRIER AT SAME LEVEL AS THE SIDE SLOPE PROFILE TO BE FULLY VISIBLE.
- (4) LENGTH AND DURATION MAY BE EXCEEDED FOR URBAN AREAS WHEN ENGINEERING JUDGEMENT INDICATES SIGHT DISTANCE WILL BE ADVERSELY AFFECTED BY TEMPORARY BARRIER.
- (5) TEMPORARY TRAFFIC BARRIER MAY BE ELIMINATED FOR STATIONARY OPERATIONS OF LESS THAN 24 HOURS FOR MULTILANE, AND MAY BE ELIMINATED FOR STATIONARY OPERATIONS OF LESS THAN 96 HOURS PER STAGE FOR TWO LANES, BASED ON ENGINEERING JUDGEMENT.

| | | | | | | | | | | | |
|--|-------------------------|------------|-----------|---|---|---------------------------|--------------------------------|---------|--------------|-----------|--|
| FILE NAME = c:\pwworkspace\pudot\grain\asas\d8312785\... | USER NAME = grain\asas | DESIGNED - | REVISED - | STATE OF ILLINOIS DEPARTMENT OF TRANSPORTATION | DETAILS: ROUGH GROOVED SURFACE; UNEVEN LANES; DROP-OFF PROTECTION POLICY | F.A.P. RTE. | SECTION | COUNTY | TOTAL SHEETS | SHEET NO. | |
| | lg-roofvegdetails.dgn | DRAWN - | REVISED - | | | VAR | 09 CM R11 REG AND PATCH 2013-3 | PULASKI | 10 | 10 | |
| | PLOT SCALE = 1/8"=1'-0" | CHECKED - | REVISED - | | | CONTRACT NO. 78329 | | | | | |
| | PLOT DATE = 7/13/2012 | DATE - | REVISED - | | | ILLINOIS FED. AID PROJECT | | | | | |