

F.A. RTE.	SECTION	COUNTY	TOTAL SHEETS	SHEET NO.
HWY 37 & COLLINS	10-00004-00-SW	JOHNSON	15	1

STATE OF ILLINOIS
DEPARTMENT OF TRANSPORTATION
DIVISION OF HIGHWAYS

CENTRAL BUREAU OF
LOCAL ROADS & STREETS

PLANS FOR
SAFE ROUTES TO SCHOOLS SIDEWALK IMPROVEMENTS

VILLAGE OF GOREVILLE - VARIOUS LOCATIONS

SECTION NO. 10-00004-00-SW

PROJECT NO. SRTS-4009(032)

JOB NO. C-40-110-09

CONTRACT NO. 99447

JOHNSON COUNTY

LENGTH OF PROJECT 820.54 FEET (0.1554 MILES)

SHEET LAYOUT

- 1 COVER SHEET
- 2 NOTES & QUANTITIES
- 3-10 PLAN SHEETS
- 11-12 SIDEWALK PROFILE
- 13-14 SIDEWALK DETAIL
- 15. SIDEWALK SECTIONS

STANDARDS

- 280001-05-TEMPORARY EROSION CONTROL SYSTEMS
- 424001-05-CURB RAMP FOR SIDEWALKS
- 424001-06-PERPENDICULAR CURB RAMP FOR SIDEWALKS
- 701301-01-LANE CLOSURE, 2L, 2W, SHORT TIME OPERATIONS
- 720006-01-SIGN PANEL ERECTION DETAILS
- 729001-01-APPLICATION OF TYPES A & B METAL POST
- 780001-01-TYPICAL PAVEMENT MARKINGS

ENGINEER AND SURVEYOR'S CERTIFICATE

STATE OF ILLINOIS)
COUNTY OF WILLIAMSON)

I, JOHN H. CRAWFORD, ILLINOIS PROFESSIONAL ENGINEER NO. 29206 AND ILLINOIS PROFESSIONAL LAND SURVEYOR NO. 2061 DO HEREBY CERTIFY THAT THESE DRAWINGS WERE PREPARED BY ME, OR PREPARED UNDER MY DIRECT SUPERVISION.

IN WITNESS THEREOF, I HAVE SET MY HAND AND SEAL THIS 29TH DAY OF MAY 2012.

JOHN H. CRAWFORD
I.P.E. NO. 29206
I.P.L.S. NO. 2061
CARTERVILLE, ILLINOIS



PROJECT LOCATION

PROJECT AREA MAP

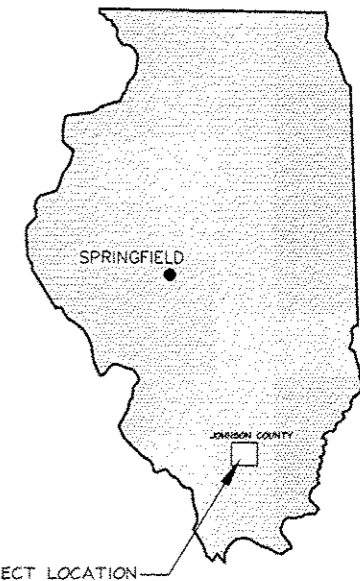

PROJECT LOCATION

Approved 6/26, 2012

[Signature]
PRESIDENT, VILLAGE OF GOREVILLE

Passed JULY 9, 2012

[Signature]
District 9 Engineer of Local Roads and Streets

Releasing for Bid
Based on Limited
Review

7/9, 2012

[Signature]
Deputy Director of Highways, Region 5 Engineer

NO.	DESCRIPTION	BY	DATE	NO.	DESCRIPTION	BY	DATE
					DESIGNED		
					DRAWN	WDS	3/27/12
					CHECKED	JHC	3/27/12

VILLAGE OF GOREVILLE
JOHNSON COUNTY, IL
SAFE ROUTES TO SCHOOL
COVER PAGE

JOHN H. CRAWFORD & ASSOCIATES, P.C.
CIVIL ENGINEERS, LAND SURVEYORS
201 SOUTH DIVISION STREET, CARTERVILLE, ILLINOIS 62910
PHONE (618) 985-6370 FAX (618) 985-4592
PROFESSIONAL DESIGN FIRM # 184-002855

SHEET NO.	
1	
ISSUE	DATE
A	5/29/12

APPENDIX P - MEASUREMENTS, SURVEYING, 2012, 10:11:20 AM

NOTES:

1. ALL MATERIALS AND METHODS SHALL BE IN ACCORDANCE WITH STANDARD SPECIFICATIONS FOR WATER AND SEWER MAIN CONSTRUCTION IN ILLINOIS LATEST EDITION.
2. CONTRACTORS SHALL CONTACT EACH UTILITY COMPANY PRIOR TO CONSTRUCTION. ANY DAMAGE CAUSED TO EXISTING UTILITIES SHALL BE THE CONTRACTORS RESPONSIBILITY AND CONTRACTOR SHALL LEND ALL POSSIBLE ASSISTANCE IN RESTORING SERVICE.
3. NOT ALL OF THE GAS, POWER OR TELEPHONE LINES, WERE ABOVE OR BELOW GROUND, HAVE BEEN SHOWN ON THE PLANS. THE LOCATION OF EXISTING UNDERGROUND UTILITIES, SUCH AS GAS OR WATER MAINS, ETC., AS SHOWN ON THE PLANS HAVE BEEN DETERMINED FROM THE BEST AVAILABLE INFORMATION AND ARE GIVEN FOR THE CONVENIENCE OF THE CONTRACTOR. THE CONTRACTOR SHALL ASSUME RESPONSIBILITY FOR ALL UTILITIES, WHETHER SHOWN OR NOT, AND MUST REALIZE THAT THE ACTUAL LOCATIONS AND THOSE SHOWN MAY BE DIFFERENT.
4. INTERRUPTION OF UTILITY SERVICE IS NOT EXPECTED. HOWEVER, IF INTERRUPTION OF ANY UTILITY SERVICE IS NECESSARY, THE CONTRACTOR SHALL GIVE AT LEAST ONE DAY NOTICE TO CUSTOMERS INVOLVED AND SHALL USE ALL HIS RESOURCES TO MINIMIZE INTERRUPTION.
5. ALL DISTURBED AREAS SHALL BE GRADED TO PROVIDE POSITIVE DRAINAGE. CULVERTS, FIELD TILES AND OTHER DRAINAGE FACILITIES DAMAGED DURING CONSTRUCTION SHALL BE REPLACED BY CONTRACTOR AT NO ADDITIONAL COST TO THE VILLAGE.
6. ANY PERMANENT SURFACE, STREET, DRIVEWAY, OR SIDEWALK DAMAGE BY CONTRACTOR SHALL BE REPAIRED BY CONTRACTOR.
7. DETECTABLE WARNINGS SHALL BE YELLOW IN COLOR AT ALL LOCATIONS.

SUMMARY OF QUANTITIES

CODE #	ITEM DESCRIPTION	TOTAL	UNIT
20100110	TREE REMOVAL (6 - 15 UNIT DIAMETER)	100	UNIT
20200100	EARTH EXCAVATION	300	CU YD
21400100	GRADING AND SHAPING DITCH	400	FOOT
25000100	SEEDING, CLASS 1	0.9	ACRE
28100107	STONE RIP RAP CLASS A 4	600	SQ YD
42400200	PORTLAND CEMENT CONCRETE SIDEWALK 5 INCH	4,011	SQ FT
42400400	PORTLAND CEMENT CONCRETE SIDEWALK 7 INCH	524	SQ FT
42400800	DETECTABLE WARNINGS	256	SQ FT
44000300	CURB REMOVAL	98	FOOT
44000600	SIDEWALK REMOVAL	1,401	SQ FT
50300225	CONCRETE STRUCTURES	28	CU YD
50901760	PIPE HANDRAIL	240	FOOT
54010604	PRE CAST CONCRETE BOX CULVERT, 6'x4'	24	FOOT
542A0220	PIPE CULVERT CL A 1, 15"	20	FOOT
67100100	MOBILIZATION	1	LUMP SUM
70100450	TRAFFIC CONTROL AND PROTECTION	1	LUMP SUM
72000100	SIGN PANEL TYPE 1	144	SQ FT
72400500	RELOCATE SIGN PANEL ASSEMBLY	3	EACH
72900100	METAL POST TYPE A	168	FOOT
△ 78001150	PAINT PAVEMENT MARKING LINE 12"	1344	FOOT
54001001	BOX CULVERT END SECTIONS, CULVERT NO 1	2	EACH
42300100	PORTLAND CEMENT CONCRETE DRIVEWAY PAVEMENT, 5 INCH	16.3	SQ YD
XX000503	SPLIT RAIL FENCE	680	FOOT
△ X8210425	LUMINAIRE, STREET LIGHTING, HIGH PRESSURE SODIUM VAPOR, 250 WATT, 240 VOLT	10	EACH
△ X032571A	FLASHING BEACON POST MOUNTED, SOLAR POWERED INSTALLATION	6	EACH

△ SPECIALTY ITEMS

Z:\projects\land Projects\Eng\COREVILLE SIDE WALKS 2010\dwg\SIDE WALKS 2012.dwg, 7/30/2012 9:14:00 AM

NO.	DESCRIPTION	BY	DATE	NO.	DESCRIPTION	BY	DATE
					DESIGNED		
					DRAWN	WFL	3/27/12
					CHECKED	JHC	3/27/12
				A1	REVISED PER IDOT REQUEST	WOS	7/30/12

VILLAGE OF GOREVILLE
 JOHNSON COUNTY, IL
 SAFE ROUTES TO SCHOOL
 NOTES AND QUANTITIES



JOHN H. CRAWFORD & ASSOCIATES, P.C.
 CIVIL ENGINEERS, LAND SURVEYORS
 201 SOUTH DIVISION STREET, CARTERSVILLE, ILLINOIS 62916
 PHONE (618) 285-0370 FAX (618) 285-4622
 PROFESSIONAL DESIGN FIRMA # 184-002885

SHEET NO.	
2	
ISSUE	DATE
A1	7/30/12

F.A. RTE.	SECTION	COUNTY	TOTAL SHEETS	SHEET NO.
HWY 57 & COLLINS	10-00004-00-5W	JOHNSON	15	3



SCALE: 1" = 10'

LEGEND

- IRON PIN FOUND
- △ STONE FOUND
- 1/2" IRON PIN SET
- CONCRETE MONUMENT SET
- ▲ ROAD SIGN
- ◇ POWER POLE
- GUY WIRE
- ⊕ WATER METER
- ⊕ WATER HYDRANT
- ⊕ LIGHT POLE

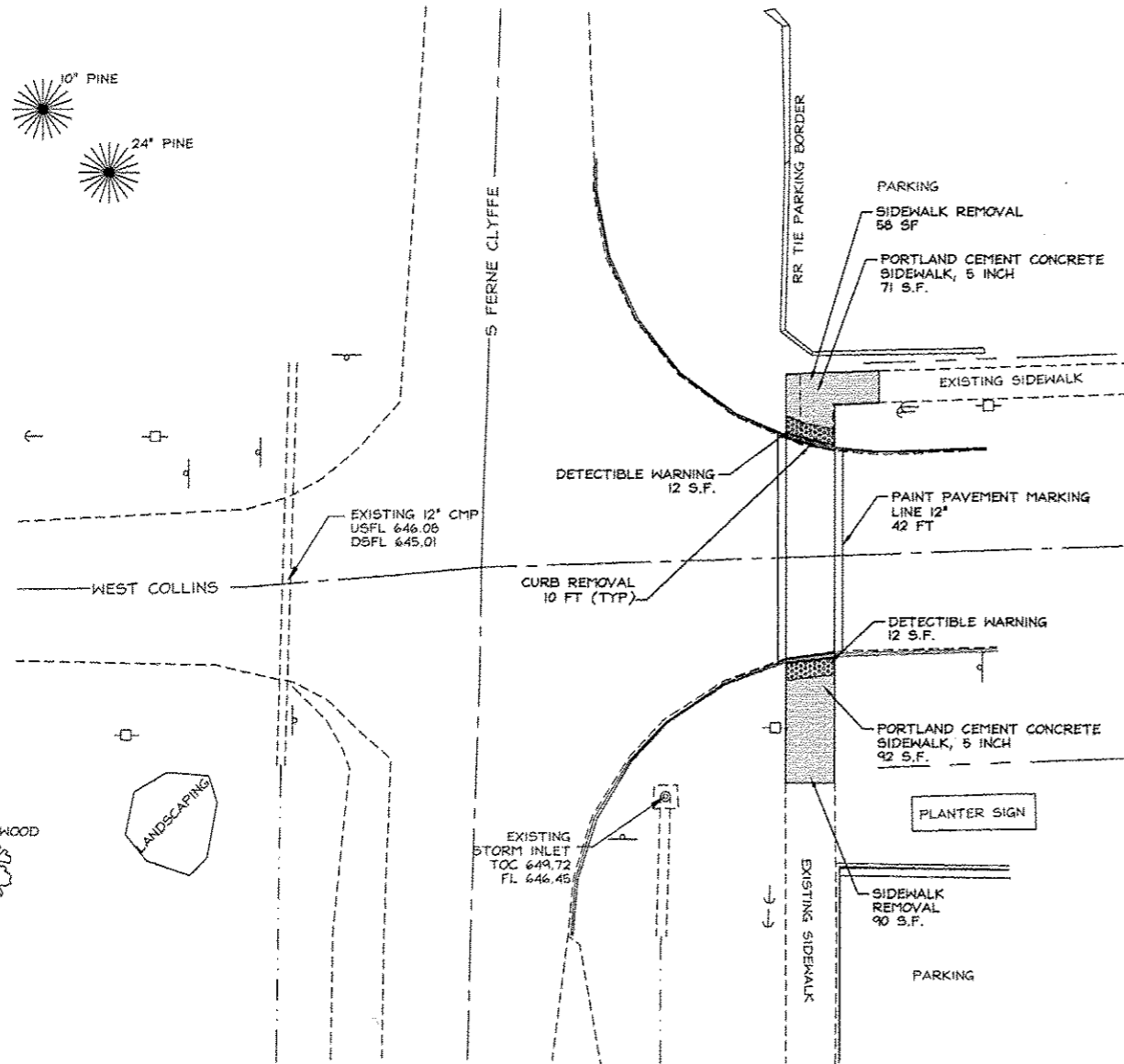
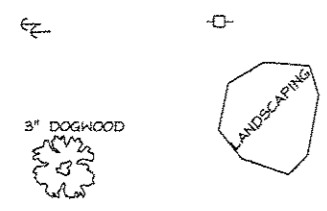
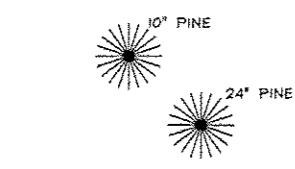

NO.	DESCRIPTION	BY	DATE	NO.	DESCRIPTION	BY	DATE

VILLAGE OF GOREVILLE
 JOHNSON COUNTY, IL
 SCHOOL SAFE WAY PLAN
 PLAN SHEET

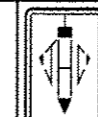

JOHN H. CRAWFORD & ASSOCIATES, P.C.
 CIVIL ENGINEERS, LAND SURVEYORS
 201 SOUTH DIVISION STREET, CARTERSVILLE, ILLINOIS 62918
 PHONE (618) 965-6370 FAX (618) 905-4692
 PROFESSIONAL DESIGN FIRM # 184-002865

SHEET NO.	
3	
ISSUE	DATE
A	3/27/12

ASSOCIATION PROFESSIONAL ENGINEERS PROGRAMS TOURNAMENT/REGISTRATION 6/15/2012 10:35:24 AM

F.A. RTE.	SECTION	COUNTY	TOTAL SHEET	SHEET NO.
HWY 37 & COLLINS	10-00004-00-SW	JOHNSON	15	4

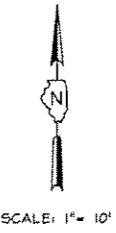
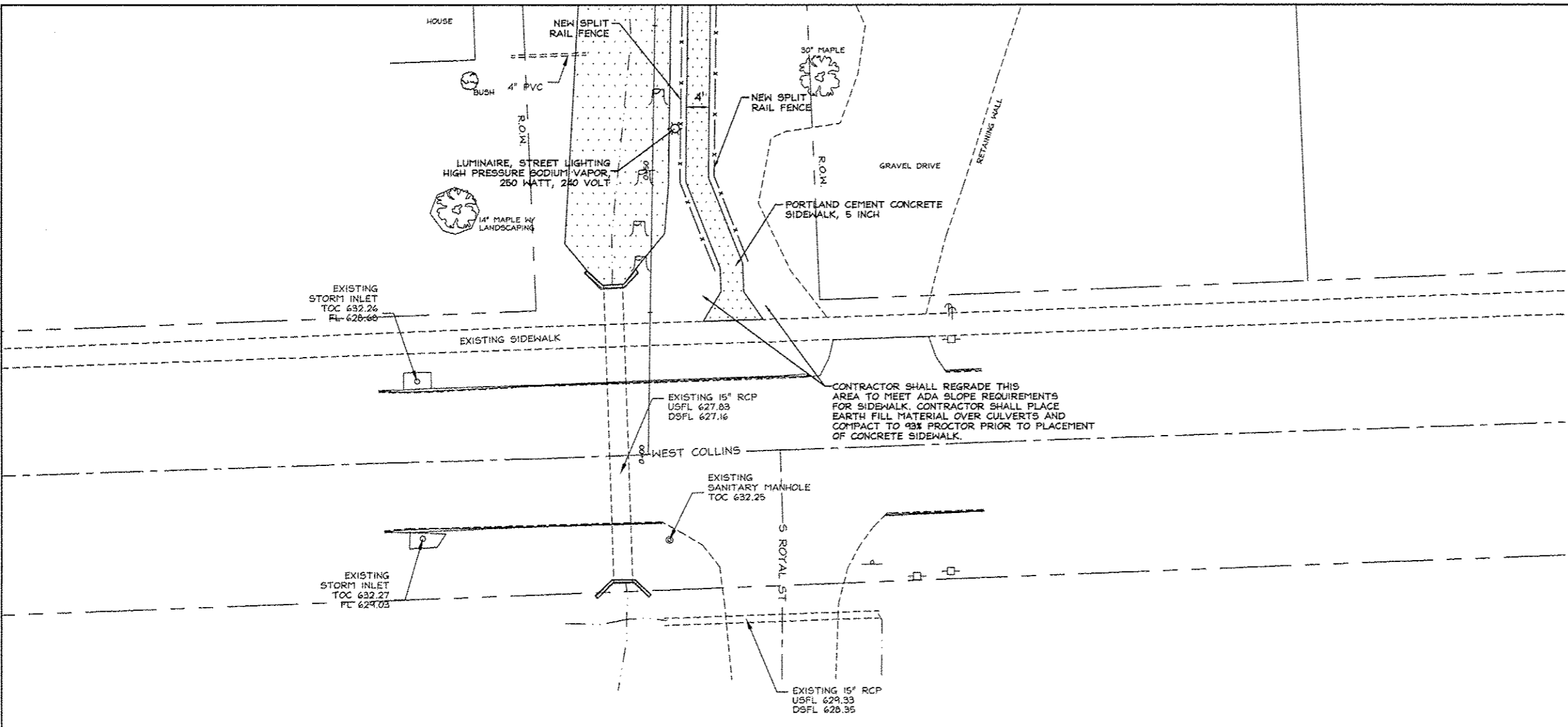

- LEGEND**
- IRON PIN FOUND
 - △ STONE FOUND
 - 1/2" IRON PIN SET
 - CONCRETE MONUMENT SET
 - ∕ ROAD SIGN
 - ⊕ POWER POLE
 - ⊖ GUY WIRE
 - ⊕ WATER METER
 - ⊕ WATER HYDRANT
 - ⊕ LIGHT POLE

NO.	DESCRIPTION	BY	DATE	NO.	DESCRIPTION	BY	DATE
					DESIGNED		
					DRAWN	WFL	3/27/12
					CHECKED	JHC	3/27/12

VILLAGE OF GOREVILLE
 JOHNSON COUNTY, IL
 SCHOOL SAFE WAY PLAN
 PLAN SHEET

JOHN H. CRAWFORD & ASSOCIATES, P.C.
 CIVIL ENGINEERS, LAND SURVEYORS
 201 SOUTH DIVISION STREET, CARTERSVILLE, ILLINOIS 62910
 PHONE (618) 985-6310 FAX (618) 985-4632
 PROFESSIONAL DESIGN FIRM # 184-002885

SHEET NO.	
4	
ISSUE	DATE
A	3/27/12

1. Verify All Requirements, Easements, Setbacks, Encroachments, Etc. Before Proceeding With This Plan.

F.A. RTE.	SECTION	COUNTY	TOTAL SHEETS	SHEET NO.
HWY 37 & COLLINS	10-00094-00-504	JOHNSON	15	5

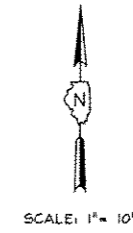

- LEGEND**
- IRON PIN FOUND
 - △ STONE FOUND
 - 1/2" IRON PIN SET
 - CONCRETE MONUMENT SET
 - ⊕ ROAD SIGN
 - ⊖ POWER POLE
 - ⊘ GUY WIRE
 - ⊙ WATER METER
 - ⊙ WATER HYDRANT
 - ☆ LIGHT POLE

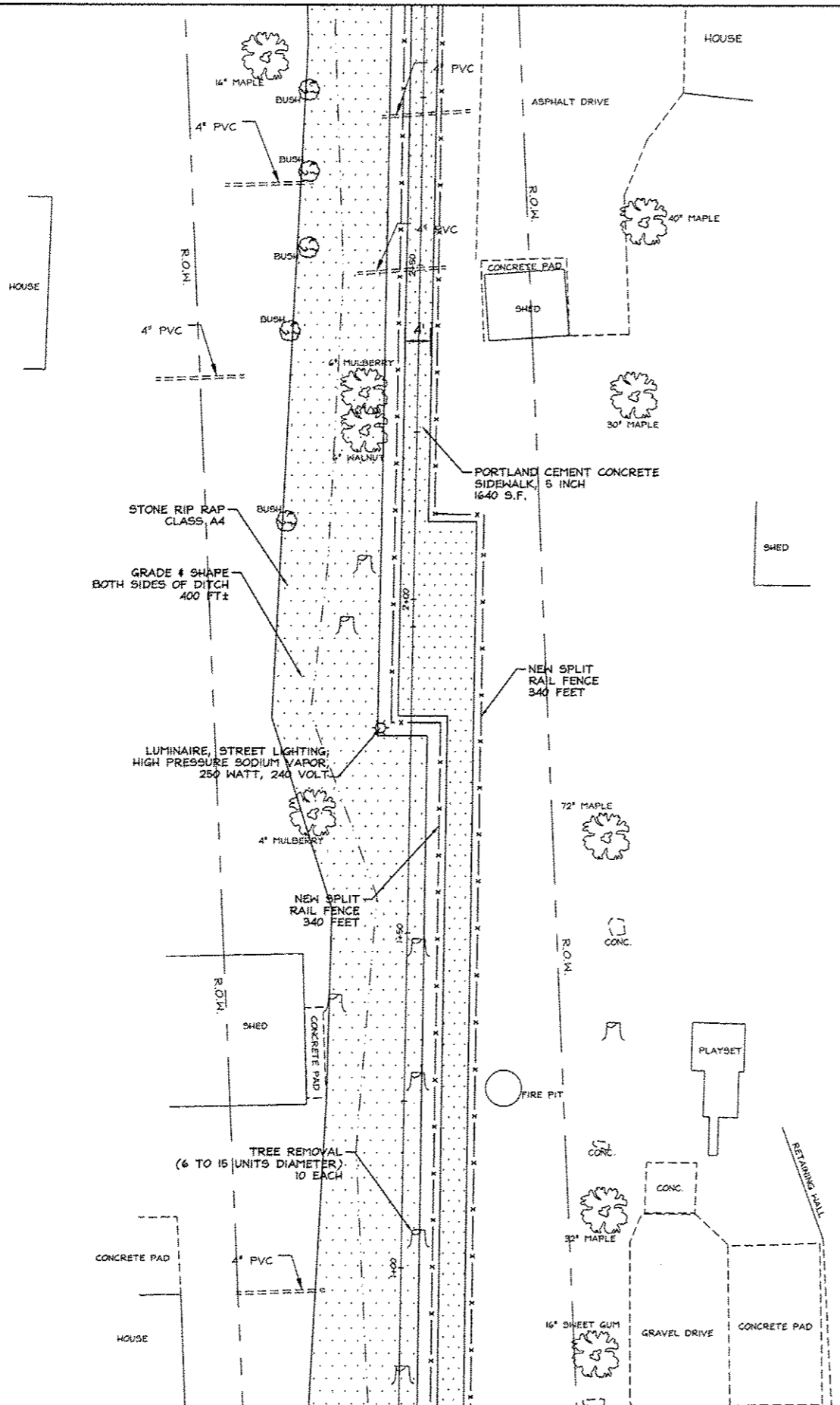

NO.	DESCRIPTION	BY	DATE	NO.	DESCRIPTION	BY	DATE
					DESIGNED		
					DRAWN	WFL	3/27/12
					CHECKED	JHC	3/27/12

VILLAGE OF GOREVILLE
 JOHNSON COUNTY, IL
 SCHOOL SAFE WAY PLAN
 PLAN SHEET



JOHN H. CRAWFORD & ASSOCIATES, P.C.
 CIVIL ENGINEERS, LAND SURVEYORS
 201 SOUTH DIVISION STREET, CARTERSVILLE, ILLINOIS 62910
 PHONE (618) 985-6370 FAX (618) 985-4892
 PROFESSIONAL DESIGN FIRM # 184-002885

SHEET NO.	
5	
ISSUE	DATE
A	3/27/12

K:\Projects\12-00094\12-00094-00-504.dwg, 3/27/12, 11:29:45 AM

F.A. RTE.	SECTION	COUNTY	TOTAL SHEETS	SHEET NO.
HWY 97 & COLLINS	10-00004-00-SH	JOHNSON	15	6

SCALE: 1" = 10'

LEGEND

- IRON PIN FOUND
- ▲ STONE FOUND
- 1/2" IRON PIN SET
- CONCRETE MONUMENT SET
- ROAD SIGN
- ⊕ POWER POLE
- GUY WIRE
- ⊕ WATER METER
- ⊕ WATER HYDRANT
- ⊕ LIGHT POLE

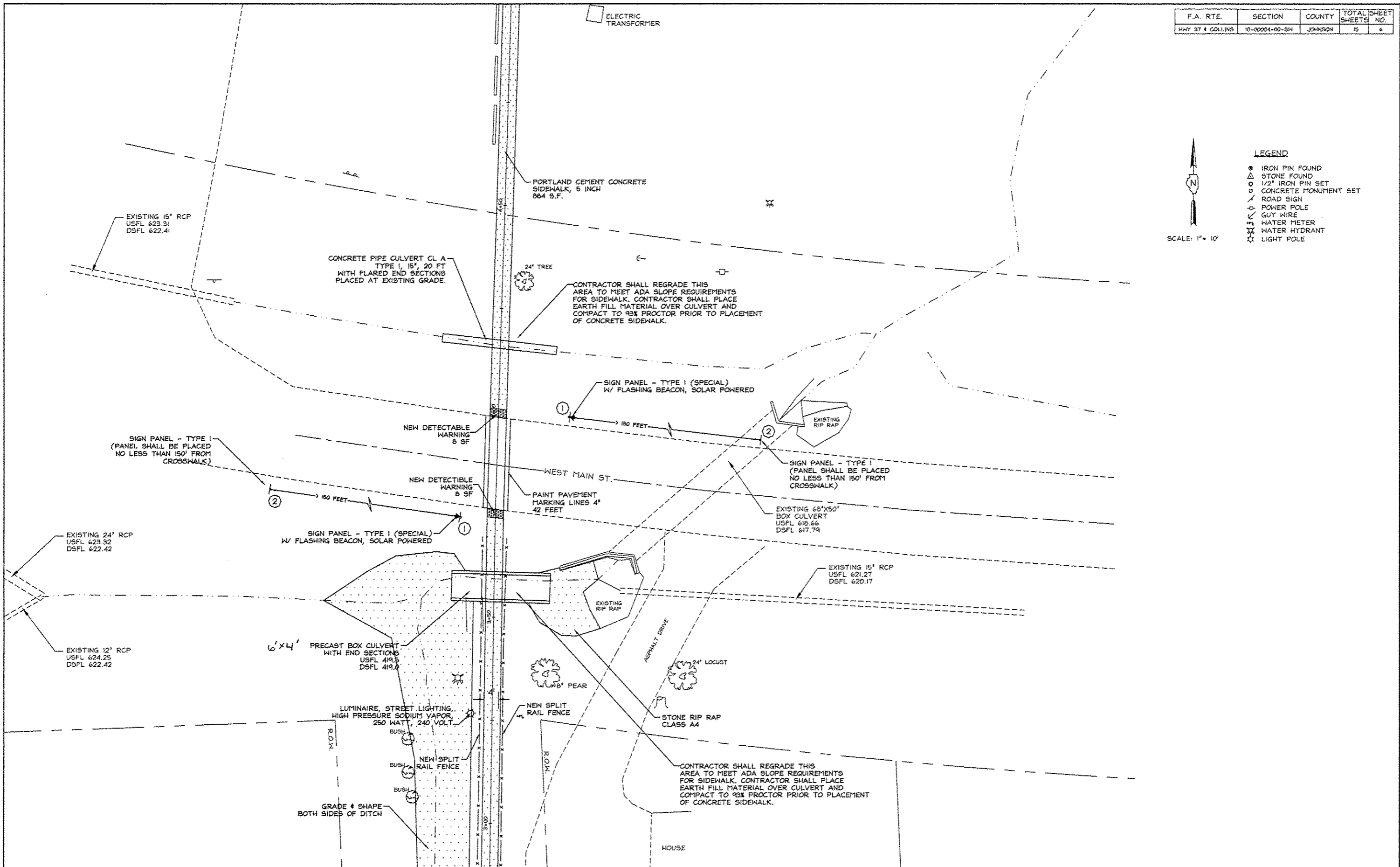

NO.	DESCRIPTION	BY	DATE	NO.	DESCRIPTION	BY	DATE
					DESIGNED		
					DRAWN	WFL	3/27/12
					CHECKED	JHC	3/27/12

VILLAGE OF GOREVILLE
 JOHNSON COUNTY, IL
 SCHOOL SAFE WAY PLAN
 PLAN SHEET

JOHN H. CRAWFORD & ASSOCIATES, P.C.
 CIVIL ENGINEERS, LAND SURVEYORS
 201 SOUTH DIVISION STREET, CARTERSVILLE, ILLINOIS 62919
 PHONE (618) 965-6976 FAX (618) 965-4592
 PROFESSIONAL DESIGN FIRM # 184-002885

SHEET NO.	
6	
ISSUE	DATE
A	3/27/12

C:\Users\jrcrawford\Documents\2012\10-00004\2012-03-27\10-00004-00-SH-06.dwg 6/13/2012 10:33:16 AM

F.A. RTE.	SECTION	COUNTY	TOTAL SHEETS	SHEET NO.
HWY 37 & COLLINS	10-00004-00-SW	JOHNSON	16	7

EXISTING BASEBALL FIELD

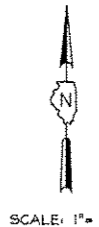

- LEGEND**
- IRON PIN FOUND
 - ▲ STONE FOUND
 - 1/2" IRON PIN SET
 - CONCRETE MONUMENT SET
 - ∕ ROAD SIGN
 - ⊖ POWER POLE
 - ⊘ GUY WIRE
 - ⊕ WATER METER
 - ⊗ WATER HYDRANT
 - ☆ LIGHT POLE

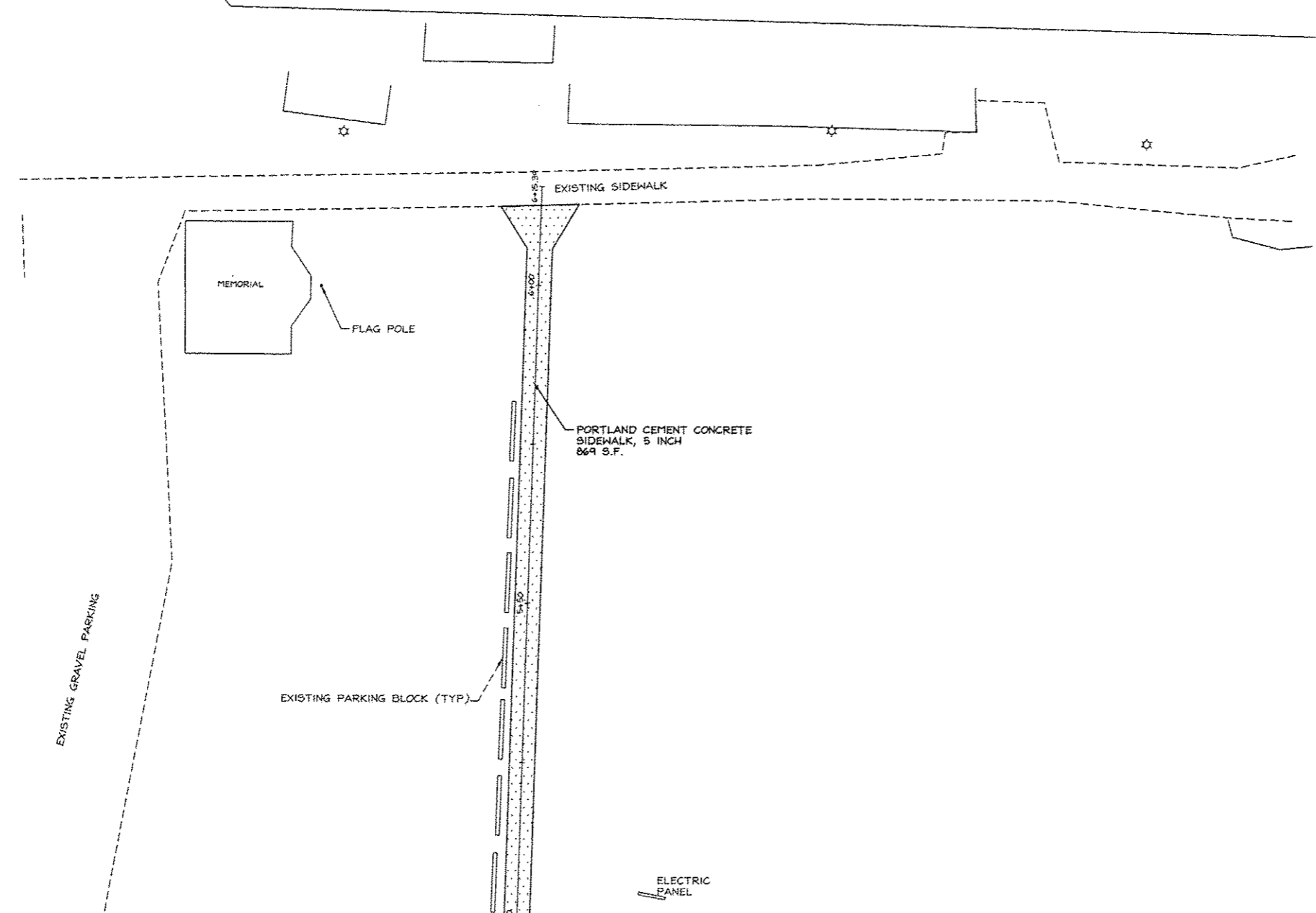

NO.	DESCRIPTION	BY	DATE	NO.	DESCRIPTION	BY	DATE

VILLAGE OF GOREVILLE
JOHNSON COUNTY, IL
SCHOOL SAFE WAY PLAN
PLAN SHEET



JOHN H. CRAWFORD & ASSOCIATES, P.C.
CIVIL ENGINEERS, LAND SURVEYORS
201 SOUTH DIVISION STREET, CARTERSVILLE, ILLINOIS 62918
PHONE (618) 985-6370 FAX (618) 985-4992
PROFESSIONAL DESIGN FIRM # 104-002885

SHEET NO.	
7	
ISSUE	DATE
A	3/27/12

AutoCAD 2010 Project: 10-00004-00-SW.dwg, 3/27/12, 10:44:44 AM

F.A. RTE.	SECTION	COUNTY	TOTAL SHEETS	SHEET NO.
HWY 37 & COLLINS	10-00004-00-SW	JOHNSON	15	8

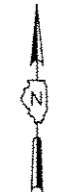

SCALE: 1" = 10'

- LEGEND**
- IRON PIN FOUND
 - ▲ STONE FOUND
 - 1/2" IRON PIN SET
 - CONCRETE MONUMENT SET
 - ROAD SIGN
 - POWER POLE
 - GUY WIRE
 - ⊕ WATER METER
 - ⊕ WATER HYDRANT
 - ☆ LIGHT POLE
 - MAILBOX

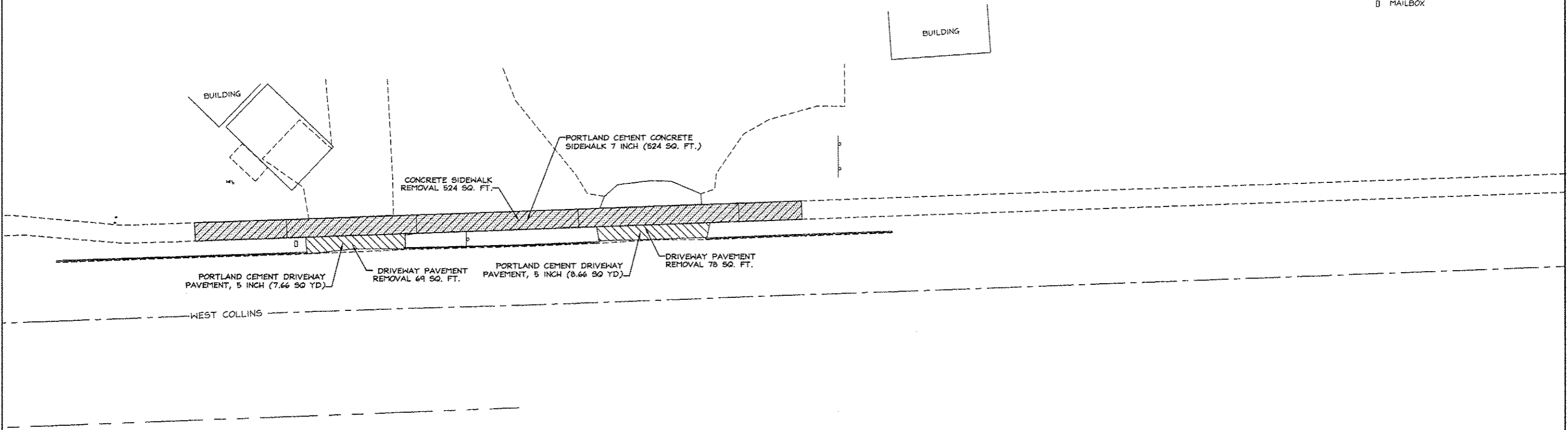

NO.	DESCRIPTION	BY	DATE	NO.	DESCRIPTION	BY	DATE

VILLAGE OF GOREVILLE
 JOHNSON COUNTY, IL
 SCHOOL SAFE WAY PLAN
 PLAN SHEET

JOHN H. CRAWFORD & ASSOCIATES, P.C.
 CIVIL ENGINEERS, LAND SURVEYORS
 201 SOUTH DIVISION STREET, CARTERSVILLE, ILLINOIS 62918
 PHONE (618) 985-6370 FAX (618) 985-4882
 PROFESSIONAL DESIGN FIRM # 184-002885

SHEET NO.	
8	
ISSUE	DATE
A	3/27/12

AutoCAD Project File: GOREVILLE_SCHOOL_SAFE_WAY_PLAN_SHEET.dwg, 3/27/12, 10:29:01 AM

F.A. RTE.	SECTION	COUNTY	TOTAL SHEETS	SHEET NO.
HWY 37 & COLLINS	10-00004-00-SW	JOHNSON	15	9

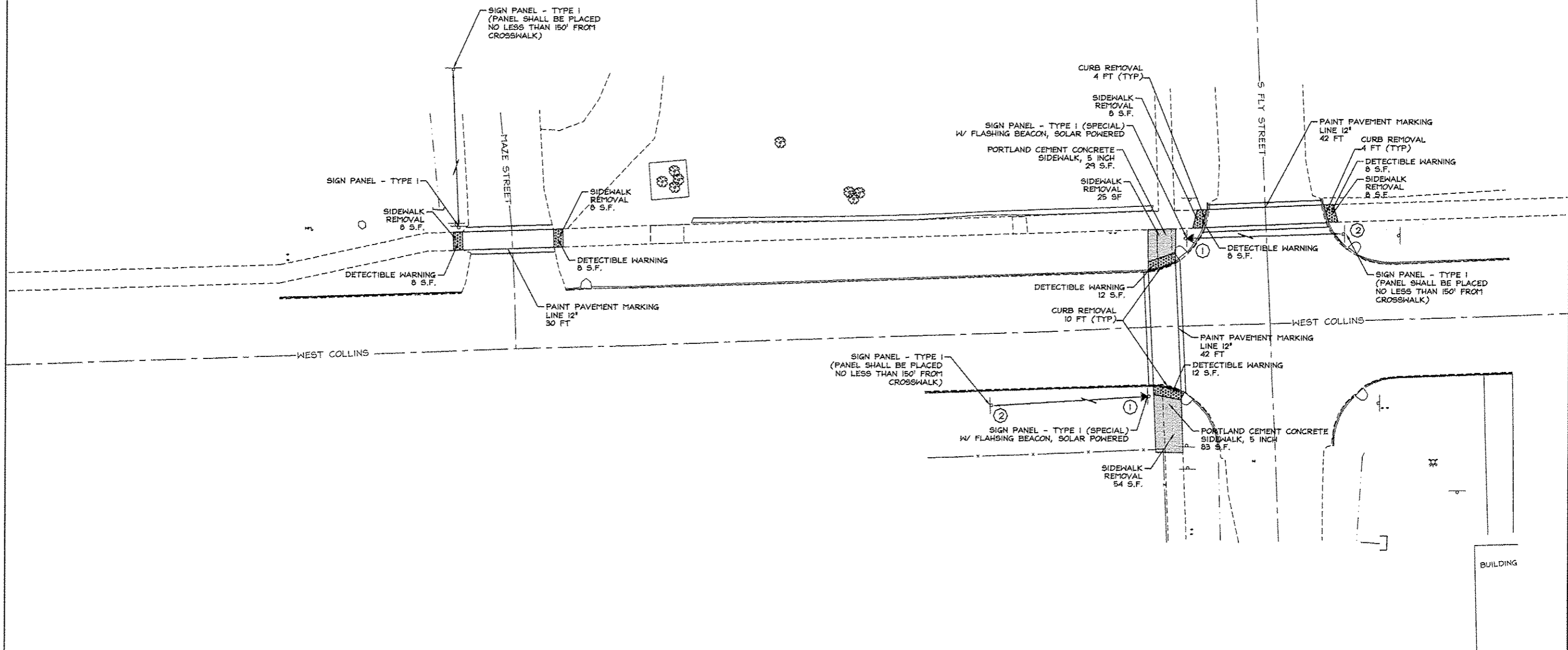

SCALE: 1" = 10'

LEGEND

- IRON PIN FOUND
- △ STONE FOUND
- 1/2" IRON PIN SET
- CONCRETE MONUMENT SET
- ROAD SIGN
- POWER POLE
- GUY WIRE
- WATER METER
- WATER HYDRANT
- LIGHT POLE

NO.	DESCRIPTION	BY	DATE	NO.	DESCRIPTION	BY	DATE

VILLAGE OF GOREVILLE
JOHNSON COUNTY, IL
SCHOOL SAFE WAY PLAN
PLAN SHEET

JOHN H. CRAWFORD & ASSOCIATES, P.C.
CIVIL ENGINEERS, LAND SURVEYORS
201 SOUTH DIVISION STREET, CARTERSVILLE, ILLINOIS 62910
PHONE (618) 955-6370 FAX (618) 985-4692
PROFESSIONAL DESIGN FIRM # 184-002885

SHEET NO.	
9	
ISSUE	DATE
A	3/27/12

L:\PROJECTS\2012\2012-03-27\2012-03-27-001\2012-03-27-001.dwg 6/27/2012 10:28:38 AM

F.A. RTE.	SECTION	COUNTY	TOTAL SHEETS	SHEET NO.
HWY 37 & COLLINS	10-00004-00-5M	JOHNSON	15	10

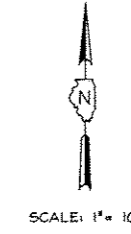

- LEGEND**
- IRON PIN FOUND
 - ▲ STONE FOUND
 - 1/2" IRON PIN SET
 - CONCRETE MONUMENT SET
 - ROAD SIGN
 - POWER POLE
 - GUY WIRE
 - ⊕ WATER METER
 - ⊕ WATER HYDRANT
 - ★ LIGHT POLE

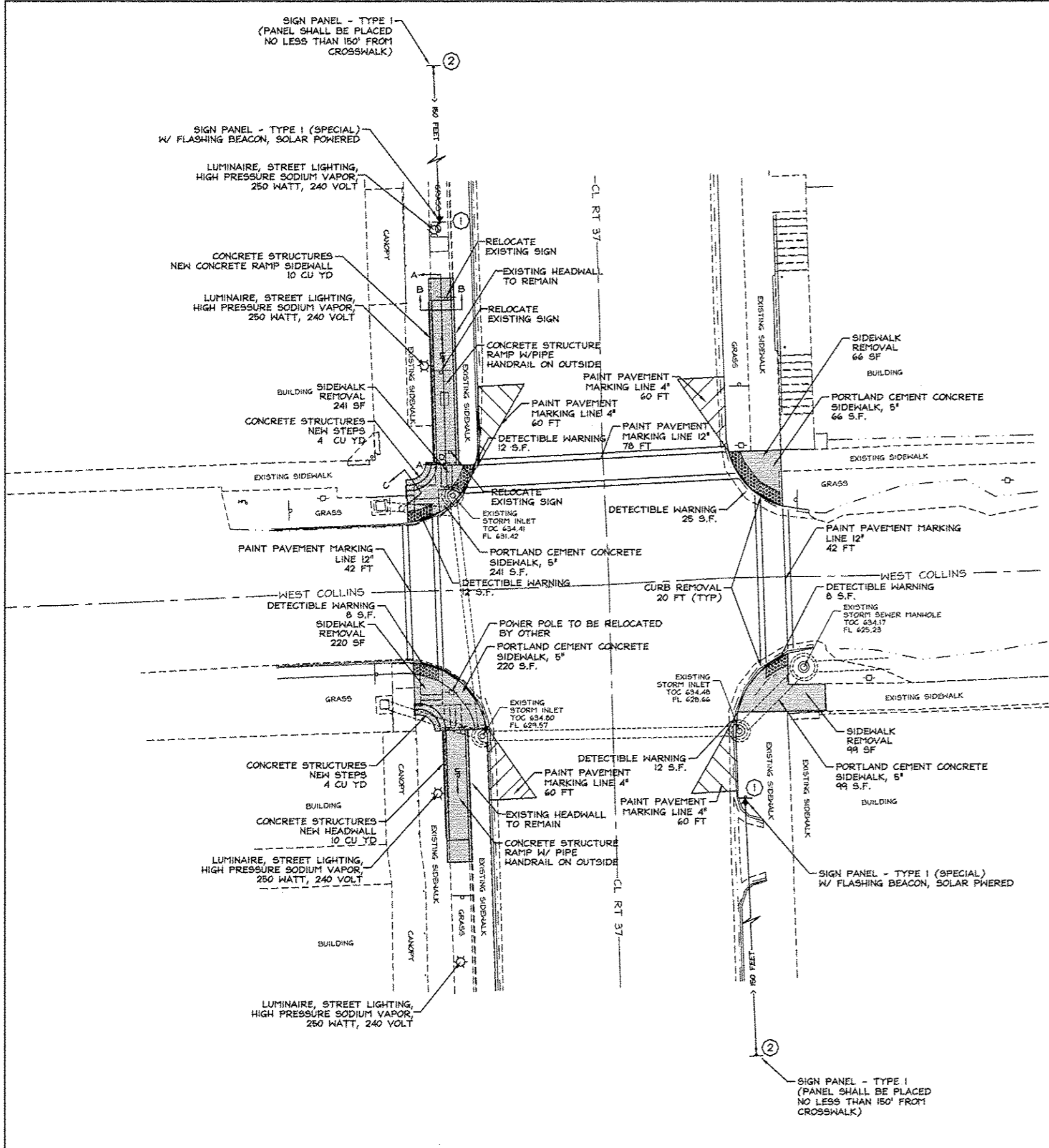

DATE PLOTTED: 03/27/2012 10:34:40 AM

NO.	DESCRIPTION	BY	DATE	NO.	DESCRIPTION	BY	DATE
					DESIGNED		
					DRAWN	WFL	3/27/12
					CHECKED	JHC	3/27/12

VILLAGE OF GOREVILLE
 JOHNSON COUNTY, IL
 SCHOOL SAFE WAY PLAN
 PLAN SHEET

JOHN H. CRAWFORD & ASSOCIATES, P.C.
 CIVIL ENGINEERS, LAND SURVEYORS
 201 SOUTH DIVISION STREET, CARTERSVILLE, ILLINOIS 62918
 PHONE (618) 985-8370 FAX (618) 985-4592
 PROFESSIONAL DESIGN FIRM # 104-002865

SHEET NO.	
10	
ISSUE	DATE
A	3/27/12

F.A. RTE.	SECTION	COUNTY	TOTAL SHEET
HWY 37 & COLLINS	10-00004-00-SW	JOHNSON	SHEETS NO.
			15 11

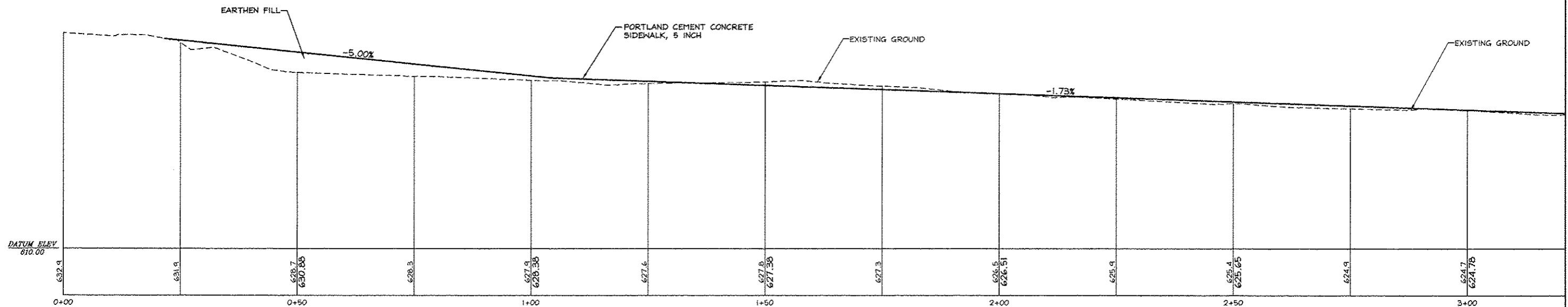

NO.	DESCRIPTION	BY	DATE	NO.	DESCRIPTION	BY	DATE

BY	DATE
DESIGNED	
DRAWN	WFL 3/27/12
CHECKED	JHC 3/27/12

VILLAGE OF GOREVILLE
JOHNSON COUNTY, IL
SCHOOL SAFE WAY PLAN
SIDEWALK PROFILE



JOHN H. CRAWFORD & ASSOCIATES, P.C.
CIVIL ENGINEERS, LAND SURVEYORS
201 SOUTH DIVISION STREET, CARTERSVILLE, ILLINOIS 62812
PHONE (618) 985-6370 FAX (618) 985-4692
PROFESSIONAL DESIGN FIRM # 184-002885

SHEET NO.	
11	
ISSUE	DATE
A	3/27/12

V:\Projects\10-00004\10-00004-SW\SCH\10-00004-SW-SIDWALK.PLT 3/27/2012 10:24:10 AM

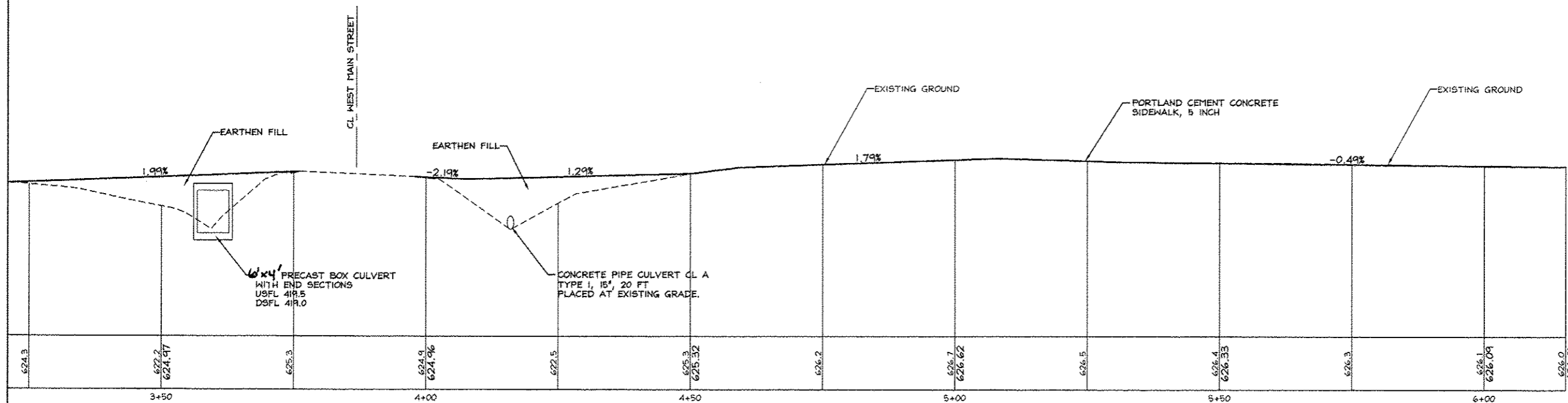

NO.	DESCRIPTION	BY	DATE	NO.	DESCRIPTION	BY	DATE	NO.	DESCRIPTION	BY	DATE
									DESIGNED		
									DRAWN	WFL	3/27/12
									CHECKED	JHC	3/27/12

VILLAGE OF GOREVILLE
JOHNSON COUNTY, IL
SCHOOL SAFE WAY PLAN
SIDEWALK PROFILE



JOHN H. CRAWFORD & ASSOCIATES, P.C.
CIVIL ENGINEERS, LAND SURVEYORS
201 SOUTH DIVISION STREET, CARTERSVILLE, ILLINOIS 62918
PHONE (618) 985-6370 FAX (618) 985-4692
PROFESSIONAL DESIGN FIRM # 184-002895

SHEET NO.	
12	
ISSUE	DATE
A	3/27/12

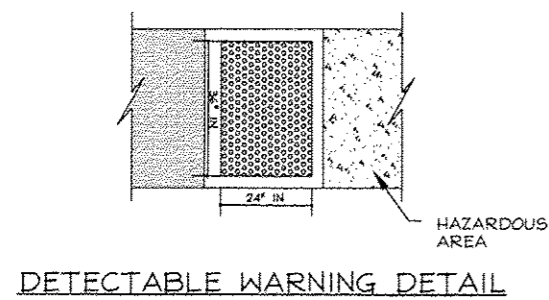
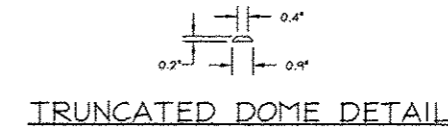
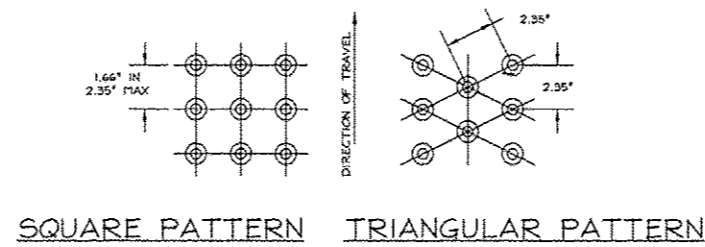
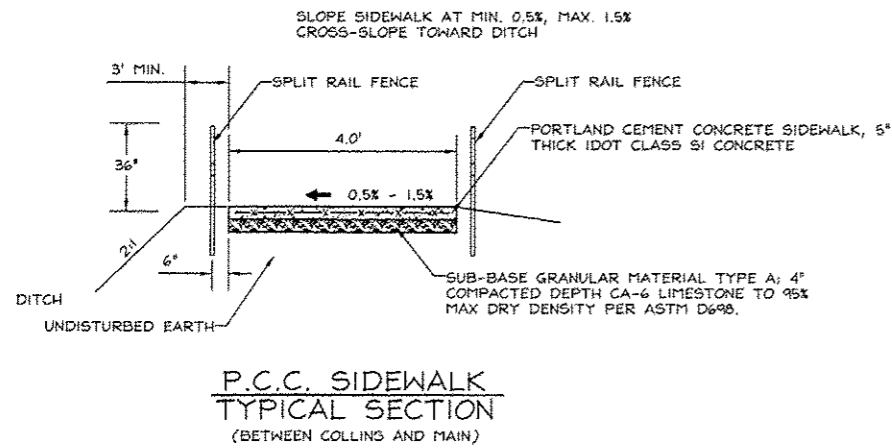
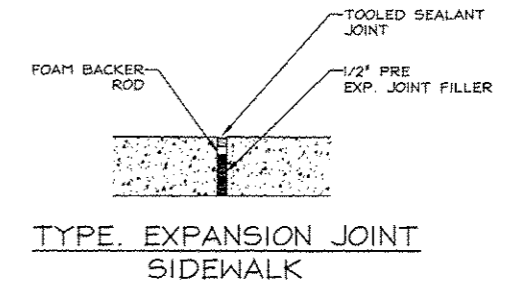
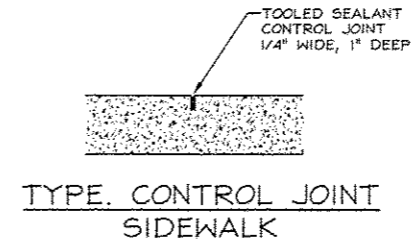
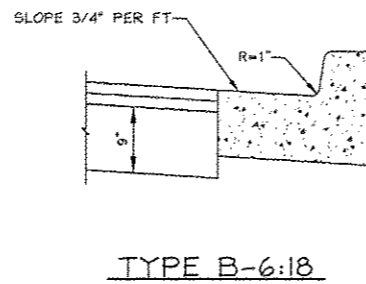
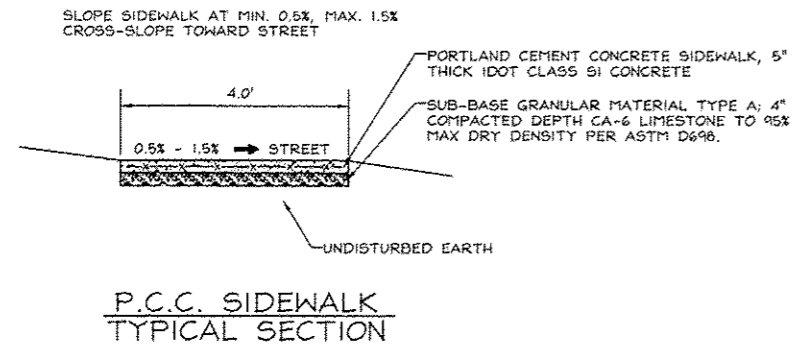

LOCATION	QTY	SIGN CODE	SIZE	SYMB/LETT/BORD	BACKGROUND
①	6	SI-1	36"X36"	BLACK	FLUORESCENT YELLOW-GREEN
	6	W16-7P	24"X12"	BLACK	FLUORESCENT YELLOW-GREEN
	6	AMBER BEACON-SEE SPECIFICATIONS FOR DETAILS			
②	6	SI-1	36"X36"	BLACK	FLUORESCENT YELLOW-GREEN
	6	W16-9P	24"X12"	BLACK	FLUORESCENT YELLOW-GREEN

SCHEDULE OF SIGNS

NO.	DESCRIPTION	BY	DATE	NO.	DESCRIPTION	BY	DATE

VILLAGE OF GOREVILLE
 JOHNSON COUNTY, IL
 SAFE ROUTES TO SCHOOL
 SIDEWALK DETAIL AND SIGN SCHEDULE



JOHN H. CRAWFORD & ASSOCIATES, P.C.
 CIVIL ENGINEERS, LAND SURVEYORS
 201 SOUTH DIVISION STREET, CARTERSVILLE, ILLINOIS 62918
 PHONE (618) 985-6370 FAX (618) 985-4692
 PROFESSIONAL DESIGN FIRM # 184-002885

SHEET NO.	
13	
ISSUE	DATE
A	3/27/12

VILLAGE OF GOREVILLE, JOHNSON COUNTY, ILLINOIS, PROJECT NO. 10-00004-00-9H, SHEET NO. 13 OF 15, DATE 3/27/12

F.A. RTE.	SECTION	COUNTY	TOTAL SHEETS	SHEET NO.
HWY 37 & COLLINS	10-00004-00-SW	JOHNSON	15	14

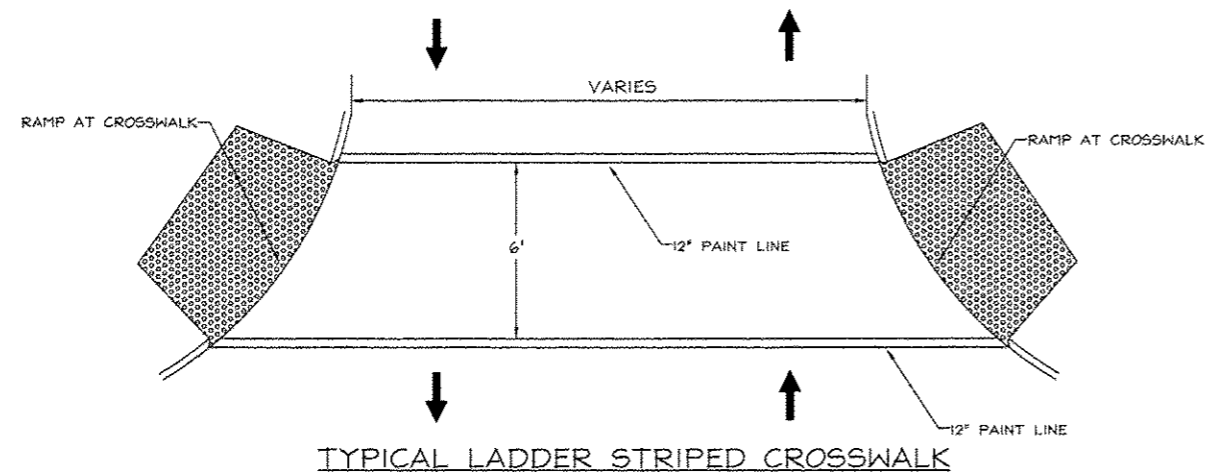

NOTE: DETAILS FOR WORK LOCATED AT THE SOUTHWEST CORNER OF HIGHWAY 37 AND COLLINS STREET SHALL BE MIRROR VIEW OF DETAILS A-A, B-B, AND C-C.

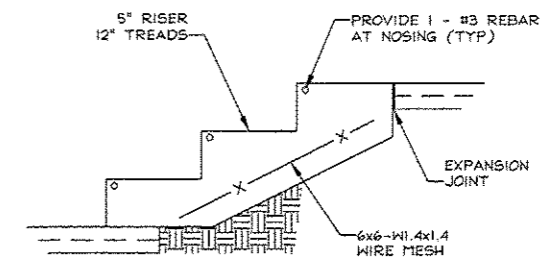
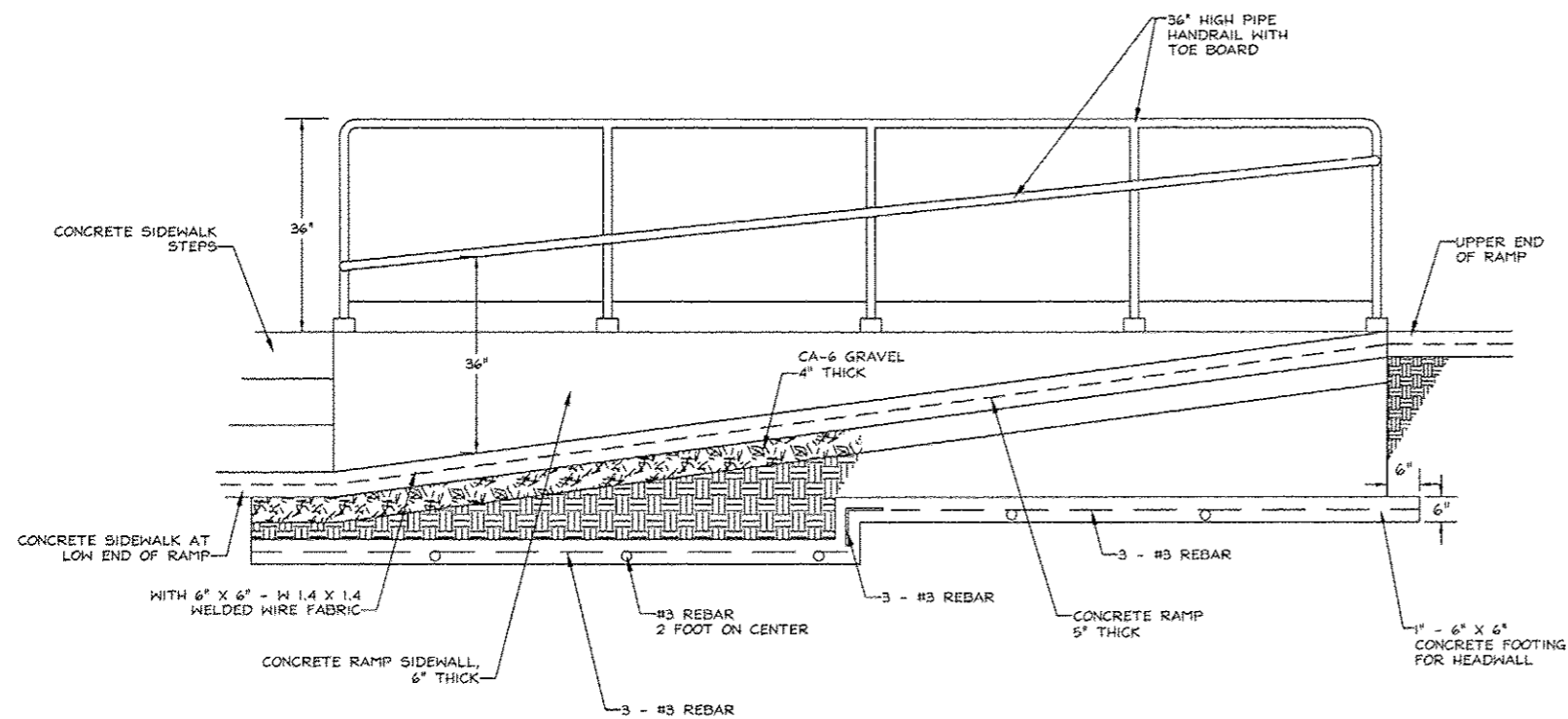
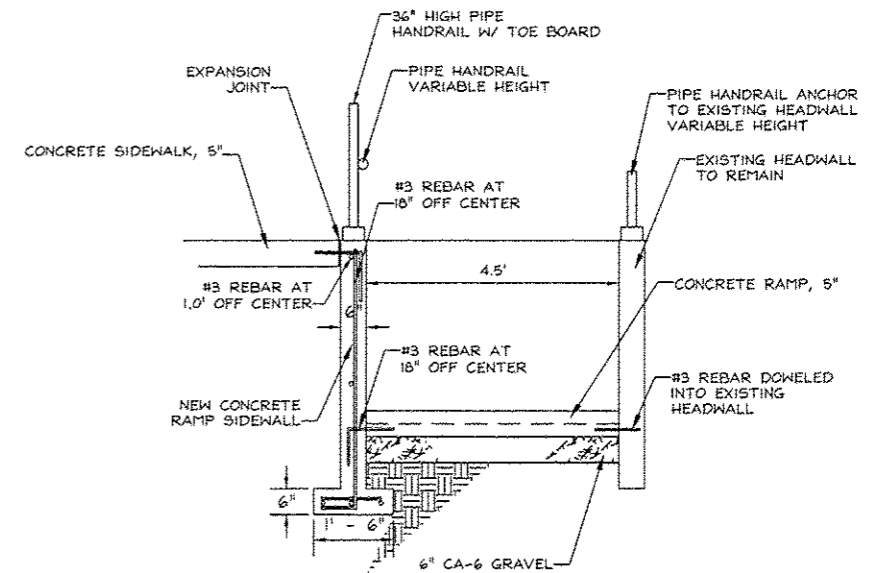

NO.	DESCRIPTION	BY	DATE	NO.	DESCRIPTION	BY	DATE
					DESIGNED		
					DRAWN	WFL	3/27/12
					CHECKED	JHC	3/27/12

VILLAGE OF GOREVILLE
JOHNSON COUNTY, IL
SAFE ROUTES TO SCHOOL
SIDEWALK DETAIL

JOHN H. CRAWFORD & ASSOCIATES, P.C.
CIVIL ENGINEERS, LAND SURVEYORS
201 SOUTH DIVISION STREET, CARTERSVILLE, ILLINOIS 62918
PHONE (618) 585-4370 FAX (618) 585-4692
PROFESSIONAL DESIGN FIRM # 184-002885

SHEET NO.	
14	
ISSUE	DATE
A	3/27/12

V:\Projects\10101\10101.dwg 10/10/12 10:10:12 AM

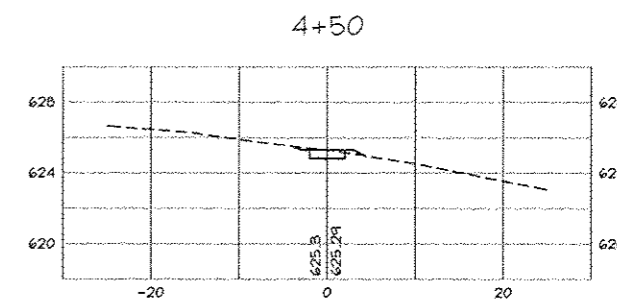
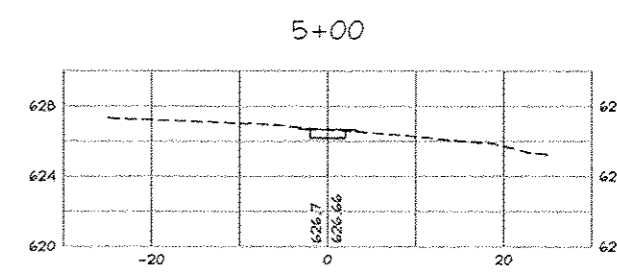
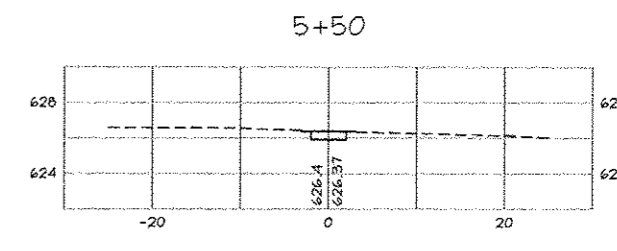
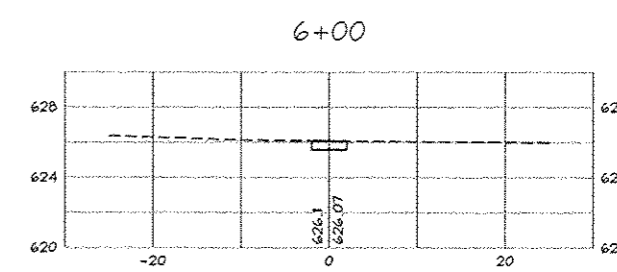
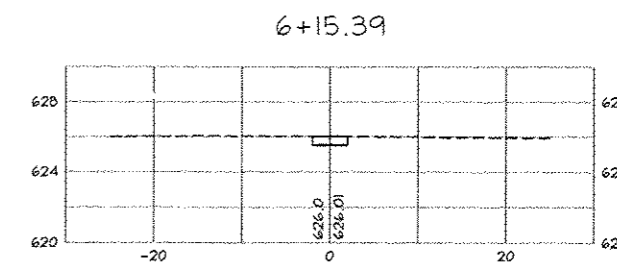
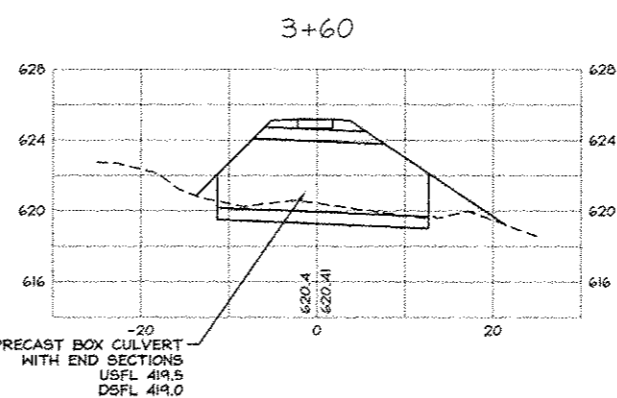
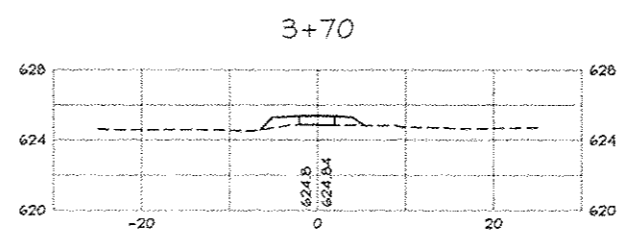
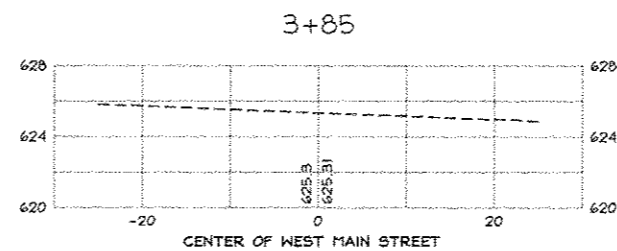
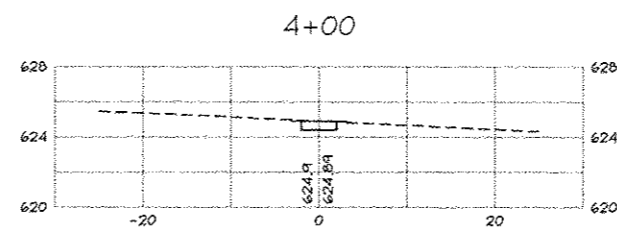
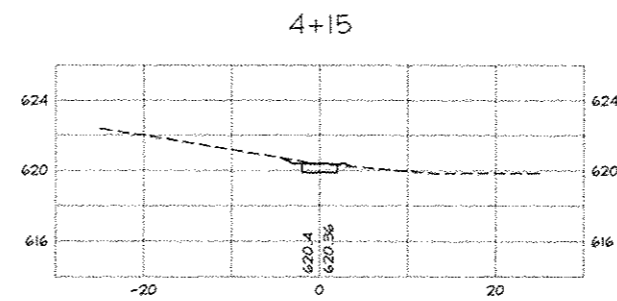
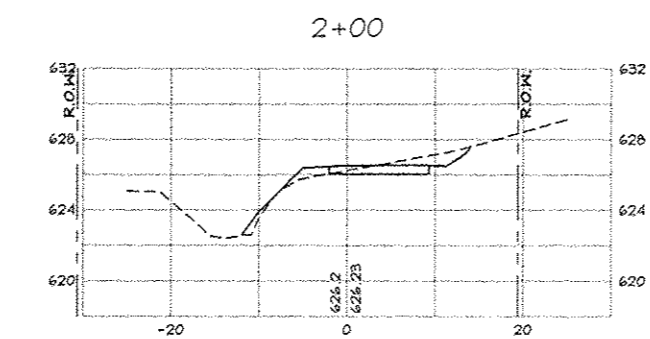
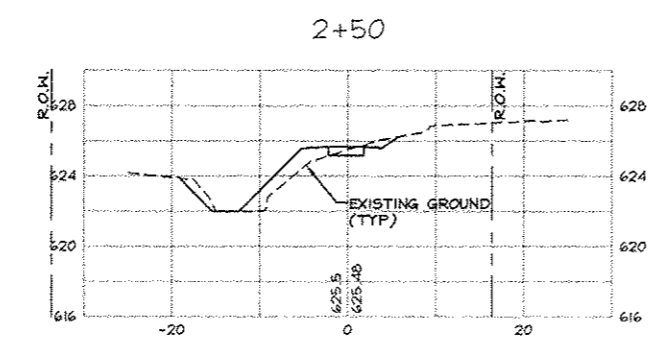
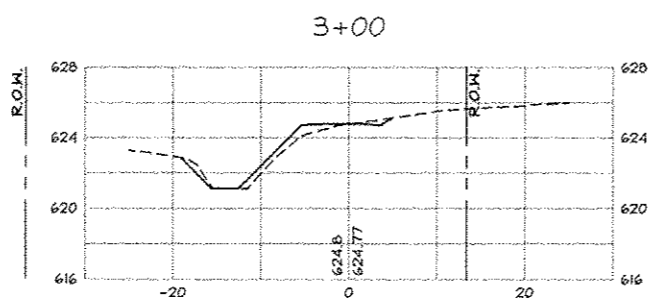
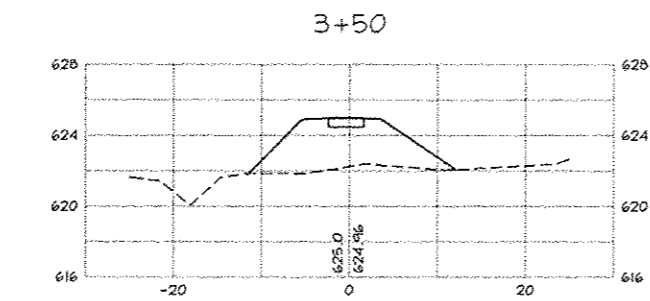
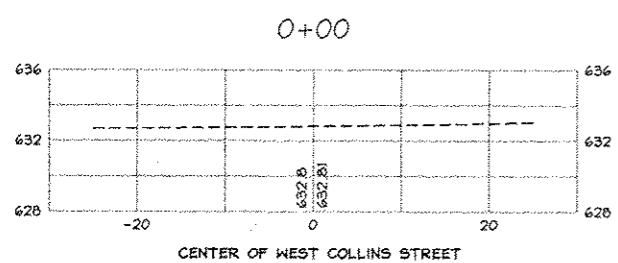
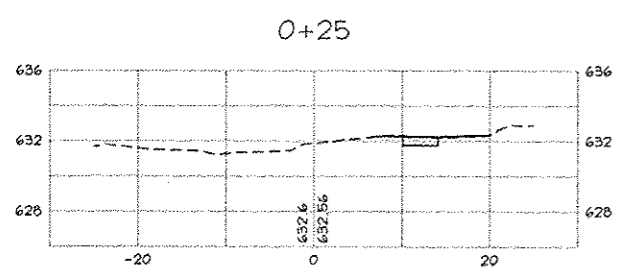
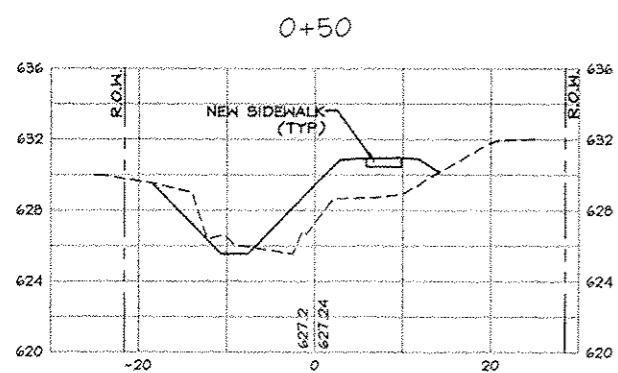
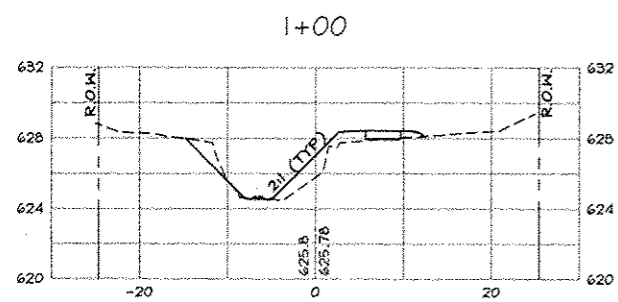
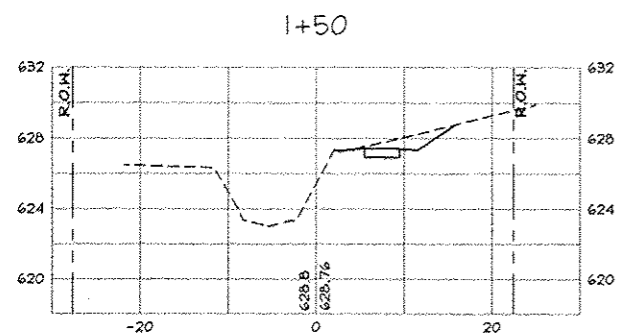

NO.	DESCRIPTION	BY	DATE	NO.	DESCRIPTION	BY	DATE
					DESIGNED		
					DRAWN	WFL	3/27/12
					CHECKED	JHC	3/27/12

VILLAGE OF GOREVILLE
JOHNSON COUNTY, IL
SCHOOL SAFE WAY PLAN
SIDEWALK SECTIONS



JOHN H. CRAWFORD & ASSOCIATES, P.C.
CIVIL ENGINEERS, LAND SURVEYORS
201 SOUTH DIVISION STREET, CARTERSVILLE, ILLINOIS 62918
PHONE (618) 885-6370 FAX (618) 885-4692
PROFESSIONAL DESIGN FIRM # 184-002855

SHEET NO.	
15	
ISSUE	DATE
A	3/27/12