

PLAN SURVEYED BY DATE
 PLOTTED & CHECKED BY
 NOTE BOOK NO. OF WAY CHECKED
 NO. DDD FILE NAME

PLAN SURVEYED BY DATE
 PLOTTED & CHECKED BY
 NOTE BOOK NO. OF WAY CHECKED
 NO. DDD FILE NAME

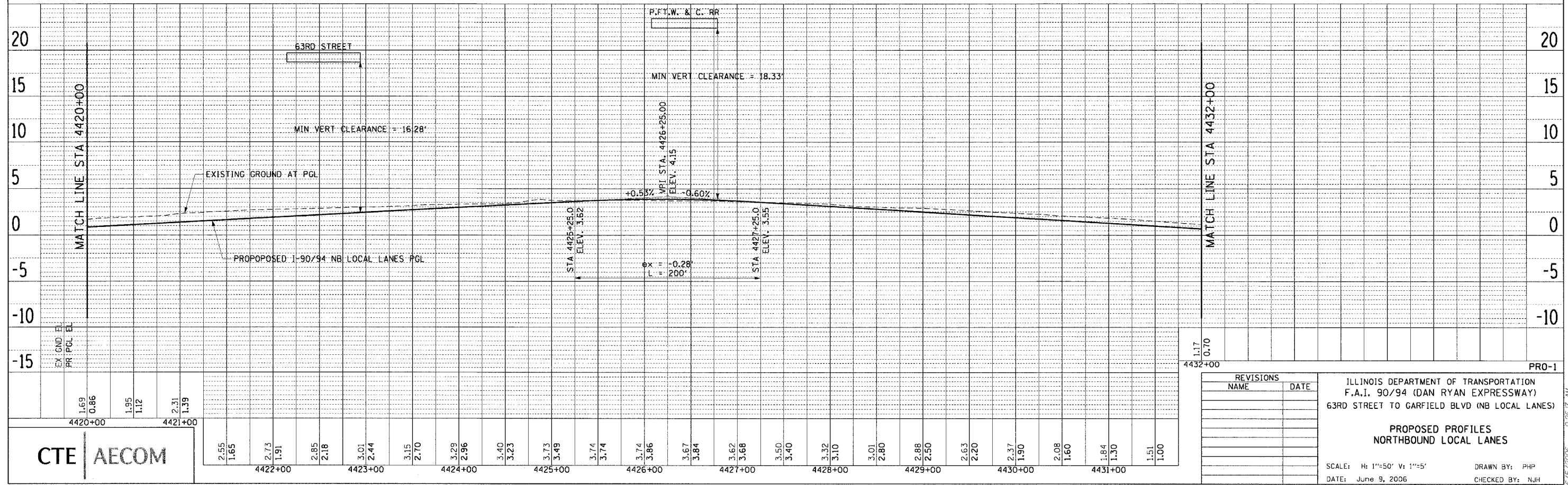
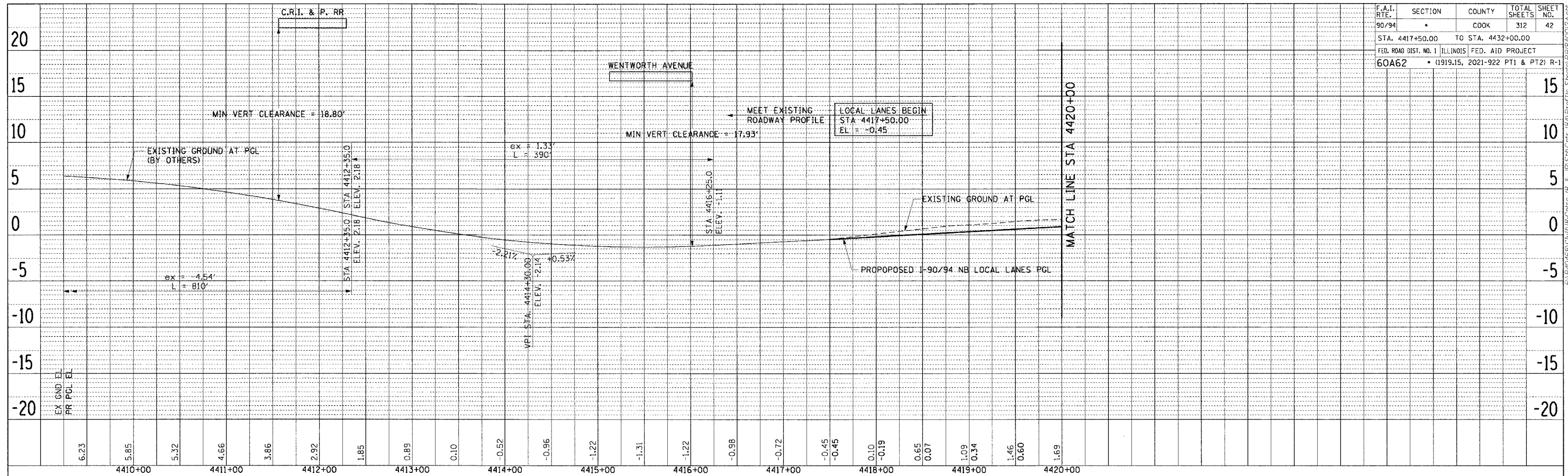

F.A.I. RTE.	SECTION	COUNTY	TOTAL SHEETS	SHEET NO.
90/94	*	COOK	312	42
STA. 4417+50.00		TO STA. 4432+00.00		
FED. ROAD DIST. NO. 1 ILLINOIS FED. AID PROJECT				
60A62 • (1919-15, 2021-922 PT1 & PT2) R-1				

REVISIONS	
NAME	DATE

ILLINOIS DEPARTMENT OF TRANSPORTATION
 F.A.I. 90/94 (DAN RYAN EXPRESSWAY)
 63RD STREET TO GARFIELD BLVD (NB LOCAL LANES)

**PROPOSED PROFILES
 NORTHBOUND LOCAL LANES**

SCALE: H: 1"=50' V: 1"=5'
 DATE: June 9, 2006

DRAWN BY: PHP
 CHECKED BY: NJH



F:\P\40460\CV\NB-Chrs 18 & 19\SP\CHT 18A\Profile 18A\PR01B.Stw

6/5/2006 9:26:17 AM