

| | | | | |
|---|---------|-----------------|--------------|-----------|
| F.A.I. RTE. | SECTION | COUNTY | TOTAL SHEETS | SHEET NO. |
| 90/94 | | COCK | 312 | 94 |
| STA. 4432+00 | | TO STA. 4436+75 | | |
| FED. ROAD DIST. NO. 1 ILLINOIS FED. AID PROJECT | | | | |
| 60A62 • (1919.15, 2021-922 PT1 & PT2) R-1 | | | | |

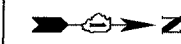

- LEGEND: EXISTING**
- = INLET
 - CATCH BASIN
 - MANHOLE
 - STORM SEWER
 - - - COMBINED SEWER
 - PIPE UNDERDRAIN
 - [R] STRUCTURE TO BE REMOVED
 - [AD] STRUCTURE TO BE ADJUSTED
 - //// STORM SEWER REMOVAL
 - //// COMBINED SEWER REMOVAL
 - //// WATER MAIN REMOVAL
 - ***** ABANDON EXISTING PIPE

EXISTING CONDITIONS AND REMOVAL

- PROPOSED IMPROVEMENTS**
- LEGEND: PROPOSED**
- INLET
 - CATCH BASIN
 - MANHOLE
 - STORM SEWER
 - PIPE UNDERDRAIN
 - - - PROPOSED SWALE
 - ↔ HIGH POINT
 - ↔ LOW POINT
 - (XX-01) PROPOSED STRUCTURE

- NOTES:**
- SEE DRAINAGE SCHEDULES FOR STRUCTURE, PIPE AND UNDERDRAIN INFORMATION.
 - THE LOCATION OF DRAINAGE STRUCTURES AND PIPES CONSTRUCTED IN PREVIOUS CONTRACTS IS BASED OFF OF CONTRACT PLAN DRAWINGS. THE CONTRACTOR MUST VERIFY LIMITS OF PREVIOUS CONSTRUCTION IN THE FIELD.

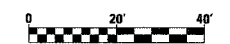

| REVISIONS | |
|-----------|------|
| NAME | DATE |
| | |
| | |
| | |
| | |
| | |
| | |
| | |
| | |
| | |
| | |

DU-8

ILLINOIS DEPARTMENT OF TRANSPORTATION
 F.A.I. 90/94 (DAN RYAN EXPRESSWAY)
 63RD STREET TO GARFIELD BLVD (NB LOCAL LANES)

DRAINAGE AND UTILITY PLANS

SCALE: 1"=20'
 DATE: June 9, 2006

DRAWN BY: NJH
 CHECKED BY: RMC

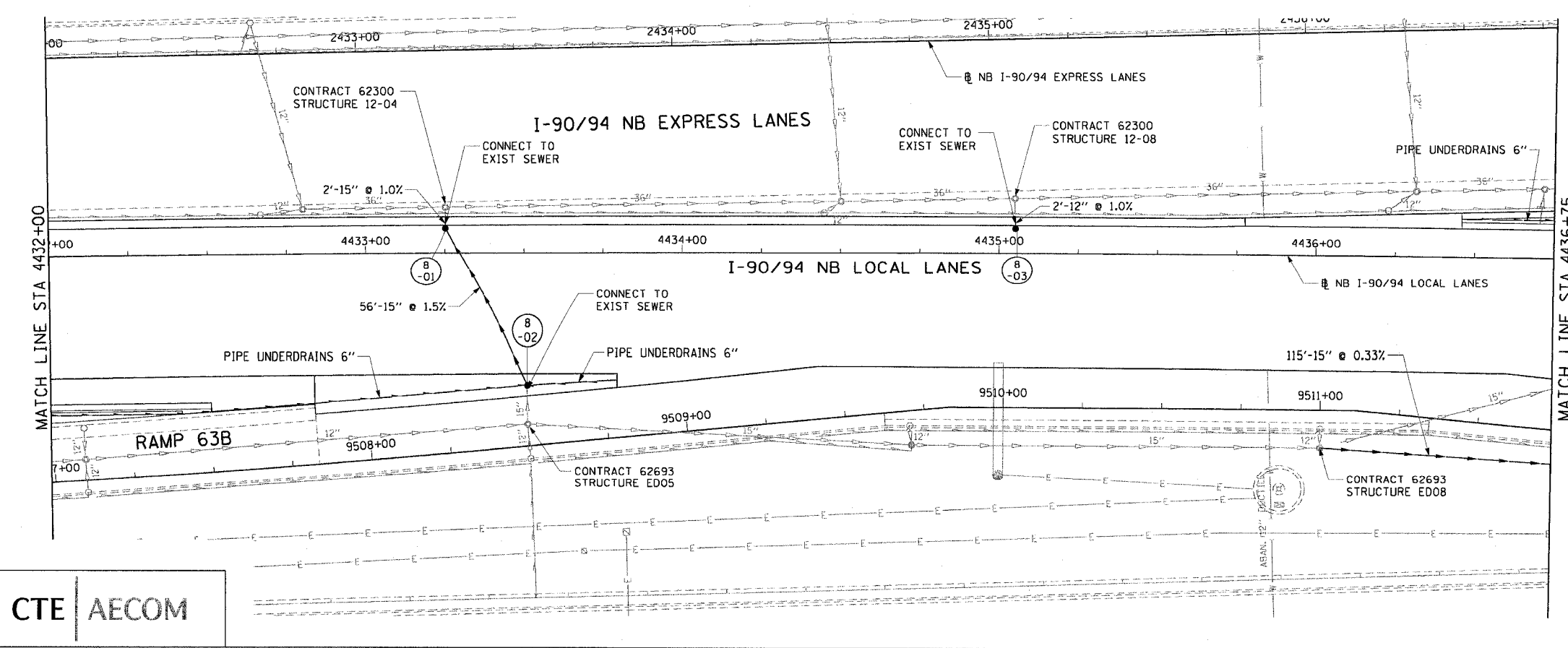
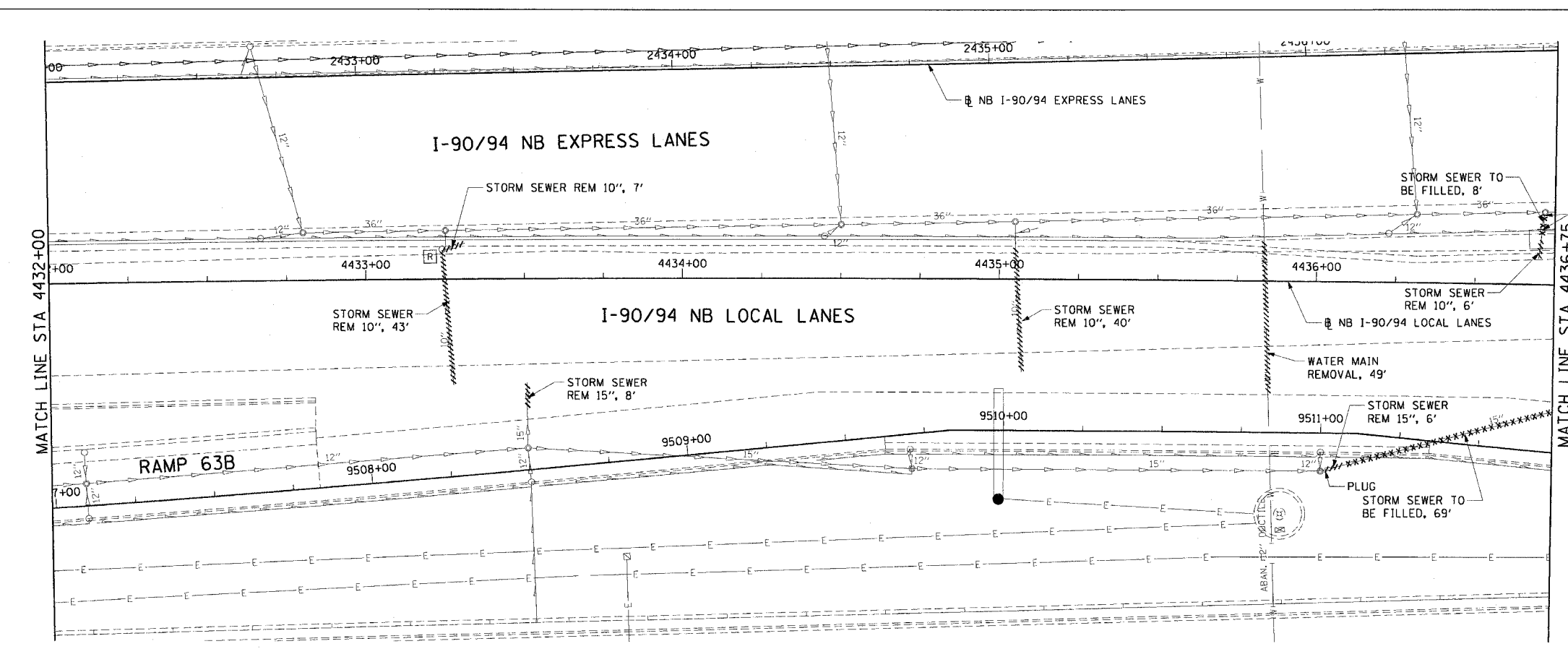

CTE | AECOM

I:\Projects\90-94\90-94-18 & 19\Contract\18\drainage and utility plans\du08.dwg
 9/3/2006 AM