

INSTALLATION NOTES

K - REINSTALL POLE, MAST ARM ASSEMBLY, SIGNAL HEADS, PEDESTRIAN HEADS.

L - REINSTALL STORED SIGNAL ELECTRIC CABLE FROM EXISTING MANHOLE TO SIGNAL AND PEDESTRIAN HEADS

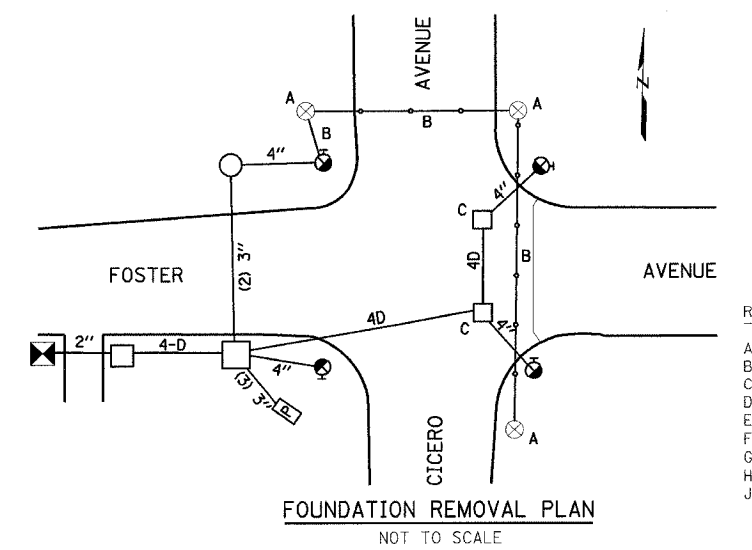

FOUNDATION AND CONDUIT PLAN
SCALE 1" = 20'

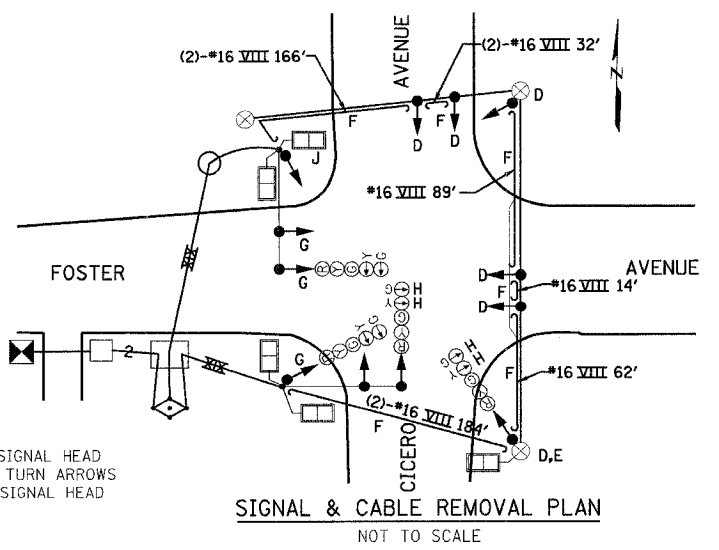

REMOVAL NOTES:

A - REMOVE EXISTING TEMPORARY WOOD POLE
 B - REMOVE EXISTING SPAN & TETHER WIRE
 C - MANHOLE WITH ADJUSTED FRAME & LID
 D - REMOVE EXISTING SIGNAL HEAD
 E - REMOVE EXISTING PEDESTRIAN SIGNAL HEAD
 F - REMOVE EXISTING SIGNAL CABLE
 G - UNCOVER AND ENERGIZE EXISTING WESTBOUND SIGNAL HEAD
 H - UNCOVER AND ENERGIZE EXISTING SOUTHBOUND TURN ARROWS
 J - UNCOVER AND ENERGIZE EXISTING PEDESTRIAN SIGNAL HEAD

BILL OF MATERIALS
REMOVE AND REINSTALL SIGNAL EQUIPMENT

	UNIT	QTY
MAST ARM, TRAFFIC, STEEL MONOTUBE, 35 FOOT	EACH	1
MAST ARM, TRAFFIC, STEEL MONOTUBE, 40 FOOT	EACH	1
SIGNAL HD, POLYCARB., 1-FACE, 3-SECT., BRACKET MNTD	EACH	1
SIGNAL HD, POLYCARB., 1-FACE, 3-SECT., MAST ARM MNTD	EACH	4
SIGNAL HD, POLYCARB., 1-FACE, 5-SECT., BRKT MNTD	EACH	1
PEDESTRIAN SIGNAL HD, POLYCARB., 1-FACE, BRKT MNTD	EACH	4
JUNCTION BOX, POLE OR POST MOUNTED	EACH	2

ALL SIGNAL EQUIPMENT MOUNTED ON LIGHT POLES

BILL OF MATERIALS
REMOVE AND REINSTALL LIGHTING EQUIPMENT

	UNIT	QTY
POLE, STEEL, 34'-6", ANCHOR BASE, 12 1/2" DIA., 3 GA	EACH	2
MAST ARM, STEEL, STREET LIGHTING, 8 FOOT	EACH	4
LUMINAIRE, STREET LIGHT, HPS, 310 WATT, 240 V.	EACH	4

ALL SIGNAL EQUIPMENT MOUNTED ON LIGHT POLES

6/20/2006 6:23:53 AM ks:\182519\A\cadd\1\182519_Perm_Sig_Plan.dgn



ILLINOIS DEPARTMENT OF TRANSPORTATION
FOSTER AVE. BRIDGE OVER I-94
 PERMANENT TRAFFIC SIGNAL INSTALLATION
 N. CICERO AVENUE & W. FOSTER AVENUE
 DRAWING No. 12867

REVISIONS	
NAME	DATE

SCALE: AS NOTED DRAWN BY: PRK
 DATE: JUNE 30, 2006 CHECKED BY: JM