

F.A.P. RTE.	SECTION	COUNTY	TOTAL SHEETS	SHEET NO.
344	2006-003 TS	COOK	63	18
STA.		TO STA.		
FED. ROAD DIST. NO.		ILLINOIS	FED. AID PROJECT	
CONTRACT NO. 60B13				

CONSTRUCTION NOTE:

1 REMOVE EXISTING 18' TRAFFIC SIGNAL POST, INSTALL NEW 12' TRAFFIC SIGNAL POST ON EXISTING FOUNDATION AND RELOCATE EXISTING TRAFFIC SIGNAL HEAD, 3-FACE, 2-FACE, 3-SECTION AND 1-FACE, 5-SECTION TO NEW POST, REUSE EXISTING CABLES. INSTALL NEW LIGHT DETECTOR ON NEW POST AND INSTALL NEW NO. 20 3/C AND NO. 14 3/C CABLES.

REMOVE EXISTING TRAFFIC SIGNAL EQUIPMENT, EACH 1

THE FOLLOWING ITEMS SHALL BE REMOVED BY THE CONTRACTOR AND SHALL BE DISPOSED OF BY THEM OUTSIDE THE RIGHT-OF-WAY AT THEIR EXPENSE. THE SALVAGE VALUE OF THE REMOVED EQUIPMENT SHALL BE REFLECTED IN THE CONTRACT BID PRICE.

- 1 EACH SIGNAL POST - 18'

LEGEND

	EXISTING HANDHOLE
	SERVICE INSTALLATION
	CONCRETE HANDHOLE
	CONTROLLER CABINET
	SIGNAL HEAD AND POST
	SIGNAL HEAD AND BACKPLATE
	MAST ARM ASSEMBLY AND POLE
	DETECTOR LOOP
	CONDUIT
	UPPER NUMERAL INDICATES LENGTH " T INDICATES CONDUIT IN TRENCH " P INDICATES CONDUIT PUSHED LOWER NUMERAL INDICATES SIZE
	EXISTING GALVANIZED STEEL CONDUIT
	R.O.W.
	CONCRETE DOUBLE HANDHOLE
	EXISTING UTILITY POLE
	BURIED TELEPHONE CABLE
	PROGRAMMED HEAD
	LIGHT DETECTOR
	CONFIRMATION BEACON
	RELOCATED

A THIS SHEET IS FOR PROPOSED FIBER OPTIC INTERCONNECT, NEW CONTROLLER ONLY.

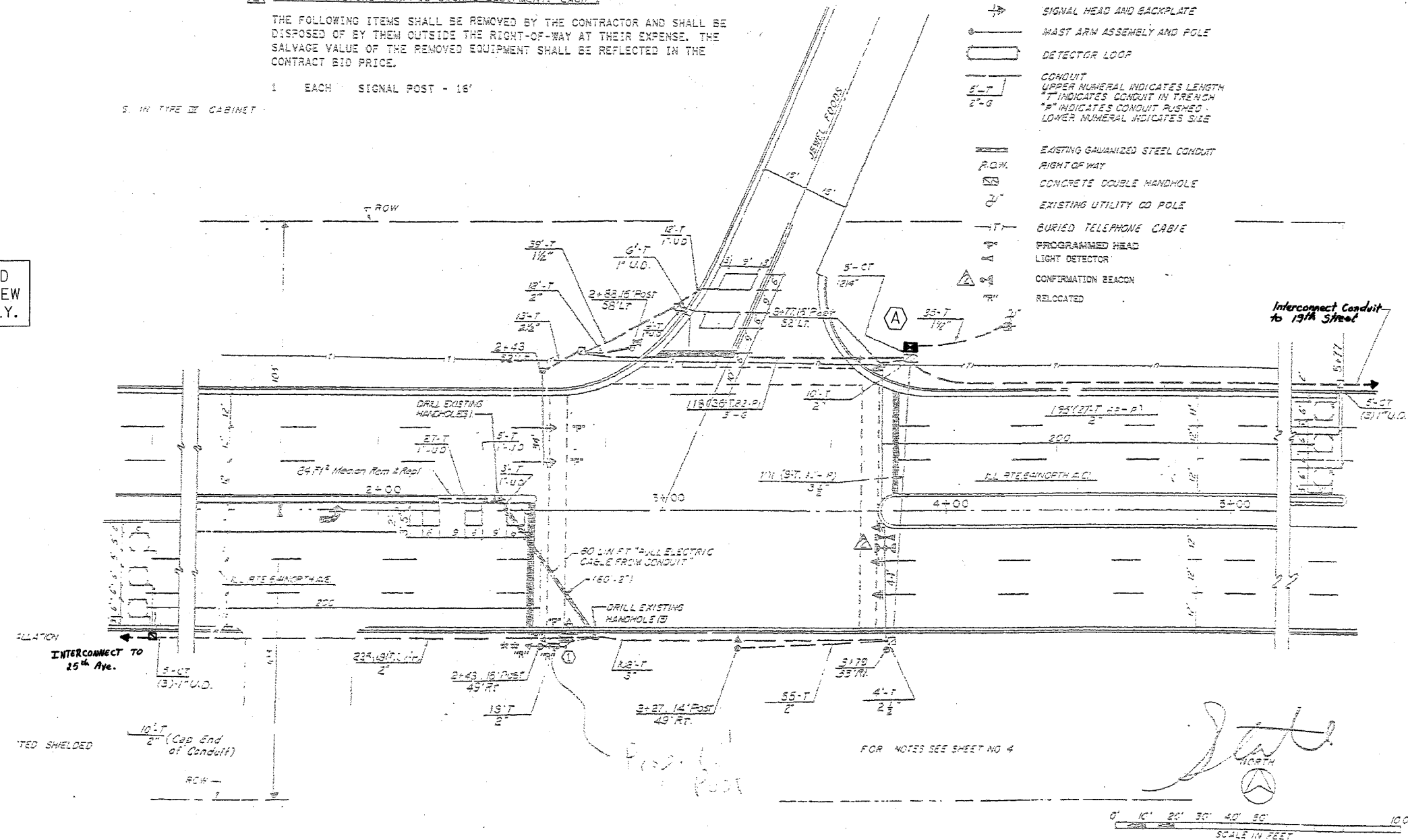

RESTORATION OF WORK AREA. RESTORATION OF THE TRAFFIC SIGNAL WORK AREA SHALL BE INCIDENTAL TO THE RELATED PAY ITEM SUCH AS FOUNDATION, CONDUIT, HANDHOLE, TRENCH AND BACKFILL, ETC., AND NO EXTRA COMPENSATION SHALL BE ALLOWED. ALL ROADWAY SURFACES SUCH AS SHOULDERS, MEDIANS, SIDEWALKS, PAVEMENT, ETC. SHALL BE REPLACED IN KIND. ALL DAMAGE TO MOWED LAWNS SHALL BE REPLACED WITH AN APPROVED SOG. AND ALL DAMAGE TO UNMOWED FIELDS SHALL BE SEEDED IN ACCORDANCE WITH STANDARD SPECIFICATIONS 252 AND 250 RESPECTIVELY.

INSTALLATION OF EMERGENCY VEHICLE PREEMPTION
6-03-02
MELROSE PARK-SHEET 186 OF 365
CHRISTOPHER S. BURKE ENGINEERING LTD.
2875 West Higgins Road, Suite 500
Rosemont, Illinois 60018
(630) 522-0800

75# 10915

REVISIONS	
NAME	DATE
BCP-ENG-ADD	2-3-99
EE NEAR RIGHT	
3-SECTION SIGNAL	
HEAD	
CSSEL	6-03-02

ILLINOIS DEPARTMENT OF TRANSPORTATION
TRAFFIC SIGNAL MODIFICATION AND REMOVAL PLAN
IL. RTE. 64 (NORTH AVENUE) AND JEWEL DR.
SCALE: VERT. NTS
HORIZ. 1"=40'
DATE 6/19/06
DRAWN BY BCK
DESIGNED BY BCK
CHECKED BY DDB