

F.A.P. RTE.	SECTION	COUNTY	TOTAL SHEETS	SHEET NO.
344	2006-003 TS	COOK	59	60
STA.		TO STA.		
FED. ROAD DIST. NO.	ILLINOIS	FED. AID PROJECT		
CONTRACT NO. 60B13				

PROPOSED FIBER OPTIC INTERCONNECT
RE-USING EXISTING CONDUIT UP TO
THE INTERSECTION OF RIDGELAND AV.

ILL. RTE. 64

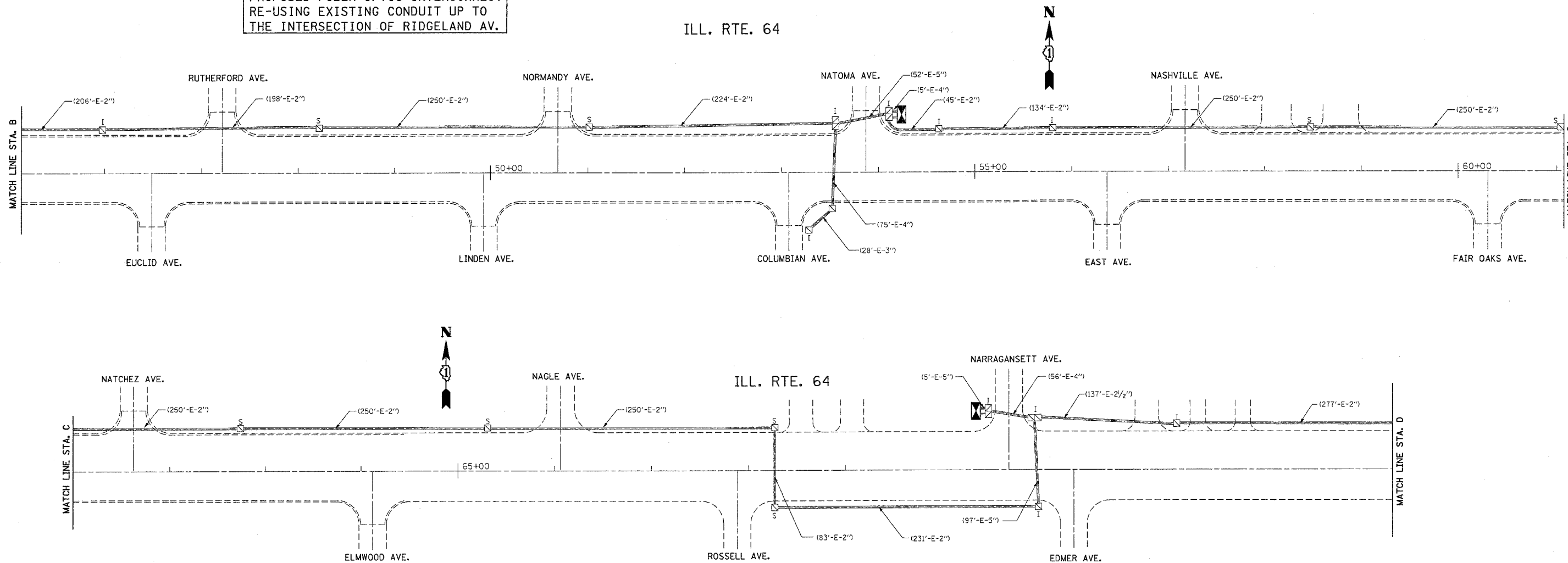

INTERCONNECT PLAN LEGEND

	PROPOSED	EXISTING
CONTROLLER CABINET		
SERVICE INSTALLATION, (P) POLE OR (G) GROUND MOUNT		
TELEPHONE CONNECTION		
HANDHOLE		
HEAVY DUTY HANDHOLE		
DOUBLE HANDHOLE		
G.S. CONDUIT IN TRENCH OR PUSHED		
SYSTEM	S	I
INTERSECTION	IP	I
UNIT DUCT	UD	
COMMON TRENCH	CT	
DETECTOR LOOP, TYPE I		
PREFORMED DETECTOR LOOP		

RESTORATION OF WORK AREA, RESTORATION OF THE TRAFFIC SIGNAL WORK AREA SHALL BE INCLUDED IN THE RELATED PAY ITEMS SUCH AS FOUNDATION, CONDUIT, HANDHOLE, TRENCH AND BACKFILL, ETC. ALL ROADWAY SURFACES SUCH AS SHOULDERS, MEDIANS, SIDEWALKS, PAVEMENT, ETC. SHALL BE REPLACED IN KIND. ALL DAMAGE TO MOWED LAWNS SHALL BE REPLACED WITH AN APPROVED SOD AND ALL DAMAGE TO UNMOWED FIELDS SHALL BE SEEDED. RESTORATION OF THE WORK AREA SHALL BE INCIDENTAL TO THE CONTRACT WITHOUT ANY EXTRA COMPENSATION ALLOWED TO THE CONTRACTOR.

REVISIONS	
NAME	DATE

ILLINOIS DEPARTMENT OF TRANSPORTATION

INTERCONNECT PLAN
ILL. RTE. 64
FROM EUCLID AV. TO EDMER AV.

SCALE: VERT. 1" = 50'
DATE 6/23/2006

DRAWN BY BCK
DESIGNED BY BCK
CHECKED BY DAD

PLOT DATE = 6/23/2006
FILE NAME = c:\projects\1164\ridgeland\1164-ridgeland.dgn
PLOT SCALE = 1/8" = 50' / IN.
USER NAME = karrh@pdh.com

07:44:22 06/23/2006