

| | | | | |
|---------------------|-------------|----------|------------------|-----------|
| F.A.I. RTE. | SECTION | COUNTY | TOTAL SHEETS | SHEET NO. |
| 55 | 2006-031 BY | WILL | 137 | 16 |
| STA. | | TO STA. | | |
| FED. ROAD DIST. NO. | | ILLINOIS | FED. AID PROJECT | |

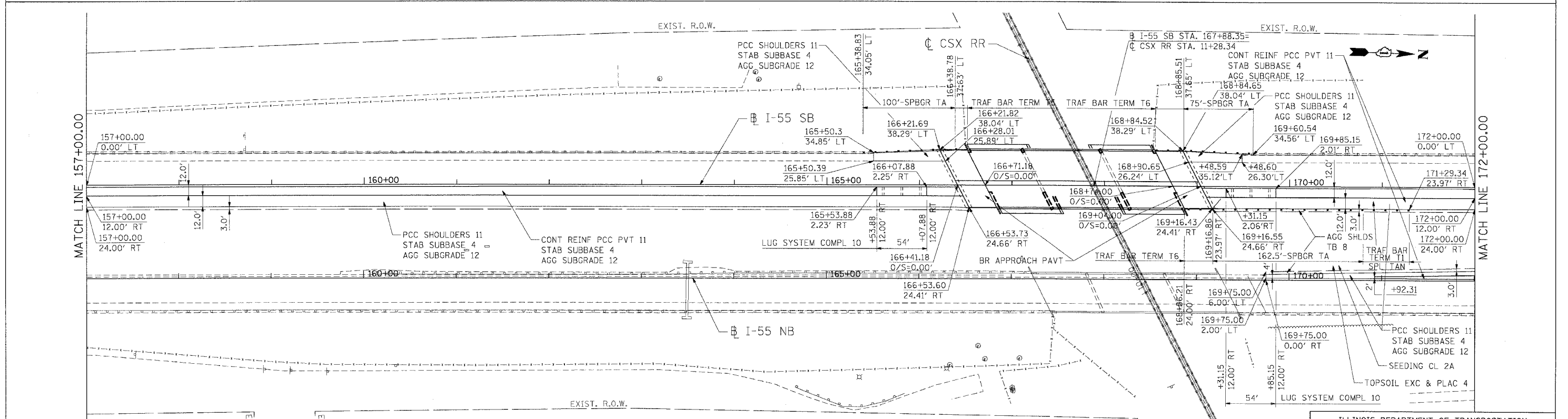
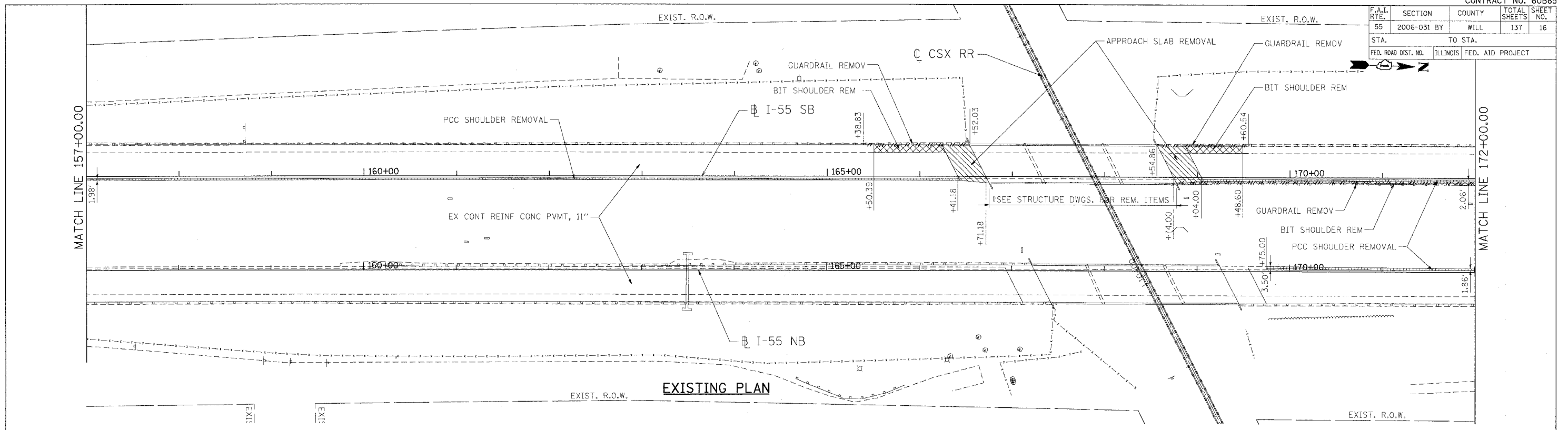

PLOT DATE = 07/21/06
 FILE NAME = I:\PROJECTS\60B85\DRAWING\ROADWAY\ROADWAY.DWG
 USER NAME = DDH
 7-19-2006 10:42:49 AM

| REVISIONS | |
|-----------|------|
| NAME | DATE |
| | |
| | |
| | |
| | |

ILLINOIS DEPARTMENT OF TRANSPORTATION
 FAI ROUTE 55 (OVER CSX RR AND SUNNYLAND DRAIN)
 BRIDGE WIDENING

ROADWAY PLAN
FAI 55
STA. 157+00.00 TO STA. 172+00.00

SCALE: 1"=50'
 DATE 07/21/06
 DRAWN BY AG
 CHECKED BY DDH

TENG
 TENG & ASSOCIATES, INC.
 ENGINEERS/ARCHITECTS/PLANNERS
 CHICAGO, ILLINOIS