

F.A.I. RTE.	SECTION	COUNTY	TOTAL SHEETS	SHEET NO.
55	2006-031 BY	WILL	137	27
STA.		TO STA.		
FED. ROAD DIST. NO.		ILLINOIS	FED. AID PROJECT	

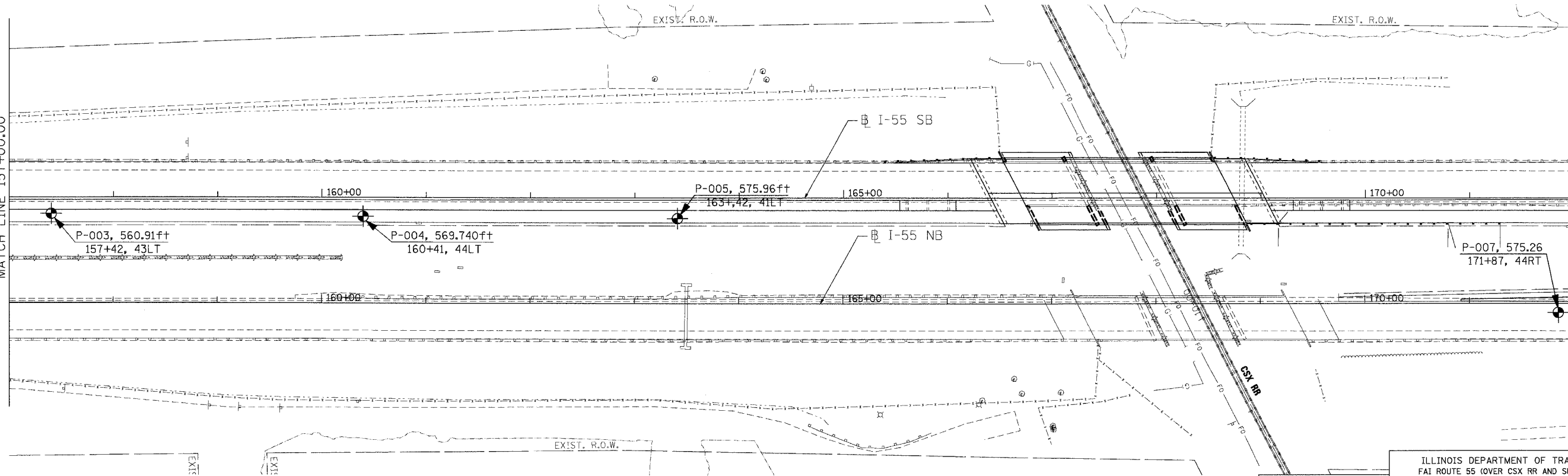
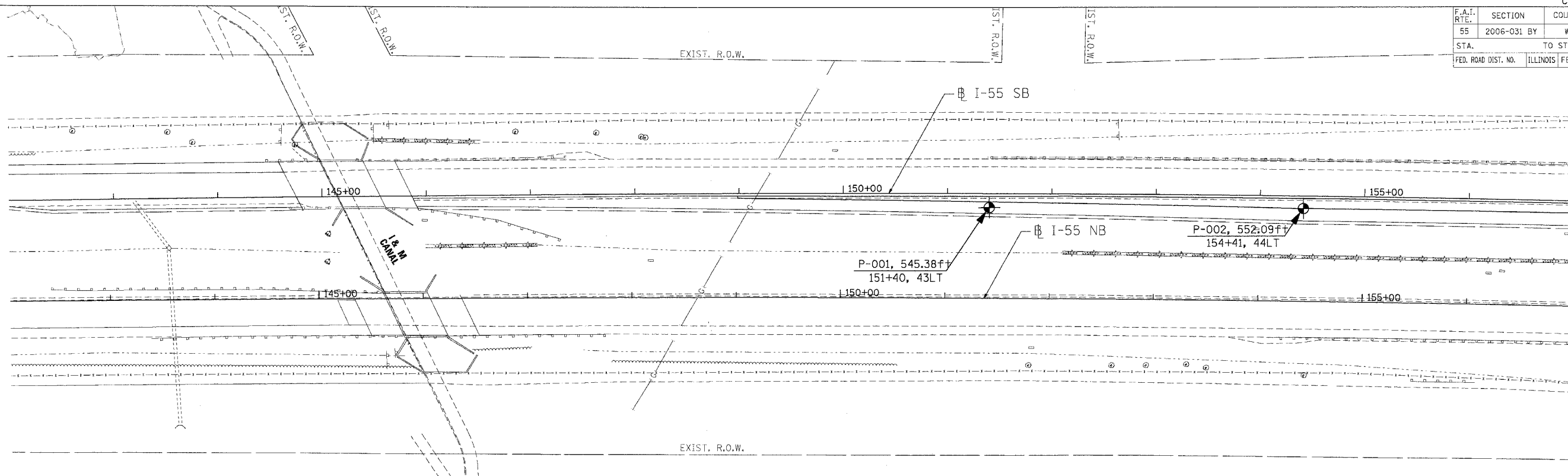

MATCH LINE 157+00.00

MATCH LINE 172+00.00

REVISIONS	
NAME	DATE

ILLINOIS DEPARTMENT OF TRANSPORTATION
 FAI ROUTE 55 (OVER CSX RR AND SUNNYLAND DRAIN)
 BRIDGE WIDENING

SOIL BORING PLAN
FAI 55
STA. 142+00.00 TO STA. 172+00.00

SCALE: 1"=50'
 DATE 07/07/06
TENG ENGINEERS/ARCHITECTS/PLANNERS
 CHICAGO, ILLINOIS

DRAWN BY MW
 CHECKED BY DDH

DRAWN BY: ED/AB CHECKED BY: LI 555-11-01

Wang Engineering, Inc. 1146 Main Street
 Lombard, IL 60148
 Geo-Environmental Engineers 630-953-9928

CREATED BASED ON DRAWINGS PREPARED BY TENG AND ASSOCIATES, INC.

PLOT DATE = 07/07/06
 PLOT SCALE = 1"=50'
 USER NAME = jibber